

HO-803, Old Washington Road Survey District
Old Washington Road, Augustine Avenue, Downs Avenue, Montgomery Road, Elkridge
Howard County
1817-1953
Private

CAPSULE SUMMARY

The Old Washington Road Survey District is located in the town of Elkridge and abuts the Elkridge Landing Survey District (HO-784) on the east. It consists of 100+ buildings, mostly single-family residential homes, located on Old Washington Road, Augustine Avenue, Montgomery Road and Downs Avenue. The period of significance for the Old Washington Road area is defined as 1817-1953, but the buildings standing in the district today date no earlier than ca. 1850. Historically, the Old Washington Road Survey District is a significant example of suburban development over a period of 100 years, and architecturally, the District exhibits an important array of vernacular domestic architecture embellished with decorative details from "popular" architectural designs.

The Old Washington Road Survey District is significant under criteria a and c for its association with broad patterns in American history and its vernacular architecture ranging in date from 1850 to 1953. This district is located immediately to the west of the historic settlement of Elkridge Landing and their histories are intimately connected. This District derives its primary significance from its role as a commuter suburb related first to the railroad and later to the automobile. It also contains a good collection of vernacular architecture, mostly domestic, exhibiting the stylistic trends of 100 years of building.

Maryland Historical Trust

Maryland Inventory of Historic Properties Form

Inventory No. HO-803

1. Name of Property (indicate preferred name)

historic Old Washington Road Survey District

other

2. Location

street and number Old Washington, Augustine, Montgomery, Downs not for publication

city, town Elkridge vicinity

county Howard

3. Owner of Property (give names and mailing addresses of all owners)

name multiple

street and number telephone

city, town state zip code

4. Location of Legal Description

courthouse, registry of deeds, etc. Howard County Courthouse tax map and parcel: Map 38

city, town Ellicott City liber folio

5. Primary Location of Additional Data

- Contributing Resource in National Register District
- Contributing Resource in Local Historic District
- Determined Eligible for the National Register/Maryland Register
- Determined Ineligible for the National Register/Maryland Register
- Recorded by HABS/HAER
- Historic Structure Report or Research Report
- Other HO-804,805,806,807

6. Classification

Category	Ownership	Current Function	Resource Count	
			Contributing	Noncontributing
<input checked="" type="checkbox"/> district	<input type="checkbox"/> public	<input type="checkbox"/> agriculture		
<input type="checkbox"/> building(s)	<input checked="" type="checkbox"/> private	<input type="checkbox"/> commerce/trade	101	23
<input type="checkbox"/> structure	<input type="checkbox"/> both	<input type="checkbox"/> defense		buildings
<input type="checkbox"/> site		<input checked="" type="checkbox"/> domestic		sites
<input type="checkbox"/> object		<input checked="" type="checkbox"/> education		structures
		<input type="checkbox"/> funerary		objects
		<input type="checkbox"/> government		Total
		<input type="checkbox"/> health care		
		<input type="checkbox"/> industry		
		<input type="checkbox"/> landscape		
		<input type="checkbox"/> recreation/culture		
		<input checked="" type="checkbox"/> religion		
		<input type="checkbox"/> social		
		<input type="checkbox"/> transportation		
		<input type="checkbox"/> work in progress		
		<input type="checkbox"/> unknown		
		<input type="checkbox"/> vacant/not in use		
		<input type="checkbox"/> other:		
			Number of Contributing Resources previously listed in the Inventory	
			0	

7. Description

Inventory No. HO-803

Condition

<input type="checkbox"/> excellent	<input type="checkbox"/> deteriorated
<input checked="" type="checkbox"/> good	<input type="checkbox"/> ruins
<input type="checkbox"/> fair	<input type="checkbox"/> altered

Prepare both a one paragraph summary and a comprehensive description of the resource and its various elements as it exists today.

The Old Washington Road Survey District is located in the town of Elkridge and abuts the Elkridge Landing Survey District (HO-784) on the east. It consists of 75+ buildings, mostly single-family residential homes, located on Old Washington Road, Augustine Avenue, Montgomery Road and Downs Avenue. The period of significance for the Old Washington Road area is defined as 1817-1953, but the buildings standing in the district today date no earlier than ca. 1850. Historically, the Old Washington Road Survey District is a significant example of suburban development over a period of 100 years, and architecturally, the District exhibits an important array of vernacular domestic architecture embellished with decorative details from "popular" architectural designs.

1850-1874

6179 Old Washington Road, George W. Hobbs House and Store, HO-804

The two story, double pile, brick house at 6179 Old Washington Road has undergone a lot of changes and contains its share of mysteries and, along with the brick house next door, is one of the oldest buildings remaining on this section of Old Washington Road. The house faces north on the south side of the road on a lot that measures just under half an acre. Like many of the early buildings in Elkridge, it is sited close to the edge of the road. The main block of the house is five bays wide with a hipped roof pierced by two interior brick chimneys. A one story, double pile, single bay wing is located on the east end of the house. A single story addition was made to the rear of the structure in the early 20th century. The main block and the east wing of the house are laid in 7:1 common bond and have a corbelled brick cornice. A stone foundation supports the structure which is painted white.

The front façade of the main block of the house is five bays wide and has two doors on the first story. From left to right the façade contains a door, two windows, another door, and a window. The second story of the main block contains five windows which are vertically aligned above the first floor openings. The single story east wing is one bay wide on the front and contains one window. The windows are vinyl replacements and the doors are not original. But the openings are all capped with flat arches and do appear to be original. Both of the doors have transoms. All of the window sills have been replaced with header brick sills; they would have been stone or wood originally. The window on the front of the east wing is also an original opening with a flat arch although the window is a vinyl replacement. A corbelled brick cornice runs across the front of the building on both the main block and the east wing. A single story front porch spans the five-bay main block but it is made of 20th century material – concrete floor, iron balustrade and iron and brick supports – and it is not clear what the original porch looked like. This house dates to ca. 1850.

6181 Old Washington Road, Hobbs House, HO-805

The two and a half story, single pile, brick house at 6181 Old Washington Road has been heavily altered but remains one of the most interesting houses on this stretch of the old Washington Turnpike. It rests on a rubble stone foundation facing north on the south side of Old Washington Road. The house currently occupies a very small lot and sits close to the edge of the road. The tall and narrow house is only three bays wide and capped with a side gabled, asphalt shingle roof. The house is laid in a 7:1 common bond and has a corbelled brick cornice. The east and south facades of the structure are stuccoed and painted white while the north (front) and west facades are only painted. A two story cross gabled brick addition was made to the rear of the house around 1945 and at that time the original portion of the house was heavily altered. A frame porch on the rear of the addition has been enclosed with asbestos siding.

The front façade of the house shows several major alterations. Currently, the first story of the façade contains a central entry flanked by a window on either side. All of the windows in the house are vinyl replacements and the door is also not original. All of the openings are capped with flat brick arches. However, two courses above and slightly offset from the door opening is another flat brick arch; this one is more finely executed than the other existing arches and the bricks are gauged to give the arch a more distinct splay. On the far left of the façade there is a large patch in the masonry where a door used to be; this patch does not have a

Maryland Historical Trust

Maryland Inventory of Historic Properties Form

Inventory No. HO-803

Name Old Washington Road Survey District
Continuation Sheet

Number 7 Page 1

flat brick arch at the top of it. On the second story, there are currently two windows in the end bays and a blank central bay, and the half story above features two smaller windows (probably held 3/3 wood sash originally) vertically aligned above the existing second floor windows. The central bay on the second story is currently blank but does contain a flat brick arch indicating that it used to hold a window. Like the extra arch above the door below, the flat arch on the second story is also gauged with a more distinct splay than the flat arches currently capping the windows. The second story flat arch is also vertically aligned above the extra arch on the first story. The left most window on the second story is vertically aligned above the door patch on the first story. A full width, single story, hipped roof front porch spans the front of the house and is supported by chamfered square posts. The floor of the porch is poured concrete. The only other decoration on the front façade is a corbelled brick cornice. The house used to have two interior brick end chimneys on the east and west walls but these were dismantled in the 1940's and the fireplaces closed. This house dates to ca. 1850.

6301 and 6305 Old Washington Road, Hartke Double House, HO-807

The Hartke Double House faces north on the south side of the turnpike directly across from where Montgomery Road intersects Old Washington Road. The two-story frame building was built in several stages and all sections of it rest on stone foundations. The building houses two separate dwellings. The west half of the building, three bays wide with a front gabled roof, is now known as 6305 Old Washington Road and probably dates to around 1880. This dwelling was added onto the west façade of an existing dwelling, what is now the eastern half of the double house, known as 6301 Old Washington Road. The eastern half of the house consists of two separate sections, a single pile, four bay wide section with a side gabled roof, and a cross gabled rear wing. At least part of the eastern half of the house (the rear wing) dates to at least 1850 and has a plain, boxed cornice and boxed cornice returns. The side gabled section has a central brick chimney while the rear wing has an interior end chimney on the back wall. Each half of the house now has its own lot; together they total about half an acre. The house adjoins the old schoolhouse lot on the west and other residential properties on the south and east.

6204 Old Washington Road

This two-story frame house faces south close to the north side of the road. It rests on a masonry foundation which is concealed by the purple asbestos siding that covers the walls of the house. The three bay wide house is capped by a side gabled roof with two cross gables on the front façade. The entrance is in the far right bay on the first story beneath a steeply pitched pedimented entry portico with exposed rafter tails and turned supports. The two windows on the first story and the two windows on the second story are vertically aligned below the cross gables. All of the windows are replacements. A brick façade has been applied halfway up the first story on the front façade. The front section of the house is one room deep with a rear two story cross-gabled wing and a large interior central brick chimney pierces the ridge of the side gabled roof. Decorative scalloped vergeboards decorate the end gables and the two front cross gables. The steeply pitched gables, the decorative vergeboards, and the large central chimney give the house a gothic feel and it probably dates to ca. 1865.

6208 and 6210 Old Washington Road

This interesting two-story frame duplex faces south close to the north side of the road. A side gabled roof shelters the front single pile section and is pierced by a massive central brick chimney and a central cross gable. The four-bay front façade has entrances in the two end bays and tall floor-to-ceiling windows in the middle two bays. These first floor windows are replaced and both doors are also 20th century replacements, but a tall 4/4 original wood window on the west façade indicates that the size of the window openings are original. Both entrances are sheltered by gabled entry porticos supported by square chamfered posts. Four smaller 4/4 wood windows span the second story of the front façade. A large two story, three bay, single pile addition towards the rear of the east façade also has a side gabled roof. Three windows span the first story of the addition while only one decorates the second

Maryland Historical Trust

Maryland Inventory of Historic Properties Form

Inventory No. HO-803

Name Old Washington Road Survey District
Continuation Sheet

Number 7 Page 2

story; all are modern replacements. An interior brick end chimney is located on the east wall of the addition and a single story porch supported by square posts on a solid brick balustrade spans the front of the addition. Decorative scalloped vergeboards decorate the east gable of the addition. Both the east addition and the main block of the house are covered with cedar shakes, have asphalt shingle roofs and rest on stone foundations. There are no decorative vergeboards on the main block but the peaks of all three gables are decorated with wood finials. There is also at least one rear wing and perhaps two, one off each half of the house. A two story cross gabled rear wing extends at least from the east half of the house and is pierced by another massive interior brick chimney. A small single story one room addition is located towards the rear of the west façade. A large modern garage has been built on the western edge of the lot. Based on the exterior details, this house probably dates to ca. 1865 but may date a decade or so earlier.

6249 Old Washington Road

This two story frame house faces north on the southwest corner of the Old Washington Road – Hanover Road intersection. The house rests on a stone foundation on a large lot and has a side gabled roof with a central cross gable on the front. A large rear cross gabled wing extends the house to the rear. The narrow front façade is only three bays wide with a central glazed entry. The door is flanked by tall 4/4 double hung wood windows, one on each side, and vertically aligned above on the second story are three smaller 4/4 wood windows. Wood finials decorate the peaks of all three gables. There are two exterior end chimneys on the house - the one on the east façade is brick while the one on the west façade is stone; neither is original. A two-story frame addition is located towards the rear of the west façade – the stone foundation on this section does not match that beneath the front section of the house. A hipped roof, single story, front porch spans the front façade but is constructed of completely modern materials with iron supports and a cement floor. The house is clad in asbestos siding but is in excellent condition with most of its original windows. It probably dates to ca. 1865.

6184 Old Washington Road

This two-story, frame, side hall plan house faces south on the north side of the road. It has been restored/rehabilitated by the current owners and has new, beaded wood siding. The three bay house rests on a stone foundation and has a side gabled roof with a central cross gable. The first floor windows of the house are tall, floor to ceiling, 2/2 original wood windows. The three windows across the second floor are vinyl replacements. There are decorative patterned shingles in the central cross gable and the end gables. A bump out on the west façade looks a lot like a former chimney but may just be a projecting bay. The existing front porch has clearly not been restored and has brick supports and an iron balustrade on a concrete floor. The house is in excellent condition and is the only restored house in the district to have new wood siding instead of vinyl. It is unclear, however, if the patterned shingles are new renditions of an original detail or if they are instead a brand new detail. This house probably dates to ca. 1870.

1875-1899

6180 Old Washington Road

This two story frame tri-gable faces south on the north side of the road across from the two Hobbs houses. The house is three bays wide with a central entry and original 2/2 wood windows. One interior brick chimney pierces the side gabled, asphalt shingle roof. A two story addition on the back (north façade) of the structure extends the house to the rear. An enclosed full width front porch conceals the front door. The house is clad in asbestos siding and is in good condition. It probably dates to ca. 1875.

6252 Old Washington Road

Maryland Historical Trust

Maryland Inventory of Historic Properties Form

Inventory No. HO-803

Name Old Washington Road Survey District
Continuation Sheet

Number 7 Page 3

This two-story frame tri-gable faces south close to the north side of the road. The house is clad in asbestos siding and rests on a brick foundation. One interior brick chimney pierces the asphalt shingle roof. The three bay front façade has a glazed and paneled central entry on the first story and a bay window in the right bay. A 2/2 double hung wood window is located in the left bay and three more 2/2 windows are vertically aligned above on the second story. There are several rear additions, probably on an original rear cross-gabled wing. A single story wrap around porch wraps around the west façade and has square chamfered posts, square balusters, and a wood floor. The house is in excellent condition and probably dates to ca. 1875.

6270 Old Washington Road

This is another example of a two-story, frame, tri-gabled dwelling. This one rests on a stone foundation which is covered with cement facing south on the north side of the road. The side gabled single pile front section is augmented by several rear extensions, one of which is probably an original cross-gabled rear wing. The three bay front façade has 2/2 wood windows and a central entry (the door is not original). A single story hipped roof front porch has been enclosed. The materials of the house have been modernized with an asphalt shingle roof and vinyl siding. The house is in good condition and probably dates to ca. 1875.

6274 Old Washington Road

This interesting two-story, frame tri-gable faces south on the north side of the road across the street from the fire station. This house is narrower than most of the other tri-gables in the district but has a large original two story cross gabled rear wing. A large two-story addition has been made to the rear of the wing extending the house further. The original portion of the house rests on a stone foundation. The three bay front façade features a steeply pitched central cross gable and two entrances, one in each end bay. Both of the existing doors are historic and appear to be original— one is actually paneled double doors with elaborate carving and a transom of multicolored lights and the other is glazed and paneled with many multicolored panes of glass in the window and is also capped by a transom. How the floorplan corresponds to these two doors is unclear from the exterior. The single window on the first story and the three across the second story are all vinyl replacements. A sunburst design in the cross gable is done in vinyl as is the rest of the exterior siding. It is unknown if this design is based on the original appearance of the house. A two story stacked bay window on the east façade has a mansard-type roof covered with decorative shingles and rests on a brick foundation. This is probably a slightly later addition. The west façade features one small square window with many small panes of multicolored glass and the only original 4/4 wood window left in the house. Two 6/6 wood windows are located in the basement level of the west façade. A full width single story front porch appears to have an original stone foundation but now has a cement floor. The turned supports and wood balustrade look to be recently redone but are probably close to the original style of the porch. In spite of the all vinyl exterior and replacement of most of the windows, this house is still in excellent condition and is one of the more interesting ones along the street. It probably dates to ca. 1875.

6004 Old Washington Road

This two story, three bay, frame I-house rests on a stone foundation facing south on the northwest corner of Augustine Avenue and Old Washington Road. The house originally contained four rooms, two upstairs and two down, and a center hall. There is a basement under half of the house. An addition has been made to the rear of the building. The side gabled asphalt shingle roof has a central cross gable on the front façade and is pierced by two interior corbelled brick chimneys at the ridge, probably flanking the center hall. The house is clad in aluminum siding and all of the windows are vinyl replacements. The front porch has been enclosed to form a vestibule concealing the original entry and eliminating any decoration on the porch. The central cross gable contains a vent. This house is in good condition but most of its character defining elements have been lost. It was probably built ca. 1880.

Maryland Historical Trust

Maryland Inventory of Historic Properties Form

Inventory No. HO-803

Name Old Washington Road Survey District
Continuation Sheet

Number 7 Page 4

6040 Washington Road

This two story, five bay, frame Folk Victorian is set back from the road facing south on the north side of Old Washington Road. The house has been heavily modernized with vinyl siding, all replacement vinyl windows, and a large addition on the rear. The asphalt shingle, side gabled roof is pierced by two interior brick chimneys at the ridge of the roof, probably flanking the center hall. On the first story of the front façade, the central entry is topped with a transom and flanked by sidelights. The house's most interesting feature is a centered second story bay window with a tent roof vertically aligned above the front door. A full width single story front porch also exhibits Victorian influences in the spindle frieze and turned porch supports. The gables used to contain small arched windows but they have since been replaced with rectangular vinyl units. The house is in excellent, though altered, condition. It sits on a larger lot than most on Old Washington Road and was probably built around 1880.

6317 Old Washington Road, Old Elkridge School House, HO-806

This vacant house sits in disrepair on an overgrown lot at the intersection of Montgomery Road and Old Washington Road beside HO-807, The Hartke Double House. The one story frame building faces east on a small hill close to the edge of the road on a part stone, part concrete foundation. In its earliest incarnation the building was an early schoolhouse in Elkridge, perhaps dating back to around 1885. In 1912 the building was sold by the school board and was converted into a private residence. The original portion of the structure has a gable front roof and rests on a stone foundation. Three tall original 6/6 wood windows remain on the north façade, the only façade that has not been added onto. Additions have been made to the rear (west) façade and the south façade. An enclosed porch stretches across the front (east façade) of the building. Aluminum siding covers the exterior walls of the building and the roof is covered with asphalt shingles. An interior brick stovepipe chimney pierces the roof in the center of the original building and probably served a central heating stove originally.

6084 Old Washington Road

Set on a large lot well back from the road, this two story, frame, gable and wing structure is in excellent condition. The house is five bays wide, not including an additional wing on the far side of the gable front section. The additional wing means the gable front section is actually in the middle of the house instead of on one of the ends. It is unclear if this wing is a later addition. The gable front section is dominated by stacked bay windows, one on each floor. The central entry was originally capped by a transom that has since been closed. All of the windows in the house are vinyl replacements. The house is clad in cedar shakes and has an asphalt shingle roof except on the additional east wing which has a standing seam metal roof. One large interior end chimney is located on the west wall of the house. A full width front porch is supported by classical style posts and lacks a balustrade. This house is similar in form to many others in the district and probably dates to the late 19th century, ca. 1890.

6154 Old Washington Road

This two story, three bay frame house rests on a stone foundation facing south on the north side of the road. It is one of several historic houses along this stretch that have been heavily modernized, but this house at least retains its original form. The five/three bay front façade has a projecting cross-gabled central bay which contains the central entry on the first floor. The entry is flanked by sidelights and capped with a transom. All of the windows in the house are vinyl replacements and the house is clad in vinyl siding. An asphalt shingle side gabled roof is pierced by one interior brick chimney. A large wrap around porch features turned supports and balusters. The house is in excellent condition but the materials have been heavily modernized and it is unclear what is original to the house. It probably dates to ca. 1890.

Maryland Historical Trust

Maryland Inventory of Historic Properties Form

Inventory No. HO-803

Name Old Washington Road Survey District
Continuation Sheet

Number 7 Page 5

6231 Old Washington Road

This two story, frame, gable front and wing dwelling faces east on the south side of the road. The house rests on a stone foundation amidst a large lawn and many large trees set back from the road. The gable front section of the dwelling extends well beyond the rear of the side wing creating a large two-story rear wing as well. There is a two story square tower with a pyramid roof with flared eaves set in this rear ell. The front entrance, located on the east façade, has a transom and sidelights and is flanked by two windows in the gable front section and two in the side gabled wing. A single story porch is located in the front ell across the front façade of the side gabled wing but it has been entirely rebuilt with modern lumber. Two interior brick chimneys with decorative peaked tops pierce the roof. All in all the house is in excellent condition but has been heavily modernized with asbestos siding, all replacement windows, and an asphalt shingle roof. The one remaining character-defining element of the structure is the rear tower and based on this evidence the house is dated to ca. 1890.

6238 Old Washington Road

This heavily modernized two story frame dwelling rests on a stone foundation facing south directly across from the Old Washington Road / Hanover Road intersection. The front section of the house has a very low pitched side gabled roof. A cross gabled wing extends the house to rear and on the rear of the wing is a two story square tower with a pyramid roof. The front façade of the house is three bays wide with a glazed and paneled central entry. The door itself is a Victorian era door with carved dentils and other decoration. The bay just around the front door juts out about a foot on the first story only creating a very small vestibule inside. There is no front porch; only a cement stoop. Some of the windows on the house are vinyl replacements, some are 1/1 wood, and there is at least one 2/2 wood window on the west façade. A large old interior brick chimney is also located towards the rear of the west façade. There is a separate entrance on the second story of the east façade accessed by an exterior wooden stair and deck and the house may be divided into apartments. Totally clad in vinyl with an asphalt shingle roof, it is hard to date this building from the outside. The only datable elements are the door and the tower and based on these details alone a date of ca. 1890 is assigned to the building.

6050 Old Washington Road

Like house number 6042 located just to the east, this two story, five bay frame dwelling sits very far back from the north side of Old Washington Road. It faces south and is not visible from the road. Also like house number 6042, this one has been heavily modernized with vinyl siding and all replacement vinyl windows. The asphalt shingle side gabled roof is interrupted by a cross gabled projecting center bay. Two interior brick chimneys located at the ridge of the roof probably flank a center hall. The glazed and paneled central entry is flanked by sidelights. A two story cross gabled wing extends from the rear of the house; it is not possible to tell if this is original. No front porch exists though it seems likely that it had one at one point. A complete lack of decorative details makes this structure difficult to date but based on form alone the house probably dates to the last quarter of the 19th century.

6066 Old Washington Road

Another heavily altered, two-story, frame structure, this house faces south on the north side of the road. This one sits fairly close to the road and may originally have had a gable and wing form but several large additions confuse the picture. The house is entirely clad in vinyl siding and has all vinyl replacement windows. Two interior brick chimneys and a hipped roof dormer are the only remaining elements of the house that look as if they have any age on them. Again, without any decorative details or original materials it is very difficult to date this house. An educated guess of the last quarter of the 19th century is the best that can be done.

Maryland Historical Trust

Maryland Inventory of Historic Properties Form

Inventory No. HO-803

Name Old Washington Road Survey District

Continuation Sheet

Number 7 Page 6

Augustine Avenue

The west side of Augustine Avenue south of Old Washington Road is lined with a series of Folk Victorian houses that all appear to be the same vintage (ca. 1890) and exhibit an assortment of stylistic details and forms common to the period. All of the houses are on lots that are (or were originally) around 1 acre and the houses all sit on the front half of the lot close to the street. The entire eastern side of the street and the south end of the street south of house number 5960 has been residentially developed within the last 20 years.

5960 Augustine Avenue

This interesting two-story frame Folk Victorian is five bays wide and two bays deep and rests on a brick foundation. The side-gabled, asphalt shingle roof is pierced by two interior brick chimneys at the ridge that probably flank a center hall. The central entry is glazed and paneled with a two light transom. The most prominent decorative feature of this house located on the front façade to the right of the front door are stacked bay windows, one on each story, capped with a tower roof. Windows in the bay windows are 1/1 double hung wood while others in the house are 2/2 double hung wood. A total of three diamond shaped, multi-paned windows also adorn the house, two on the front façade and one on the south façade. A single story wrap around porch wraps around the front and south facades of the house. The supports are plain and square as are the balusters. A bay window on the second story of the south façade rests on the porch roof. The entire house is clad in cedar shakes and there are decorative shingles in the gables on the north and south sides. The house is in good condition. The back half of the original lot has been subdivided off and a new house constructed.

5956 Augustine Avenue

This two-story, five bay, frame, gable front and wing house lacks the Victorian details of its neighbors but is in excellent condition. The gable front section is two bays wide with two 2/2 windows on each story. The central entry is located in the wing and is glazed and paneled with a transom. Windows throughout the house are 2/2 but some appear to be replacements that have retained the 2/2 configuration. There are 2/2 arched windows in each of the three gables. In the ell on the front of the house there is a single story porch with classical style supports on a solid balustrade. The house is clad in vinyl siding and has an asphalt shingle roof pierced by one interior brick chimney at the ridge where the two rooflines meet.

5946 Augustine Avenue

This two-story, three bay, frame Folk Victorian has an unusual front gabled roof on the front half of the structure and a perpendicular gabled roof over the rear half. There is also a large addition on the rear of the original structure. The wide front gable is covered with decorative shingles and has a centered 2/2 arched window. The central entry on the first floor is glazed and paneled and flanked by one 2/2 window on each side. On the second story of the front façade, the central bay features an arched 2/2 window while the left bay features a bay window resting on the porch roof. A single story wrap around front porch spans the front façade and wraps around the north façade. Turned supports and balusters and decorative brackets adorn the porch. Stacked bay windows decorate the north façade and are capped by a tower roof that extends into the gable. The house is clad in vinyl siding and has an asphalt shingle roof that is pierced by two interior brick chimneys, one on each slope of the front gabled roof. The house is in excellent condition.

5936 Augustine Avenue

This two-story, five-bay, single pile, frame tri-gable also lacks a lot of Victorian inspired decoration. The materials on the house

Maryland Historical Trust

Maryland Inventory of Historic Properties Form

Inventory No. HO-803

Name Old Washington Road Survey District
Continuation Sheet

Number 7 Page 7

have been completely modernized with an asphalt shingle roof, vinyl siding, and replacement vinyl windows. The projecting cross gabled center bay has the central glazed and paneled entry on the first floor topped with a transom. There was originally an arched 2/2 window in the front gable and both side gables but the bottom halves of all three are now vents. The full-width front porch is supported by classical style posts on a solid balustrade. The house rests on a brick foundation and has one interior brick chimney. There is an interesting outbuilding located toward the rear of the lot. It is not easily visible from the street and looks abandoned. The small two-story frame building has a front gabled roof and must originally have had a porch on the front since there is a full size door on the second story. This building also has a brick chimney.

5920 Augustine Avenue

This two-story, five-bay, frame Folk Victorian is in excellent condition and retains some nice original details. The house is clad in cedar shakes painted yellow and rests on a brick foundation. Originally one room deep with a rear wing, a large two-story addition has been made to the south façade of the rear wing enlarging the house. A side gabled asphalt shingle roof shelters the front of the house and two small cross gables decorate the front façade. The cross gables have stick decoration and each contains a small arched one-light window. On the first floor, the paneled central entry is flanked by a sidelight. The windows on the front façade, four on the first floor and five on the second, are vertically aligned and all appear to be 1/1 double hung wood windows with exterior storm windows. The north and south end gables have the same details, stick decoration and windows, as the front cross gables. Stacked bay windows on the north façade extend into the gable. A single story wrap around front porch spans the front façade and wraps around the south side of the building. Classical style supports are connected by a metal balustrade. The house is in excellent condition. Two small gabled sheds/garages are located to the north of the house. The frame buildings are also clad in cedar shakes painted yellow.

5900 Augustine Avenue

This two-story, five-bay, frame house faces east on the southwest corner of Old Washington Road and Augustine Avenue and is in excellent condition. A side gabled asphalt shingle roof shelters the house which is covered with asbestos siding. The front façade is dominated by the projecting cross-gabled, central bay. The central cross gable has cornice returns and an arched 1/1 window. The end gables feature the same details. The central entry is glazed and paneled and topped with a transom. The fenestration has probably been altered on the first floor – there are now two large picture windows on either side of the door. On the second floor, five replacement windows were probably vertically aligned over the original first floor openings. A single story full width front porch has square supports and a metal balustrade. There is a one story, one room addition on the north end of the building. A small, frame, detached one-car garage is located to the south of the house.

Augustine Avenue continues on the north side of Washington Road. The northeast corner of the intersection of Augustine and Old Washington Road is occupied by St. Augustine's church and several associated school and meeting buildings. With the exception of the stone church, the school buildings are brick 1950's replacements of earlier frame buildings. There is one large old house next to the church, probably the rectory at one time, that has some nice late 19th century details. The church itself dates to the early 20th century and is a beautiful expansive stone building. St. Augustine's Church has occupied the site since at least the mid-19th century when it appears on the Martenet Map of 1860.

There are several ca. 1890 Folk Victorians on the east side of Augustine Avenue just north of the church complex and one more on the west side of the street. Most of the west side of the street is occupied by a series of 1940's and 1950's cottages. The streets Virlona Avenue and Claire Drive intersect Augustine Avenue north of the Folk Victorian dwellings and contain a variety of 1950's, 60's and 70's residential development.

Maryland Historical Trust

Maryland Inventory of Historic Properties Form

Inventory No. HO-803

Name Old Washington Road Survey District
Continuation Sheet

Number 7 Page 8

5805 Augustine Avenue

This two-story, frame Folk Victorian rests on a brick foundation facing west on the southeast corner of the intersection of Augustine Avenue and Virlona Avenue. The basic form is gable front and wing with a square tower in the ell and an additional wing on the north end and a parallel gabled section across the rear façade. The presence of 2/2 windows in the side and rear wings indicates that they may be original or very early additions. Most of the windows in the house are 2/2 double hung sash. The top of the tower and each of the gables contain arched 1/1 windows and the pyramid roof on the tower has flared eaves. The glazed and paneled entry is located in the base of the tower and has a transom and sidelights. A wrap around porch stretches across the gable front section and wraps around the south side to the tower. The porch is supported by classical style columns and has square balusters. The house is clad in vinyl siding, has an asphalt shingle roof, and is in excellent condition.

5815 Augustine Avenue

This two-story, five-bay, double pile, frame house rests on a stone foundation facing west on the east side of Augustine Avenue next door to house number 5805. It takes the same form as several other houses on the street with a side gabled roof and a projecting central cross gabled bay. The central glazed and paneled entry has a transom and sidelights and the three gables contain arched 1/1 windows but the other windows in the house are all vinyl replacements. A single story full width front porch spans the front façade and is supported by classical columns and has square balusters. The materials of the house have been modernized with vinyl siding and an asphalt shingle roof in addition to the replacement vinyl windows but the house is in excellent condition.

5820 Augustine Avenue

This two-story frame house sits well back from the west side of the road and actually faces south. The overall form of the house is gable front and wing with an additional wing on the rear. A large two-story addition has also been made to the rear of the house. The entire first story of the house has had a brick façade applied to it and the second story is clad in aluminum siding. The original portion of the house has a standing seam metal roof. A wrap around front porch has classical style columns and a flat, sawn balustrade. The second story of the gable front section is actually a three sided bay window that rests on the front porch roof. Most of the visible windows appear to be 1/1 double hung wood sash and some of the upper sash contain stained glass. The house is in excellent condition.

5839 Augustine Avenue

This two-story, five-bay, single pile, frame house rests on a brick foundation facing west close to the east side of the road just north of church school building. It is similar in form to house number 5815, two houses to the north. The side gabled roof has a central cross gable on the front façade and a cross gabled two story rear wing on the rear façade. The central entry is glazed and paneled with a transom and sidelights and the windows in the house appear to be 1/1 double hung wood sash. The central cross gable has a square one-light window and patterned shingles. The end gables also feature patterned wood shingles. The entire house is clad in unpainted cedar shakes and has an asphalt shingle roof. A full width single story front porch has classical style columns on a solid balustrade. The south side façade of the house features a two story projecting bay with a hipped roof. The house is in very good condition.

Additional buildings in the district from this time period:

5923 Old Washington Road – Two story frame dwelling with a steep side gabled roof with large shed dormers on both the front and back slopes. Some 2/2 wood windows. Looks like a late 19th century building with multiple additions and alterations.

Maryland Historical Trust

Maryland Inventory of Historic Properties Form

Inventory No. HO-803

Name Old Washington Road Survey District
Continuation Sheet

Number 7 Page 9

6298 Old Washington Road – Two story frame house, some Victorian details on part of the front porch, several 2/2 wood windows. On the northeast corner of the intersection of Old Washington Road and Montgomery Road. In poor/altered condition. 2/2 windows suggest a late 19th century date but the original form of the building is a mystery.

6308 Old Washington Road – Two story frame house, 3 bay front façade, side gabled roof, single pile with a rear two story cross gabled wing. Covered with asbestos siding, all replacement windows, one interior brick stovepipe chimney. Ca. 1890.

1900-1925

6134 Old Washington Road

This large, two-story, frame, gable front and wing house rests on a brick foundation facing south on the north side of the road. The five-bay front façade (two in the gable front section and three in the wing) features a central glazed and paneled entry capped with a transom. The windows in the house are all replacements except for a small arched window in the front facing gable. The house is clad in aluminum siding and has an asphalt shingle roof. A wide wrap around porch wraps around the east façade supported by plain square posts. It has no balustrade. One interior brick chimney has a decorative peaked top. The house probably dates to ca. 1900.

6098 Old Washington Road

This two-story frame Colonial Revival is in excellent condition. The house is three bays wide and topped with a slate, side gabled roof. It faces south on the north side of the road. The central entry with transom and sidelights is sheltered by a classical style pedimented portico. The large windows are all vinyl replacements and the walls are clad in vinyl siding. An exterior brick end chimney on the east facade of the house is flanked by quarter fan lights in the gable. The house has one story wings on both the east and west facades; the one on the west façade may be an original enclosed porch. The house is in excellent condition and probably dates to ca. 1920.

6108 Old Washington Road

This bungalow faces south on the north side of the road across the street from the old high school. The one story structure is constructed of rusticated concrete block and capped with a hipped roof. Three hipped roof dormers, one each on the south, east and west slopes of the roof, belie the existence of living space in the attic. The three bay front façade has a central entry and a full width front porch with classical half-columns on rusticated concrete block piers and a lattice balustrade. One interior brick chimney pierces the asphalt shingle roof. All of the windows are vinyl replacements. The house is in excellent condition and probably dates to ca. 1920.

6112 Old Washington Road

This is the second in a series of three bungalows built in a row across the street from the old high school. This one is one story with a useable attic and has a side gabled roof. The frame house rests on a rusticated concrete block foundation and is covered with cedar shakes. The front façade is four bays wide and has a full width front porch with classical half-columns on a solid balustrade. A shed-roofed dormer on the front slope of the roof has two full size windows and the east façade is decorated with a bay window. All of the windows in the house are vinyl replacements. A single story addition on the west façade of the house incorporates a one-car garage in the basement level. One interior brick chimney pierces the asphalt shingle roof. This house is in

Maryland Historical Trust

Maryland Inventory of Historic Properties Form

Inventory No. HO-803

Name Old Washington Road Survey District
Continuation Sheet

Number 7 Page 10

excellent condition and probably dates to ca. 1920.

6135 Old Washington Road

This three story, flat roofed brick building is the old Elkridge High School constructed ca. 1923. Now home to a private school, the building was heavily altered in the mid-20th century. The front of the building used to front on Old Washington Road but an addition has been made to the south façade and that has become the front of the building. Thirty windows and two entrances stretch across the original front façade. The windows are all vertically aligned and are the same size on all three floors but all are replacements. Neighbors report that almost all of the windows were bricked up by the school board 30 years ago. One of the two entrances retains its elaborate Colonial Revival surround – by far the most significant remaining architectural element of the building. The original door itself has been replaced with a flush metal door. The building is laid in running brick bond and has a corbelled brick cornice and the suggestion of a belt course and a water table. A large, low one story addition was made to the east façade of the building. In spite of the alterations it has endured, the building is still very recognizable as a school done in the Colonial Revival style and an important landmark to the community.

6122 Old Washington Road

Neighbors report that this large and much-altered building was an elementary school in the first part of the 20th century. It is directly across the street from the old high school and some neighbors claim that this building housed all of the school children, elementary and high schoolers, before the large two story brick building across the street was completed. This building is smaller than the high school and seems to have been built in several stages, but it also appears to have been altered extensively when it was converted into apartments. The exterior is now vinyl siding and stone, perhaps a façade only, and all of the windows are replacements. It probably dates to the 1910's or 20's.

6130 Old Washington Road

Perched on a small hill facing south across the street from the old high school, this one story bungalow rests on a rusticated concrete block foundation and has a stuccoed masonry exterior. The side gabled roof is pierced by two gabled dormers, each holding an 8 by 8 light casement window. The three bay front façade has a glazed central entry and paired windows on either side. A porch with classical supports and square balusters spans the front façade. A gable front wing is located on the east end of the house and it seems likely that it is original to the building. Four vinyl replacement windows run across the front of the wing and a four light wood window is located in the gable. There is a separate entrance in the basement level of the wing which is built into the hill. A four light window is located in the west gable of the house and bracketed eaves are characteristic of the bungalow style. The house is in good condition and probably dates to ca. 1925.

6399 Old Washington Road

This interesting small frame building is at the extreme western edge of the district and faces north at the point where Route 1 and Old Washington Road split. It rests on a rusticated concrete block foundation and has a flat or very low pitched shed roof. The roof has cornice brackets on at least the front and the two side facades and also has exposed rafter tails on those three facades. The front (north) façade has a central entry flanked by a large window on either side. The windows consist of multiple panes in the upper sash over one large pane in the lower sash and are made of wood. A full width front porch spans the front façade and has chamfered posts and an interesting stick-work balustrade. A small one-story frame addition with a side gabled roof is located on the rear of the structure. The small size of the building, combined with the large front windows, central entry and flat roof suggest that it may have been used as a store originally. It is now a private dwelling and is in fair condition. It is surrounded by industrial

Maryland Historical Trust

Maryland Inventory of Historic Properties Form

Inventory No. HO-803

Name Old Washington Road Survey District

Continuation Sheet

Number 7 Page 11

and commercial development, however, and is certainly one of the more endangered buildings in the district. The rusticated concrete block foundation, combined with the stylistic details, suggests a date of around 1920.

6289 Old Washington Road

This large, two-story, frame house sits back from the south side of the old Turnpike facing north on a large lot. The Neoclassical style house rests on a rusticated concrete block foundation and has a side gabled slate roof. A hipped roof dormer adorns the front slope of the roof. The four bay front (north) façade features an entry in the far left bay with a transom and sidelights. Stacked bay windows decorate the west façade. All of the windows in the house are replacements. A full width front porch features Ionic columns on rusticated concrete block supports. The Neoclassical style and the rusticated concrete block foundation indicate a ca. 1920 date.

Additional buildings in the district from this time period:

5922 Old Washington Road – One story frame bungalow/cottage.

5932 Old Washington Road – One story frame bungalow with shed roofed dormer.

5944 Old Washington Road – One and a half story frame bungalow with shed roofed dormers and cedar shake siding.

5950 Old Washington Road – Two story frame Colonial Revival dwelling, shake exterior, full width front porch with classical details.

5962 Old Washington Road – Craftsman bungalow with shake exterior and 6/6 windows.

5856 Augustine Avenue – One story gable front and wing cottage, ca. 1910.

6193 Old Washington Road – One story frame bungalow/cottage, neighbors claim that part of this building was the old jail.

6365 Old Washington Road – Two story frame house with a hipped roof. Tall and narrow with the short side of the house, only two bays wide, facing the street. One hipped roof dormer, front porch, replacement windows.

1926-1953

Between 1926 and 1953, residential development in the district mirrored that in the rest of the county in the form of small subdivisions of modest sized bungalows, cottages, ranchers, and Cape Cod's. These types of houses occur individually throughout the district as older, larger lots were subdivided and they occur in several small concentrations on the edges of the district. Those houses at the eastern edge of the district on the bend of Old Washington Road where it leaves its original path to join with Route 1 are one example, as are the bungalows that line both sides of Montgomery Road between Old Washington Road and Route 1, and all of the small cottages on Downs Avenue near the western edge of the district, a subdivision dating to right round 1950. The economic depression of the 1930's encouraged minimalist architecture on a small scale in order to keep housing at an affordable level for most people. Following the end of World War II in the mid 1940's, the boom in housing construction, particularly in new subdivisions dependent on the automobile, resulted in large numbers of modest minimalist cottages and ranchers being built to house the returning troops and their young families. The following buildings fall within the boundaries of this district and represent the area's continued growth and expansion as a commuter suburb between 1926 and 1953.

5938 Old Washington Road – One story cottage has a side gabled roof and exhibits Tudor influences in the exterior stone chimney on the front façade. Wall cladding is Formstone.

5952 Old Washington Road – One story frame house, three bay front façade, roof dormers, vinyl siding.

5954 Old Washington Road – Cape Cod with slate roof and roof dormers.

5832, 5838, 5844 and 5848 Augustine Avenue – All one story minimalist cottages built at the same time on adjoining small lots, ca. 1948.

Maryland Inventory of
Historic Properties Form

Name Old Washington Road Survey District
Continuation Sheet

Number 7 Page 12

-
- 6010 Old Washington Road – One story rancher showing Tudor influences in the use of stone on part of the front façade.
6018 Old Washington Road – One and a half story frame Cape Cod with roof dormers, a bay window, and an applied stone façade on the first story.
6151 Old Washington Road – One and a half story brick Cape Cod.
6159 Old Washington Road – One and a half story brick Cape Cod with one large gabled dormer and a classical style entry portico. There is an attached one story brick store with a flat parapeted roof on the east side of the house that is now used as an apartment. This store front has large windows flanking a central entry.
6189 Old Washington Road – One and a half story stone Cape Cod.
6220 Old Washington Road – One story minimalist cottage with asbestos siding.
6221 Old Washington Road – One and a half story brick Cape Cod.
6232 Old Washington Road – One story cinder block rancher.
6241 Old Washington Road – One and a half story frame Cape Cod.
6283 Old Washington Road – One and a half story frame Cape Cod.
6319 Old Washington Road – One and a half story frame cottage with asbestos siding.
6330 Old Washington Road – One and a half story frame Cape Cod.
6334 Old Washington Road – One and a half story frame Cape Cod.
6357 Old Washington Road – One story minimalist cottage with a partial brick façade.
Downs Avenue subdivision – Small minimalist ranchers and cottages on small lots.
7000 block of Montgomery Road – One and one and a half story bungalows and Cape Cods that all look alike and were all constructed at the same time, ca. 1945. Some rusticated concrete block foundations, asbestos siding.

ALTERED HISTORIC BUILDINGS WHICH CANNOT BE DATED

These buildings have been altered to such a degree that no date can accurately be assigned to them but some piece of evidence (a stone foundation, for instance) indicates that the building does have an historic core.

- 6042 Old Washington Road
6045 Old Washington Road
6200 Old Washington Road
6263 Old Washington Road
6286 Old Washington Road
6288 Old Washington Road
6297 Old Washington Road

NON-CONTRIBUTING BUILDINGS (CONSTRUCTED POST 1953)

- 5826 Augustine Avenue
5823 Augustine Avenue
6043 Old Washington Road
6047 Old Washington Road
6188 Old Washington Road
6201 Old Washington Road
6203 Old Washington Road
6205 Old Washington Road
6242 Old Washington Road

Maryland Historical Trust
Maryland Inventory of
Historic Properties Form

Inventory No. HO-803

Name Old Washington Road Survey District
Continuation Sheet

Number 7 Page 13

6250 Old Washington Road
6259 Old Washington Road
6258 Old Washington Road
6264 Old Washington Road
6271 Old Washington Road
6294 Old Washington Road
6293 Old Washington Road
6309 Old Washington Road
6371 Old Washington Road
6379 Old Washington Road
6326 Old Washington Road

8. Significance

Inventory No. HO-803

Period	Areas of Significance	Check and justify below		
<input type="checkbox"/> 1600-1699	<input type="checkbox"/> agriculture	<input type="checkbox"/> economics	<input type="checkbox"/> health/medicine	<input type="checkbox"/> performing arts
<input type="checkbox"/> 1700-1799	<input type="checkbox"/> archeology	<input type="checkbox"/> education	<input type="checkbox"/> industry	<input type="checkbox"/> philosophy
<input checked="" type="checkbox"/> 1800-1899	<input checked="" type="checkbox"/> architecture	<input type="checkbox"/> engineering	<input type="checkbox"/> invention	<input type="checkbox"/> politics/government
<input checked="" type="checkbox"/> 1900-1999	<input type="checkbox"/> art	<input type="checkbox"/> entertainment/ recreation	<input type="checkbox"/> landscape architecture	<input type="checkbox"/> religion
<input type="checkbox"/> 2000-	<input type="checkbox"/> commerce	<input type="checkbox"/> ethnic heritage	<input type="checkbox"/> law	<input type="checkbox"/> science
	<input type="checkbox"/> communications	<input type="checkbox"/> exploration/ settlement	<input type="checkbox"/> literature	<input type="checkbox"/> social history
	<input checked="" type="checkbox"/> community planning		<input type="checkbox"/> maritime industry	<input type="checkbox"/> transportation
	<input type="checkbox"/> conservation		<input type="checkbox"/> military	<input type="checkbox"/> other:
Specific dates	1817-1953	Architect/Builder	multiple	
Construction dates	1850-1953			

Evaluation for:

National Register Maryland Register not evaluated

Prepare a one-paragraph summary statement of significance addressing applicable criteria, followed by a narrative discussion of the history of the resource and its context. (For compliance reports, complete evaluation on a DOE Form - see manual.)

The Old Washington Road Survey District is significant under criteria a and c for its association with broad patterns in American history and its vernacular architecture ranging in date from 1850 to 1953. This district is located immediately to the west of the historic settlement of Elkridge Landing and their histories are intimately connected. This District derives its primary significance from its role as a commuter suburb related first to the railroad and later to the automobile. It also contains a good collection of vernacular architecture, mostly domestic, exhibiting the stylistic trends of 100 years of building.

Old Washington Road itself used to be the Washington Turnpike, a major transportation route established in 1817. The settlement of Elkridge Landing dates back to the early 18th century, though the portion of the town standing today dates no earlier than 1800. Elkridge Landing was first an important tobacco and grain shipping port in the early to mid-18th century and then a center of the iron industry with the establishment of the Elkridge Furnace in the 1750's. By 1800 the river had silted up putting an end to the shipping traffic and deforestation and perhaps a drop in demand following the Revolutionary War had put a temporary halt to the iron industry at Elkridge. But two new developments in town provided Elkridge Landing with new potential as a transportation hub. The Washington Turnpike, a gravel surfaced toll road, was chartered in 1817 and passed through Elkridge down what is now Old Washington Road and Main Street. The rapid growth in railroads up and down the east coast in the 1830's and 1840's led to an increased demand for iron and the Elkridge Furnace was rebuilt and put back into operation by the Ellicott family in 1826. The Washington link of the B and O Railroad was completed through the middle of Elkridge in 1835. The Thomas Viaduct, a multi-arched bridge constructed of granite, was no small feat in engineering and carried the railroad over the Patapsco River to Relay, just upstream from Elkridge on the Baltimore County side of the river.

Elkridge's situation at the confluence of these two important transportation routes certainly led to her prosperity and growth during the mid-19th century. An inset of Elkridge Landing on the 1860 Martenet Map shows a concentration of houses, and businesses and several churches along the turnpike (Main Street) near the railroad, and additional businesses are found further west along the Turnpike. Shown on the 1860 map in what is now the Old Washington Road Survey District are a wheelwright, a blacksmith, a hotel, several stores and a school. Between 1850 and 1880 Elkridge experienced a construction boom related to the railroad in large part because the increased ease of commuting via rail made it possible for people to live further from the places they worked. At the same time, the rising trend in suburban living also extolled the virtues of semi-rural, small town living over the dirty corrupting forces found in city living. Continued advances in building technology made houses cheaper and faster to build and therefore more affordable for a wider range of the middle class. All of these factors led to increased development in planned subdivisions as well as places like Elkridge where existing lots were subdivided for new dwellings. Baltimore and Washington both were booming cities in the mid-19th century and it became increasingly common, especially towards the end of the 19th century, for people to commute into Baltimore by train for work and for school. The Elkridge station on the railroad was completed in 1875 and was located at the junction of the Turnpike and the railroad. The 1878 Hopkins Map of Howard County shows a well-populated settlement at Elkridge Landing. The inset showing the center of town in greater detail ends at the point where today Main

Maryland Historical Trust

Maryland Inventory of Historic Properties Form

Inventory No HO-803

Name Old Washington Road Survey District

Continuation Sheet

Number 8 Page 1

Street becomes Old Washington Road. But the development continues west along the Turnpike, and the area between St. Augustine's Church and the Old Montgomery Road intersection, which today makes up the bulk of the Old Washington Road Survey District, is almost as heavily developed with roadside houses and stores as the center of town is in 1878.

The Old Washington Road Survey District derives its primary significance from its roll as a commuter suburb, related first to the railroad and the turnpike and later to the automobile and Route 1. Unlike in the heart of Elkrige where many of the buildings shown on the 1878 map can still be identified today, very few of the buildings shown along Old Washington Road in 1878 still exist. Several do, of course, but what is far more noticeable about this corridor is the amount of redevelopment that has occurred over the years and continues today. This stretch of road between Route 1 and Main Street shows the continued evolution of suburban development from the Folk Victorians of the late 19th century through the Cape Cods of the 1940's and 50's.

1850-1874

The earliest buildings identified in the survey date to ca. 1850. Since the Turnpike was first constructed in 1817, there are approximately 33 years of history no longer accounted for in the remaining built landscape. In addition, there are many buildings on the 1860 map that related directly to the roads importance as a thoroughfare for travelers and consumers, including the hotel and most of the shops and stores, which are no longer standing. Only 7 buildings remain that date to between 1850 and 1874 and today all are private dwellings. Of these, one was a one-room schoolhouse (HO-806) and one was originally a combined shop and dwelling (HO-804, George Hobbs House and Store) while the rest were originally constructed for solely residential purposes. These buildings all sit close to the edge of the road and remaining original decorative details include wood finials on the peaks of the gables and decorative vergeboards.

1875-1899

Buildings dating between 1875 and 1899 currently make the biggest visual impact on the district. They are all residential in character, two stories in height, and exhibit a variety of decorative details common to the Folk Victorian style. For the most part they are in very good condition and retain many of their original details.

All of these buildings are directly related to the old turnpike's transformation from thoroughfare to commuter suburb. The construction of the Elkrige station on the railroad occurred in 1875 so this area immediately became more accessible for those working in Baltimore and Washington. By 1875, the suburbanization movement in America was in full swing, inspiring a yearning in middle class America for single family homes in parklike settings away from the noise, pollution and crime of the cities. At the same time, advances in building technology, including the increasingly widespread use of the balloon frame and the mechanized manufacture of a variety of decorative details, combined with the popularity of pattern books in planning a house's form and style, resulted in houses that were cheaper and faster to build and therefore accessible for a wider population of middle class Americans. These suburban dwellings also had a feeling of homogeneity about them since earlier vernacular forms were often set aside in favor of the popular styles and forms published in pattern books and magazines. What is interesting, especially along Old Washington Road where these houses were not built by one builder as part of a planned community but one at a time for individual owners, is how the buildings are similar in form but have an individuality in their use of decorative details. The collection of dwellings along Augustine Avenue, particularly the portion south of Old Washington Road, is a particularly good example of Folk Victorian suburban construction where all of the dwellings were built at the same time on identical lots yet none of the buildings look the same.

1900-1925

Maryland Historical Trust

Maryland Inventory of Historic Properties Form

Inventory No HO-803

Name Old Washington Road Survey District

Continuation Sheet

Number 8 Page 2

Between 1900 and 1925, the Old Washington Road corridor continued to grow as a commuter suburb. The architecture of this period is more modest than the previous quarter century with more one story bungalows and cottages interspersed among older, larger dwellings. It is significant that the houses built during this period are so much more modest compared to the large Folk Victorians of the 1890's and must indicate that the income level of those moving to Elkridge had declined. By the 1920's, the railroad had given way to the automobile as the dominant mode of transportation, particularly for the upper and middle classes who could afford the new cars. Those with cars were no longer restricted to neighborhoods close to a railroad line and instead new automobile suburbs were planned on farms and fields on the outskirts of big cities and small towns. Therefore, those commuters who were still dependent on the railroad for transportation and from work probably had lower incomes and needed smaller, more modest houses. It was this class of people who were still interested in Elkridge's proximity to the railroad and found the Old Washington Road corridor a desirable suburban area.

Two major additions to the district during this time were the large schools on Old Washington Road in the middle of the district. They were probably built around the same time, the smaller for elementary schoolers and the larger brick building as a middle and high school around 1920. The old frame one room school house near the intersection of Old Washington Road and Old Montgomery Road was sold by the school district and no longer in use as a school by 1912, so it is possible that the smaller of the buildings at 6122 Old Washington Road was built around 1910 and housed all of Elkridge's school children before the large brick building across the street was completed 10 years later. The large brick school has undergone many changes over the years but is an important anchor for the community. Now a private school, the building retains one highly significant architectural detail – the elaborate Colonial Revival architrave surrounding one of the exterior doors on the north façade.

1926-1953

The period between 1926 and 1953 was marked by two major events in United States history - the Depression and World War II. The architectural growth and development of the Old Washington Road Survey District mirrored that of the rest of the country. The economic depression of the 1930's encouraged minimalist architecture on a small scale in order to keep housing affordable for more people. The housing boom following the end of World War II in the mid 1940's resulted in large numbers of minimalist cottages and ranchers in automobile subdivisions constructed to house returning troops and their young families. Several clusters of these types of houses are evident in the District and others are interspersed along Old Washington Road on small, subdivided lots.

On a very local level, the construction of Route 1 just to the north of Old Washington Road around 1930 diverted commercial traffic away from the old Turnpike and Elkridge's main street. This further encouraged the ongoing residential development on Old Washington Road and actually helped preserve the 19th century domestic architecture that remained.

The Old Washington Road corridor's evolution as a commuter suburb did not stop in 1953 and in fact it continues today at a frantic pace. However, now that most available land along the road is built out, developers and investors are tearing down some of the old, historic buildings in order to further subdivide the lot and squeeze in several new houses. Ironically, the historic character of Old Washington Road, and really Elkridge as a whole, is threatened by the very factors that lent it growth and prosperity in the mid-19th century – a desirable location close to important transportation routes and suburbanization.

The boundaries of the Old Washington Road Survey District were difficult to define. Since the significance of the district lies in its evolving role as a commuter suburb, it was difficult to determine which side roads should be included and which should not since the suburban development naturally spread outward from the old Turnpike. Ultimately, it was decided to focus on those properties that fronted on Old Washington Road with a few exceptions for early and intact examples of wholesale subdivisions including Augustine Avenue, Montgomery Road between Route 1 and Old Washington Road, and Downs Avenue. The period of significance for the District is defined as 1817-1953 because the Turnpike was chartered and laid out in 1817 and 1953 is the

Maryland Historical Trust

Maryland Inventory of Historic Properties Form

Inventory No HO-803

Name Old Washington Road Survey District

Continuation Sheet

Number 8 Page 3

current 50-year cutoff for historic properties. However, the earliest buildings currently standing in the district date to ca. 1850 meaning that there is a 30-year gap in the historic landscape.

As an example of a continually evolving commuter suburb, the Old Washington Road Survey District is largely intact, but many of the older properties in the district are under threat of further subdivision involving demolition of the historic buildings and as the area continues to grow and evolve, development pressure will continue to be an issue. Most of the properties in the district are in good condition but some of the 19th century buildings have been allowed to decay making them even more vulnerable to teardown and redevelopment.

9. Major Bibliographical References

Inventory No. HO-803

See continuation sheet.

10. Geographical Data

Acreage of surveyed property 80

Acreage of historical setting 80+

Quadrangle name Relay

Quadrangle scale 1:24000

Verbal boundary description and justification

Tax map 38, multiple parcels. See attached tax map enlargements for parcels, addresses, and exact district boundaries.

11. Form Prepared By

name/title	Kristin Hill, Historic Sites Surveyor		
organization	Howard County Department of Planning and Zoning	date	11/24/03
street and number	3430 Court House Drive	telephone	410-313-4335
city or town	Ellicott City	state MD	zip code 21043

The Maryland Inventory of Historic Properties was officially created by an Act of the Maryland Legislature to be found in the Annotated Code of Maryland, Article 41, Section 181 KA, 1974 supplement.

The survey and inventory are being prepared for information and record purposes only and do not constitute any infringement of individual property rights.

return to: Maryland Historical Trust
DHCD/DHCP
100 Community Place
Crownsville MD 21032
410-514-7600

Maryland Historical Trust

Maryland Inventory of Historic Properties Form

Inventory No. HO-803

Name Old Washington Road Survey District

Continuation Sheet

Number 9 Page 1

Ames, David L., and Linda Flint McClelland. NATIONAL REGISTER BULLETIN: HISTORIC RESIDENTIAL SUBURBS. National Park Service, 2002.

Elkridge Bicentennial Committee. ELKRIDGE: A BICENTENNIAL JOURNAL. Peggy Ford, chairman and Nellie Arrington, editor. (Elkridge Bicentennial Committee, 1976).

Fuchs, Ronald W., II. "'At Elkridge Furneis As You See, William Williams He Mad Me:' The Story of an Eighteenth-Century Maryland Iron Furnace." JOURNAL OF EARLY SOUTHERN DECORATIVE ARTS, Winter 1996, Vol. XXII, No. 2.

Hopkins, G.M. ATLAS OF HOWARD COUNTY, MARYLAND, 1878. (Ellicott City, Maryland: Howard County Bicentennial Commission, Inc., 1975).

Martenet, Simon J. MARTENET'S MAP OF HOWARD COUNTY, MARYLAND. (Baltimore, 1860.)

Sharp, Henry K. THE PATAPSCO RIVER VALLEY: CRADLE OF THE INDUSTRIAL REVOLUTION IN MARYLAND. (Baltimore: Maryland Historical Society, 2001).

Travers, Paul J. THE PATAPSCO: BALTIMORE'S RIVER OF HISTORY. (Centerville, MD: Tidewater Publishers, 1990).



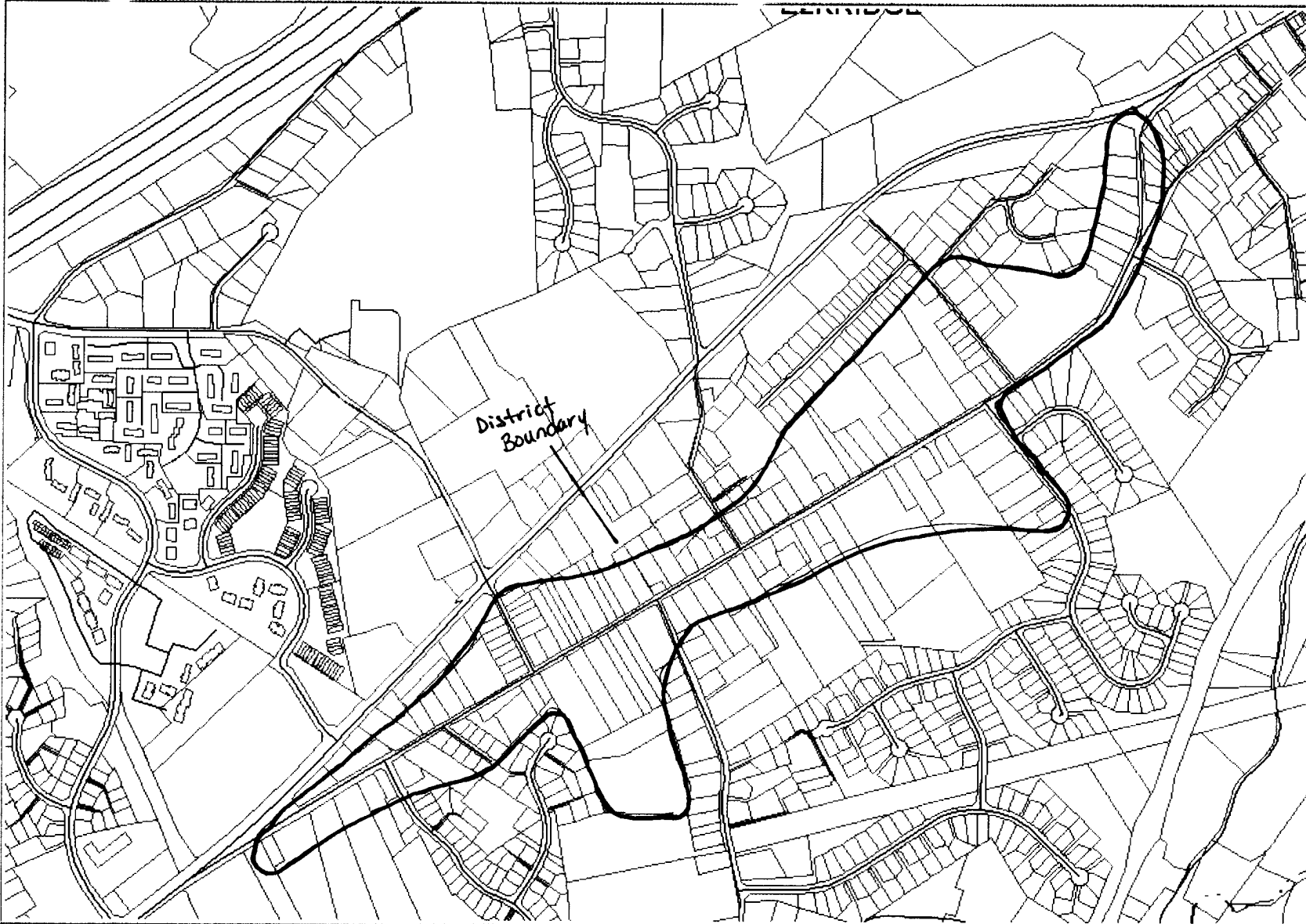

Voris, Helen P. ELKRIDGE: WHERE IT ALL BEGAN. (Elkridge, 2000).



HCAS
Howard County

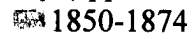

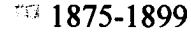
Key (applies to the next five maps):

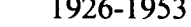
- | | |
|---|---|
|  1850-1874 |  unknown date,
historic |
|  1875-1899 |  non-contributing |
|  1900-1925 | 1234 property address |
|  1926-1953 | |

HO-803
Old Washington Road Survey District
Elkrige, Howard County, Maryland
First in a series of five maps

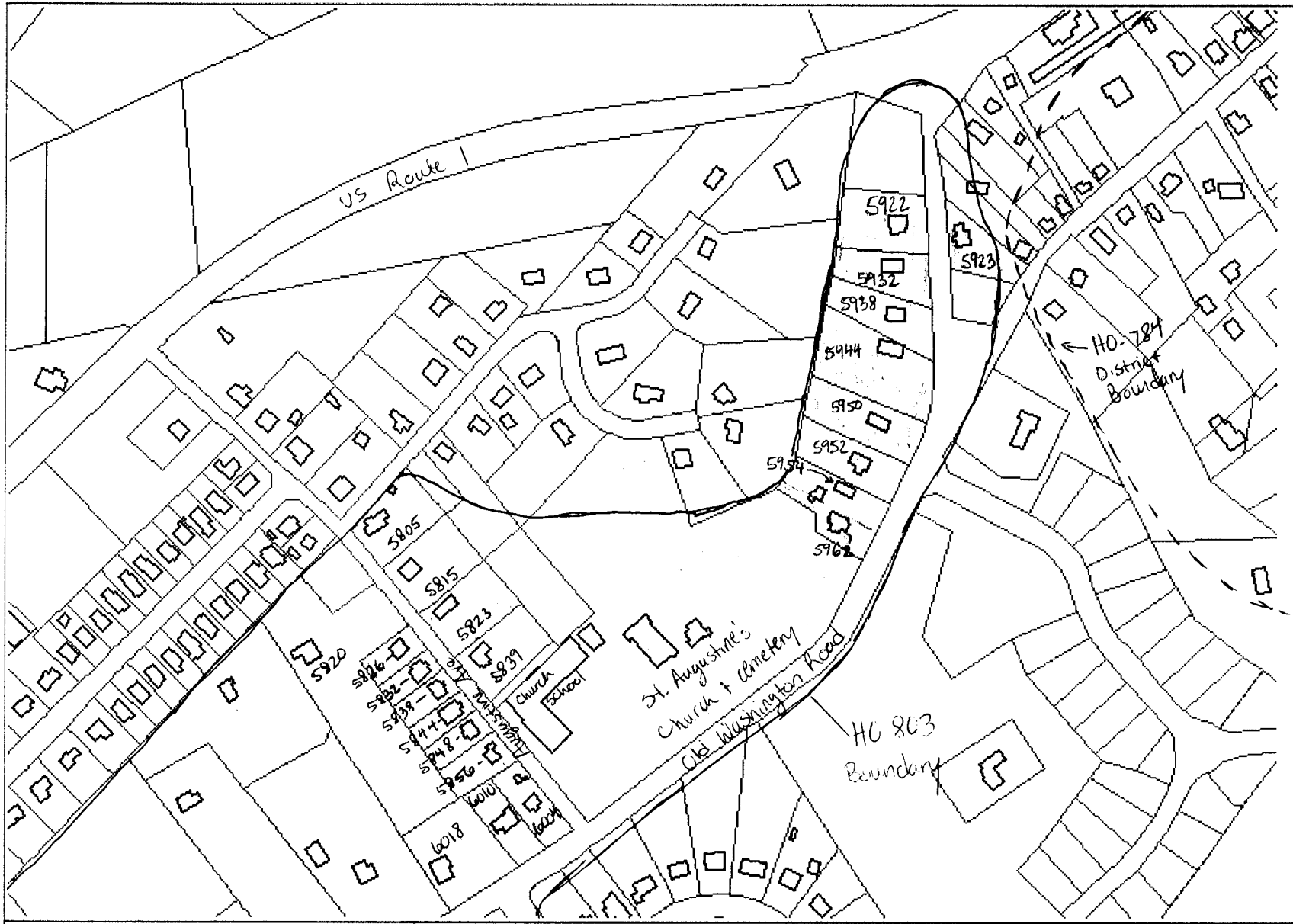

Second in a series of five

50-803

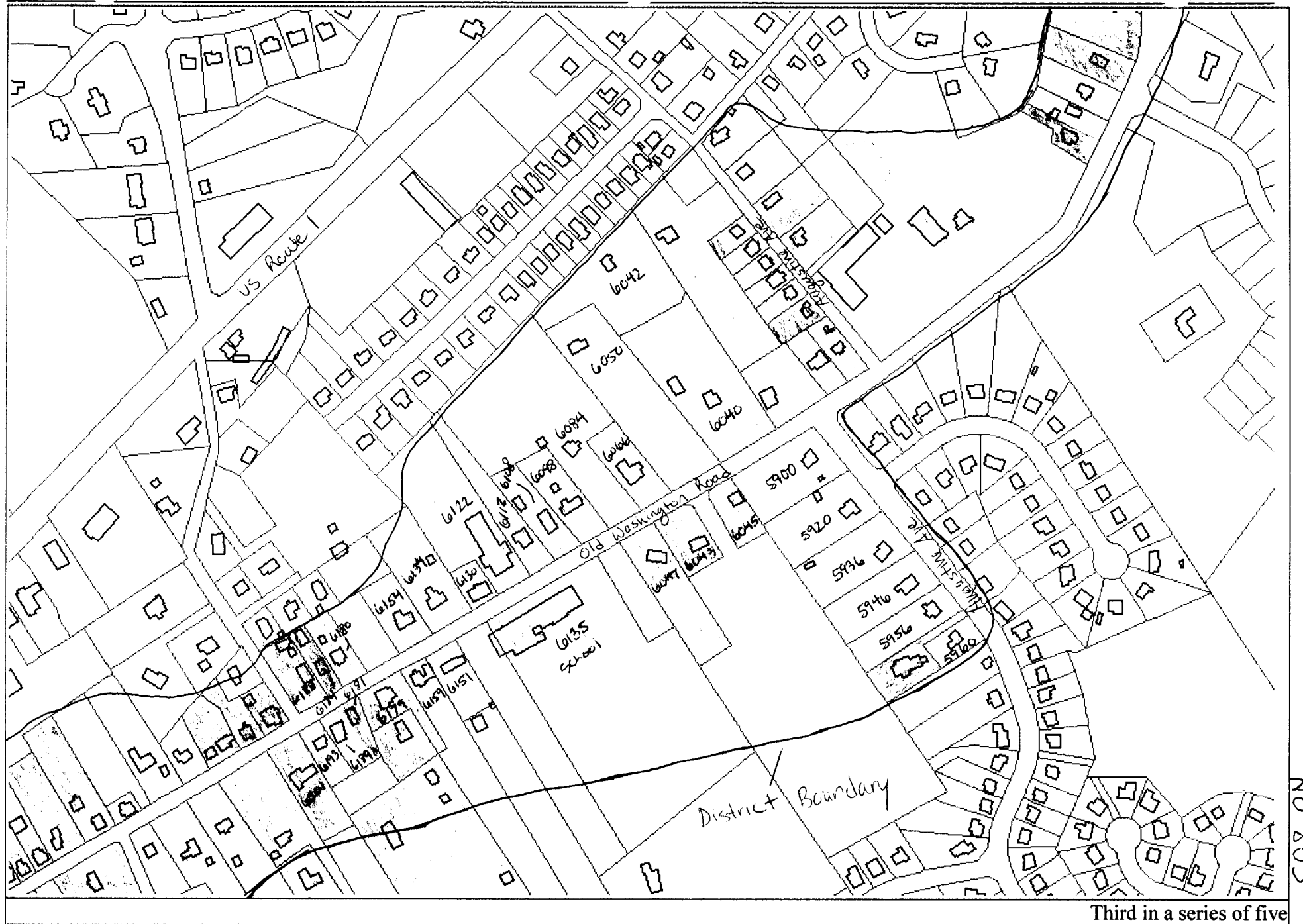

NO-803



NO-803

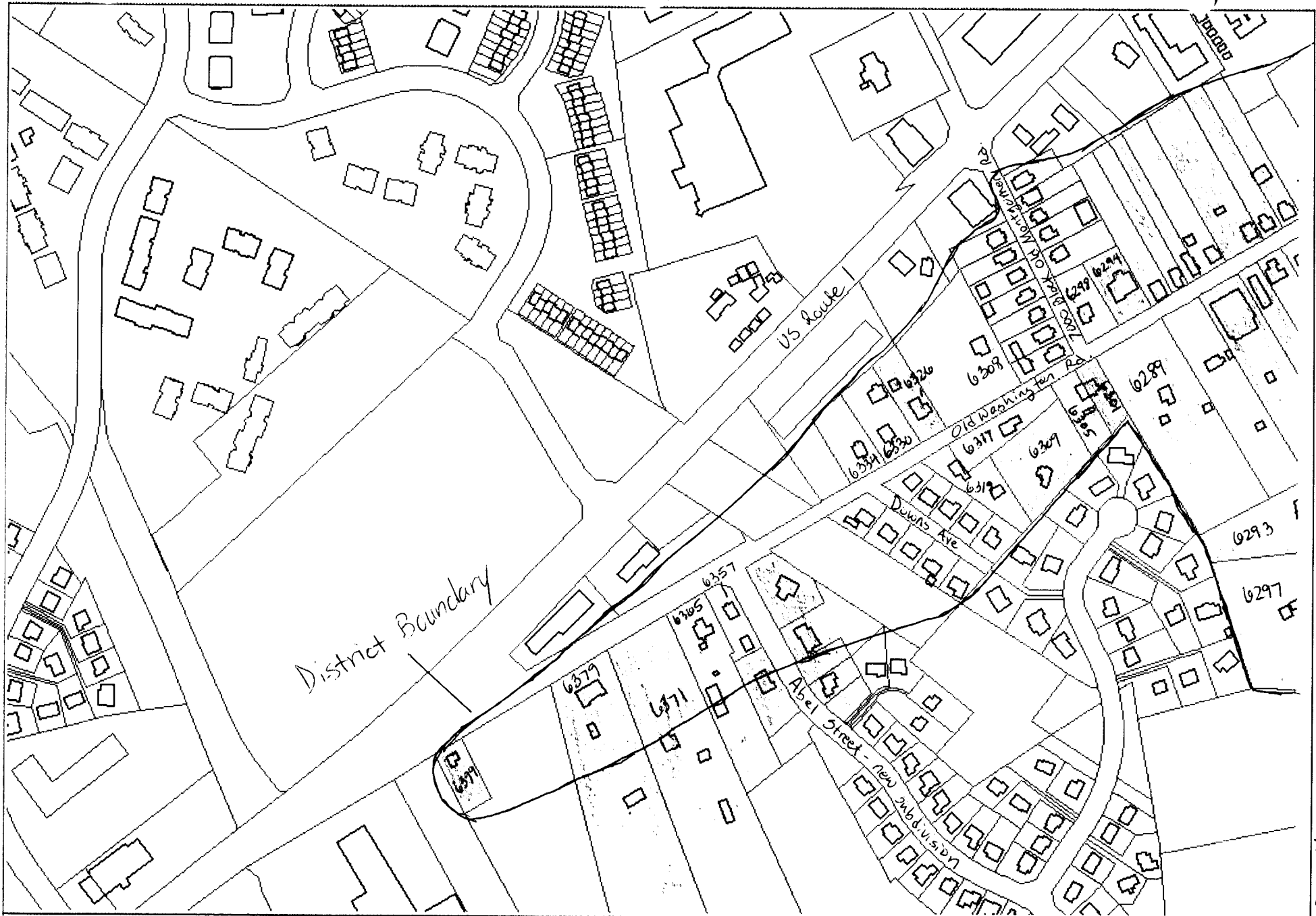

110-803

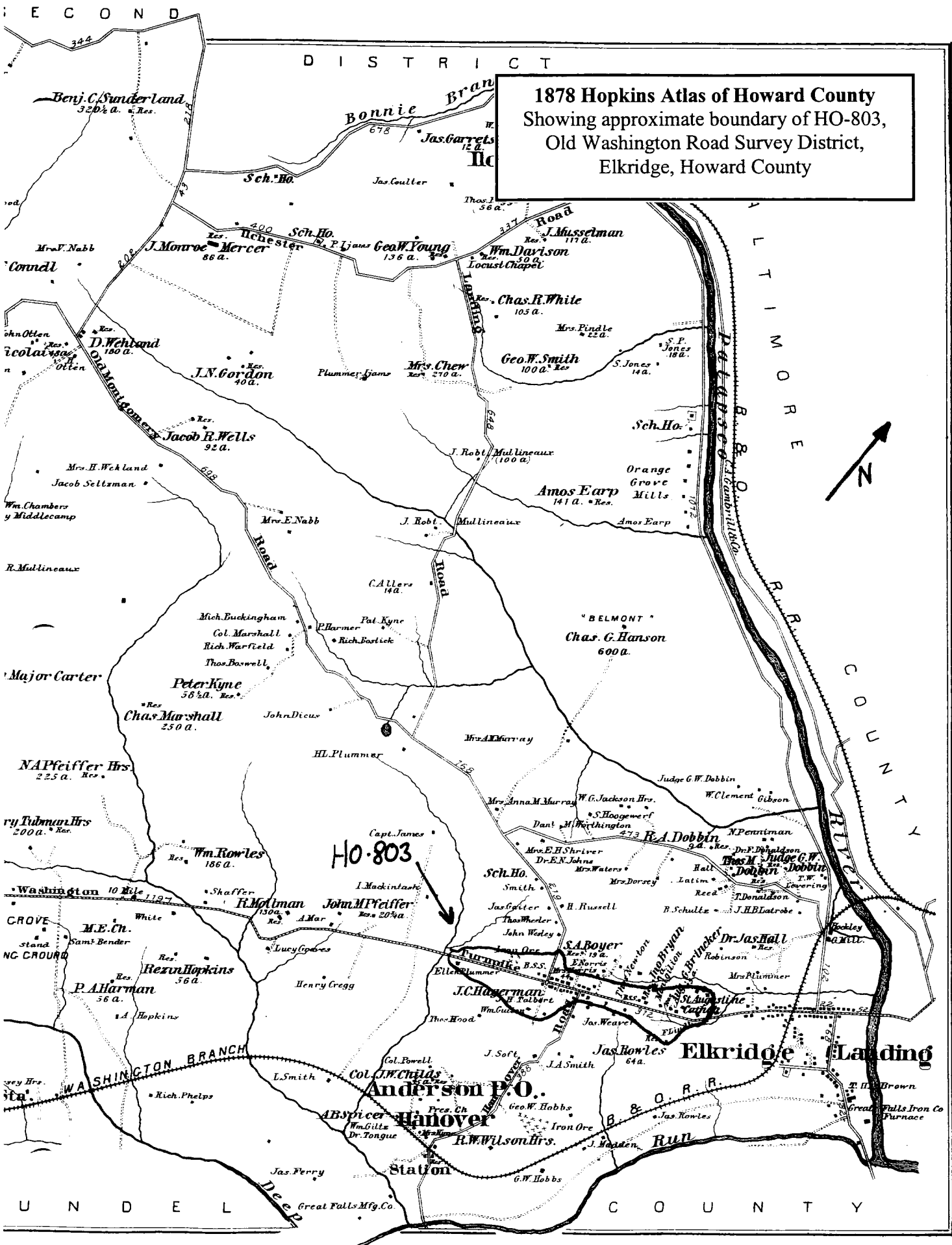

1878 Hopkins Atlas of Howard County
 Showing approximate boundary of HO-803,
 Old Washington Road Survey District,
 Elkridge, Howard County

HO-803

Anderson P.O.

Elkridge Landing

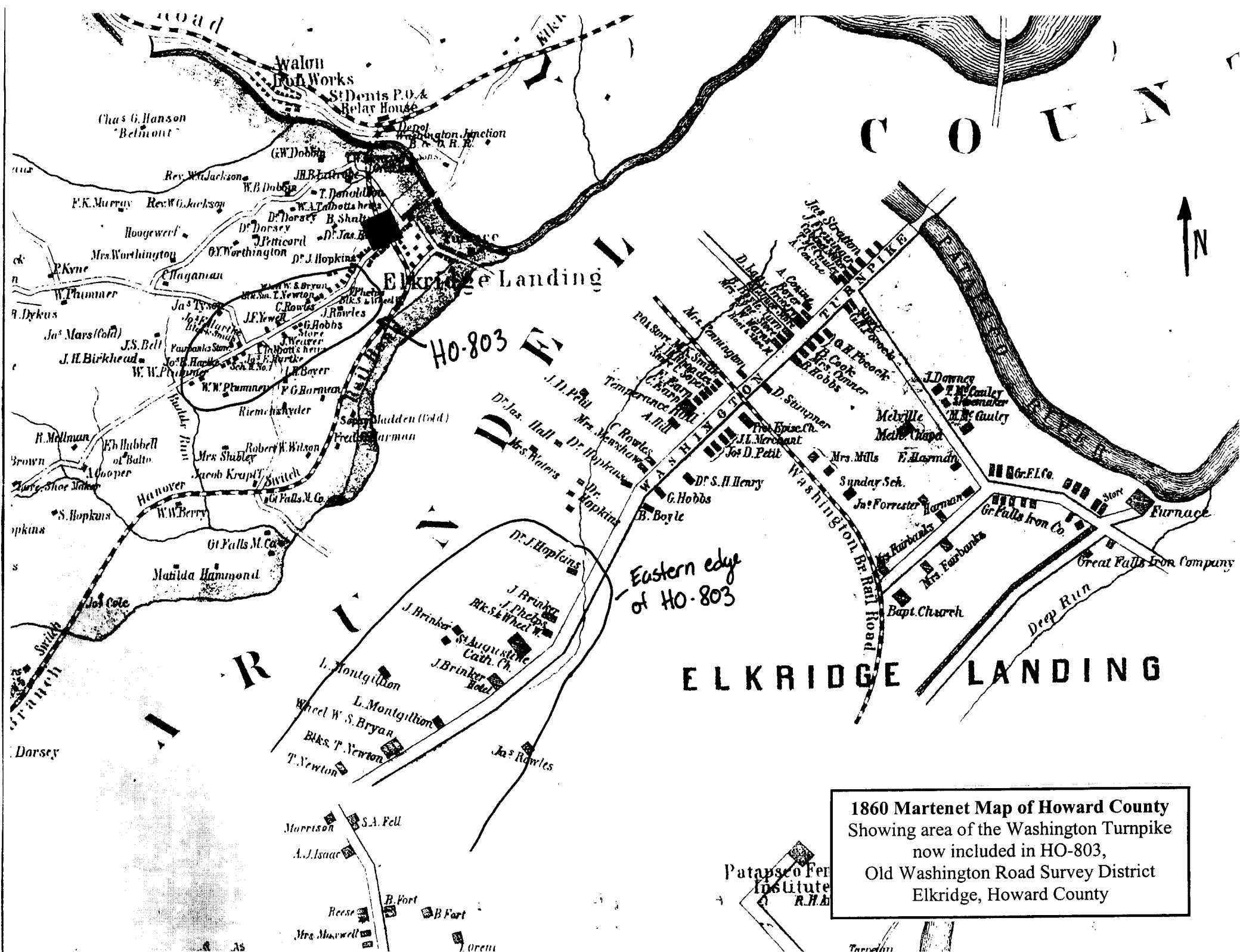

1860 Martenet Map of Howard County
 Showing area of the Washington Turnpike
 now included in HO-803,
 Old Washington Road Survey District
 Elkrige, Howard County

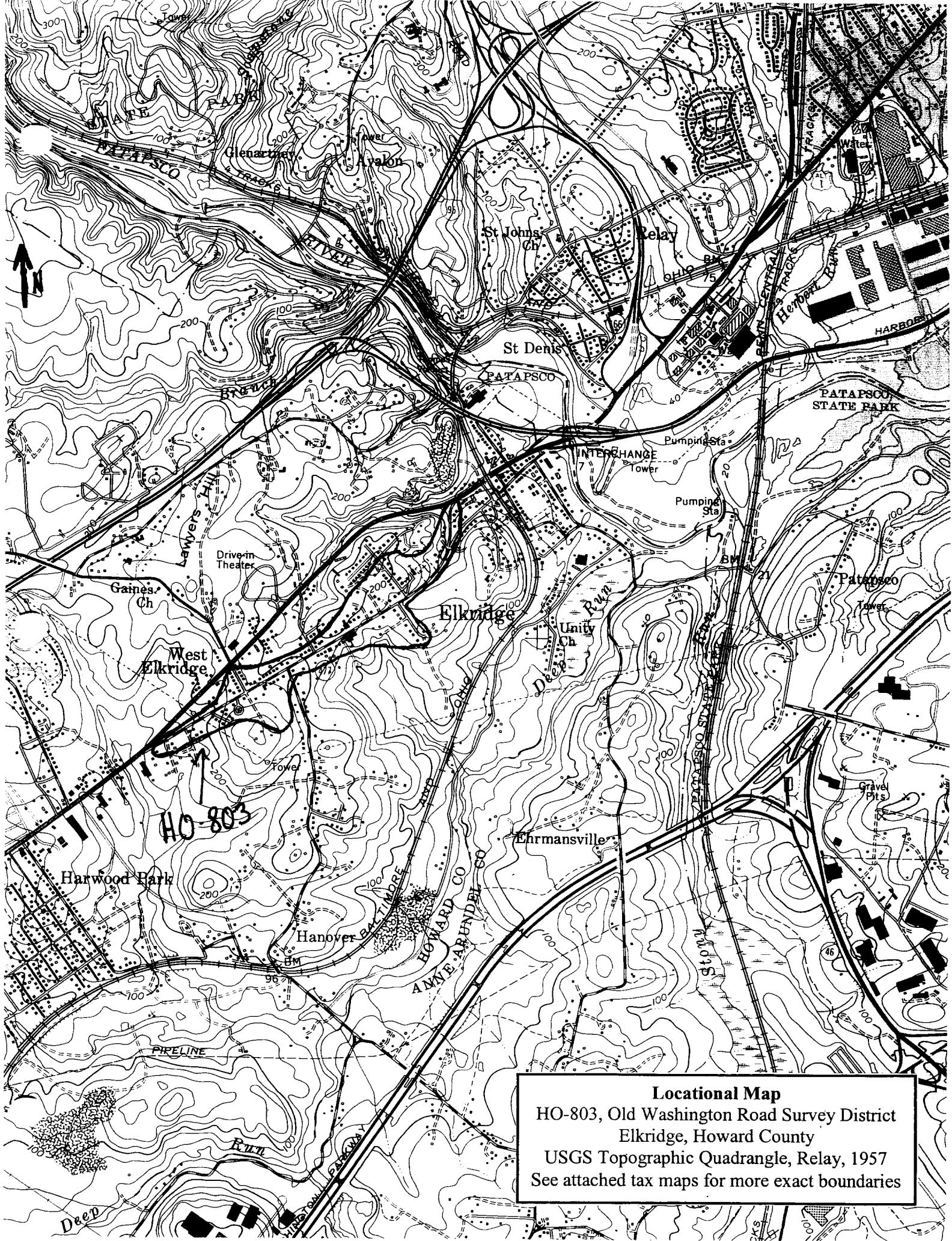

Locational Map
HO-803, Old Washington Road Survey District
Elkridge, Howard County
USGS Topographic Quadrangle, Relay, 1957
See attached tax maps for more exact boundaries



HO-803, Old Washington Road Survey District
5938, 5932, 5923 + 5922 Old Washington Road, Elkridge

Howard County, MD

14 21+82 NNNNN 975

Kristin Hill, 11/03

Negative at MOSHPD

Looking NE towards Rt. 1 along Old Washington Rd at
eastern edge of district.

1/41

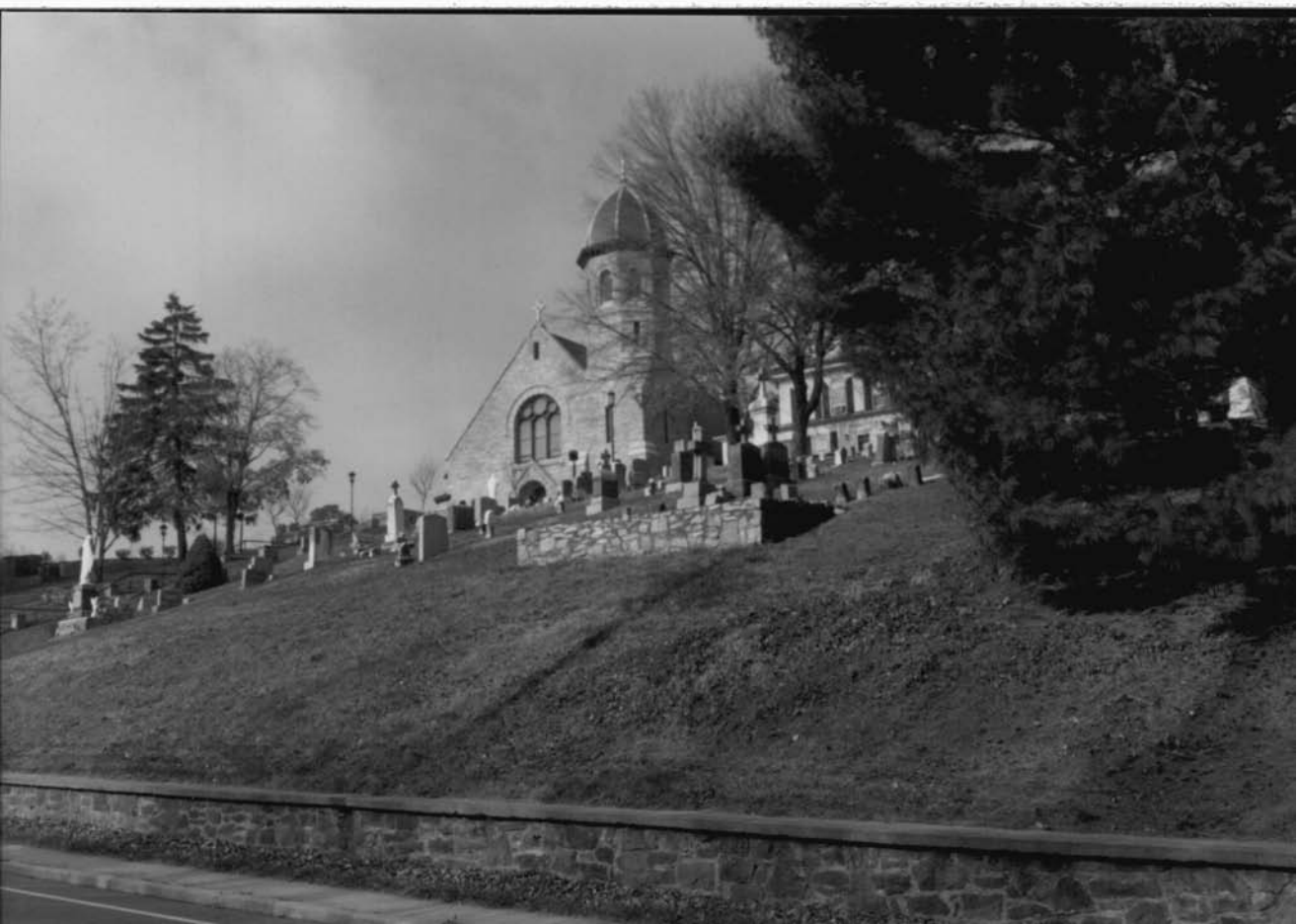

HO-803, Old Washington Rd Survey District
St. Augustine's Church, Elkridge

Howard County, MD

Kristin Hill, 11/03

13 21+01 NNNNN 975

Negative at MDSHPO

St. Augustine's cemetery + church, looking NW from
Old Washington Road

2/41



HO-803, Old Washington Rd Survey District

5960 Augustine Avenue, Elkridge

Howard County, MD

Kristin Hill, 10/03

Negative at MDSTPO

SE elevation

3/41

59 21+82 (NINE) 350



HO-803, Old Washington Road Survey District

5946 Augustine Avenue, Elkridge

Howard County, MD

Kristin Hill, 10/03

58 21+01 NHHH 358

Negative at MDSHPD

SE elevation

4/41



Ho-803, Old Washington Road Survey District

5936 Augustine Avenue, Elkridge

Howard County, MD

Kristin Hill, 10/03

Negative at MDSHPD

NE elevation

5/41

57 21101 111111 350



H0-803, Old Washington Road Survey District

5920 Augustine Avenue, Elkridge

Howard County, MD

Kristin Hill, 10/03

56:21451 HHHHH 358

Negative at MDSTPO

East elevation

6/41



HO-803, Old Washington Road Survey District

5805 Augustine Avenue, Elkridge

Howard County, MD

Kristin Hill, 10/03

Negative at MDSHPO

SW elevation

7/41



HO 803, Old Washington Road Survey District
5839 Augustine Avenue, Elkridge
Howard County, MD

Kristin Hill, 10/03

55 21+01 NNNNN 339

Negative at MDSHPO

SW elevation

8/41



H0-803, Old Washington Road Survey District
5815 Augustine Avenue, Elkridge

Howard County, MD

Kristin Hill, 10/03

Negative at MDSHPD

NW elevation

9/41

54 21+01 NNNNN 350



HO-803, Old Washington Road Survey District
Augustine Avenue, Elkridge

Howard County, MD

Kristin Hill, 11/03

12 21+01 NNNNN 975

Negative at MDSHPo

Looking north up the west side of the street, 5800 block

10/41



HO-803, Old Washington Road Survey District

6004 Old Washington Road, Elkridge

Howard County, MD

Kristin Hill, 10/03

Negative at MDSHPO

52 21#02 NNNNN 350

South elevation

11/41



HD-803, Old Washington Road Survey District

6040 Old Washington Road, Elkridge

Howard County, MD

Kristin Hill, 10/03

51 21002 RRRFH 350

Negative at MDSHPO

South elevation

12/41



Hd-803, Old Washington Road Survey District

6084 and 6098 Old Washington Road, Elkridge

Howard County, MD

Kristin Hill, 10/03

Negative at MD SHPO 58 21+68 HERRN 350

Looking NW from Old Washington Rd.

13/41



HO-803, Old Washington Road Survey District

6098 Old Washington Road, Elkridge

Howard County, MD

Kristin Hill, 10/03

Negative at MDSHPO

South elevation

14/41

49 21402 INHER 350



HO-803, Old Washington Road Survey District
6112 Old Washington Road, Elkridge

Howard County, MD

Kristin Hill, 11/03

48 21+81 NNNNN 350

Negative at MDSHPD

SE elevation

15/41



HO-803, Old Washington Road Survey District

6122 Old Washington Road, Elkridge

Howard County, MD

Kinstin Hill, 10/03

Negative at MDSHPO

SE elevation

16/41

47 21+02 NORTH 350



HO-803, Old Washington Road Survey District

6135 Old Washington Road, Elkridge

Howard County, MD

Kristin Hill, 10/03

45 21468 111111 358

Negative at MDSHPD

NW elevation, former Elkridge High School

17/41



6135

HO. 803, Old Washington Road Survey District

6135 Old Washington Road, Elkridge

Howard County, MD

Kristin Hill, 10/03

46 21781 NNNNN 350

Negative at MDSHPD

Former Elkridge High School, detail of door architrave

18/41



HO-803, Old Washington Road Survey District

6134 Old Washington Road, Elkridge

Howard County, MD

Kristin Hill, 10/03

44 2102 NNNNN 350

Negative at MD SHPO

South elevation

19/41



HO-803, Old Washington Road Survey District

6159 Old Washington Road, Elkridge

Howard County, MD

Kristin Hill, 10/03

37 21486 HNNNN 350

Negative at MDSHPD

North elevation

20/41



HO 803, Old Washington Road Survey District

6179 Old Washington Road, Elkridge

Howard County, MD

Kristin Hill, 10/03

35 21401 NHHN 350

Negative at MDSHPO

NW elevation

21/41



H0-803, old Washington Road Survey District

6180 Old Washington Road, Elkridge

Howard County, MD

39 21+02 NNNNN 356

Kristin Hill, 10/03

Negative at MDSHPO

NW elevation

22/41



HO. 803, Old Washington Road Survey District

6154 Old Washington Road, Elkridge

Howard County, MD

Kristin Hill, 10/03

42 21403 NNNNN 350

Negative at MDSHPD

SW elevation

23/41



H0-803, Old Washington Road Survey District

Old Washington Road, Elkridge

Howard County, MD

Kristin Hill, 10/03

43 21*01 NNNNN 350

Negative at M05H00

Looking west along the north side of Old Washington Road. House #6180 is in foreground.

24/41



HO-803. Old Washington Road Survey District

6180, 6184, Old Washington Road, Elkridge

Howard County, MD

Kristin Hill, 10/03

41 21+00 NORTH 350

Negative at MOSTHO

South east elevations

25/41



HO-803, Old Washington Road Survey District

6184 Old Washington Road, Elkridge

Howard County, MD

Kristin Hill, 10/03

48 21081 111111 358

Negative at MD5HPO

South elevation

26/41



HD-803 Old Washington Road Survey District

6204 Old Washington Road, Elkridge

Howard County, MD

42 21+85 NNNNN 621

Kristin Hill, 10/03

Negative at MDSH20

SE facade

27/41

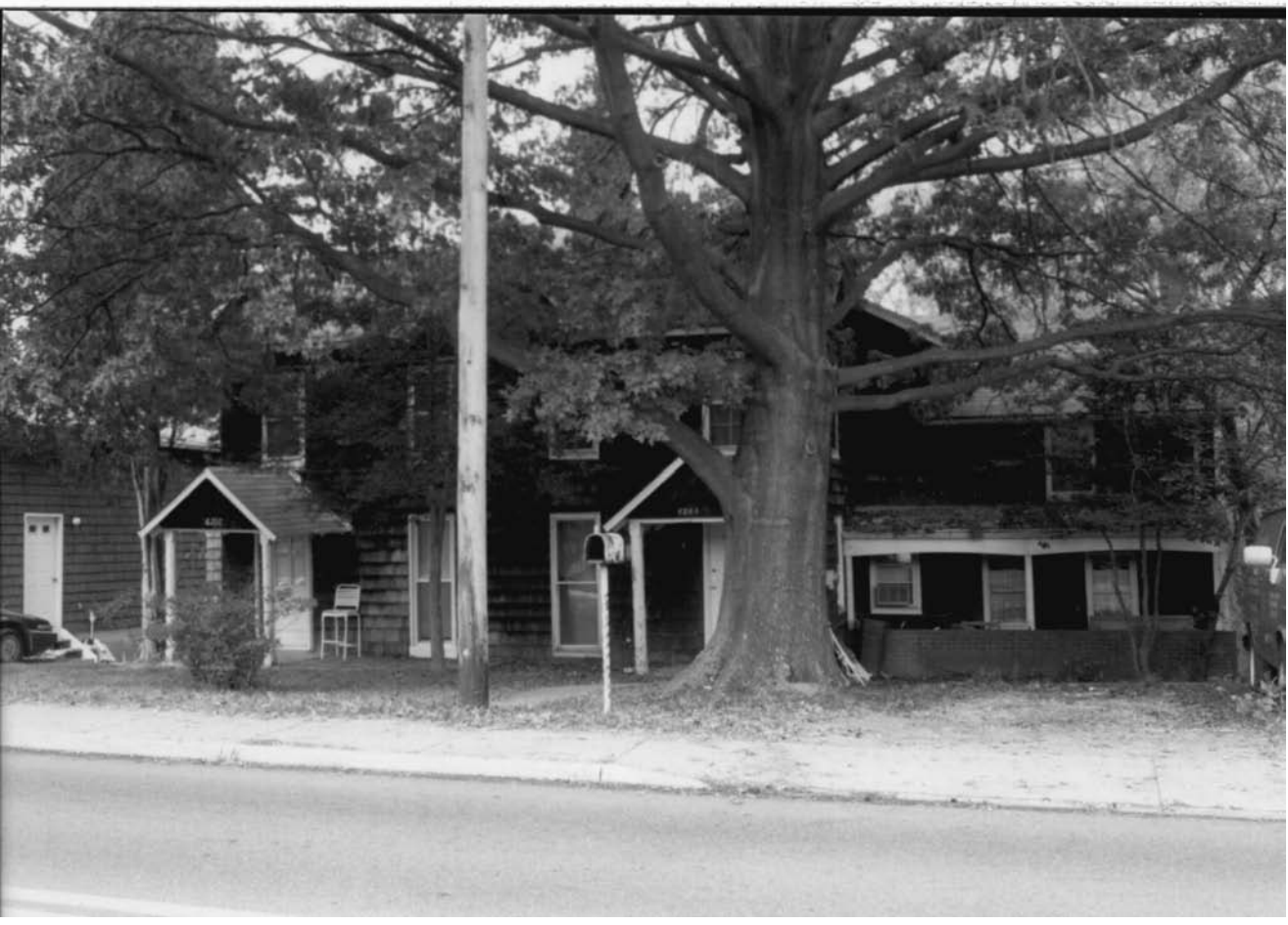

HO-803 Old Washington Road Survey District
6208 + 6210 Old Washington Road, Elkridge

Howard County, MD

Knight Hill, 10/03

Negative at MDSHPD

South facade

28/41

41 21 FEB 2004 1621



HO-803 Old Washington Road Survey District

6231 Old Washington Road, Elkridge

Howard County, MD

Kinstik Hill, 10/03

Negative at MDSHPD

N facade

29/41

48 21+92 HANNH 621



HO-8030 Old Washington Road Survey District

6249 Old Washington Road, Elkridge

Howard County, MD

39 21+01 EIRWIN 621

Kristin Hill, 10/03

Negative at MDSHPD

NW facade

30/41



HO-803 Old Washington Road Survey District
6252 Old Washington Road, Elkridge
Howard County, MD

Kristin Hill, 10/03

Negative at MDHPD

South facade

31/41

38 21 182 HIKHIN 621



HO-803 Old Washington Road Survey District

6270 Old Washington Road, Elkridge

Howard County, MD

Kristin Hill, 10/03

Negative at MDSHPO

North side of road, looking west

32/41

35 21488 HHHHH 621



HO-803 Old Washington Road Survey District
6274 Old Washington Road, Elkridge

Howard County, MD

Kristin Hill, 10/03

Negative at MD SHPO

SW facade

33/41

37 21482 NNNNN 621



HO-803 Old Washington Road Survey District

6274 Old Washington Road, Elkridge

Howard County, MD

Kristin Hall, 10/03

Negative at MDHPO

36 23 103 111111 621

Close up, first story front facade

34/41



HO-803, Old Washington Road Survey District
Old Montgomery Rd, Elkridge
Howard County, MD

Kristin Hill, 11/03

11 21+00 NNNNN 975

Negative at MDSHPD

Looking NE along East side of the road towards Rt. 1,
7000 block

35/41



Ho-803, Old Washington Road Survey District
old Montgomery Road, Elkridge
Howard County, MD

Kristin Hill, 11/03

09 21+00 NNNNN 975

Negative at MDSHPD

Looking NW along west side of the road towards Rt. 1,
7000 block

36/41



HO. 803, Old Washington Road Survey District

6399 Old Washington Road, Elkridge

Howard County, MD

Kristin Hill, 11/03

07 21+00 NNNNN 975

Negative at MDSTHPD

North elevation

37/41



HO-803, Old Washington Road Survey District

6399 Old Washington Road, Elkridge

Howard County, MD

Krista Hill, NW03

38 21+02 NNNNN 975

Negative at MDSTHPD

NW facade

38/41



HO. 803, Old Washington Road Survey District
6399 Old Washington Road, Elkridge
Howard County, MD

06 21+00 NNNNN 975

Kristin Hill, 11/03
Negative at MDSHPD

NE elevation

39/41



HO-803, Old Washington Road Survey District

Elkridge

Howard County, MD

Kristin Hill, 11/03

05 21-01 NNNNN 975

Negative at MDSHPO

Looking East along Old Washington Road from western
edge of the district.

40/41



HO-803, Old Washington Road Survey District
Downs Avenue, Elkridge
Howard County, MD

02 21+01 NNNNN 975

Kristin Hill, 11/03

Negative at MDSHPO

Looking SE along East side of Downs Ave. from
Old Washington Road

41141