

**INDIVIDUAL PROPERTY/DISTRICT
MARYLAND HISTORICAL TRUST
INTERNAL NR-ELIGIBILITY REVIEW FORM**

Property/District Name: Bobby's Scaggsville Station Survey Number: HO-713

Tax Parcel#: 54

Project: Maryland 216/29 Project Planning Study Agency: MDOT-SHA

Site visit by MHT Staff: no yes Name _____ Date _____

Eligibility recommended _____ Eligibility **not** recommended _____

Criteria: A B C D Considerations: A B C D E F G None

Justification for decision: (Use continuation sheet if necessary and attach map)

Bobby's Scaggsville Station at 10919A Scaggsville Road is not eligible due to the fact that it does not meet National Register Criteria A, B, C, or D. Preliminary research has not revealed any association between the dwelling and events that have made a significant contribution to the broad patterns of our history (Criterion A) or the lives of persons significant in our past (Criterion B). Although the building, a typical 1930s filling station, provides an example of the Bungalow with Craftsman-style influences, it is neither unusual nor distinguished; it does not represent the work of a master or display high artistic merit (Criterion C). There is no evidence that the property is likely to yield information important in history or prehistory (Criterion D). Thus, the property is not National Register-eligible.

Documentation on the property/district is presented in: Maryland Historical Trust Inventory Form
and Maryland 29/216 Project Planning Report

Prepared by: Tracerics, 5420 Western Ave., Chevy Chase, MD 20815 November 1997

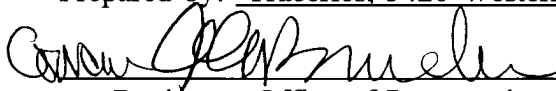
 Date 2/10/98
Reviewer, Office of Preservation Services

NR program concurrence: yes no not applicable

 Date 3/31/99
Reviewer, NR Program

Jan

CAPSULE SUMMARY
Bobby's Scaggsville Station
10919A Scaggsville Road
(HO-713)

Constructed as a gas station, Bobby's Scaggsville Station at 10919A Scaggsville Road was designed as a bungalow with Craftsman-style influences. The one-story, low-slung building has an L-shaped plan and is covered with a hipped roof. Set on a parged concrete foundation, the gas station features a deep porte cochere at the front and a single interior brick chimney set near the rear of the building at the intersection of the arms of the "L." The wood frame walls are clad in asbestos shingles. The porte cochere is supported on square wood posts and features exposed rafters on its underside. Many of the building's original features remain, including the 1/1 windows, the panel-and-light doors, and the exposed rafters beneath the overhanging eaves.

The gas station at 10919A Scaggsville Road was erected by the Hines family in 1937. Mentioned in the deed of sale dated July 8, 1944, the station was one of the early modern filling stations in the Scaggsville area. Its form is typical of rural gas stations built throughout the United States during the 1910s, 1920s, and 1930s. Craftsman in style, these stations often served as combination general store and filling station in areas remote from urban centers. Members of the Hines family owned and operated the gas station from its inception and still own the property today.

MARYLAND HISTORICAL TRUST
MD INVENTORY OF HISTORIC PROPERTIES

Inventory No. HO-713

=====

1. Name of Property

=====

historic name _____
common/other name Bobby's Scaggsville Station

=====

2. Location

=====

street & number 10919A Scaggsville Road not for publication _____
city or town Laurel vicinity _____ state Maryland code MD
county Howard County code 27 zip code 20723

=====

3. State/Federal Agency Certification N/A

=====

4. National Park Service Certification N/A

=====

5. Classification

=====

Ownership of Property (Check all that apply)

- private
- public-local
- public-State
- public-Federal

Category of Property (Check only one box)

- building(s)
- district
- site
- structure
- object

Number of Resources within Property

Contributing		Noncontributing		
<u>1</u>		<u>0</u>		buildings
<u>0</u>		<u>0</u>		sites
<u>0</u>		<u>0</u>		structures
<u>0</u>		<u>0</u>		objects
<u>1</u>		<u>0</u>		Total

Is this property listed in the National Register?

Yes Name of Listing _____
No

Maryland Inventory of Historic Properties
Bobby's Scaggsville Station
10919A Scaggsville Road
Howard County, Maryland

Inventory No. HO-713
Page 2

=====
6. Function or Use
=====

Historic Functions (Enter categories from instructions)

Cat: COMMERCE/TRADE Sub: Gas Station

Current Functions (Enter categories from instructions)

Cat: COMMERCE/TRADE Sub: Gas Station

=====
7. Description
=====

Architectural Classification (Enter categories from instructions)

Bungalow/Craftsman

Materials (Enter categories from instructions)

foundation Solid: Parged
roof Hipped: Asphalt Shingles
walls Wood Frame: Asbestos Shingles
other _____

Narrative Description (Describe the historic and current condition of the property.)

See Continuation Sheet No. 7-1

=====
8. Statement of Significance
=====

Applicable National Register Criteria (Mark "x" in one or more boxes for the criteria qualifying the property for National Register listing)

- A Property is associated with events that have made a significant contribution to the broad patterns of our history.
- B Property is associated with the lives of persons significant in our past.
- C Property embodies the distinctive characteristics of a type, period, or method of construction or represents the work of a master, or possesses high artistic values, or represents a significant and distinguishable entity whose components lack individual distinction.
- D Property has yielded, or is likely to yield information important in prehistory or history.

Criteria Considerations (Mark "X" in all the boxes that apply.)

- A owned by a religious institution or used for religious purposes.
- B removed from its original location.
- C a birthplace or a grave.
- D a cemetery.
- E a reconstructed building, object, or structure.
- F a commemorative property.
- G less than 50 years of age or achieved significance within the past 50 years.

Maryland Inventory of Historic Properties
Bobby's Scaggsville Station
10919A Scaggsville Road
Howard County, Maryland

Inventory No. HO-713
Page 4

=====
Areas of Significance (Enter categories from instructions)

Architecture
Commerce

Period of Significance 1937-present

Significant Dates 1937

Significant Person (Complete if Criterion B is marked above)

Cultural Affiliation Undefined

Architect/Builder Unknown

Narrative Statement of Significance (Explain the significance of the property.)

See Continuation Sheet No. 8-1

Maryland Inventory of Historic Properties
Bobby's Scaggsville Station
10919A Scaggsville Road
Howard County, Maryland

Inventory No. HO-713
Page 5

=====
9. Major Bibliographical References
=====

(Cite the books, articles, legal records, and other sources used in preparing this form.)

Howard County Land Records, Recorder of Deeds, Howard County,
Ellicott City, Maryland

=====
10. Geographical Data
=====

Acreage of Property 1.673 acres

Verbal Boundary Description (Describe the boundaries of the property.)

The property at 10919A Scaggsville Road is designated as Parcel 54, Grid 11 as indicated on Map 46.

Boundary Justification (Explain why the boundaries were selected.)

The property at 10919A Scaggsville Road has historically been associated with Parcel 54 since the building's construction since 1937.

=====
11. Form Prepared By
=====

name/title Kathryn A. Gettings, Architectural Historian
organization Traceries date October 30, 1997
street & number 5420 Western Avenue telephone 301/656-5283
city or town Chevy Chase state MD zip code 23185

=====
12. Property Owner
=====

name John T. and Ida E. Hines
street & number 10752 Scaggsville Rd. telephone 301/725-3156
city or town Laurel state MD zip code 20723
=====

MARYLAND INVENTORY OF HISTORIC PROPERTIES
CONTINUATION SHEET

Inventory No. HO-713

Section 7 Page 1

10919A Scaggsville Road
name of property
Howard County, Maryland
county and state

=====
Constructed as a gas station, the building at 10919A Scaggsville Road was designed as a bungalow with Craftsman-style influences. The one-story, low-slung building has an L-shaped plan and is covered with a hipped roof. Set on a parged concrete foundation, the gas station features a deep porte cochere at the front and a single interior brick chimney set near the rear of the building at the intersection of the arms of the "L." The wood frame walls are clad in asbestos shingles. The porte cochere is supported on square wood posts and features exposed rafters on its underside. Many of the building's original features remain, including the 1/1 windows, the panel-and-light doors, and the exposed rafters beneath the overhanging eaves. An interior brick chimney rises above the intersection of the rear hip and the ridge of the gable roof ell.

Part of a 1.673 acre property that includes the dwelling next door at 10919B Scaggsville Road, the gas station at 10919A occupies a small property which backs up onto rolling pasture lands. Set close to southwestern edge of Scaggsville Road, the building is fronted by a sizable asphalt parking/service area with gas pumps standing beneath the wide porte cochere.

EXTERIOR DESCRIPTION:

The facade, the northeast elevation of the filling station, comprises two wall planes, the projecting commercial facade in the hipped roof section of the building and the more private side elevation of the ell. Within the projecting section there is a central entrance marked by a single-leaf, five-panel, four-light door. To either side of the main entrance is a pair of large 1/1 windows. Along the northeast elevation of the ell, two 1/1 windows and one panel-and-light door pierce the wall. All openings are trimmed with the same square-edged casings.

The northwest wall is pierced in the gable end of the ell by a single 1/1 window. The southwest elevation contains three window bays. One bay on this elevation has been closed with plywood, while the other two are filled with 1/1 windows. Square-edged casings surround each of these openings. The southeast elevation is penetrated by four openings. The outer two hold 1/1 windows with square-edged trim while each of the inner openings contains a five-panel wood door.

MARYLAND INVENTORY OF HISTORIC PROPERTIES
CONTINUATION SHEET

Inventory No. HO-713

Section 8 Page 1

10919A Scaggsville Road
name of property
Howard County, Maryland
county and state

=====
The gas station at 10919A Scaggsville Road was erected by the Hines family in 1937. Mentioned in the deed of sale dated July 8, 1944, the station was one of the early modern filling stations in the Scaggsville area. Its form is typical of rural gas stations built throughout the United States during the 1910s, 1920s, and 1930s. Craftsman in style, these stations often served as combination general store and filling station in areas remote from urban centers.

The Hines family settled this area as early as 1924, having acquired this property in the late 1910s. At that time John L. Hines purchased two tracts of land from which the current 1.673 acres is derived. The residence at 10909 Scaggsville Road was built in 1924, and the adjacent bungalow at 10919B Scaggsville Road is contemporary with the filling station. Members of the Hines family owned and operated the gas station from its inception and still own the property today.

MARYLAND INVENTORY OF HISTORIC PROPERTIES
CONTINUATION SHEET

Inventory No. HO-713

10919A Scaggsville Road
name of property
Howard County, Maryland
county and state

=====
HISTORIC CONTEXT:

Geographic Organization: Piedmont

Chronological/Development Period (s):

Modern Period (1930-present)

Prehistoric/Historic Period Theme (s):

Architecture, Landscape, and
Community Planning
Economic

RESOURCE TYPE(S)

Category: Building

Historic Environment: Rural

Historic Function (s): COMMERCE/TRADE/Gas Station

Known Design Source: Unknown

MARYLAND INVENTORY OF HISTORIC PROPERTIES
CONTINUATION SHEET

Inventory No. HO-713

10919A Scaggsville Road
name of property
Howard County, Maryland
county and state

=====
May 9, 1995 Janet Dunn, Personal Representative of Ruth E. Linton's Estate, to John T. and Ida Hines
Sold Ruth E. Linton's interest in property for \$30,000
Land Records of Howard County
Liber MDR 3481 Folio 604

May 9, 1995 Helen E. Hoode and Brownie L. Orndorff, John T. Hines, and Evelyn M. Hines to John T. and Ida E. Hines
Sold for \$90,000
Land Records of Howard County
Liber MDR 3481 Folio 599

RESOURCE SKETCH MAP

10919 A Scaggsville Rd.

HO-713

Bobby's Scaggsville Station
Laurel, Howard County, MD

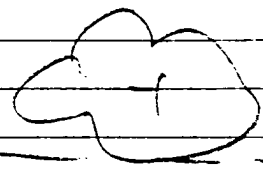
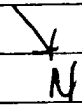

cow
pasture

slopes
down
↑

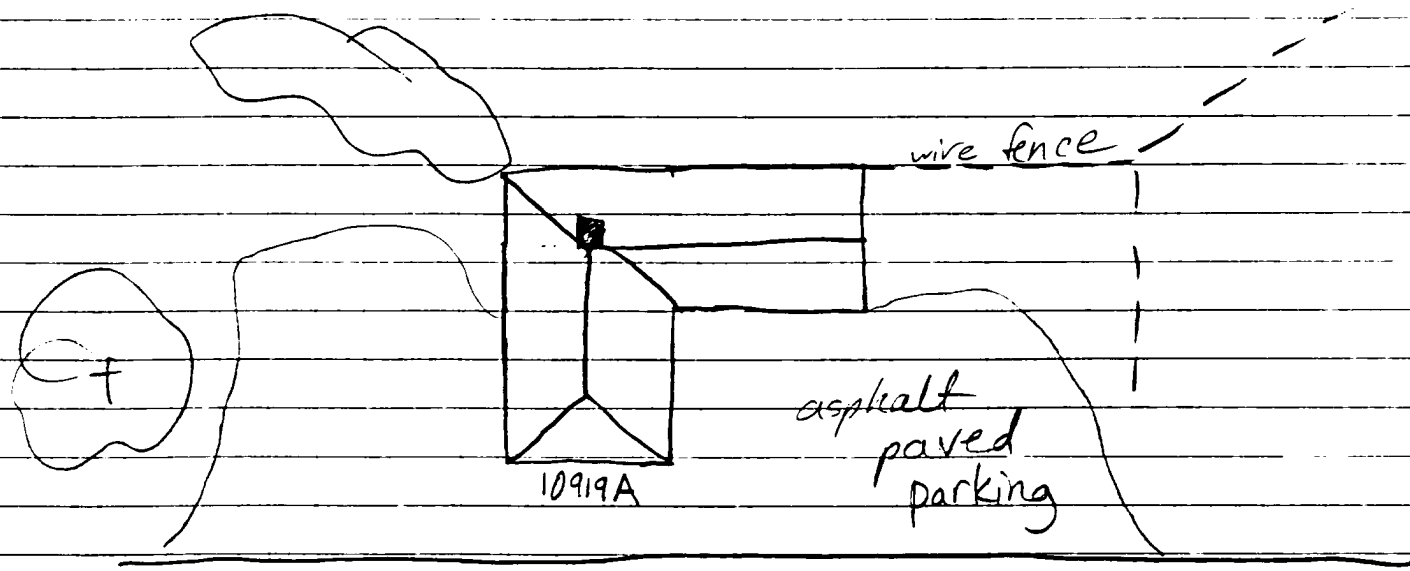

Scaggsville Rd.

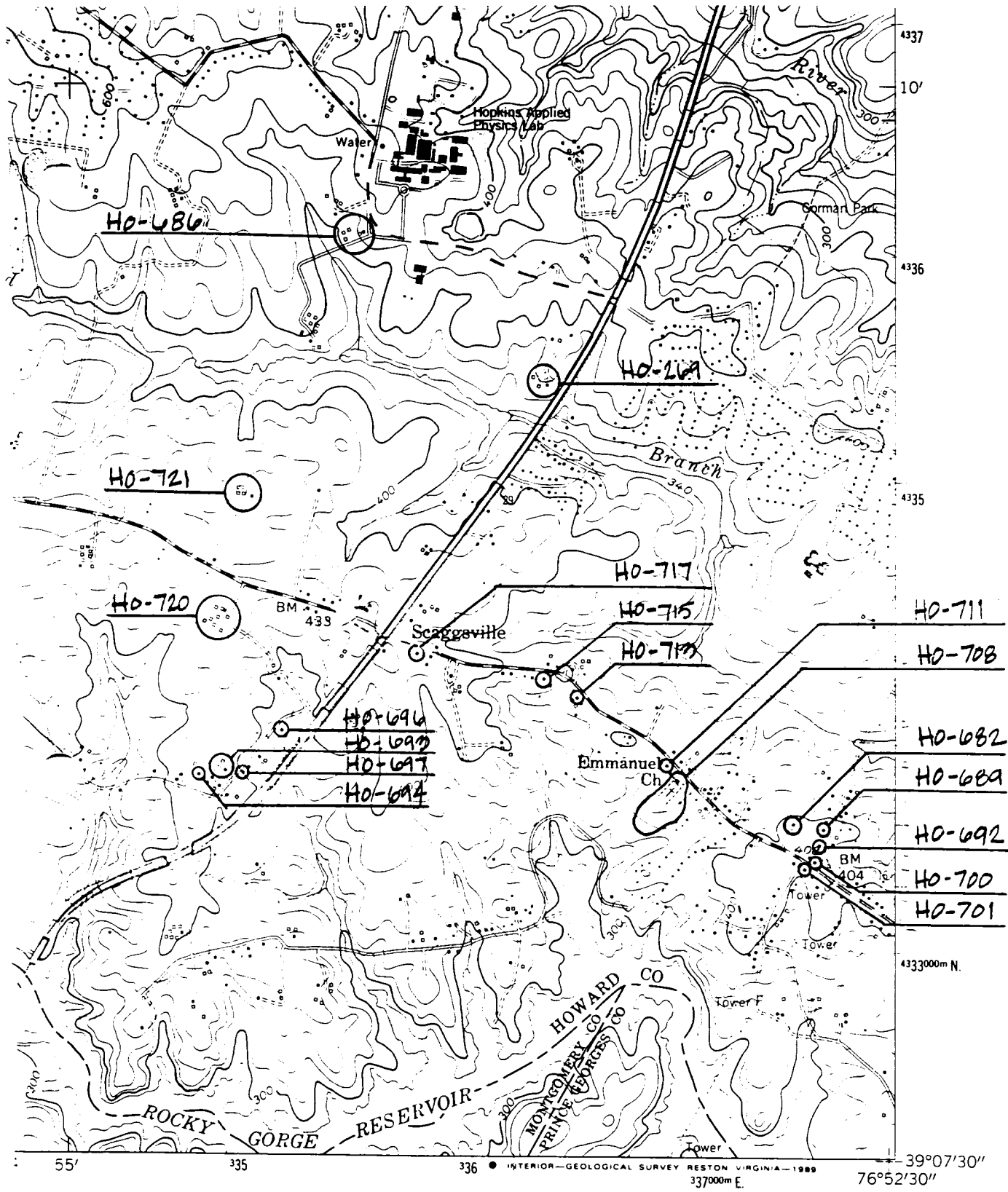

1/4 MILE

ROAD CLASSIFICATION

Heavy-duty		Light-duty	
Medium-duty		Unimproved dirt	
		U. S. Route	
		State Route	



CLARKSVILLE, MD.
 NW/4 LAUREL 15' QUADRANGLE
 39076-88-TF-024

1957
 PHOTOREVISED 1979
 DMA 5662 III NW—SERIES V833

To place on the predicted North American Datum 1983
 move the projection lines 8 meters south and
 26 meters west as shown by dashed corner ticks

(LAUREL)
 5662 III SE



HO-713

Bobby's Scaggsville Station

10919A Scaggsville Road

Howard County, MD

Traceries

October 1997

MDSHPO

NE Elevation

1 OF 3



HO-713

Bobby's Scaggsville Station

10919 A Scaggsville Rd.

Howard County, MD

Traceries

October 1997

MD SHPO

SE Elevation

3 OF 3



HO-713

Bobby's Scaggsville Station

10919A Scaggsville Rd.
Howard County, MD

Traceries

October 1997

SHPO-MD

West Corner

2 OF 3