

1405705604

MARYLAND HISTORICAL TRUST

INVENTORY FORM FOR STATE HISTORIC SITES SURVEY

1 NAME
 HISTORIC LINNWOOD
 AND/OR COMMON THE COBB HOUSE

2 LOCATION
 STREET & NUMBER 2327 DANIELS RD
 CITY, TOWN E. C VICINITY OF DANIELS CONGRESSIONAL DISTRICT _____
 STATE Maryland 21043 COUNTY HOWARD

3 CLASSIFICATION

CATEGORY	OWNERSHIP	STATUS	PRESENT USE	
<input type="checkbox"/> DISTRICT	<input type="checkbox"/> PUBLIC	<input checked="" type="checkbox"/> OCCUPIED	<input type="checkbox"/> AGRICULTURE	<input type="checkbox"/> MUSEUM
<input checked="" type="checkbox"/> BUILDING(S)	<input checked="" type="checkbox"/> PRIVATE	<input type="checkbox"/> UNOCCUPIED	<input type="checkbox"/> COMMERCIAL	<input type="checkbox"/> PARK
<input type="checkbox"/> STRUCTURE	<input type="checkbox"/> BOTH	<input type="checkbox"/> WORK IN PROGRESS	<input type="checkbox"/> EDUCATIONAL	<input checked="" type="checkbox"/> PRIVATE RESIDENCE
<input type="checkbox"/> SITE	<input type="checkbox"/> PUBLIC ACQUISITION	<input checked="" type="checkbox"/> ACCESSIBLE	<input type="checkbox"/> ENTERTAINMENT	<input type="checkbox"/> RELIGIOUS
<input type="checkbox"/> OBJECT	<input type="checkbox"/> IN PROCESS	<input checked="" type="checkbox"/> YES RESTRICTED	<input type="checkbox"/> GOVERNMENT	<input type="checkbox"/> SCIENTIFIC
	<input type="checkbox"/> BEING CONSIDERED	<input type="checkbox"/> YES UNRESTRICTED	<input type="checkbox"/> INDUSTRIAL	<input type="checkbox"/> TRANSPORTATION
		<input type="checkbox"/> NO	<input type="checkbox"/> MILITARY	<input type="checkbox"/> OTHER

4 OWNER OF PROPERTY
 NAME MIKE & JANET WILLS Telephone #: _____
 STREET & NUMBER 2327 DANIELS RD.
 CITY, TOWN EC VICINITY OF DANIELS STATE MD. Zip code 21043

5 LOCATION OF LEGAL DESCRIPTION
 COURTHOUSE REGISTRY OF DEEDS, ETC HOWARD CO. COURTHOUSE Liber #: _____
 STREET & NUMBER _____ Folio #: _____
 CITY, TOWN EWCOTT CITY MD STATE 21043

6 REPRESENTATION IN EXISTING SURVEYS
 TITLE NONE KNOWN
 DATE _____ FEDERAL _____ STATE _____ COUNTY _____ LOCAL _____
 DEPOSITORY FOR SURVEY RECORDS _____ STATE Maryland
 CITY, TOWN _____

2 DESCRIPTION

CONDITION

EXCELLENT
 GOOD
 FAIR

DETERIORATED
 RINGS
 UNEXPOSED

CHECK ONE

UNALTERED
 ALTERED

CHECK ONE

ORIGINAL SITE
 MOVED DATE _____

DESCRIBE THE PRESENT AND ORIGINAL (IF KNOWN) PHYSICAL APPEARANCE

8 SIGNIFICANCE

HO-570

PERIOD

AREAS OF SIGNIFICANCE - CHECK AND JUSTIFY BELOW

- | | | | | |
|---|--|---|---|--|
| <input type="checkbox"/> HISTORIC | <input type="checkbox"/> ARCHAEOLOGY-PREHISTORIC | <input type="checkbox"/> COMMUNITY PLANNING | <input type="checkbox"/> LANDSCAPE ARCHITECTURE | <input type="checkbox"/> RELIGION |
| <input type="checkbox"/> 1700-1800 | <input type="checkbox"/> ARCHAEOLOGY-HISTORIC | <input type="checkbox"/> CONSERVATION | <input type="checkbox"/> LAW | <input type="checkbox"/> SCIENCE |
| <input type="checkbox"/> 1800-1899 | <input type="checkbox"/> AGRICULTURE | <input type="checkbox"/> ECONOMICS | <input type="checkbox"/> LITERATURE | <input type="checkbox"/> SCULPTURE |
| <input type="checkbox"/> 1900-1999 | <input checked="" type="checkbox"/> ARCHITECTURE | <input type="checkbox"/> EDUCATION | <input type="checkbox"/> MILITARY | <input type="checkbox"/> SOCIAL/HUMANITARIAN |
| <input checked="" type="checkbox"/> 1700-1799 | <input type="checkbox"/> ART | <input type="checkbox"/> ENGINEERING | <input type="checkbox"/> MUSIC | <input type="checkbox"/> THEATER |
| <input checked="" type="checkbox"/> 1800-1899 | <input type="checkbox"/> COMMERCE | <input type="checkbox"/> EXPLORATION/BETTERMENT | <input type="checkbox"/> PHILOSOPHY | <input type="checkbox"/> TRANSPORTATION |
| <input type="checkbox"/> 1900- | <input type="checkbox"/> COMMUNICATIONS | <input type="checkbox"/> INDUSTRY | <input type="checkbox"/> POLITICS/GOVERNMENT | <input type="checkbox"/> OTHER (SPECIFY) |
| | | <input type="checkbox"/> INVENTION | | |

SPECIFIC DATES

BUILDER/ARCHITECT

STATEMENT OF SIGNIFICANCE

9 MAJOR BIBLIOGRAPHICAL REFERENCES

CONTINUE ON SEPARATE SHEET IF NECESSARY

10 GEOGRAPHICAL DATA

ACREAGE OF NOMINATED PROPERTY _____

VERBAL BOUNDARY DESCRIPTION

Please see Howard County Land Records, Liber _____ Folio _____

LIST ALL STATES AND COUNTIES FOR PROPERTIES OVERLAPPING STATE OR COUNTY BOUNDARIES

STATE Maryland COUNTY Howard

STATE _____ COUNTY _____

11 FORM PREPARED BY

NAME / TITLE

ORGANIZATION

DATE

STREET & NUMBER

TELEPHONE

CITY OR TOWN

STATE

The Maryland Historic Sites Inventory was officially created by an Act of the Maryland Legislature, to be found in the Annotated Code of Maryland, Article 41, Section 181 KA, 1974 Supplement.

The Survey and Inventory are being prepared for information and record purposes only and do not constitute any infringement of individual property rights.

RETURN TO: Maryland Historical Trust
The Shaw House, 21 State Circle
Annapolis, Maryland 21401
(301) 267-1438

HOWARD COUNTY

DEPARTMENT OF RECREATION AND PARKS

MARYLAND HISTORICAL TRUST

OCT 27 1983

RECEIVED

TO: 4/1/83

FROM: EO

RE: Cobb House - ~~Anniston~~ Danville

DATE: OCT. 25, 1983

HOUSE: 14. VICTORIANIZED - ASSYMETRICAL
 BELVEDERE W/ RAILING. DRAWINGS
 ARCHITECTURAL SHOWING

REMODELING
 FRONT, SIDE, AND REAR PORCHES -
 RETIC W/ GALLERY
 STAINED GLASS SIDE LITES & TRANSOM -
 FRONT DOOR.
 DECORATIVE PLASTER AND STENCILING
 INSIDE.

CUTBUILDINGS: TENT ROOFED w/ VARIETIES
 TURNED FINIALS - BRICK w/ CUT GRANITE
 SILLS & LINTELS - SMOKE HOUSE
 PUMPHOUSE
 FIELDSTONE - GREENHOUSE
 WOOD - TRIVY - 2 SEATS - ADULT/CHILD
 (OVER)

EXTENSIVE ADDITIONS HAVE CREATED A "SHOP" OF SOME SORT. - PROBABLY EARLY 20th. (W) ELECTRICAL EQUIP STILL IN TACT - ORLANDO MIGHT BE INTERESTED.

EXTERIOR -

LG. LANDSCAPED DRIVE WITH BELGIAN BLOCK DRAINS, POSTS & GATES.

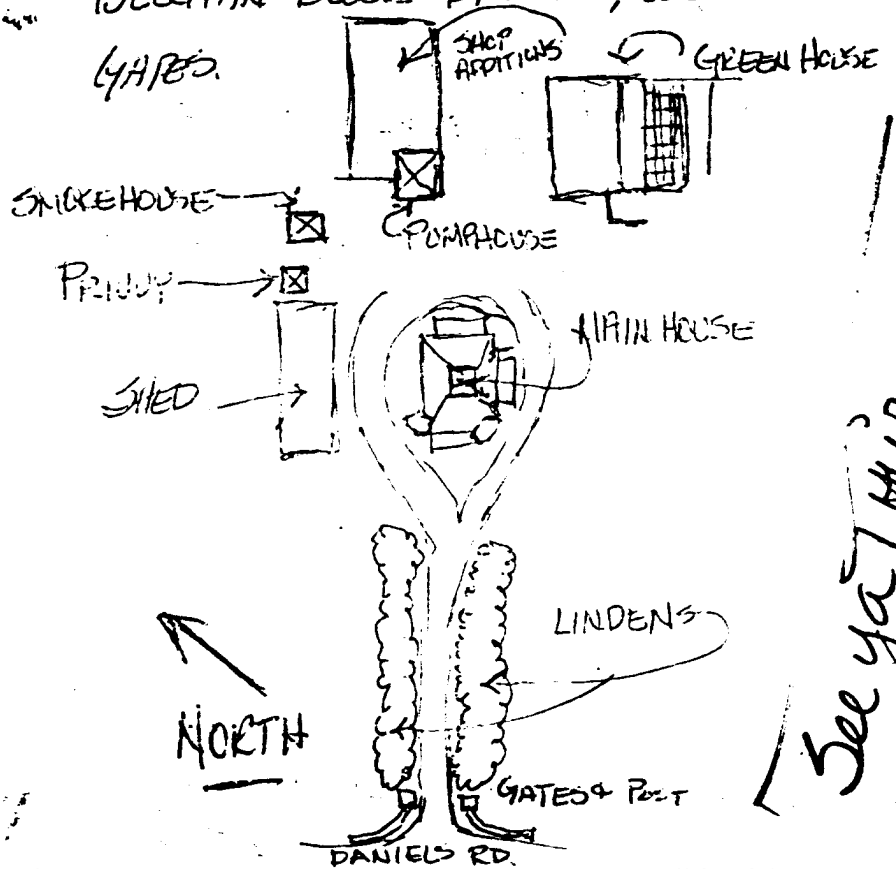

See ya T BUR.
ED

Charles McDunnokey → Samuel Cobb 4/2/1896 (Liber 65, Folio 342).

① Samuel + ~~Albert~~ ^{Sarah} Cobb - original owners.

② + Albert + Sarah - children.

③ Albert Cobb → Albert L + Carmell Taylor
April 27, 1973 (Liber 633, Folio 578)
son Albert died 1975

- prefabrication 2nd floor added -
- interesting in hallway, 2nd floor.

pump from adjacent land to
3rd floor storage tank.

"Alterations + Additions for a Frame Dwelling to be Erected for Mr.
S.F. Cobb"

D.S. Hopkins, Architect, Grand Rapids, Mich

General Notes -

The following specifications include old house as well as new wherever old house is altered and added to.

The roof of the old house must be removed and a new one put on - as for plans, ~~plans~~ elevations, details. The heights for new part must be made to conform with height of old house and all dimensions on new or altered work must be made to conform with old work. The outside finish on window watertable, corner boards + must be the same as now on the old building. The siding on entire building is to be taken off and same is to be as specified

(SECOND DISTRICT)

HOWARD COUNTY

Scale 2 Inches per Mile



EXPLANATIONS	
Dist. & Co. Lines
County Roads
Private
Turnpike
Rail Roads
Streams
The figures along the Roads shows the distance in Rods from junction to junction thereof	

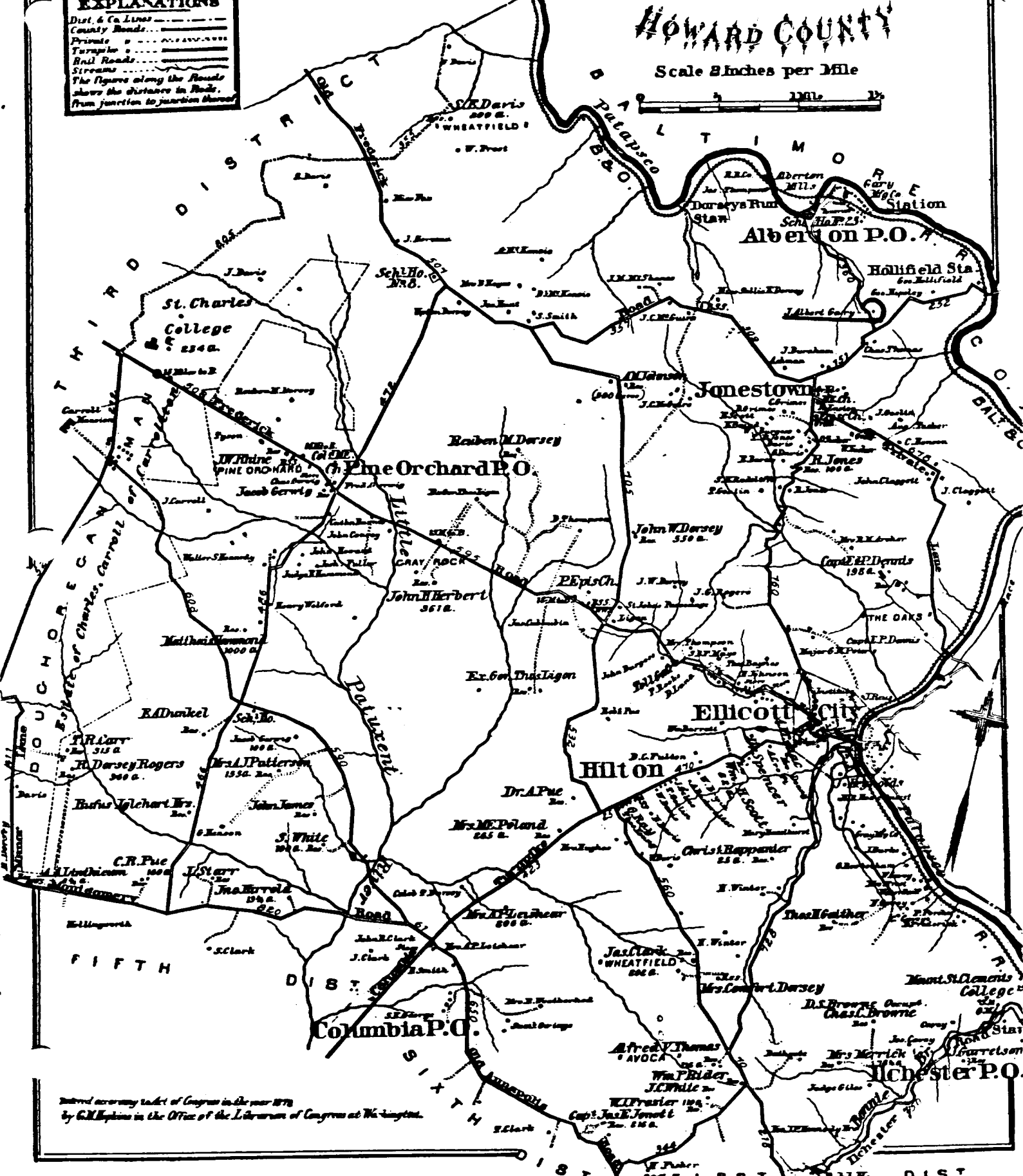

Entered according to act of Congress in the year 1878
 by G.M. Hopkins in the Office of the Librarian of Congress at Washington.

LIST OF PATRONS OF THE ATLAS OF HOWARD COUNTY, MD.

FIRST DISTRICT.

Table with columns: NAME, P. O. ADDRESS, No. of Acres, OCCUPATION, NATIVITY. Lists patrons for the First District including names like Anderson C. D., Brown T. H., Bryson John, etc.

SECOND DISTRICT-CONTINUED.

Table with columns: NAME, P. O. ADDRESS, No. of Acres, OCCUPATION, NATIVITY. Continues the list of patrons for the Second District.

CROSS, OR THIRD DISTRICT.

Table with columns: NAME, P. O. ADDRESS, No. of Acres, OCCUPATION, NATIVITY. Lists patrons for the Cross or Third District.

SECOND DISTRICT.

Table with columns: NAME, P. O. ADDRESS, No. of Acres, OCCUPATION, NATIVITY. Lists patrons for the Second District.

LISBON, OR FOURTH DISTRICT.

Table with columns: NAME, P. O. ADDRESS, No. of Acres, OCCUPATION, NATIVITY. Lists patrons for the Lisbon or Fourth District.



HO-570

