

HO-558
Prestage's Folly
Ellicott City
Private

Circa 1869

Prestage's Folly faces north on the west side of Old Columbia Pike, opposite Tuten's Cottage. It is a charming building, which has been constructed in three time frames, which now forms somewhat of a "T" plan. It is in its simplicity of scale and massing, as well as its fine site, that the building excels. This site places the building a distance from the road with two large trees on its east elevation providing a horticultural frame for the building. Its setback provides a depth and interest to the streetscape along this section of Old Columbia Pike.

Prestage's Folly is significant to Howard County and the State of Maryland architecturally as a fine example of a mid-nineteenth century house to which late nineteenth and twentieth century additions have been made and historically as part of a tract of land called Prestage's Folly, which was acquired by Dr. William Denny on September 26, 1835. (Anne Arundel County Land Records - Liber 20, folio 362). This land was later acquired by John Martin in 1869 for \$1,000, leading to the belief that the oldest section of the house existed at the time of this sale. This is further corroborated by the fact that the family of Anastasia Martin, the present owners, believe the house to have been constructed shortly after the Civil War.

MARYLAND HISTORICAL TRUST

HO-558
Ellicott City Quad
District 2
MAGI #1405582528

INVENTORY FORM FOR STATE HISTORIC SITES SURVEY

1 NAME

HISTORIC Prestage's Folly

AND/OR COMMON

2 LOCATION

STREET & NUMBER 3832 Old Columbia Pike (MD 987)

CITY, TOWN

Ellicott City VICINITY OF

CONGRESSIONAL DISTRICT

6th

STATE

Maryland

COUNTY

Howard

3 CLASSIFICATION

CATEGORY	OWNERSHIP	STATUS	PRESENT USE
<input type="checkbox"/> DISTRICT	<input type="checkbox"/> PUBLIC	<input checked="" type="checkbox"/> OCCUPIED	<input type="checkbox"/> AGRICULTURE <input type="checkbox"/> MUSEUM
<input checked="" type="checkbox"/> BUILDING(S)	<input checked="" type="checkbox"/> PRIVATE	<input type="checkbox"/> UNOCCUPIED	<input type="checkbox"/> COMMERCIAL <input type="checkbox"/> PARK
<input type="checkbox"/> STRUCTURE	<input type="checkbox"/> BOTH	<input type="checkbox"/> WORK IN PROGRESS	<input type="checkbox"/> EDUCATIONAL <input checked="" type="checkbox"/> PRIVATE RESIDENCE
<input type="checkbox"/> SITE	PUBLIC ACQUISITION	ACCESSIBLE	<input type="checkbox"/> ENTERTAINMENT <input type="checkbox"/> RELIGIOUS
<input type="checkbox"/> OBJECT	<input type="checkbox"/> IN PROCESS	<input checked="" type="checkbox"/> YES RESTRICTED	<input type="checkbox"/> GOVERNMENT <input type="checkbox"/> SCIENTIFIC
	<input type="checkbox"/> BEING CONSIDERED	<input type="checkbox"/> YES UNRESTRICTED	<input type="checkbox"/> INDUSTRIAL <input type="checkbox"/> TRANSPORTATION
		<input type="checkbox"/> NO	<input type="checkbox"/> MILITARY <input type="checkbox"/> OTHER

4 OWNER OF PROPERTY

NAME

Mr. and Mrs. Russell J. Grimes

Telephone #:

STREET & NUMBER

3832 Old Columbia Pike

CITY, TOWN

Ellicott City VICINITY OF

Maryland STATE zip code 21043

5 LOCATION OF LEGAL DESCRIPTION

COURTHOUSE, REGISTRY OF DEEDS, ETC

Tax Map 25A, p. 262
Hall of Records

Liber #: 631
Folio #: 127

STREET & NUMBER

Howard County Court House

CITY, TOWN

Ellicott City

STATE

Maryland

6 REPRESENTATION IN EXISTING SURVEYS

TITLE

Howard County Historic Sites Inventory

DATE

1978-1979

FEDERAL STATE COUNTY LOCAL

DEPOSITORY FOR SURVEY RECORDS

Maryland Historical Trust

CITY, TOWN

21 State Circle, Annapolis

STATE

Maryland

7 DESCRIPTIONEllicott City Quad
District 2

CONDITION		CHECK ONE		CHECK ONE	
<input checked="" type="checkbox"/> EXCELLENT	<input type="checkbox"/> DETERIORATED	<input type="checkbox"/> UNALTERED	<input checked="" type="checkbox"/> ORIGINAL SITE	<input type="checkbox"/> MOVED	DATE _____
<input type="checkbox"/> GOOD	<input type="checkbox"/> RUINS	<input checked="" type="checkbox"/> ALTERED			
<input type="checkbox"/> FAIR	<input type="checkbox"/> UNEXPOSED				

DESCRIBE THE PRESENT AND ORIGINAL (IF KNOWN) PHYSICAL APPEARANCE

Prestage's Folly faces north on the west side of Old Columbia Pike, opposite Tuten's Cottage. It is a charming building, which has been constructed in three time frames, which now forms somewhat of a "T" plan. It is in its simplicity of scale and massing, as well as its fine site, that the building excels. This site places the building a distance from the road with two large trees on its east elevation providing a horticultural frame for the building. Its setback provides a depth and interest to the streetscape along this section of Old Columbia Pike.

THE ORIGINAL HOUSE

Originally, the house faced east a three bay wide, one room deep, two story high, gabled roof (running north-south) frame clapboard house, resting on a stone foundation, with square brick interior chimney rising between its central and north bays, constructed into the center of an interior dividing wall.

Today this section of the house provides a large dining room, located in the central and south bays of this original dwelling unit and a paneled den in its north bay.

The present dining room retains a fine mid-nineteenth century chair rail, bordering random width, beaded wainscotting, which runs around the perimeter of the room, which also features top nailed, random width floor boards. The second floor holds two bedrooms.

Some time in the late nineteenth century the rest of the basic "T" plan was constructed. The east wing was constructed, forming the base of the "T" and extending east from the central and south bays of the original dwelling unit.

THE EAST WING

The east wing is a two bay wide, one room deep, two story high, gabled roof (running east-west) frame clapboard section, resting on a stone foundation, with a central, square brick chimney and a one-story high, shed roofed, open porch, supported by two square posts and a pilaster, running along the north elevation. This porch covers the rectangular, roman arched, open bible and cross paneled entrance door, flanked by three vertical side lights and surmounted by a four light transom, which is placed in the west bay of this north wall.

Fenestration for this section of the house is proportionally scaled and vertically aligned. All of its windows are rectangular and double-hung, underlined by projecting wooden sills, with its sashes holding two-over-two lights.

CONTINUE ON SEPARATE SHEET IF NECESSARY

The south elevation of this wing holds a central first and second floor window of the type described, with the "A" formed by its gabled roof decorated with wooden shingles, which creates a lacy effect on this elevation. This detail, along with the flanking east and west sections of the building and the proportional scale of its central windows, results in a strong visual, focal point for the entire composition.

INTERIOR OF THE EAST WING

The interior of the east wing holds a hall and staircase (running north-south) along its west wall and a large living room in its east bay.

The hall features a fine staircase with turned balusters, balustrade and kneel post. The door and window frames of the hall feature flat wooden pilasters and lintels, joined by square corners, decorated with rosettes. Hardwood floors are featured throughout this section.

THE SOUTH WING

The south wing of the house was originally one large kitchen, lighted by an east-west and two south windows, with an enclosed staircase along its west wall. Entrances on its north wall led to the east, to the entrance hall and on the west, to the dining room or original section of the house. A square brick chimney is and was centered into its south wall. This wall held a rectangular, outside entrance door, placed in the east end bay, which now leads into a comfortable family room addition. A first floor window is placed on either side of the fireplace.

The west end of the kitchen now is enclosed for use as a bath, while a large brick fireplace has been constructed to feed into the flue of the central square brick chimney of its south wall.

The single east window for the kitchen has been enlarged to a double window, each component an eight-over-eight, double-hung window.

The south window of the kitchen, placed east of the fireplace, is now totally opened and holds two shelves. The south window west of the fireplace is unchanged. Two similar, second floor windows rest above.

The west window for the kitchen now is a west window for the bathroom.

THE FAMILY ROOM ADDITION

Along the south wall of this kitchen runs a square, one-story high, shed roofed, frame, family room addition, placed east of center to allow the west bay window of this wall to remain functional.

An open staircase on its east elevation leads to its rectangular entrance door. North of this entrance door rests a rectangular, double-hung window, holding eight-over-eight lights.

The south elevation of this family room holds a double window, each component a rectangular, eight-over-eight, double-hung window.

The west wall of this section holds a similar, but singular, eight-over-eight light window.

8 SIGNIFICANCE

HO-558
Ellicott City Quad
District 2

PERIOD	AREAS OF SIGNIFICANCE -- CHECK AND JUSTIFY BELOW			
<input type="checkbox"/> PREHISTORIC	<input type="checkbox"/> ARCHEOLOGY-PREHISTORIC	<input type="checkbox"/> COMMUNITY PLANNING	<input type="checkbox"/> LANDSCAPE ARCHITECTURE	<input type="checkbox"/> RELIGION
<input type="checkbox"/> 1400-1499	<input checked="" type="checkbox"/> ARCHEOLOGY-HISTORIC	<input type="checkbox"/> CONSERVATION	<input type="checkbox"/> LAW	<input type="checkbox"/> SCIENCE
<input type="checkbox"/> 1500-1599	<input type="checkbox"/> AGRICULTURE	<input type="checkbox"/> ECONOMICS	<input type="checkbox"/> LITERATURE	<input type="checkbox"/> SCULPTURE
<input type="checkbox"/> 1600-1699	<input checked="" type="checkbox"/> ARCHITECTURE	<input type="checkbox"/> EDUCATION	<input type="checkbox"/> MILITARY	<input type="checkbox"/> SOCIAL/HUMANITARIAN
<input type="checkbox"/> 1700-1799	<input type="checkbox"/> ART	<input type="checkbox"/> ENGINEERING	<input type="checkbox"/> MUSIC	<input type="checkbox"/> THEATER
<input checked="" type="checkbox"/> 1800-1899	<input type="checkbox"/> COMMERCE	<input type="checkbox"/> EXPLORATION/SETTLEMENT	<input type="checkbox"/> PHILOSOPHY	<input type="checkbox"/> TRANSPORTATION
<input type="checkbox"/> 1900-	<input type="checkbox"/> COMMUNICATIONS	<input type="checkbox"/> INDUSTRY	<input type="checkbox"/> POLITICS/GOVERNMENT	<input type="checkbox"/> OTHER (SPECIFY)
		<input type="checkbox"/> INVENTION		

SPECIFIC DATES 1869

BUILDER/ARCHITECT

STATEMENT OF SIGNIFICANCE

Prestage's Folly is significant to Howard County and the State of Maryland architecturally as a fine example of a mid-nineteenth century house to which late nineteenth and twentieth century additions have been made and historically as part of a tract of land called Prestage's Folly, which was acquired by Dr. William Denny on September 26, 1835. (Anne Arundel County Land Records - Liber 20, folio 362) This land was later acquired by John Martin in 1869 for \$1,000, leading to the belief that the oldest section of the house existed at the time of this sale. This is further corroborated by the fact that the family of Anastasia Martin, the present owners, believe the house to have been constructed shortly after the Civil War.

Prestage's Folly is located within the Ellicott City National Register Historic District, as well as the local historic district. It is presently being impacted upon by the Cat Rock Storm Drainage and Sewer Project of the Department of Public Works. The Department of Public Works has made strong recommendations to insure that certain mandatory controls be placed on the project to insure the preservation of the scenic and historic resources along the Cat Rock. Such controls should be carefully monitored during construction.

Not only will this house be affected, but several other homes on Merryman and Hill Streets, all of which are presently within a National Register Historic District.

9 MAJOR BIBLIOGRAPHICAL REFERENCES

Interview with Miss Grimes, daughter of Mr. and Mrs. Russell J. Grimes.
Howard County Land Records

CONTINUE ON SEPARATE SHEET IF NECESSARY

10 GEOGRAPHICAL DATA

ACREAGE OF NOMINATED PROPERTY 3.06 acres

Please see Attachment 1, Tax Map 25A

VERBAL BOUNDARY DESCRIPTION

Please see Howard County Land Records, Liber 631 Folio 127

LIST ALL STATES AND COUNTIES FOR PROPERTIES OVERLAPPING STATE OR COUNTY BOUNDARIES

STATE Maryland COUNTY Howard

STATE _____ COUNTY _____

11 FORM PREPARED BY

NAME / TITLE

Cleora Barnes Thompson, Archivist

ORGANIZATION

Office of Planning & Zoning-Comprehensive Planning Section

DATE

STREET & NUMBER

3450 Court House Drive

TELEPHONE

CITY OR TOWN

Ellicott City

STATE

Maryland

The Maryland Historic Sites Inventory was officially created by an Act of the Maryland Legislature, to be found in the Annotated Code of Maryland, Article 41, Section 181 KA, 1974 Supplement.

The Survey and Inventory are being prepared for information and record purposes only and do not constitute any infringement of individual property rights.

RETURN TO: Maryland Historical Trust
The Shaw House, 21 State Circle
Annapolis, Maryland 21401
(301) 267-1438

TITLE SEARCH

HO-558 PRESTAGE'S FOLLY

<u>DATE</u>	<u>LIBER</u>	<u>FOLIO</u>	<u>GRANTOR</u>	<u>GRANTEE</u>	<u>TRANSACTION</u>
30 Mar 1973	631 -	127	Katherine May Nelson, for estate of Estelle Koontz	Russell J. Grimes	Deed to 3.06 acres.
13 Jan 1944	180 -	311	Charles E. Miller	Leslie & Estelle Koontz	Deed to 6¼ Acres P/O Tract called Prestage's Folly
26 Oct 1939	165 -	40	John William Martin, Unm.	Charles E. Miller	Deed
25 Oct 1939			J. Dougherty Mahon, Trustee	John W. Martin	Deed
25 July 1939			Mary E. Bildstein, et al.	John W. Martin	Deed
16 Nov. 1937	158 -	445	Michael H. Coomey, Trustee	John W. Martin	Deed
17 Oct. 1918	106 -	178	Michael J. Martin & Helena	Michael H. Coomey, trustee	Deed
25 Feb 1909	86 -	643	Anastasia Martin, widow of John Martin	Michael J. Martin	Deed
26 Sept. 1906	82 -	545	Katharine Gormley, et al	Anastasia Martin, for life	Deed
26 Mar 1886	50 -	371	John Martin	Anastasia Martin, et al	Deed
15 May, 1882	45 -	38	Thomas Nevin	John & Anastasia Martin	Deed
15 April 1869	29 -	114	Thomas Donaldson, Trustee for Henrietta Denny, et al	John Martin	Deed \$1,000.
16 March 1869	29 -	118	Henrietta Denny, widow of Dr. Wm. Denny	Thomas Donaldson, Trustee	3¼ acres
26 Sept 1835	20 - (AA County)	362	Jacob Mann	Dr. William Denny	3¼ acres

Attachment 1
HO-558
Prestage's Folly
Tax Map 25-A

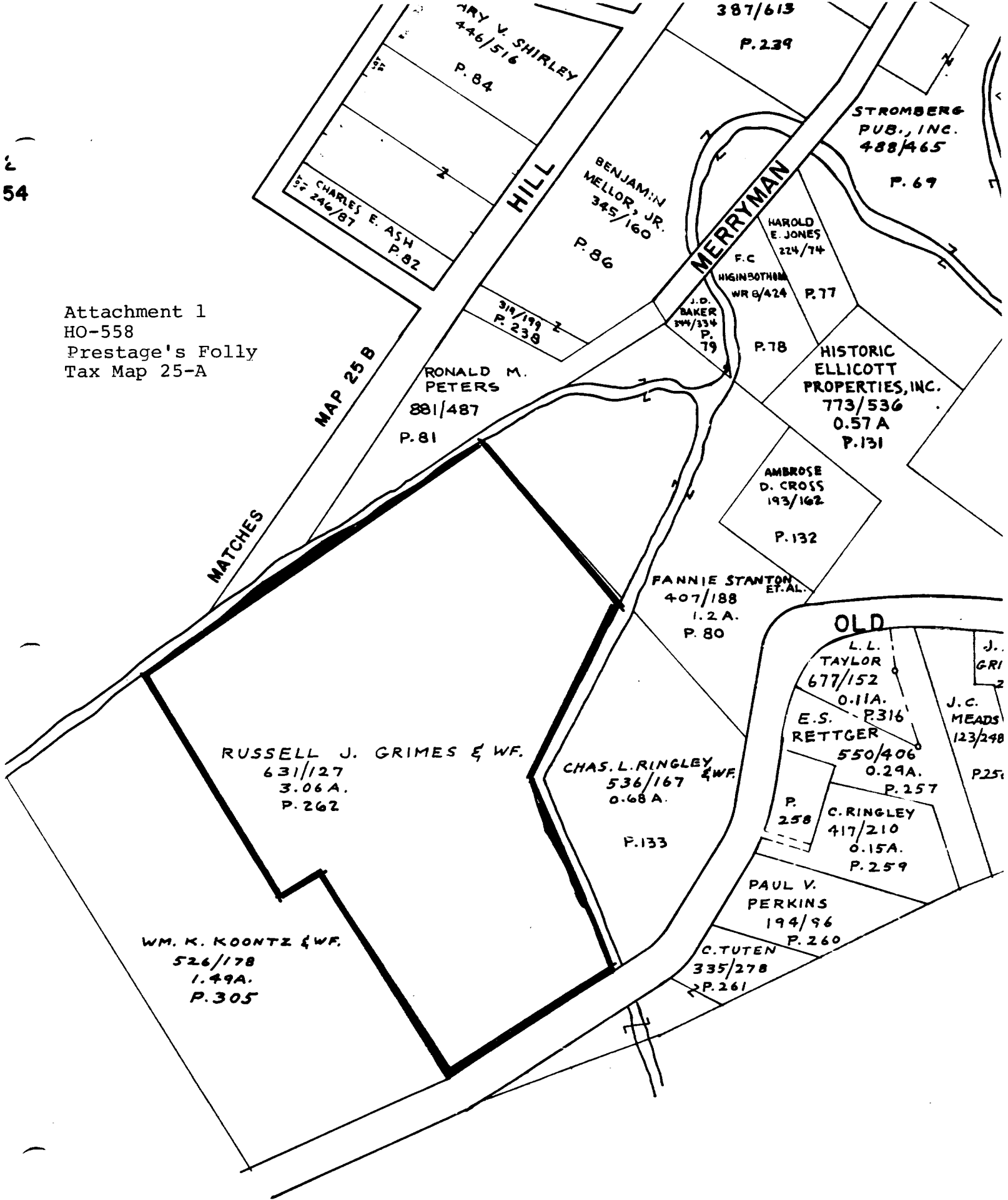

Attachment 4
HO-558
Prestage's Folly
Martennet Map of 1860

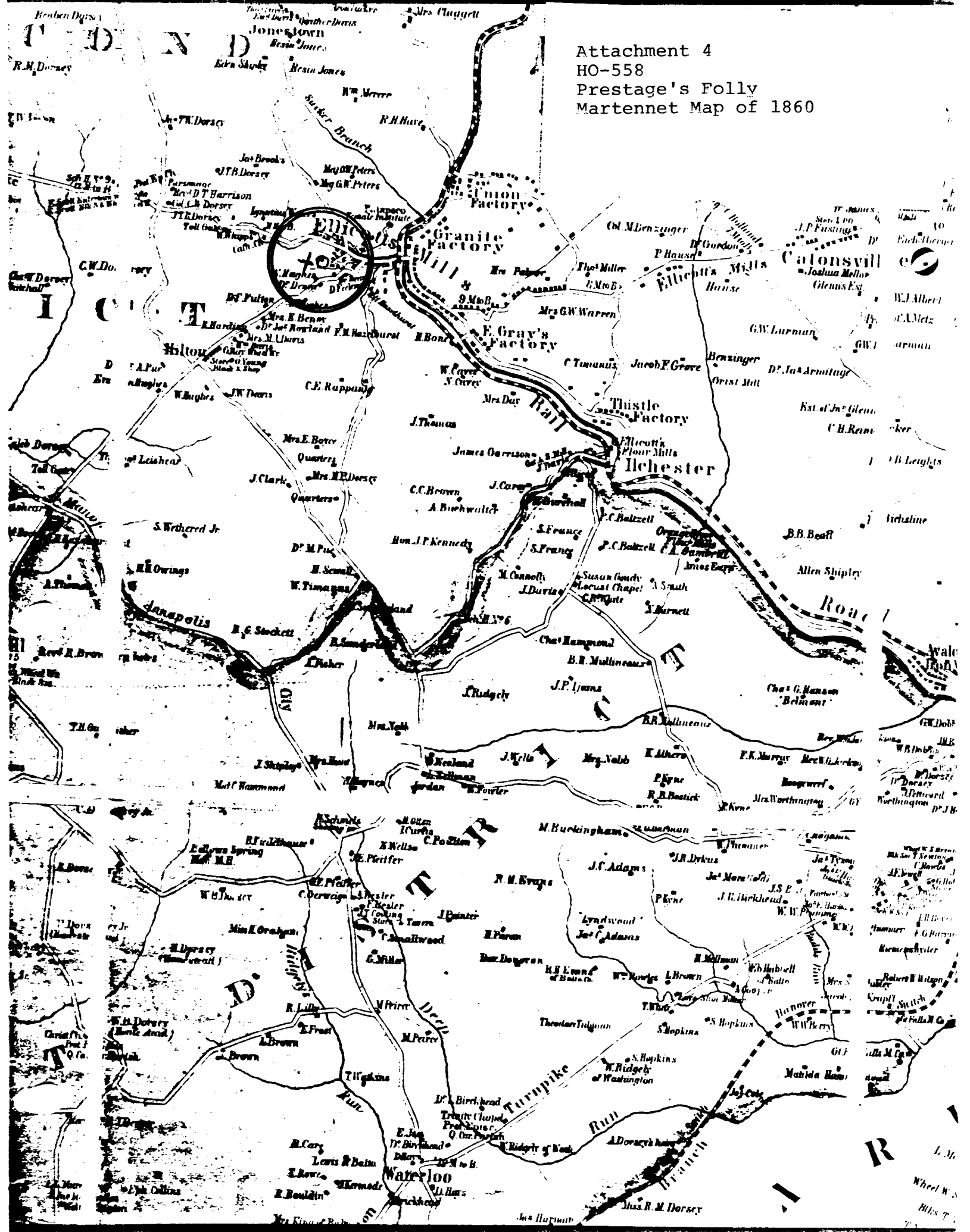

SECOND DISTRICT

HOWARD COUNTY

Scale 2 Inches per Mile



EXPLANATIONS	
Dist. & Co. Lines	-----
County Roads	-----
Private "	-----
Turnpike "	-----
Rail Roads	-----
Streams	-----
The figures along the Routes shows the distance in Rods, from junction to junction thereof	

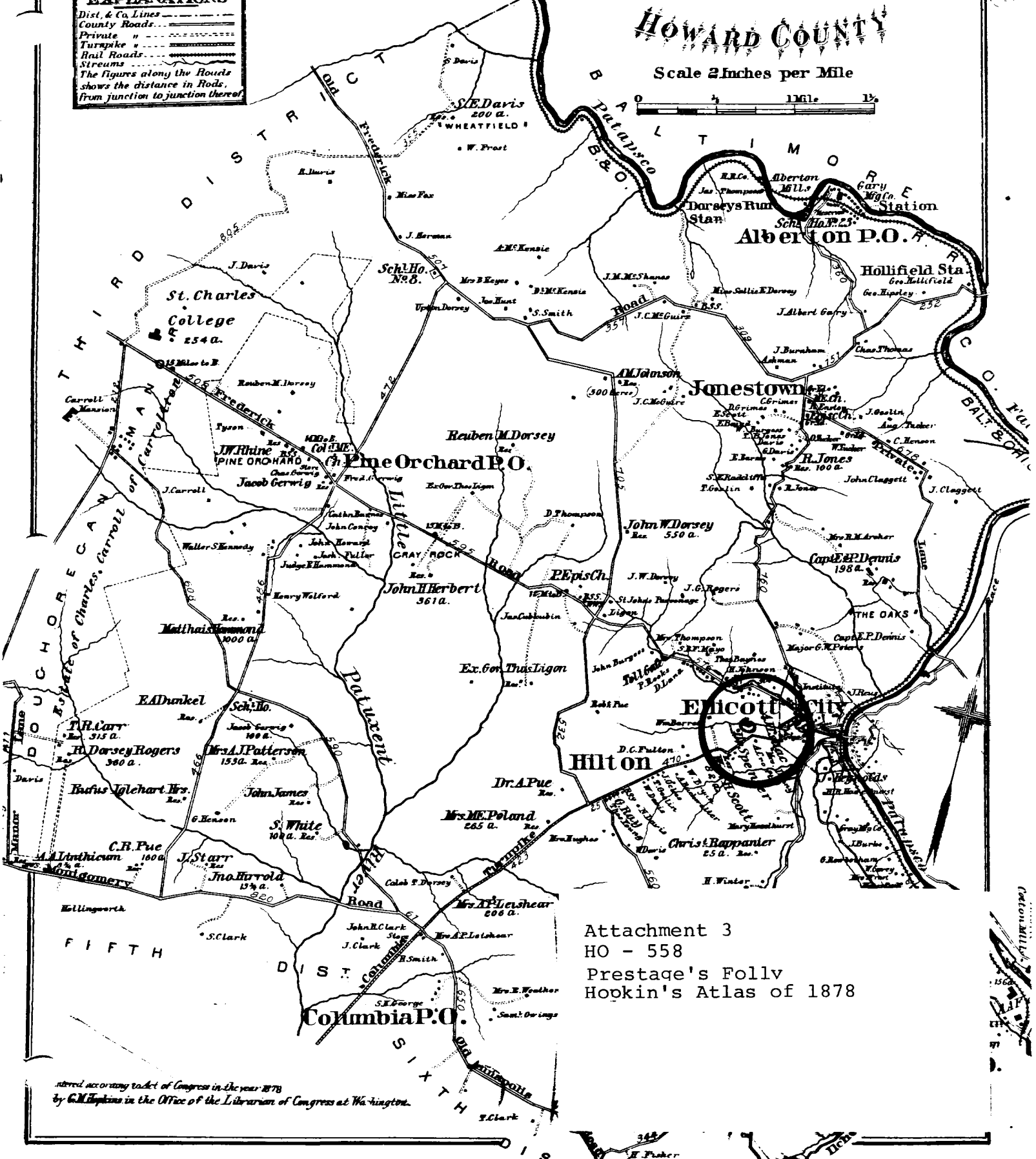

Attachment 3
 HO - 558
 Prestage's Folly
 Hopkin's Atlas of 1878

Entered according to Act of Congress in the year 1878
 by G.M. Hopkins in the Office of the Librarian of Congress at Washington.

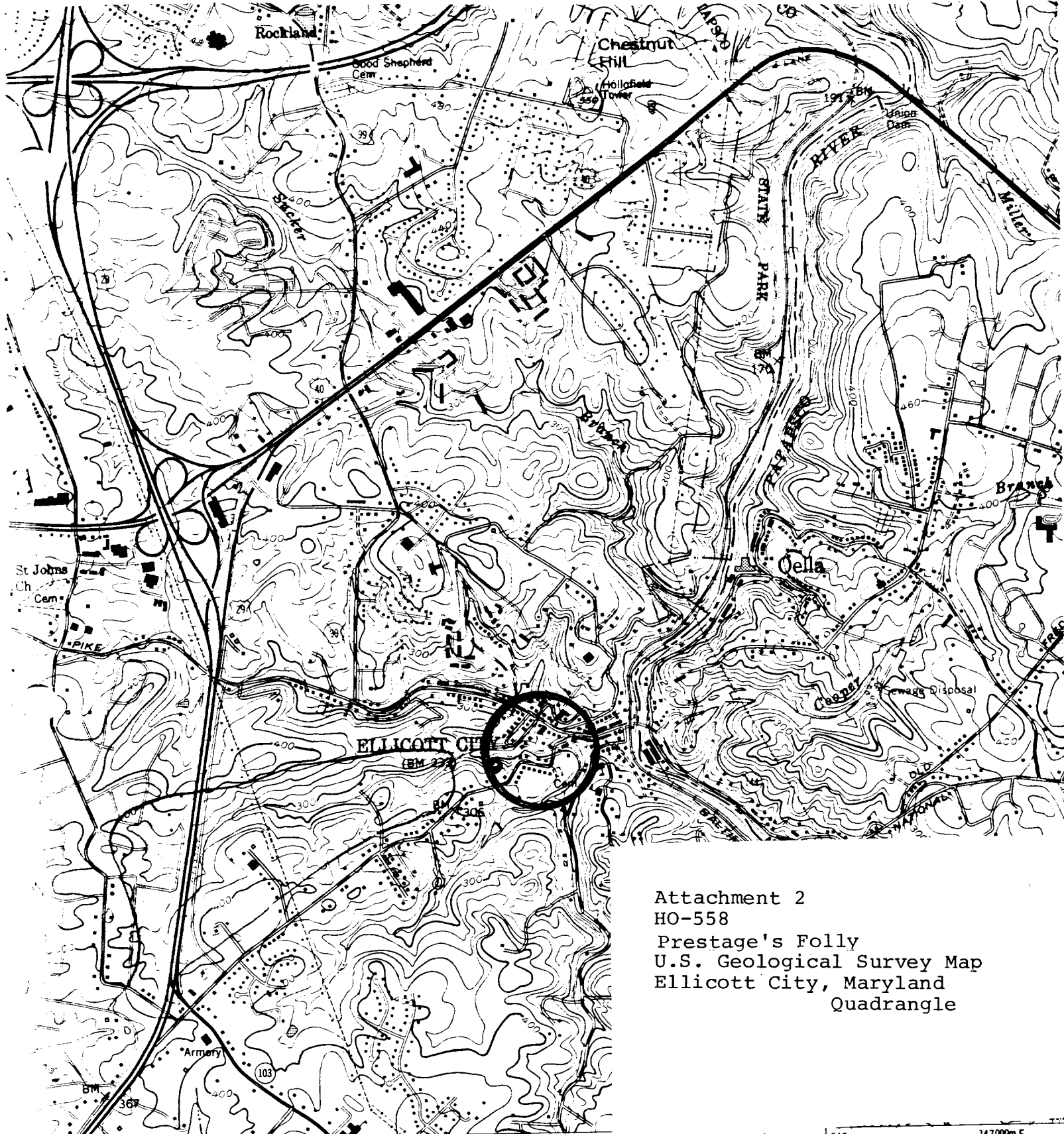

Attachment 2
 HO-558
 Prestage's Folly
 U.S. Geological Survey Map
 Ellicott City, Maryland
 Quadrangle

2 3 343 (SAVAGE) 1.3 MI. TO MD. 175 345 41 30" 346 347000m E.
 5662 III NE WEST ELK RIDGE 5.9 MI.

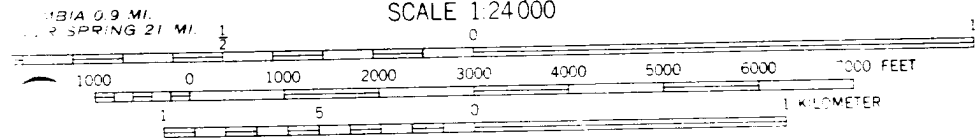

CONTOUR INTERVAL 20 FEET
 NATIONAL GEODETIC VERTICAL DATUM OF 1929

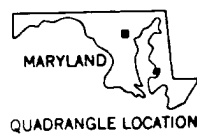



Name: HO-558
Prestage's Folly
Location: 3832 Old Columbia Pike
Ellicott City, Maryland
Photographer: Cleora B. Thompson, A.I.C.P.
Date of photograph: April, 1980
Negatives in possession of the Maryland Historical Trust
View: Northeast
Photographer looking: Southwest
Photograph number: 1 of 1