

HO-530
The William Rowles House
Elkridge
Private

circa 1857

The William Rowles House faces south on the north side of Route 1, four tenths of a mile north of its entrance, another four tenths of a mile east of its intersection with Dorsey Road. It is a three bay wide, one room deep, two story high, gabled roof (running east-west) frame, German siding, (covered with asbestos shingles) house, resting on a stone foundation, with projecting, intersecting gabled roof, central bay, holding a rectangular, double paneled vestibule entrance, flanked by five vertical side lights and surmounted by a five light transom, and unusually wide brick chimneys, which rise, terminating in square twin chimneys, inset into the east and west sides of its north wall.

The building features a "T" plan, created by a two story high, intersecting gable roof (running north-south), frame (covered with asbestos shingles) kitchen and main staircase-hall wing, with square brick chimney inset into its north wall, and one story high shed roofed appendages off its east, west and north elevations, which extends from the middle of the building's north wall.

Double casement, rectangular windows, each component holding thirty two, diamond and triangular shaped lights, rest in the east and west bays of the first floor of the south elevation and in the center of the first and second floors of the east and west elevations.

MARYLAND HISTORICAL TRUST

INVENTORY FORM FOR STATE HISTORIC SITES SURVEY

1 NAME

HISTORIC The Rowles House

AND/OR COMMON

2 LOCATION

STREET & NUMBER 7060 Washington Boulevard (Now Baltimore Washington Boulevard, U.S. 1)

CITY, TOWN Elkridge CONGRESSIONAL DISTRICT 6th

STATE Maryland COUNTY Howard

3 CLASSIFICATION

CATEGORY	OWNERSHIP	STATUS	PRESENT USE
<input type="checkbox"/> DISTRICT	<input type="checkbox"/> PUBLIC	<input checked="" type="checkbox"/> OCCUPIED	<input type="checkbox"/> AGRICULTURE <input type="checkbox"/> MUSEUM
<input checked="" type="checkbox"/> BUILDING(S)	<input checked="" type="checkbox"/> PRIVATE	<input type="checkbox"/> UNOCCUPIED	<input type="checkbox"/> COMMERCIAL <input type="checkbox"/> PARK
<input type="checkbox"/> STRUCTURE	<input type="checkbox"/> BOTH	<input type="checkbox"/> WORK IN PROGRESS	<input type="checkbox"/> EDUCATIONAL <input checked="" type="checkbox"/> PRIVATE RESIDENCE
<input type="checkbox"/> SITE	PUBLIC ACQUISITION	ACCESSIBLE	<input type="checkbox"/> ENTERTAINMENT <input type="checkbox"/> RELIGIOUS
<input type="checkbox"/> OBJECT	<input type="checkbox"/> IN PROCESS	<input checked="" type="checkbox"/> YES RESTRICTED	<input type="checkbox"/> GOVERNMENT <input type="checkbox"/> SCIENTIFIC
	<input type="checkbox"/> BEING CONSIDERED	<input type="checkbox"/> YES UNRESTRICTED	<input type="checkbox"/> INDUSTRIAL <input type="checkbox"/> TRANSPORTATION
		<input type="checkbox"/> NO	<input type="checkbox"/> MILITARY <input type="checkbox"/> OTHER

4 OWNER OF PROPERTY

NAME Mr. & Mrs. Edward P. Breitschwerdt Telephone #: 796-1274

STREET & NUMBER 7060 Washington Boulevard

CITY, TOWN Elkridge STATE, zip code Maryland 21227

5 LOCATION OF LEGAL DESCRIPTION

COURTHOUSE, REGISTRY OF DEEDS, ETC. Tax Map 37, p. 138 Liber #: 258
Hall of Records Folio #: 571

STREET & NUMBER Howard County Court House

CITY, TOWN Ellicott City STATE Maryland

6 REPRESENTATION IN EXISTING SURVEYS

TITLE Howard County Historic Sites Inventory

DATE 1978-1979 FEDERAL STATE COUNTY LOCAL

DEPOSITORY FOR SURVEY RECORDS Maryland Historical Trust

CITY, TOWN 21 State Circle, Annapolis STATE Maryland

7 DESCRIPTION

CONDITION		CHECK ONE	CHECK ONE
<input checked="" type="checkbox"/> EXCELLENT	<input type="checkbox"/> DETERIORATED	<input type="checkbox"/> UNALTERED	<input checked="" type="checkbox"/> ORIGINAL SITE
<input type="checkbox"/> GOOD	<input type="checkbox"/> RUINS	<input checked="" type="checkbox"/> ALTERED	<input type="checkbox"/> MOVED DATE _____
<input type="checkbox"/> FAIR	<input type="checkbox"/> UNEXPOSED		

DESCRIBE THE PRESENT AND ORIGINAL (IF KNOWN) PHYSICAL APPEARANCE

The William Rowles House faces south on the north side of Route 1, four tenths of a mile north of Route 1, which entrance is 4/10 of a mile east of its intersection with Dorsey Road.

It is a three bay wide, one room deep, two story high, gabled roof (running east-west) frame, German siding, (covered with asbestos shingles) house with projecting, intersecting gabled roof, central bay and unusually wide brick chimneys, which rise, ending in square twin chimneys, inset into the east and west sides of its north wall.

A two bay wide, one room deep, two story high, intersecting gabled roof (running north-south), frame (covered with asbestos shingles) kitchen wing, with square brick chimney inset into its north wall, and one story high, shed roofed appendages off its east, west and north elevations extends from the middle of the building's north wall, creating a "T" plan.

One four-over-four light and one one-over-one light, narrow rectangular second floor window, rests in the north wall with another larger staircase landing, rectangular, double-hung window, holding six-over-three lights resting in the southside of the kitchen wing's west wall. This kitchen has become a charming den with stone fireplace and one story high, shed roofed west extension which creates more spaciousness to the room, while the "L" shaped one story high, shed roofed addition on the east side of the original kitchen wing has become the new modern kitchen.

The south elevation features a rectangular, double paneled vestibule entrance door in the central projecting bay, flanked by five vertical side lights and surmounted by a five light transom, which leads into the vestibule which holds two rectangular, cross paneled doors leading into the living and dining rooms. Double casement windows, composed of thirty two, diamond shaped lights rest in the east and west bays of this elevation. These twin-casement windows are divided and flanked by flat pilasters, all of which is surmounted by a flat wooden lintel and underlined by a flat wooden sill. Above rest second floor, diamond shaped windows with four lights, which were added at a later time. A double casement second floor window similar to those below rests in the central projecting bay above the central entrance. A one story high, tin, hipped roof, open porch runs along the entire south elevation, held by six scrolled iron posts, supported by square brick posts set on a cement landing. This cement landing replaces a previous wooden one and the scrolled iron posts replace previous wooden ones, which were decorated with scrolled brackets. An old nineteenth century photograph shows the front of the house, with no diamond shaped, second floor windows and the wooden posts and brackets.

The east and west walls of the house hold tall rectangular, double casement, first and second floor windows, similar to those on the south elevation. The first floor east window is covered by a gabled roof hood, held by diagonal wooden posts.

A gabled roof, one story high, fourteen feet deep, stone ice house lies north of the house and a barn and outbuildings west.

PERIOD		AREAS OF SIGNIFICANCE -- CHECK AND JUSTIFY BELOW			
<input type="checkbox"/> PREHISTORIC	<input type="checkbox"/> ARCHEOLOGY-PREHISTORIC	<input type="checkbox"/> COMMUNITY PLANNING	<input type="checkbox"/> LANDSCAPE ARCHITECTURE	<input type="checkbox"/> RELIGION	
<input type="checkbox"/> 1400-1499	<input type="checkbox"/> ARCHEOLOGY-HISTORIC	<input type="checkbox"/> CONSERVATION	<input type="checkbox"/> LAW	<input type="checkbox"/> SCIENCE	
<input type="checkbox"/> 1500-1599	<input type="checkbox"/> AGRICULTURE	<input type="checkbox"/> ECONOMICS	<input type="checkbox"/> LITERATURE	<input type="checkbox"/> SCULPTURE	
<input type="checkbox"/> 1600-1699	<input checked="" type="checkbox"/> ARCHITECTURE	<input type="checkbox"/> EDUCATION	<input type="checkbox"/> MILITARY	<input type="checkbox"/> SOCIAL/HUMANITARIAN	
<input type="checkbox"/> 1700-1799	<input type="checkbox"/> ART	<input type="checkbox"/> ENGINEERING	<input type="checkbox"/> MUSIC	<input type="checkbox"/> THEATER	
<input checked="" type="checkbox"/> 1800-1899	<input type="checkbox"/> COMMERCE	<input type="checkbox"/> EXPLORATION/SETTLEMENT	<input type="checkbox"/> PHILOSOPHY	<input type="checkbox"/> TRANSPORTATION	
<input type="checkbox"/> 1900-	<input type="checkbox"/> COMMUNICATIONS	<input type="checkbox"/> INDUSTRY	<input type="checkbox"/> POLITICS/GOVERNMENT	<input checked="" type="checkbox"/> OTHER (SPECIFY) Local History	
		<input type="checkbox"/> INVENTION			

SPECIFIC DATES 1857

BUILDER/ARCHITECT

STATEMENT OF SIGNIFICANCE

The Rowles House is significant to Howard county and the State of Maryland historically as a part of the original land grant Troy, patented to John Dorsey in 1695 and composed of some 763 acres, which was later added to and architectually as an interesting example of nineteenth century vernacular architecture in Howard County, Maryland.

The land grant of Troy, patented in 1695 to the Honourable John Dorsey is one of the oldest in Howard County, and remained in the Dorsey family nearly a hundred years.

In 1714, the Honourable John Dorsey willed his plantation at Elk Ridge, Troy, to his grandson Basil of Caleb (of Belmont). Upon the death of Sarch, widow of Basil, the property was conveyed to their son Thomas. Elizabeth Dorsey, mentioned in old deeds was the wife of Thomas, who is believed to have constructed Troy.

Bit by bit, the Dorseys, who have often been referred to as "land poor", having owned at one time or another large tracts of land in every area of Howard County, sold portions of their holdings of Troy, Addition to Troy, Grecian Siege, and Isle of Ely.

By 1851, a Mr. Canby sold 200 acres of Troy to Anthony Johnson and until 1857, according to research of the Howard County Department of Recreation and Parks, the property changed hands several times. The summary of Parcel IVA follows:

March 11, 1851
Thomas Canby to Anthony m. Johnson
200-½ acres

May 5, 1857	Anthony Johnson to William Rowles 201 acres	18/187
March 23, 1861	William Rowles and Johnson to James Adams 1-½ acres	21/349-½
March 23, 1861	William Rowles to Richard B. Warfield 10 acres	21/371
March 23, 1861	William Rowles and Johnson to Charles Rowles 4 acres	21/369

CONTINUE ON SEPARATE SHEET IF NECESSARY

Summary of Parcel IVA (cont.)

June 29, 1880	William Rowles to Franklin Christian Kane (Morris) Rowles 4 1/4 acres	42/376
January 21, 1891	Franklin and Ida Rowles to Edward and Florence Bealmear 4 1/4 acres, 20 acres	57/31
1891	Samual Dashiell to William Rowles 144 acres (59 acres sold off)	57/24
1913	Franklin and Ida Rowles to John & Mary Shaab 144 acres, exc. 20a, 39a	94/315
January 4, 1915	Shaab to Edward Bealmear 144 a., exc.	98/289
July 24, 1954	Mary Edna Bealmear to Edward Breitschwerdt 144 acres, seven exceptions	258/571
1913	Franklin and Ida Rowles etc.	

As you can see this parcel was sold off in many little pieces, particularly after 1900. Some of the other names figuring in later ownership of small pieces are; Emma Rebecca Thompson; Charles St. Clair Thompson, Louise Perry, J.W. Marriott, Eugene Perry and Robert and Alleen Rorabaugh.

From 1857 to today the property has been owned by the Rowles associated family. The building was probably constructed between the years 1857 when Mr. Rowles bought the property and 1860, when it is noted on the 1860 Martennet Map.

Architecturally, it is one of the most outstanding houses in Howard County, featuring, original, unique double casement, rectangular windows with thirty two triangular and diamond shaped lights, a central, intersecting gabled roof, projecting bay holding the building's first floor entrance vestibule and a fine double entrance, flanked by five vertical side lights and surmounted by a five light transom.

In addition, the two wide, interior brick chimneys, inset into the north wall of the building, terminate in square, twin, brick chimneys with corbeled edging, creating an Italianate effect. This, along with such interior features as the very large rectangular double paneled doors, which are set into the dividing wall between two equal rooms and an original grey marble fireplace with flat pilasters and architrave, decorated with a central projecting shield in the west room, as well as the decorated barge boards on the projecting, intersecting gable on the south elevation offer additional evidence for a mid nineteenth century building date.

For these reasons the William Rowles House should its owners so desire, should be placed on the National Register of Historic Places, in conjunction with the Troy Historic District, the State Critical Areas Program and any local landmark legislation, which the citizens of Howard County may seek to initiate.

9 MAJOR BIBLIOGRAPHICAL REFERENCES

Land Records of Howard County
Koppenhoefer, Joetta. Troy: A Title Abstract prepared for Howard County, Department
Recreation and Parks, 1978
Interview with Mr. and Mrs. Breitschwerdt at the Rowles House, April 19, 1979

CONTINUE ON SEPARATE SHEET IF NECESSARY

10 GEOGRAPHICAL DATA

ACREAGE OF NOMINATED PROPERTY 65.30 acres

Please see Attachment 1, Tax Map 37

VERBAL BOUNDARY DESCRIPTION

Please see Howard County Land Records, Liber 258 Folio 571

LIST ALL STATES AND COUNTIES FOR PROPERTIES OVERLAPPING STATE OR COUNTY BOUNDARIES

STATE	Maryland	COUNTY	Howard
STATE		COUNTY	

11 FORM PREPARED BY

NAME / TITLE

Cleora Barnes Thompson, Archivist

ORGANIZATION

Office of Planning & Zoning-Comprehensive Planning Section

DATE

STREET & NUMBER

3450 Court House Drive

TELEPHONE

CITY OR TOWN

Ellicott City

STATE

Maryland

The Maryland Historic Sites Inventory was officially created by an Act of the Maryland Legislature, to be found in the Annotated Code of Maryland, Article 41, Section 181 KA, 1974 Supplement.

The Survey and Inventory are being prepared for information and record purposes only and do not constitute any infringement of individual property rights.

RETURN TO: Maryland Historical Trust
The Shaw House, 21 State Circle
Annapolis, Maryland 21401
(301) 267-1438

Attachment I
HO-530
The Rowles House
Tax Map 37

498

495

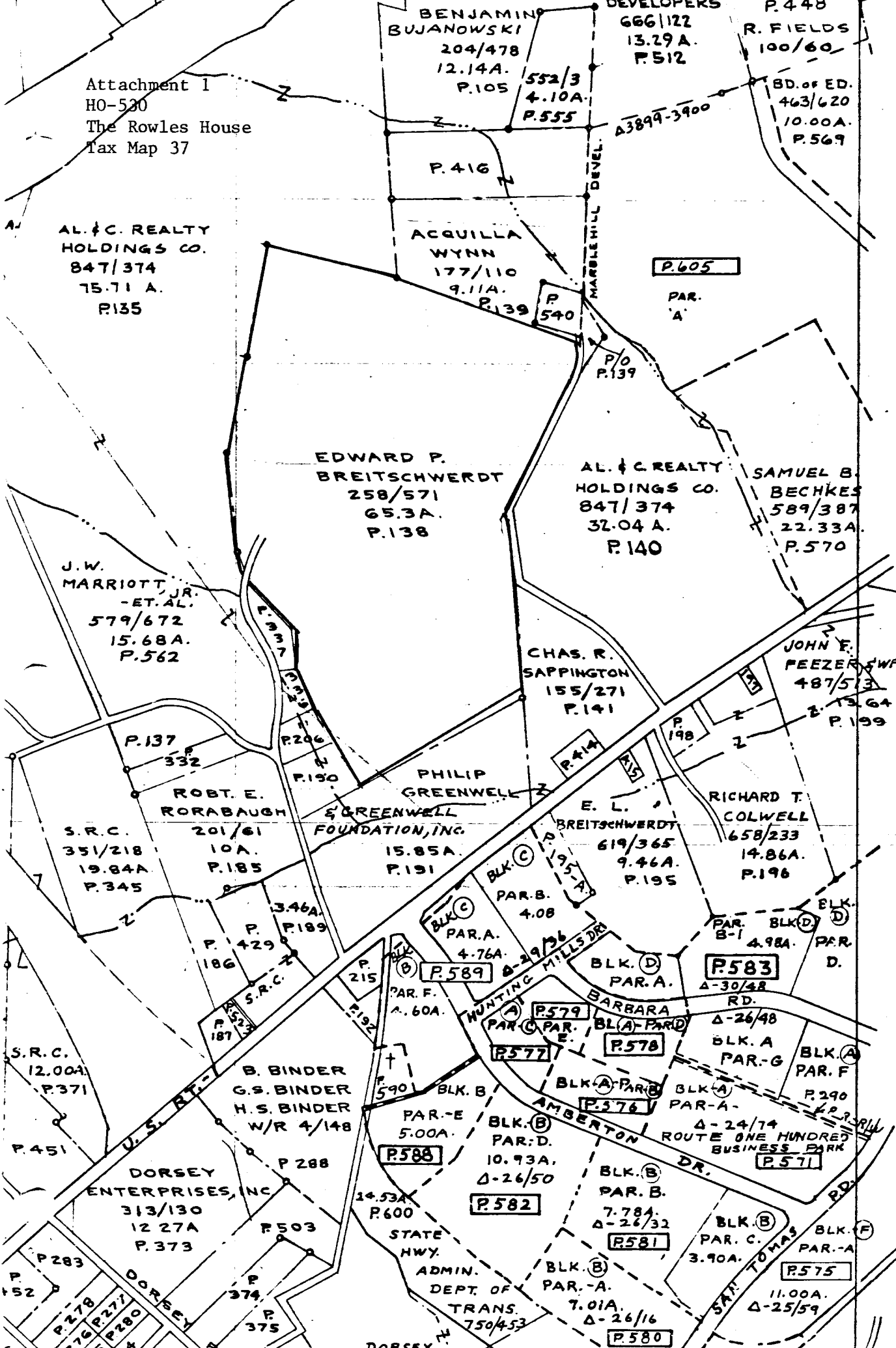

BENJAMIN
BUJANOWSKI
204/478
12.14A.
P.105

DEVELOPERS
666/122
13.29A.
P.512

P.448
R. FIELDS
100/60

BD. of ED.
463/620
10.00A.
P.569

P.416

ACQUILLA
WYNN
177/110
9.11A.
P.139

P.605

AL. & C. REALTY
HOLDINGS CO.
847/374
75.71 A.
P.135

EDWARD P.
BREITSCHWERDT
258/571
65.3A.
P.138

AL. & C. REALTY
HOLDINGS CO.
847/374
32.04 A.
P.140

SAMUEL B.
BECKES
589/387
22.33A.
P.570

J.W.
MARRIOTT, JR.
-ET. AL.
579/672
15.68A.
P.562

CHAS. R.
SAPPINGTON
155/271
P.141

JOHN F.
PEEZER, JR.
487/513
2.13.64A.
P.199

ROBT. E.
RORABAUGH
201/61
10A.
P.185

PHILIP
GREENWELL
& GREENWELL
FOUNDATION, INC.
15.85A.
P.191

E. L.
BREITSCHWERDT
619/365
9.46A.
P.195

RICHARD T.
COLWELL
658/233
14.86A.
P.196

S.R.C.
351/218
19.84A.
P.345

P.429
P.189
3.46A.
P.186

BLK. C
PAR. A.
4.76A.
P.589

BLK. D
PAR. A.
4.98A.
P.583

S.R.C.
12.00A.
P.371

B. BINDER
G.S. BINDER
H.S. BINDER
W/R 4/148

BLK. B
PAR. E.
5.00A.
P.588

BLK. B
PAR. D.
10.93A.
P.582

BLK. A
PAR. G.
P.290

DORSEY
ENTERPRISES, INC
313/130
12.27A
P.373

STATE
HWY.
ADMIN.
DEPT. OF
TRANS.
750/453

BLK. A
PAR. B.
7.78A.
P.578

BLK. A
PAR. A.
P.290

BLK. B
PAR. C.
3.90A.
P.571

BLK. B
PAR. B.
7.78A.
P.581

BLK. B
PAR. A.
11.00A.
P.575

BLK. B
PAR. A.
7.01A.
P.580

P.283
P.278
P.277
P.280

P.451
P.288
P.503
P.374
P.375

DORSEY
DR.

BLK. C
PAR. B.
4.08

BLK. D
PAR. A.
P.579

BLK. A
PAR. D.
P.577

BLK. A
PAR. A.
P.576

BLK. A
PAR. F.
P.290

BLK. B
PAR. E.
5.00A.
P.588

BLK. B
PAR. D.
10.93A.
P.582

BLK. A
PAR. B.
7.78A.
P.578

BLK. A
PAR. A.
P.290

BLK. A
PAR. F.
P.290

BLK. B
PAR. E.
5.00A.
P.588

BLK. B
PAR. D.
10.93A.
P.582

BLK. B
PAR. B.
7.78A.
P.581

BLK. B
PAR. C.
3.90A.
P.571

BLK. B
PAR. A.
11.00A.
P.575

BLK. B
PAR. A.
7.01A.
P.580

BLK. B
PAR. A.
7.01A.
P.580

BLK. B
PAR. B.
7.78A.
P.581

BLK. B
PAR. C.
3.90A.
P.571

BLK. B
PAR. A.
11.00A.
P.575

BLK. F
PAR. A.
P.290

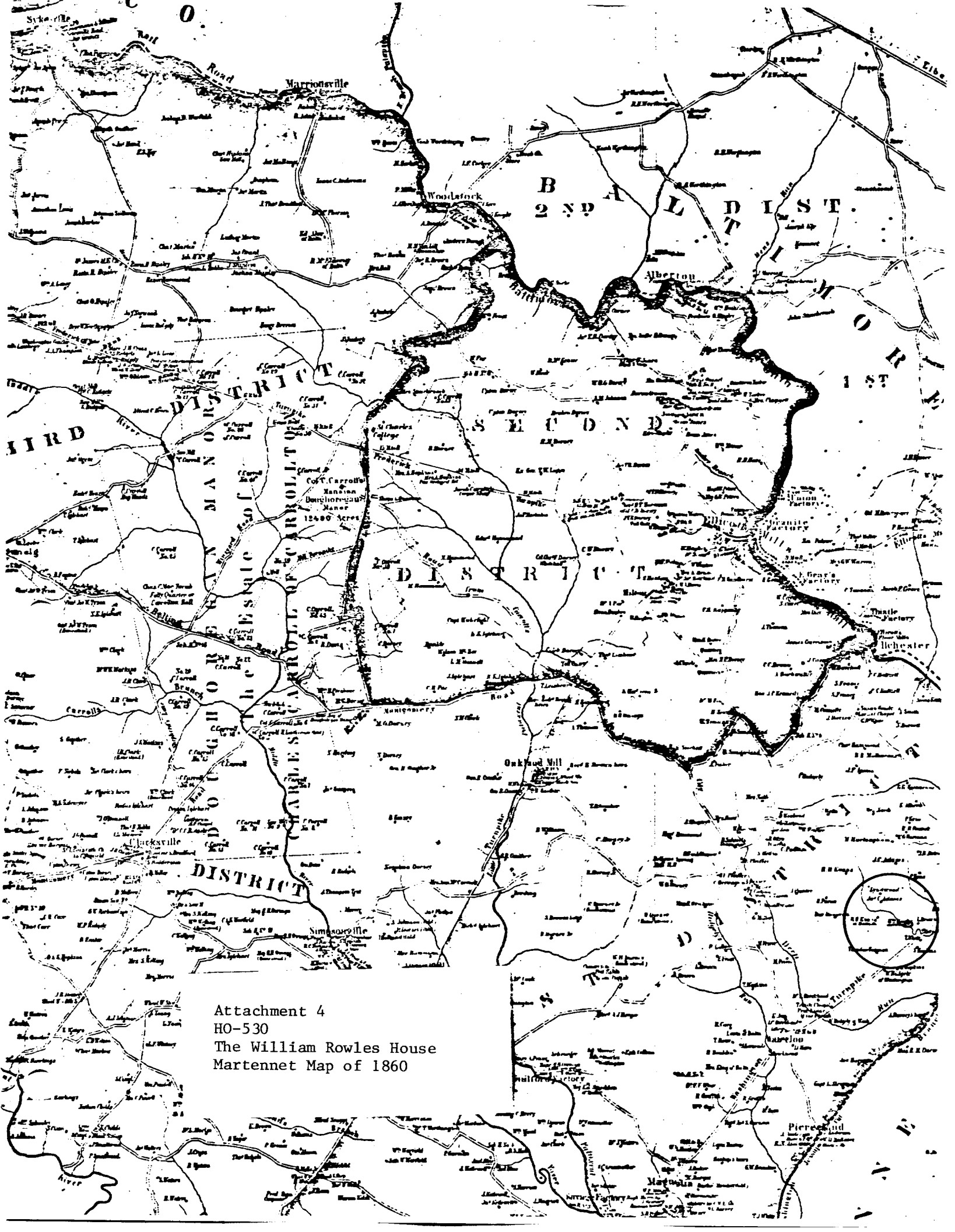

Attachment 4
HO-530
The William Rowles House
Martennet Map of 1860

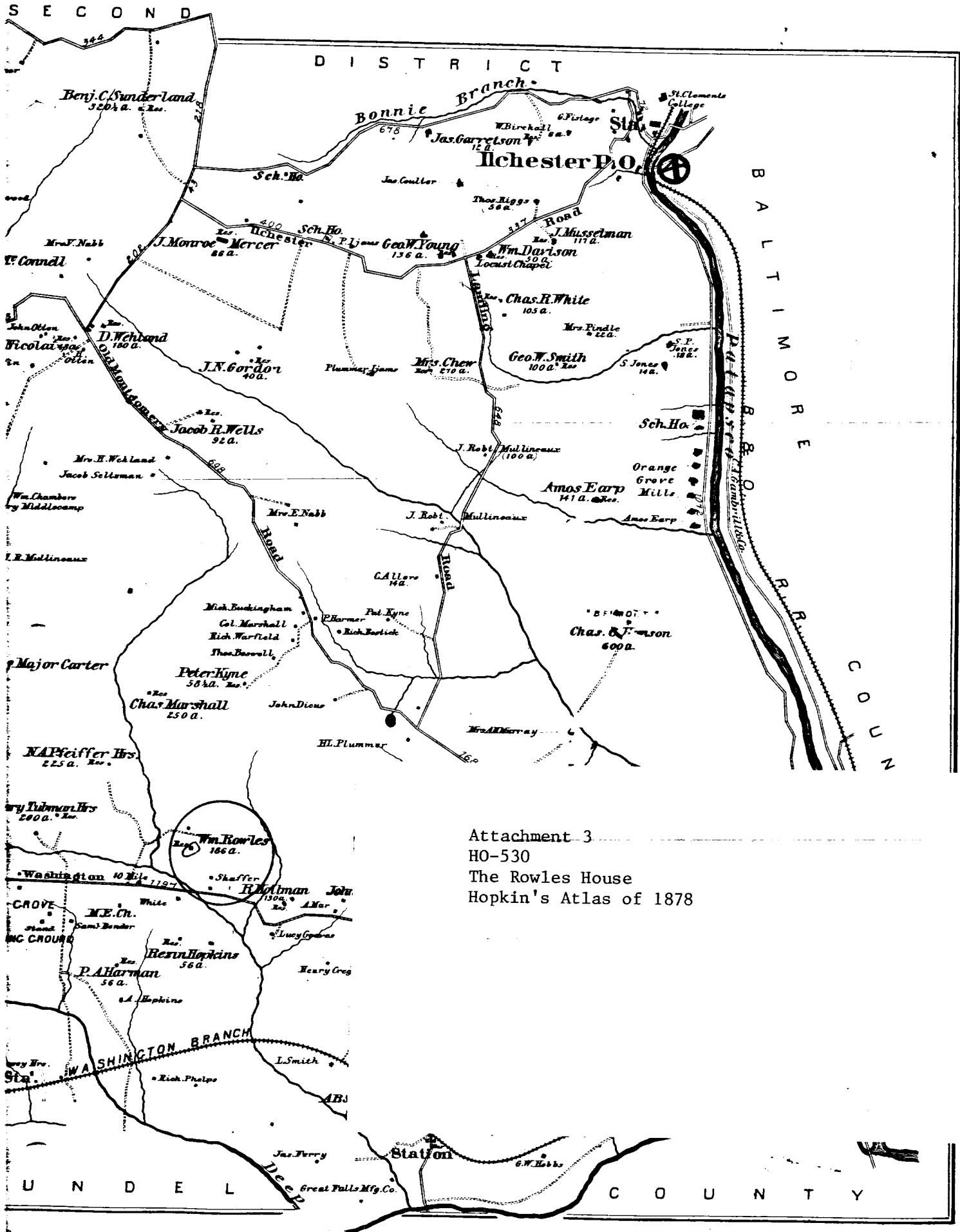

Attachment 3
 HO-530
 The Rowles House
 Hopkin's Atlas of 1878

Attachment 2
 HO-530
 The William Rowles House
 U.S. Geological Survey Map
 Savage, Maryland Quadrangle

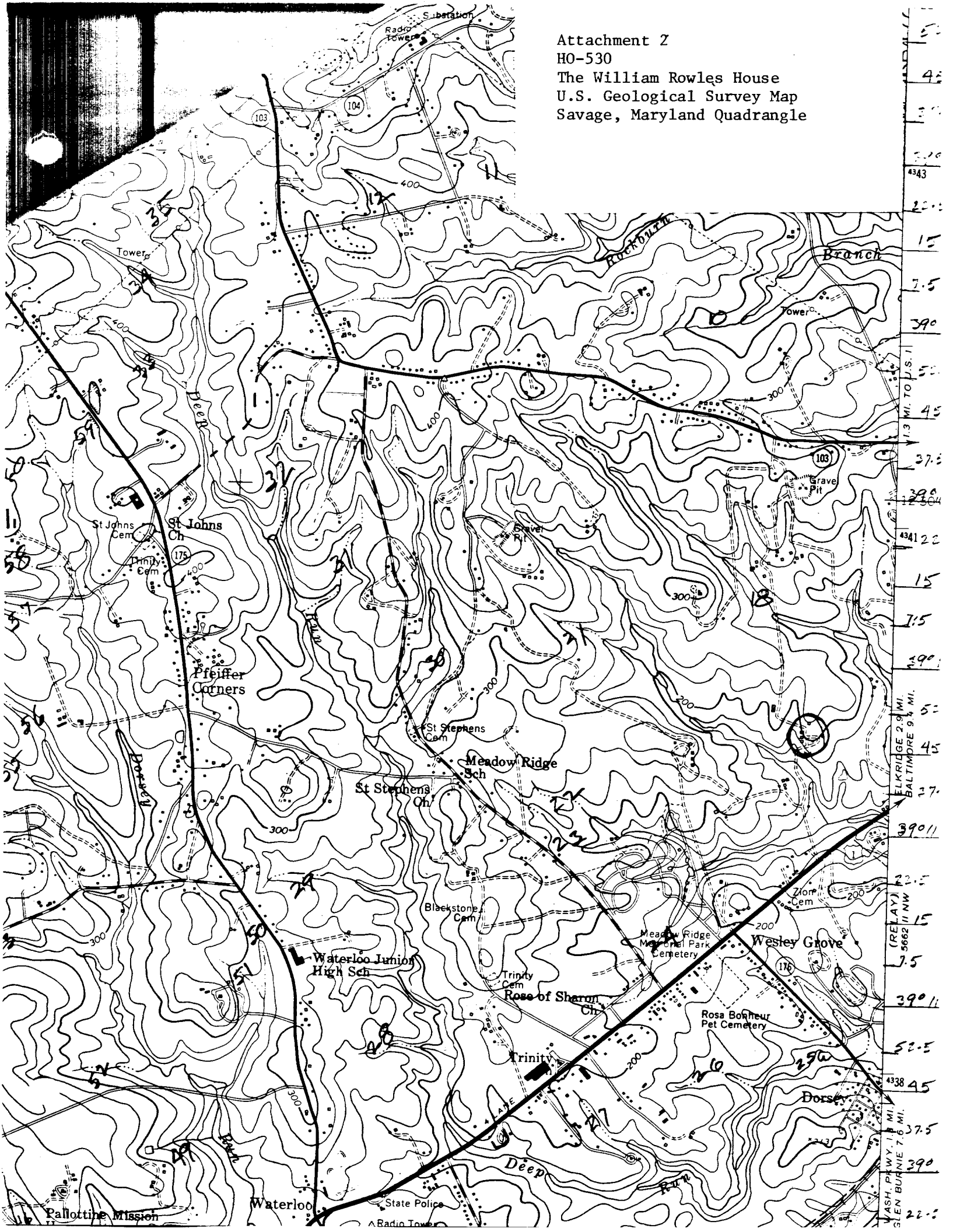



Hd - 530
THE ROWNES HOUSE
SOUTHEAST
CB THOMPSON, AICP
APRIL - 1979