

HO-528  
The Zeltmann House  
Elkridge  
Private

circa 1854

The Zeltmann House faces east, on the southeast corner of Route 103 and Old Montgomery Road. It is a three bay wide, gabled roof (running north-south) frame (covered with shingles) house, off whose west wall extends a two bay wide, one room deep, two story high, intersecting gable roof (running east-west) frame, shingled, west wing, which originally created a "T" plan. Later, two story high, intersecting gable and one story high, additions, have filled in the south west corner of the "T".

One story high, open porches run along the north and east elevations, covering rectangular entrances.

Fenestration for the house is vertically aligned, rectangular and double-hung, holding six-over-six lights.

HO-528  
The Zeltmann House  
Elkridge  
Private

circa 1854

The Zeltmann House faces east, on the southeast corner of Route 103 and Old Montgomery Road. It is a three bay wide, gabled roof (running north-south) frame (covered with shingles) house, off whose west wall extends a two bay wide, one room deep, two story high, intersecting gable roof (running east-west) frame, shingled, west wing, which originally created a "T" plan. Later, two story high, intersecting gable and one story high, additions, have filled in the south west corner of the "T".

One story high, open porches run along the north and east elevations, covering rectangular entrances.

Fenestration for the house is vertically aligned, rectangular and double-hung, holding six-over-six lights.

- NOT TO BE PUBLICIZED -

MARYLAND HISTORICAL TRUST

HO-528  
Dist. 2

MAGI # 1405285404

INVENTORY FORM FOR STATE HISTORIC SITES SURVEY

**1 NAME**

HISTORIC The Zeltman House

AND/OR COMMON

**2 LOCATION**

STREET & NUMBER 7901 Old Montgomery Road

CITY, TOWN Ellicott City VICINITY OF CONGRESSIONAL DISTRICT 6th

STATE Maryland COUNTY Howard

**3 CLASSIFICATION**

CATEGORY	OWNERSHIP	STATUS	PRESENT USE	
<input type="checkbox"/> DISTRICT	<input checked="" type="checkbox"/> PUBLIC	<input checked="" type="checkbox"/> OCCUPIED	<input type="checkbox"/> AGRICULTURE	<input type="checkbox"/> MUSEUM
<input checked="" type="checkbox"/> BUILDING(S)	<input type="checkbox"/> PRIVATE	<input type="checkbox"/> UNOCCUPIED	<input type="checkbox"/> COMMERCIAL	<input type="checkbox"/> PARK
<input type="checkbox"/> STRUCTURE	<input type="checkbox"/> BOTH	<input type="checkbox"/> WORK IN PROGRESS	<input type="checkbox"/> EDUCATIONAL	<input checked="" type="checkbox"/> PRIVATE RESIDENCE
<input type="checkbox"/> SITE	<b>PUBLIC ACQUISITION</b>	<b>ACCESSIBLE</b>	<input type="checkbox"/> ENTERTAINMENT	<input type="checkbox"/> RELIGIOUS
<input type="checkbox"/> OBJECT	<input type="checkbox"/> IN PROCESS	<input checked="" type="checkbox"/> YES: RESTRICTED	<input type="checkbox"/> GOVERNMENT	<input type="checkbox"/> SCIENTIFIC
	<input type="checkbox"/> BEING CONSIDERED	<input type="checkbox"/> YES: UNRESTRICTED	<input type="checkbox"/> INDUSTRIAL	<input type="checkbox"/> TRANSPORTATION
		<input type="checkbox"/> NO	<input type="checkbox"/> MILITARY	<input type="checkbox"/> OTHER

**4 OWNER OF PROPERTY**

NAME Ms. Anna M. Breitling

Telephone #:

STREET & NUMBER 7901 Old Montgomery Road

CITY, TOWN Ellicott City VICINITY OF STATE, zip code Maryland 21043

**5 LOCATION OF LEGAL DESCRIPTION**

COURTHOUSE, Tax Map 37, p. 29  
REGISTRY OF DEEDS, ETC. Hall of Records

Liber #: 226  
Folio #: 128

STREET & NUMBER Howard County Court House

CITY, TOWN Ellicott City STATE Maryland

**6 REPRESENTATION IN EXISTING SURVEYS**

TITLE Howard County Historic Sites Inventory

DATE 1978-1979  FEDERAL  STATE  COUNTY  LOCAL

DEPOSITORY FOR SURVEY RECORDS Maryland Historical Trust

CITY, TOWN 21 State Circle, Annapolis STATE Maryland

**7 DESCRIPTION**

CONDITION		CHECK ONE	CHECK ONE
<input type="checkbox"/> EXCELLENT	<input type="checkbox"/> DETERIORATED	<input type="checkbox"/> UNALTERED	<input checked="" type="checkbox"/> ORIGINAL SITE
<input checked="" type="checkbox"/> GOOD	<input type="checkbox"/> RUINS	<input checked="" type="checkbox"/> ALTERED	<input type="checkbox"/> MOVED    DATE _____
<input type="checkbox"/> FAIR	<input type="checkbox"/> UNEXPOSED		

---

**DESCRIBE THE PRESENT AND ORIGINAL (IF KNOWN) PHYSICAL APPEARANCE**

The Zeltman House faces east on the southeast corner of Route 103 and Old Montgomery Road. It is a three bay wide, one room deep, two story high, gabled roof (running north-south) frame (covered with shingles) house, resting on a stone foundation, off whose west wall extends a two bay wide, one room deep, two story high, intersecting gable roof (running east-west) frame, shingled west wing, which originally created a "T" plan. Later additions, however have filled in the southwest corner of the "T". They are 1) a two story high, one bay wide, two bay deep, intersecting gable-roof (running north-south) addition, which is constructed along the west wall of the main body of the house, creating a twin gable on the south elevation. 2) A one story high, shed roofed addition along the south wall of the main body of the house, and 3) a one story high, shed roofed addition along the remaining south wall of the two bay wide west wing section of the house. One story high, open porches run along the north and east elevations of the house, covering rectangular north and east entrances.

Fenestration for the house is vertically aligned, rectangular and double-hung, holding six-over-six lights.

**8 SIGNIFICANCE**

PERIOD	AREAS OF SIGNIFICANCE -- CHECK AND JUSTIFY BELOW			
<input type="checkbox"/> PREHISTORIC	<input type="checkbox"/> ARCHEOLOGY-PREHISTORIC	<input type="checkbox"/> COMMUNITY PLANNING	<input type="checkbox"/> LANDSCAPE ARCHITECTURE	<input type="checkbox"/> RELIGION
<input type="checkbox"/> 1400-1499	<input type="checkbox"/> ARCHEOLOGY-HISTORIC	<input type="checkbox"/> CONSERVATION	<input type="checkbox"/> LAW	<input type="checkbox"/> SCIENCE
<input type="checkbox"/> 1500-1599	<input type="checkbox"/> AGRICULTURE	<input type="checkbox"/> ECONOMICS	<input type="checkbox"/> LITERATURE	<input type="checkbox"/> SCULPTURE
<input type="checkbox"/> 1600-1699	<input checked="" type="checkbox"/> ARCHITECTURE	<input type="checkbox"/> EDUCATION	<input type="checkbox"/> MILITARY	<input type="checkbox"/> SOCIAL/HUMANITARIAN
<input type="checkbox"/> 1700-1799	<input type="checkbox"/> ART	<input type="checkbox"/> ENGINEERING	<input type="checkbox"/> MUSIC	<input type="checkbox"/> THEATER
<input checked="" type="checkbox"/> 1800-1899	<input type="checkbox"/> COMMERCE	<input type="checkbox"/> EXPLORATION/SETTLEMENT	<input type="checkbox"/> PHILOSOPHY	<input type="checkbox"/> TRANSPORTATION
<input type="checkbox"/> 1900-	<input type="checkbox"/> COMMUNICATIONS	<input type="checkbox"/> INDUSTRY	<input type="checkbox"/> POLITICS/GOVERNMENT	<input checked="" type="checkbox"/> OTHER (SPECIFY) Local History
		<input type="checkbox"/> INVENTION		

SPECIFIC DATES    circa 1854

BUILDER/ARCHITECT

**STATEMENT OF SIGNIFICANCE**

The Zeltman House is significant to Howard County and the State of Maryland architecturally and historically.

Architecturally, it is representative of the vernacular frame architecture of Howard County, Maryland and how it grew with the needs of its successive owners. As such, it is significant to Howard County as an example of such basic, two story high, one room deep, two or three bay wide, gabled roof, frame buildings, which were either constructed in an "L" or "T" plan or had later additions, which created such a plan. One story high, open porches usually covered entrances, providing a degree of protection during inclement weather, as we see in the Zeltman House.

Only a few nineteenth century houses remain on the north and south sides of Route 103, once known as Elkridge Landing Road, and commonly called Montgomery Road, from its intersection with Old Montgomery Road east to its intersection with U.S. Route 1. As one of such a few in number, the Zeltman House, constructed in 1854, and noted on the Martennet Map of 1860 (See Attachment 4), grows in significance. This is coupled with the fact that it is located at an intersection, and therefore, may be affected by future highway projects.

Additionally, this once thirteen acre tract was carved out of a larger tract of land called "Weaver's Lot". This fact also adds to its significance. As early as 1854, the 13 acre lot "together with all and singular the buildings" was conveyed to Louis Zealtman by William Haynes and his wife for \$138.75. This thirteen (13) acre tract of land remained intact as late as 1951, when it was conveyed to Anna Breitling and Margaret Lotz.

The history of the house is of significance to Howard County as the property of the Simon, Wess, Zeltman, Wehlands and Miller families. From 1854 to 1872, the house was the home of the Zeltman family. During that time, Katura and Louis Zealtman raised a family of six children; Frederick, Jacob, Henry, Andrew, Katherine and John. In 1872, the house was sold at public auction and acquired by Diedrick and Elizabeth Wehland for \$865 on February 19, 1873. The Wehland family held the property for only six years, when they sold it to Mary C. Simon in 1879, (40-581) for \$1500. In 1895, Mary C. Simon and her husband granted a deed to the property to Herman H. Wess for \$1350. For the next thirty years, Herman and Susan Wess owned the house, conveying it to Henry L. Miller on May 9, 1924. The Miller family held the property for over twenty years, until 1946, when Anna A. Miller conveyed the property to J. George Breitling.

Such an outline is presented for the purpose of indicating its importance to the local history of this particular area of Howard County.

**9 MAJOR BIBLIOGRAPHICAL REFERENCES**

Howard County Land Records  
Martennet Map of 1860

CONTINUE ON SEPARATE SHEET IF NECESSARY

**10 GEOGRAPHICAL DATA**

ACREAGE OF NOMINATED PROPERTY 2.79 acres

Please see Attachment 1, Tax Map 37

VERBAL BOUNDARY DESCRIPTION

Please see Howard County Land Records, Liber 226 Folio 128

LIST ALL STATES AND COUNTIES FOR PROPERTIES OVERLAPPING STATE OR COUNTY BOUNDARIES

STATE Maryland COUNTY Howard

STATE \_\_\_\_\_ COUNTY \_\_\_\_\_

**11 FORM PREPARED BY**

NAME / TITLE

Cleora Barnes Thompson, Archivist

ORGANIZATION

Office of Planning & Zoning-Comprehensive Planning Section

DATE

STREET & NUMBER

3450 Court House Drive

TELEPHONE

CITY OR TOWN

Ellicott City

STATE

Maryland

The Maryland Historic Sites Inventory was officially created by an Act of the Maryland Legislature, to be found in the Annotated Code of Maryland, Article 41, Section 181 KA, 1974 Supplement.

The Survey and Inventory are being prepared for information and record purposes only and do not constitute any infringement of individual property rights.

RETURN TO: Maryland Historical Trust  
The Shaw House, 21 State Circle  
Annapolis, Maryland 21401  
(301) 267-1438

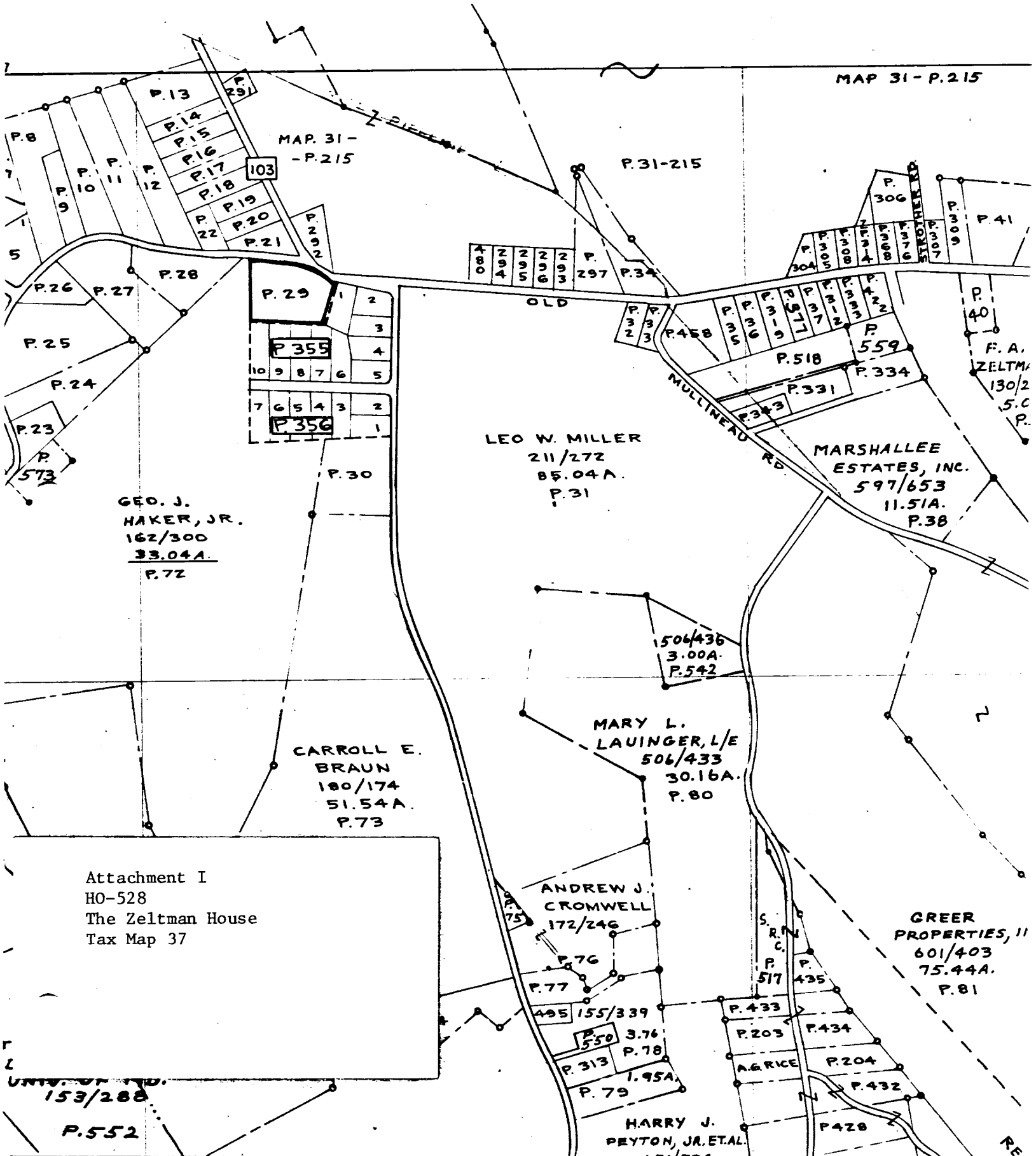

Attachment I  
 HO-528  
 The Zeltman House  
 Tax Map 37

UNITS OF LAND  
 153/288

P.552

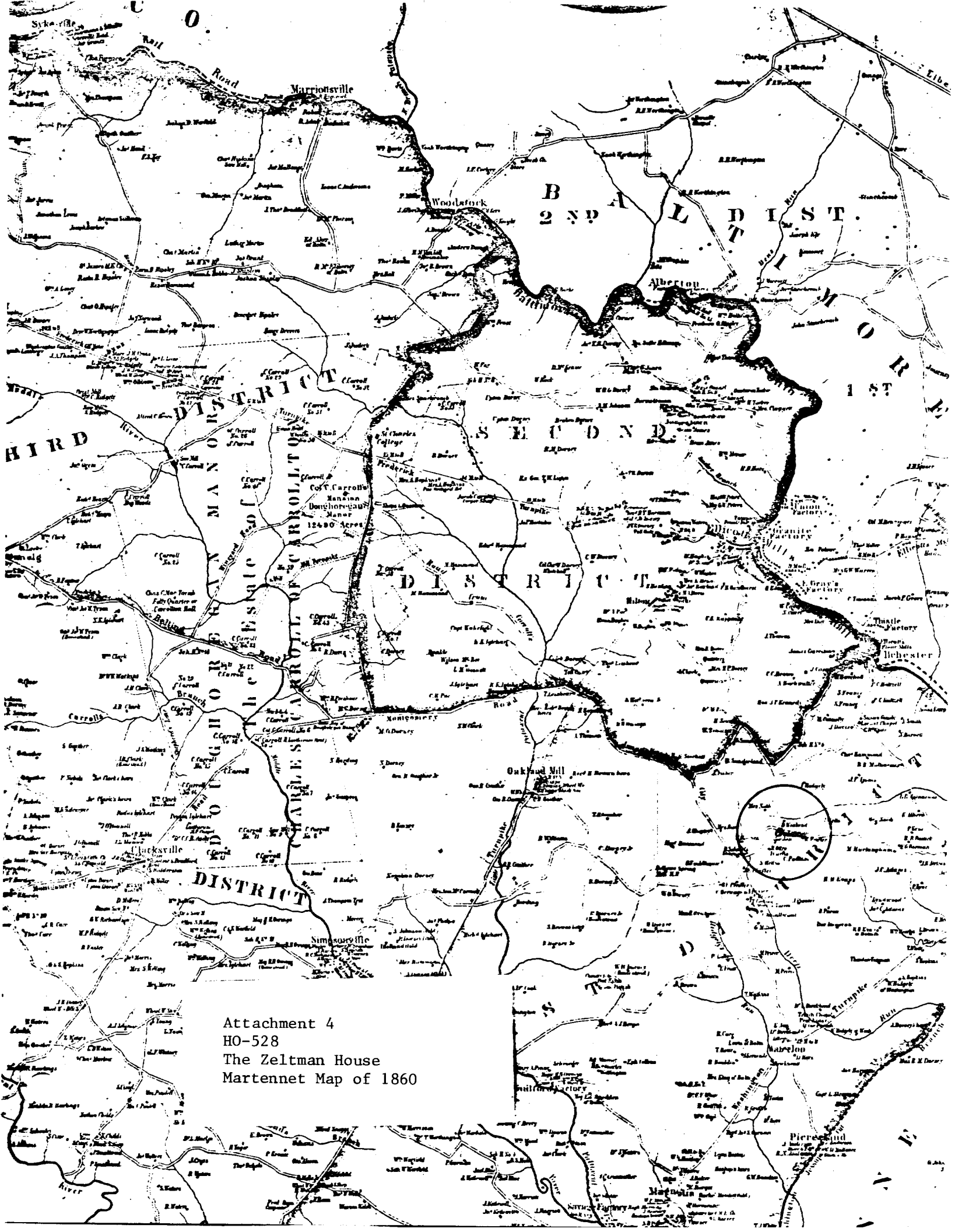

Attachment 4  
HO-528  
The Zeltman House  
Martennet Map of 1860



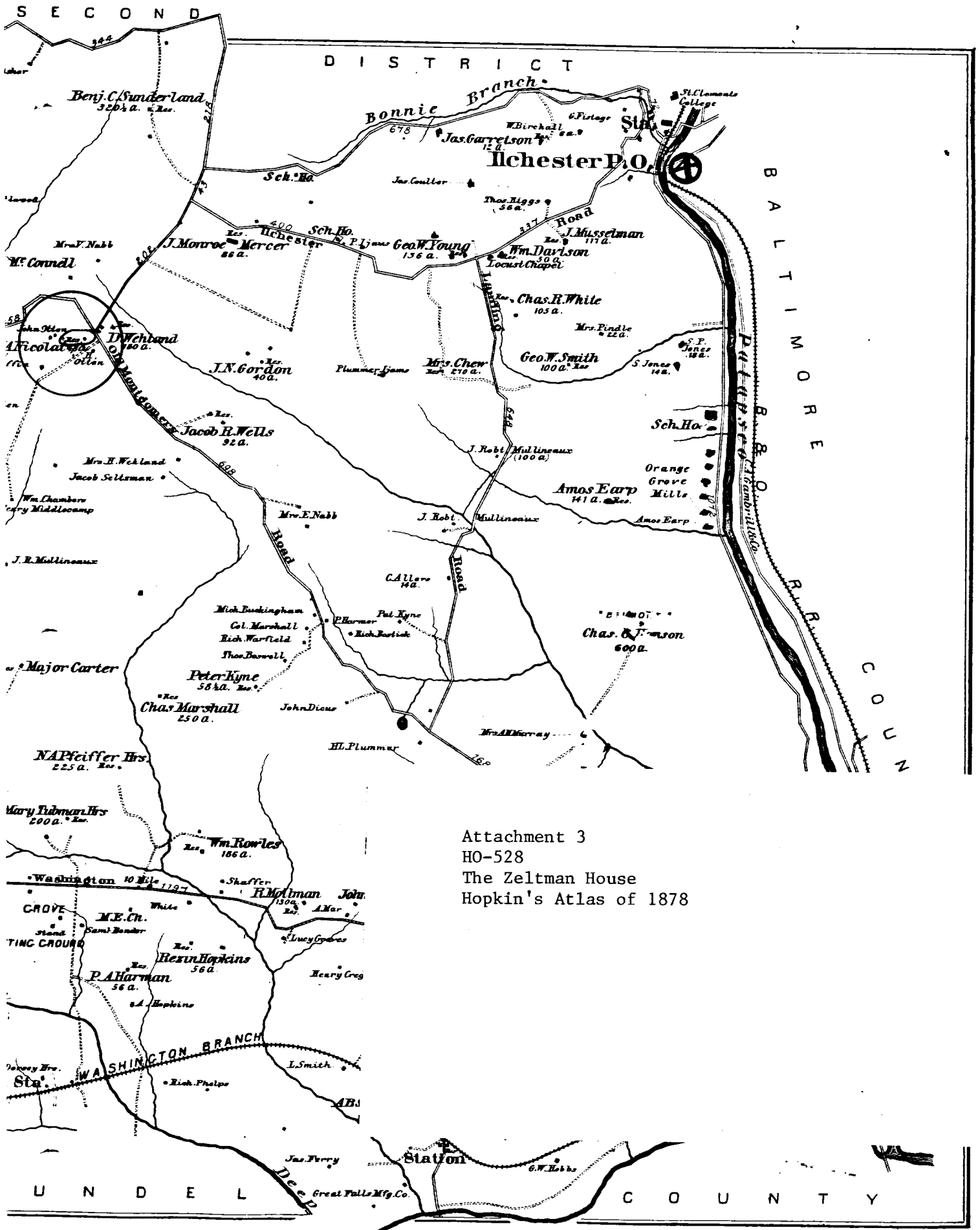

Attachment 3  
 HO-528  
 The Zeltman House  
 Hopkin's Atlas of 1878

# LOOD-PRONE AREAS

SAVAGE QU

MARY

7.5 MINUTE SERIES

NE 1/4 LAUREL



Attachment II  
HO-528  
The Zeltman House  
U.S. Geological Survey Map  
Savage, Maryland Quadrangle



NOT FOR PUBLICATION

HO-528  
The Zettman House  
Northeast  
O B THOMPSON, AICP  
APRIL, 1979