

Ho-380

The Misses Dobbins' House/Thomas Dobbin House
Elk Ridge
Private

1875

This house faces south on the north side of Old Lawyers Hill road, east of the intersection of Lawyers Hill Road. Built by Thomas M. Dobbin, son of Judge George Washington Dobbin, after whom the Lawyers Hill area was named, it served for almost fifty years as solely a summer home for the Dobbin family.

It is a three bay wide, two bay deep, two story high, gabled roof (running north-south) frame structure built on a partial stone foundation with two square corbeled brick chimneys placed on each side of the apex of its roof line.

A one story high, hipped roof, open porch, supported by eight square columns with scrolled brackets runs along the west and south walls of the building.

An east wing of WWI vintage is placed on its east wall, two bays wide, two bays deep and two stories high. Its intersecting gabled roof runs east-west.

A rectangular front entrance is located in the east bay of the south wall, with two three-three light french doors to the west and another two on the west wall, all entering on to the open porch.

Second floor double-hung windows holding two-over-two lights are vertically aligned and proportionally scaled with the central front window covered by a hood and surmounted by a roman arched vent, representative of the romanesque revival in American architecture during this time.

INVENTORY FORM FOR STATE HISTORIC SITES SURVEY

1 NAME

HISTORIC The Misses' Dobbins House/The Thomas Dobbins House

AND/OR COMMON
The Dougherty House

2 LOCATION

STREET & NUMBER 6078 Old Lawyers Hill Road

CITY, TOWN ElkrIDGE VICINITY OF CONGRESSIONAL DISTRICT Sixth District

STATE Maryland COUNTY Howard County

3 CLASSIFICATION

CATEGORY	OWNERSHIP	STATUS	PRESENT USE
<input checked="" type="checkbox"/> DISTRICT	<input type="checkbox"/> PUBLIC	<input checked="" type="checkbox"/> OCCUPIED	<input type="checkbox"/> AGRICULTURE
<input type="checkbox"/> BUILDING(S)	<input checked="" type="checkbox"/> PRIVATE	<input type="checkbox"/> UNOCCUPIED	<input type="checkbox"/> COMMERCIAL
<input type="checkbox"/> STRUCTURE	<input type="checkbox"/> BOTH	<input type="checkbox"/> WORK IN PROGRESS	<input type="checkbox"/> EDUCATIONAL
<input type="checkbox"/> SITE	PUBLIC ACQUISITION	<input checked="" type="checkbox"/> ACCESSIBLE	<input type="checkbox"/> ENTERTAINMENT
<input type="checkbox"/> OBJECT	<input type="checkbox"/> IN PROCESS	<input type="checkbox"/> YES, RESTRICTED	<input type="checkbox"/> GOVERNMENT
	<input type="checkbox"/> BEING CONSIDERED	<input type="checkbox"/> YES, UNRESTRICTED	<input type="checkbox"/> INDUSTRIAL
		<input type="checkbox"/> NO	<input type="checkbox"/> MILITARY
			<input type="checkbox"/> MUSEUM
			<input type="checkbox"/> PARK
			<input checked="" type="checkbox"/> PRIVATE RESIDENCE
			<input type="checkbox"/> RELIGIOUS
			<input type="checkbox"/> SCIENTIFIC
			<input type="checkbox"/> TRANSPORTATION
			<input type="checkbox"/> OTHER

4 OWNER OF PROPERTY

NAME Mr. and Mrs. George N. Dougherty Telephone #: 796-5228

STREET & NUMBER Old Lawyers Hill Road

CITY, TOWN ElkrIDGE VICINITY OF Maryland STATE 21227' zip code

5 LOCATION OF LEGAL DESCRIPTION

COURTHOUSE, REGISTRY OF DEEDS, ETC Tax Map 32 p. 55 Hall of Records

Liber #: 308
Folio #: 97

STREET & NUMBER Howard County Court House

CITY, TOWN Ellicott City STATE Maryland

6 REPRESENTATION IN EXISTING SURVEYS

TITLE Howard County Historic Sites Inventory

DATE 1977 FEDERAL STATE COUNTY LOCAL

DEPOSITORY FOR SURVEY RECORDS Maryland Historical Trust

CITY, TOWN 21 State Circle, Annapolis STATE Maryland

7 DESCRIPTION

Ho-380
Dist 1

corr. copy

CONDITION

EXCELLENT
 GOOD
 FAIR

DETERIORATED
 RUINS
 UNEXPOSED

CHECK ONE

UNALTERED
 ALTERED

CHECK ONE

ORIGINAL SITE
 MOVED DATE _____

DESCRIBE THE PRESENT AND ORIGINAL (IF KNOWN) PHYSICAL APPEARANCE

The Misses Dobbins' House also known as the Thomas Dobbin House, faces south on the north side of Old Lawyers Hill Road east of the intersection of Lawyers Hill Road. It is a three bay wide, two bay deep, two story high, gabled roof (running north-south) frame structure built on a partial stone foundation with two square brick chimneys with decorative corbeling placed on each side of the apex of its roof line. A one story high, hipped roof open porch supported by eight square columns with decorative scrolled brackets runs along the west and south walls of the building.

A two story high, shed roofed addition extends from the north wall of the east wing. A rectangular entrance covered by a hipped roof portico supported by two columns rests in its east wall with a double 8-8 light casement second floor window located above. A square brick chimney decorated with corbeling is centered into the east wall of the east wing which matches those of the west wing.

An east wing is placed on its east wall, two bays wide, two bays deep and two stories high. Its intersecting gabled roof runs east-west.

A rectangular front entrance is located in the east bay of the south wall, with two 2/2 light windows to the west and two 3-3 light french doors on the west wall entering on the open porch. Second floor windows are proportionally scaled and vertically aligned to the first floor doors, and hold two-over-two lights, decorated with flat wooden lintels and black wooden shutters.

The front facade holds a central second floor window similar to the others but covered with a copper hood supported by wooden brackets and surmounted by a roman arched attic vent.

Two four light, square, second floor casement windows are located on the east wall of the east wing. A six light first floor casement window is located in the south bay of this wall and a six-over-six light, double hung, rectangular window in the north bay. These windows are surmounted by flat wood lintels and flanked by flat wooden pilasters.

The main body of the house was constructed circa 1875 by Thomas M. Dobbin, son of Judge George Washington Dobbin. The roman arched vent above the central hooded, second floor window is indicative of the romanesque revival which spread through American domestic architecture in the mid nineteenth century.

CONTINUE ON SEPARATE SHEET IF NECESSARY

PERIOD		AREAS OF SIGNIFICANCE -- CHECK AND JUSTIFY BELOW			
<input type="checkbox"/> PREHISTORIC	<input type="checkbox"/> ARCHEOLOGY-PREHISTORIC	<input type="checkbox"/> COMMUNITY PLANNING	<input type="checkbox"/> LANDSCAPE ARCHITECTURE	<input type="checkbox"/> RELIGION	
<input type="checkbox"/> 1400-1499	<input checked="" type="checkbox"/> ARCHEOLOGY-HISTORIC	<input type="checkbox"/> CONSERVATION	<input type="checkbox"/> LAW	<input type="checkbox"/> SCIENCE	
<input type="checkbox"/> 1500-1599	<input type="checkbox"/> AGRICULTURE	<input type="checkbox"/> ECONOMICS	<input type="checkbox"/> LITERATURE	<input type="checkbox"/> SCULPTURE	
<input type="checkbox"/> 1600-1699	<input checked="" type="checkbox"/> ARCHITECTURE	<input type="checkbox"/> EDUCATION	<input type="checkbox"/> MILITARY	<input type="checkbox"/> SOCIAL/HUMANITARIAN	
<input type="checkbox"/> 1700-1799	<input type="checkbox"/> ART	<input type="checkbox"/> ENGINEERING	<input type="checkbox"/> MUSIC	<input type="checkbox"/> THEATER	
<input checked="" type="checkbox"/> 1800-1899	<input type="checkbox"/> COMMERCE	<input type="checkbox"/> EXPLORATION/SETTLEMENT	<input type="checkbox"/> PHILOSOPHY	<input type="checkbox"/> TRANSPORTATION	
<input type="checkbox"/> 1900-	<input type="checkbox"/> COMMUNICATIONS	<input type="checkbox"/> INDUSTRY	<input type="checkbox"/> POLITICS/GOVERNMENT	<input type="checkbox"/> OTHER (SPECIFY)	
		<input type="checkbox"/> INVENTION			

SPECIFIC DATES 1867

BUILDER/ARCHITECT

STATEMENT OF SIGNIFICANCE

The Misses Dobbins house, formerly the Thomas Dobbin house, is significant historically and architecturally. The land on which this house stands is part of the property described in two deeds to Judge George W. Dobbin, the first from Andrew Ellicott et al. dated February 15, 1845 (5-469) called "Barren Hills", being 10 acres, and 10 square perches and the second from James A. Murray, administrator, dated March 1, 1853 (WWW 13-213) "together with all the improvements thereon made," being a part of the "Rock burn, including six acres, three rods and fourteen square perches.

James A. Murray, administrator of Mary Murray of Rockburn, sold it to George Washington Dobbin.

On January 5, 1866 George W. Dobbin et al were complainants and a certain St. George W. Teakle et al, defendants in a cause of equity. Nicholas G. Penniman was appointed trustee by order of the Supreme Court of Baltimore City in place instead of Robert A. Dobbin, former trustee, then deceased. Nicholas G. Penniman as trustee sold a portion of the property to Susan D. Mayer and allotted certain other portions to the several children of the said George W. Dobbin on June 19, 1874.

On August 7, 1875 Thomas M. Dobbin acquired the property, "together with all the improvements thereon, made and being erected." (LJW 35-465)

On July 19, 1881 Thomas N, Dobbin and Bessie his wife conveyed the property to Charles E. Wethered, George L. Harrison and Charles K. Harrison, trustees as security for the sum of \$5,000 (43-471) The property contained 4 1/2 acres "together with all the improvements. On January 7, 1884 Bessie H. Dobbin, his wife acquired the land from these trustees upon payment of the \$5,000 with all interest due (LJW 47-439)

In 1936 Bessie H. Dobbin left her three daughters, as heirs, the summer home. Jeanette B. Dobbin. Rebecca Dobbin and Anne Bathurst Dobbin

Ho-380

Dist 1

It along with this whole section at Lawyers Hill should be placed on the National Register of Historic places as well as made a local historic district should its residents so desire.

9 MAJOR BIBLIOGRAPHICAL REFERENCES

Howard County Land Records
Hopkins Atlas of 1878
Interview with Mrs. Jeanne Dougherty, December 28, 1977

CONTINUE ON SEPARATE SHEET IF NECESSARY

10 GEOGRAPHICAL DATA

ACREAGE OF NOMINATED PROPERTY 1.50 acres

Please see Attachment 1
Tax Map 32, p. 55

VERBAL BOUNDARY DESCRIPTION

Please see Howard County Land Records
Liber 308, Folio 97

LIST ALL STATES AND COUNTIES FOR PROPERTIES OVERLAPPING STATE OR COUNTY BOUNDARIES

STATE Maryland COUNTY Howard

STATE COUNTY

11 FORM PREPARED BY

NAME / TITLE

Cleora Barnes Thompson, Archivist

ORGANIZATION

Office of Planning & Zoning-Comprehensive Planning Section

DATE

TELEPHONE

STREET & NUMBER

3450 Court House Drive

CITY OR TOWN

Ellicott City

STATE

Maryland

The Maryland Historic Sites Inventory was officially created by an Act of the Maryland Legislature, to be found in the Annotated Code of Maryland, Article 41, Section 181 KA, 1974 Supplement.

The Survey and Inventory are being prepared for information and record purposes only and do not constitute any infringement of individual property rights.

RETURN TO: Maryland Historical Trust
The Shaw House, 21 State Circle
Annapolis, Maryland 21401
(301) 267-1438

Attachment I
HO-380
The Misses Dobbins' House
Tax Maps 32 and 38

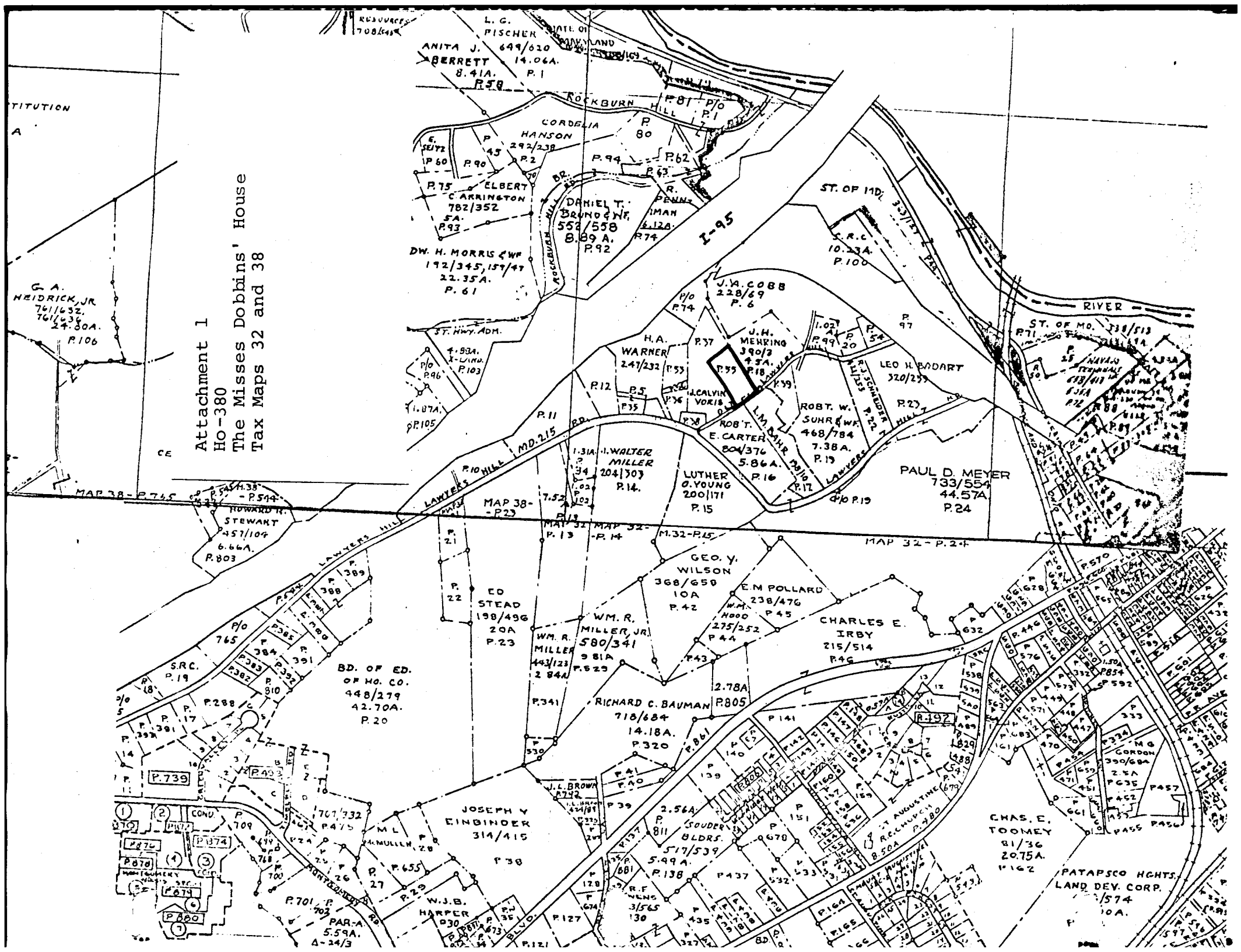

L. G. FISCHER
ANITA J. BERRETT
8.41A. P.1
R.58

ROCKBURN HILL
CORDELIA HANSON
E. SEITZ
P.60
P.90
P.45
P.2
P.94
P.62
P.63
DANIEL T. BRANDENBUR
552/558
8.89 A.
P.92

DW. H. MORRIS & WIFE
192/345, 157/47
22.35A.
P.61

J. A. COBB
228/69
P.6

H. A. WARNER
247/232
P.53

ROBT. W. SUHR & WIFE
468/784
7.38A.
P.13

PAUL D. MEYER
733/554
44.57A
P.24

J. WALTER MILLER
1.31A
204/303
P.14

GEO. Y. WILSON
368/650
10A
P.42

CHARLES E. IRBY
215/514
P.46

WM. R. MILLER, JR.
580/341
9.81A
P.523

RICHARD C. BAUMAN
718/684
14.18A.
P.320

JOSEPH Y. EINGBINDER
314/415
P.38

CHAS. E. TOOMEY
81/36
20.75A
P.162

G. A. HEIDRICK, JR.
761/652.
761/638
24.80A.
P.106

MAP 38-P.24
P.544.38
P.544
STEWART
257/104
6.66A.
R.803

BD. OF ED. OF HO. CO.
448/279
42.70A.
P.20

W. J. B. HARPER
030
P.127

PATAPSCO HGHTS. LAND DEV. CORP.
P.574
10A.

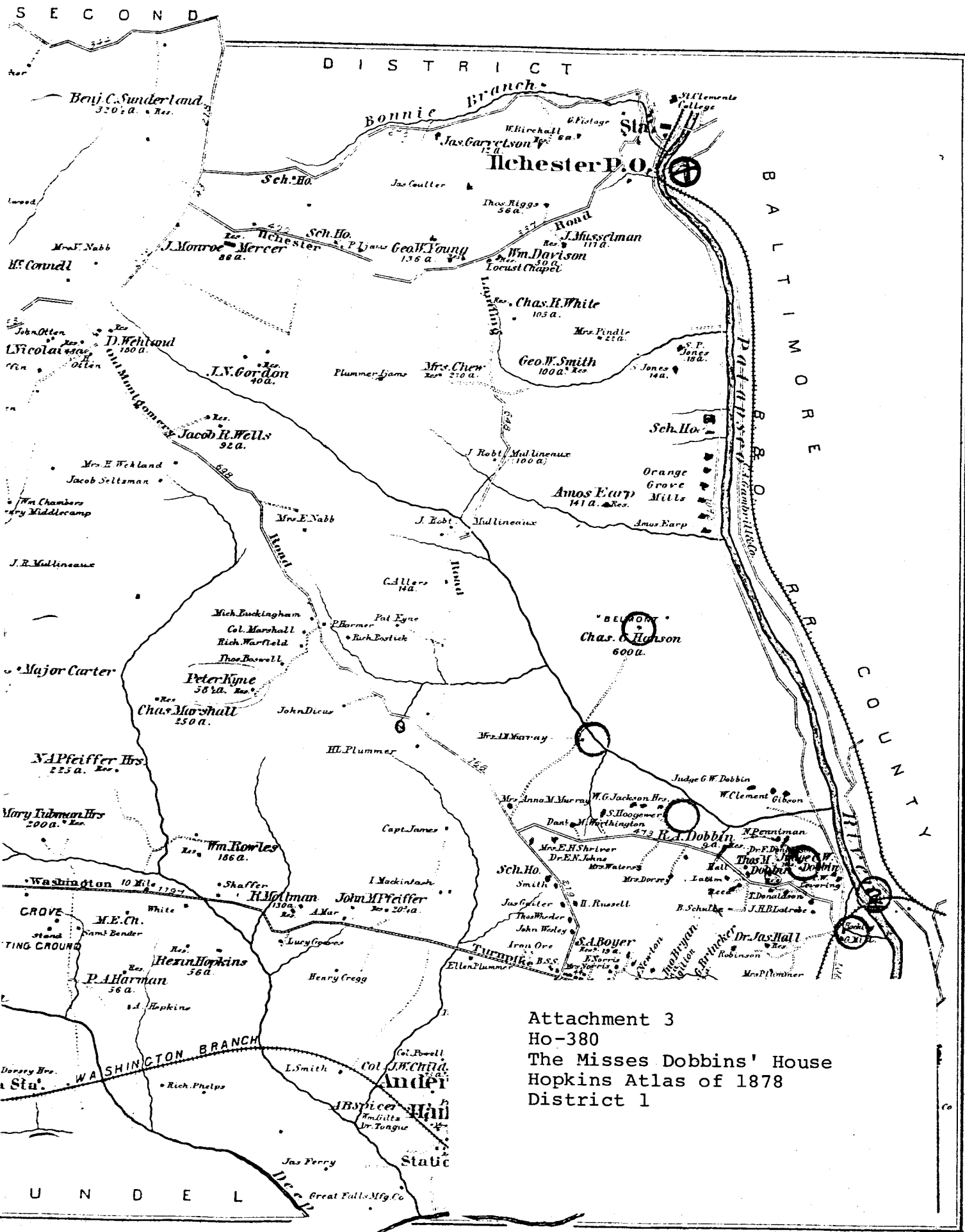

Attachment 3
 Ho-380
 The Misses Dobbins' House
 Hopkins Atlas of 1878
 District 1

5/24/50
12/25/50

52.5
45
37.5
4345000m N
39°14'30"
22.5
15
25
4344
39°14'00"
52.5
45
37.5
39°13'30"
4343
22.5
15
25
39°13'00"
4342
52.5
45
32.5
39°12'30"
42'30"
22.5
15

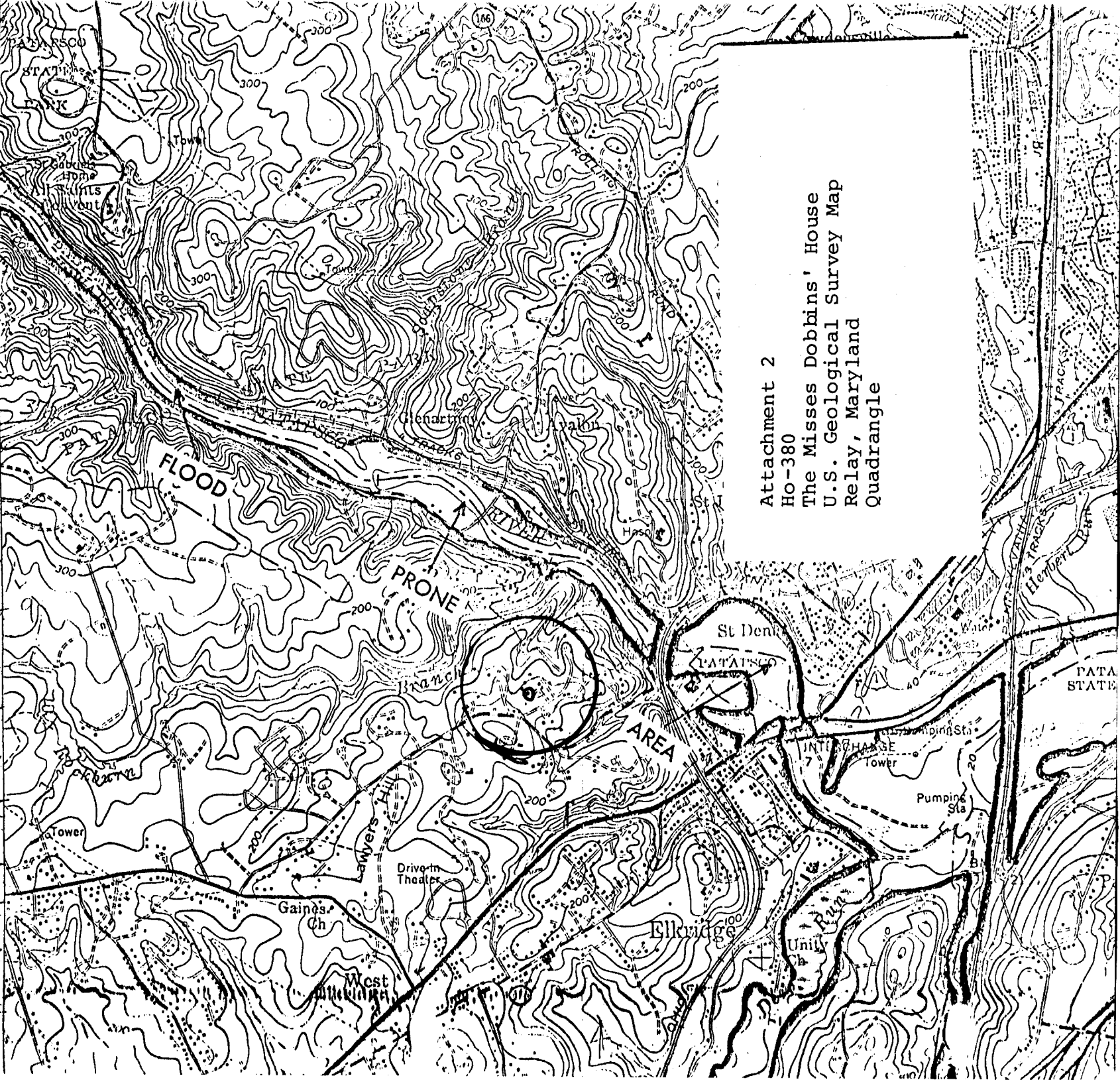

Attachment 2
HO-380
The Misses Dobbins' House
U.S. Geological Survey Map
Relay, Maryland
Quadrangle



Ho-380
The misses Dobbins' House
South
C.B. Thompson, A/P
Dec. 1917