

~~HO-351~~ HO-298

~~Old~~ St. Peter's Church Rectory & Parish House
Ellicott City
Private

CIRCA 1880

Old St. Peter's Church Rectory faces south at the east end of St. Paul's Place, southeast of St. Paul's Roman Catholic Church.

It is a Victorian frame cottage, reminiscent of the Italianate with its vertical siding, constructed in an "L" plan, composed of a three bay wide, one bay deep, one-and-a-half story high, high pitched gable roof (running east-west) frame (covered with vertical barn siding, with beveled edges) east wing, resting on a granite block foundation, connecting to the center of the east wall of a three bay wide, one bay deep, one-and-a-half story high, intersecting, high pitched, gable roof (running north-south) frame (covered with vertical barn siding with beveled edges) west wing, resting on a granite block foundation. A one-and-a-half story high, shed roofed extension runs along the north wall of the east wing, lying flush with the north wall of the west wing.

Fenestration for the house is vertically aligned and proportionally scaled. Almost all of the windows are rectangular and double-hung, with sashes holding two-over-two lights. Beveled pilasters flank these windows, which are underlined by projecting wooden sills.

This building is notable historically as the Old Rectory for St. Peter's Episcopal Church, which during the middle of the nineteenth century, stood south of St. Paul's Roman Catholic Church, before it burned to the ground and was relocated on the northeast corner of Main Street and Rogers Avenue.

MARYLAND HISTORICAL TRUST

~~HO-351~~ HO-298
 Ellicott City Quad.
 District 2
 MAGI #1403512628

INVENTORY FORM FOR STATE HISTORIC SITES SURVEY

1 NAME

HISTORIC

~~Old~~ St. Peter's Church Rectory and Parish House

AND/OR COMMON

2 LOCATION

STREET & NUMBER 8205
 820~~5~~ St. Paul Place

CITY, TOWN

Ellicott City — VICINITY OF

CONGRESSIONAL DISTRICT

6th

STATE

Maryland

COUNTY

Howard

3 CLASSIFICATION

CATEGORY	OWNERSHIP	STATUS	PRESENT USE	
<input type="checkbox"/> DISTRICT	<input type="checkbox"/> PUBLIC	<input type="checkbox"/> OCCUPIED	<input type="checkbox"/> AGRICULTURE	<input type="checkbox"/> MUSEUM
<input checked="" type="checkbox"/> BUILDING(S)	<input checked="" type="checkbox"/> PRIVATE	<input checked="" type="checkbox"/> UNOCCUPIED	<input type="checkbox"/> COMMERCIAL	<input type="checkbox"/> PARK
<input type="checkbox"/> STRUCTURE	<input type="checkbox"/> BOTH	<input type="checkbox"/> WORK IN PROGRESS	<input type="checkbox"/> EDUCATIONAL	<input type="checkbox"/> PRIVATE RESIDENCE
<input type="checkbox"/> SITE	PUBLIC ACQUISITION	ACCESSIBLE	<input type="checkbox"/> ENTERTAINMENT	<input type="checkbox"/> RELIGIOUS
<input type="checkbox"/> OBJECT	<input type="checkbox"/> IN PROCESS	<input checked="" type="checkbox"/> YES: RESTRICTED	<input type="checkbox"/> GOVERNMENT	<input type="checkbox"/> SCIENTIFIC
	<input type="checkbox"/> BEING CONSIDERED	<input type="checkbox"/> YES: UNRESTRICTED	<input type="checkbox"/> INDUSTRIAL	<input type="checkbox"/> TRANSPORTATION
		<input type="checkbox"/> NO	<input type="checkbox"/> MILITARY	<input checked="" type="checkbox"/> OTHER (vacant)

4 OWNER OF PROPERTY

NAME St. Paul's Catholic Church

Telephone #: 465-1670

STREET & NUMBER

3749 St. Paul's Street

CITY, TOWN

Ellicott City — VICINITY OF

STATE, zip code

Maryland

5 LOCATION OF LEGAL DESCRIPTION

COURTHOUSE Tax Map 25A P-120
 REGISTRY OF DEEDS, ETC. Hall of Records

Liber #: 832

Folio #: 29

STREET & NUMBER

Howard County Court House

CITY, TOWN

Ellicott City

STATE

Maryland

6 REPRESENTATION IN EXISTING SURVEYS

TITLE

Howard County Historic Sites Inventory

DATE

1978-1979

FEDERAL STATE COUNTY LOCAL

DEPOSITORY FOR SURVEY RECORDS

Maryland Historical Trust

CITY, TOWN

21 State Circle, Annapolis

STATE

Maryland

7 DESCRIPTION

CONDITION		CHECK ONE	CHECK ONE
<input type="checkbox"/> EXCELLENT	<input type="checkbox"/> DETERIORATED	<input type="checkbox"/> UNALTERED	<input checked="" type="checkbox"/> ORIGINAL SITE
<input checked="" type="checkbox"/> GOOD	<input type="checkbox"/> RUINS	<input checked="" type="checkbox"/> ALTERED	<input type="checkbox"/> MOVED DATE _____
<input type="checkbox"/> FAIR	<input type="checkbox"/> UNEXPOSED		

DESCRIBE THE PRESENT AND ORIGINAL (IF KNOWN) PHYSICAL APPEARANCE

Old St. Peter's Church Rectory faces south at the east end of St. Paul's Place, southeast of St. Paul's Roman Catholic Church.

It is a Victorian frame cottage, reminiscent of the Italianate with its vertical siding, constructed in an "L" plan, composed of a three bay wide, one bay deep, one-and-a-half story high, high pitched gable roof (running east-west) frame (covered with vertical barn siding, with beveled edges) eastwing, resting on a full, granite block foundation, connecting to the center of the east wall of a three bay wide, one bay deep, one-and-a-half story high, intersecting high pitched, gable roof (running north-south) frame (covered with vertical barn siding with beveled edges) west wing, resting on a granite block foundation.

THE SOUTH ELEVATION

The south elevation of the west wing holds a hipped roof, central, bay window, holding three, rectangular, double-hung windows, with one-over-one lights. Windows are surmounted by flat wooden lintels, flanked by beveled pilasters and underlined by projecting, wooden sills.

A similar second floor window is centered into the eave line of the steeply pitched gable at this elevation.

The west bay of the south elevation of the east wing holds the main entrance, a rectangular, cross paneled entrance door, surmounted by a blocked in transom and flanked by beveled pilasters.

A rectangular, double-hung, first floor window, similar to those described, holding two-over-two lights, is placed in the east and central bays of this wall. This elevation also features two gabled roofs, dormer windows, holding roman arched, double-hung windows, with two-over-two lights.

A one story high, open porch runs along the entire south elevation of this east wing. It is held by wooden posts decorated with fan-like carved brackets with three cut outs.

THE NORTH ELEVATION

The north elevation of the west wing holds a central, first and second floor window, similar to those described. Along the north elevation of the east wing runs a one-and-a-half story high, shed roofed extension lying flush with the north wall of the west wing. It holds a central, one-over-one light, rectangular window, flanked by larger, rectangular, double-hung windows, holding six-over-six lights.

CONTINUE ON SEPARATE SHEET IF NECESSARY

DESCRIPTION
Page (2) of (2)

A gabled roof dormer is placed on the west side of its roof. It holds a rectangular, double-hung six-over-six light window.

THE EAST ELEVATION

The east elevation of the east wing holds a central rectangular, first and second floor window, similar to those described. A rectangular first floor kitchen entrance door was placed in the north extension's east wall, but now leads into an enclosed kitchen appendage, which originally was probably an open porch with a staircase down to the ground level.

The building is constructed into a steep slope of land on the west side at Maryland Avenue, so that the granite block foundation on the east elevation becomes a full story. It features a rectangular cellar door, surmounted by a flat stone lintel on the south and a partially double-hung window, surmounted by a flat stone lintel, holding six-over-six lights, on the north side.

Remnants of an old brick chimney stack rests on the north side of a new, square brick, exterior chimney, both of which rest between the east wing and its extension and the basement entrance and window.

A narrow poured-in place concrete stairway, composed of some forty-eight steps, flanked by an iron railing leads from Maryland Avenue up the steep bank to the old rectory. This stairway passes along the north wall of the old St. Peter's Frame Parish House, which presently also lies vacant.

WEST ELEVATION

The west elevation holds three rectangular, first floor windows and two gabled roof end bay dormer windows, holding roman arched window, holding two-over-two lights. A central intersecting gable holds a second floor, rectangular entrance door with an iron staircase leading down to the ground level.

THE INTERIOR PLAN

The interior plan for the house has been altered by a previous owner to accommodate several apartments, on the first and second, as well as the ground floor.

Hardwood floors cover what once were random width floors. Woodwork around original door and window frames also remains intact.

8 SIGNIFICANCE

PERIOD	AREAS OF SIGNIFICANCE -- CHECK AND JUSTIFY BELOW			
<input type="checkbox"/> PREHISTORIC	<input type="checkbox"/> ARCHEOLOGY-PREHISTORIC	<input type="checkbox"/> COMMUNITY PLANNING	<input type="checkbox"/> LANDSCAPE ARCHITECTURE	<input checked="" type="checkbox"/> RELIGION
<input type="checkbox"/> 1400-1499	<input checked="" type="checkbox"/> ARCHEOLOGY-HISTORIC	<input type="checkbox"/> CONSERVATION	<input type="checkbox"/> LAW	<input type="checkbox"/> SCIENCE
<input type="checkbox"/> 1500-1599	<input type="checkbox"/> AGRICULTURE	<input type="checkbox"/> ECONOMICS	<input type="checkbox"/> LITERATURE	<input type="checkbox"/> SCULPTURE
<input type="checkbox"/> 1600-1699	<input checked="" type="checkbox"/> ARCHITECTURE	<input type="checkbox"/> EDUCATION	<input type="checkbox"/> MILITARY	<input type="checkbox"/> SOCIAL/HUMANITARIAN
<input type="checkbox"/> 1700-1799	<input type="checkbox"/> ART	<input type="checkbox"/> ENGINEERING	<input type="checkbox"/> MUSIC	<input type="checkbox"/> THEATER
<input checked="" type="checkbox"/> 1800-1899	<input type="checkbox"/> COMMERCE	<input type="checkbox"/> EXPLORATION/SETTLEMENT	<input type="checkbox"/> PHILOSOPHY	<input type="checkbox"/> TRANSPORTATION
<input type="checkbox"/> 1900-	<input type="checkbox"/> COMMUNICATIONS	<input type="checkbox"/> INDUSTRY	<input type="checkbox"/> POLITICS/GOVERNMENT	<input type="checkbox"/> OTHER (SPECIFY)
		<input type="checkbox"/> INVENTION		

SPECIFIC DATES Circa 1880

BUILDER/ARCHITECT

STATEMENT OF SIGNIFICANCE

Old St. Peter's Rectory is notable historically to Howard County and the State of Maryland as one of two visual expressions of the Episcopal complex, which once occupied the south side of Bank Street at this location and significant architecturally as an outstanding example of a Victorian Frame Cottage.

A brief history of St. Peter's Episcopal Church reveals the fact that St. Peter's was once called "Grace Church of the Village of Ellicott Mills", incorporated on the 30th of May, 1843, under act of the General Assembly of Maryland of 1802, Chapter III, entitled an act to incorporate certain persons of every Christian Church or congregation in this State.

An old deed in which Allen Thomas conveyed a parcel of land to this church stated the following:

"Whereas Allen Thomas is desirous to endow the said vestry of Grace Church and their successors with the lot of ground hereinafter described for the purposes of erecting the said church thereon to be dedicated to the worship of Almighty God according to the manners and customs of the Protestant Episcopal Church of Maryland." (Howard County Land Records, Liber 4, Folio 373)

A sum of five (\$5.00) dollars was paid by the vestry and what was later known as St. Peter's Episcopal Church was constructed at this location. The Reverend Alfred Holmead, erstwhile Chaplain of the Patapsco Female Institute, was appointed first pastor of Grace, later known as St. Peter's Episcopal Church. He served from April 20, 1942 through 1947.

A panaramic view of Ellicott's Mills, Maryland, 1854, by John Schofield indicates St. Peter's Church in this location, southwest of the present old rectory. This church was later destroyed by fire and a new church constructed on the northeast corner of Roger's Avenue and Main Street.

On June 15, 1854, a Libertus VanBokkelen conveyed an additional tract of land to the Vestry of St. Peter's Church at Ellicott's Mills. The present rectory is believed to stand on this latter tract of land, although no reference as to the purpose of property was stated in the deed, so often customary in regard to church property.

The old rectory does not appear to have been constructed until after 1860 for it is not noted on the Martinet Map of 1860. A building is, however, noted at this location on the Hopkin's Atlas of 1878.

Architecturally, the building is a Victorian gem, believed to have been originally constructed in a "T" plan, with one-story high, shed roofed, open porches along the north and south walls of the east wing. The north wall was enclosed to provide an additional service wing, covered by similar vertical siding, found on the rest of the building.

Any change which has occurred to the original building has not impaired its original integrity.

Its outstanding architectural features; the four gabled roof, south and west, dormer windows, the entire southwest corner of the building, its original frame siding, and the original pegged, mortise and tenon window sashes, remain intact.

The basic condition of the building appears to be excellent, constructed on a strong, granite block foundation, with no apparent damage to its supporting members.

The site of the Old St. Peters Rectory is also important, as it is located south of the Old Patapsco Bank Building (later serving as the St. Paul's School) north of the Old St. Peter's Parish House, and southeast of St. Paul's Roman Catholic Church and Convent. The building, in conjunction with its neighbors, comprises an important nineteenth century, architectural complex, which is located in the Ellicott City National Register District, as well as in the local historic district of Ellicott City.

9 MAJOR BIBLIOGRAPHICAL REFERENCES

Howard County Land Records
Interview with Mr. Ray Clark, of St. Paul's Church on April 8, 1980.

CONTINUE ON SEPARATE SHEET IF NECESSARY

10 GEOGRAPHICAL DATA

ACREAGE OF NOMINATED PROPERTY _____

Please see Attachment 1, Tax Map 25A

VERBAL BOUNDARY DESCRIPTION

Please see Howard County Land Records, Liber 832 Folio 29

LIST ALL STATES AND COUNTIES FOR PROPERTIES OVERLAPPING STATE OR COUNTY BOUNDARIES

STATE Maryland COUNTY Howard

STATE _____ COUNTY _____

11 FORM PREPARED BY

NAME / TITLE

Cleora Barnes Thompson, Archivist

ORGANIZATION

Office of Planning & Zoning-Comprehensive Planning Section

DATE

STREET & NUMBER

3450 Court House Drive

TELEPHONE

CITY OR TOWN

Ellicott City

STATE

Maryland

The Maryland Historic Sites Inventory was officially created by an Act of the Maryland Legislature, to be found in the Annotated Code of Maryland, Article 41, Section 181 KA, 1974 Supplement.

The Survey and Inventory are being prepared for information and record purposes only and do not constitute any infringement of individual property rights.

RETURN TO: Maryland Historical Trust
The Shaw House, 21 State Circle
Annapolis, Maryland 21401
(301) 267-1438

TITLE SEARCH

~~HO-351~~ HO-298

~~OLD~~ ST. PETER'S RECTORY AND PARISH HOUSE

prepared by Cleora B. Thompson

<u>DATE</u>	<u>LIBER-FOLIO</u>	<u>GRANTOR</u>	<u>GRANTEE</u>	<u>TRANSACTION</u>
24 Jun. 1977	832-29	Samuel H. Caplan & Gertrude D. Caplan	The Most Reverend William D. Borders	Deed to two parcels of land
22 Sept. 1959	340-85	Maud Mae Mead	Samuel H. Caplan	Deed to "Lot E & F described in a conveyance from "Part of the Rock Hill College pro- perty."
6 Jan. 1943	177-24	Vestry of St. Peter's P.E. Church of Ellicott City	Samuel H. Caplan	Deed to Parcel One & Parcel Two
15 June 1854	WHW15-334	Libertus VanBokkelen & Amelie VanBokkelen	Howard Swan, et al, constituting the Vestry of St. Peter's Church at Ellicott Mills	Deed to Parcel Two
29 July 1843	4-373	Allen Thomas	Vestry of Grace Church of Village of Ellicott Mills	Deed to Parcel One

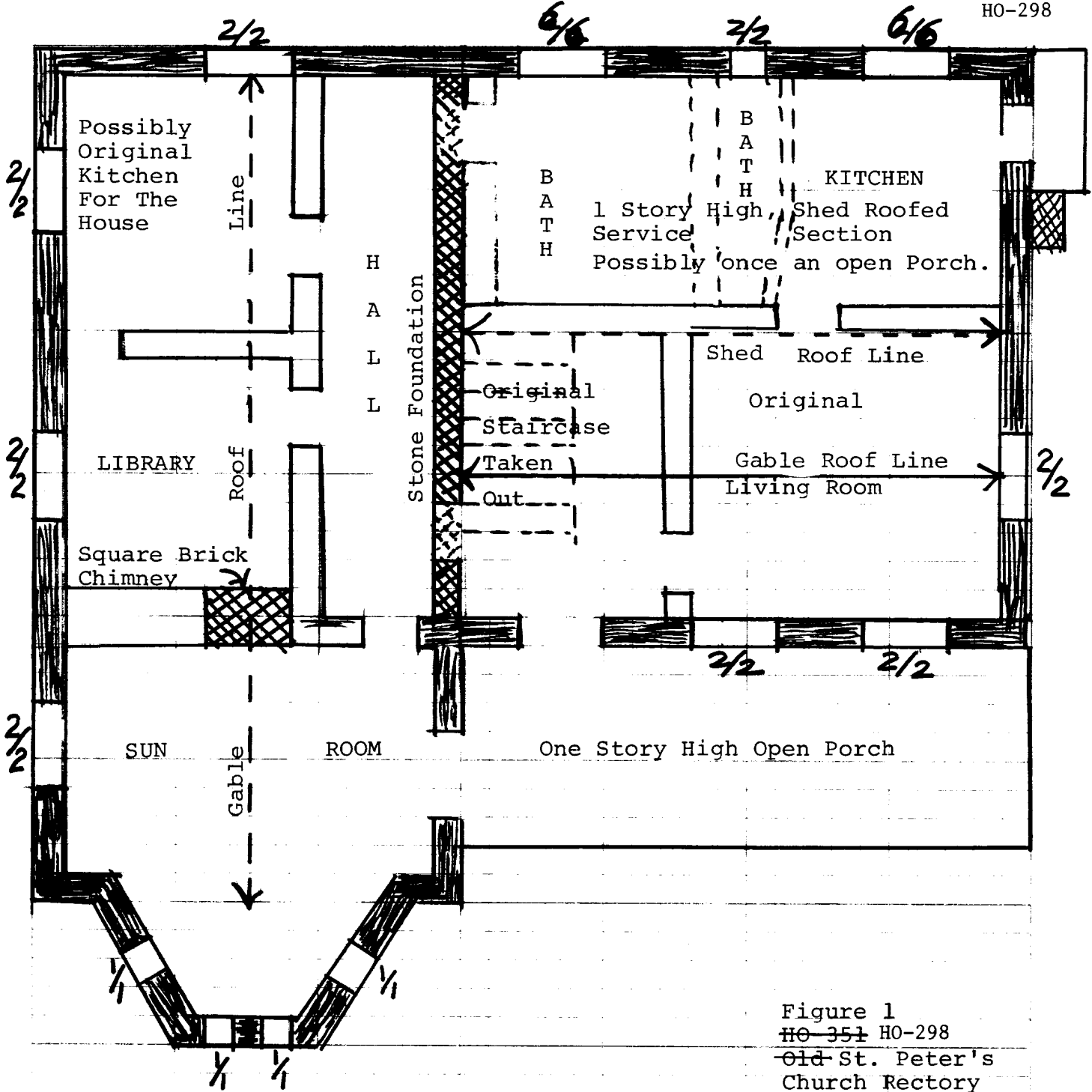
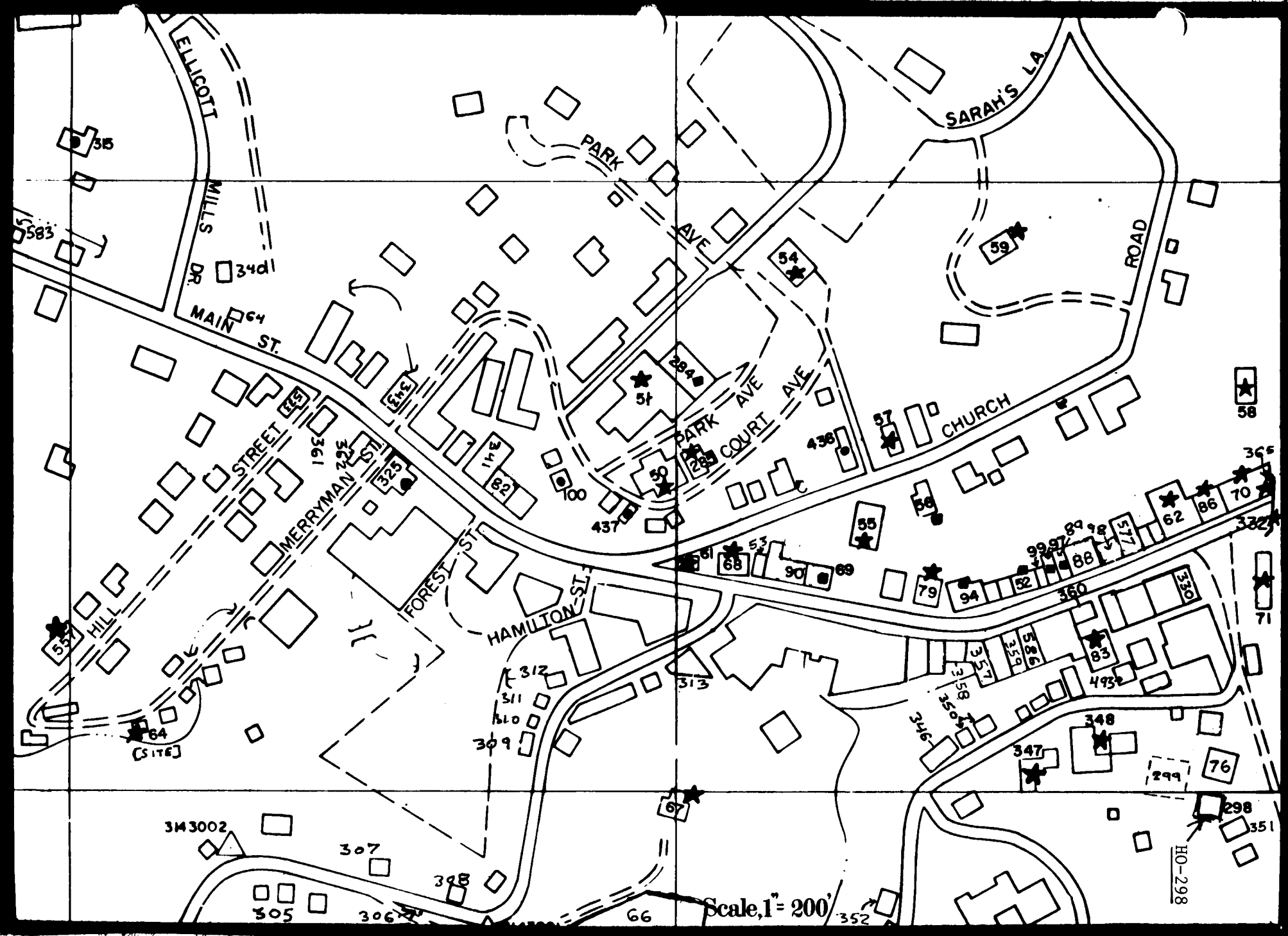

Figure 1
~~HO-351~~ HO-298
 Old St. Peter's
 Church Rectory
 and Parish House
 First Floor Plan



St. Peters' Church Rectory and Parish House, 8205 St. Paul Place

HO-298



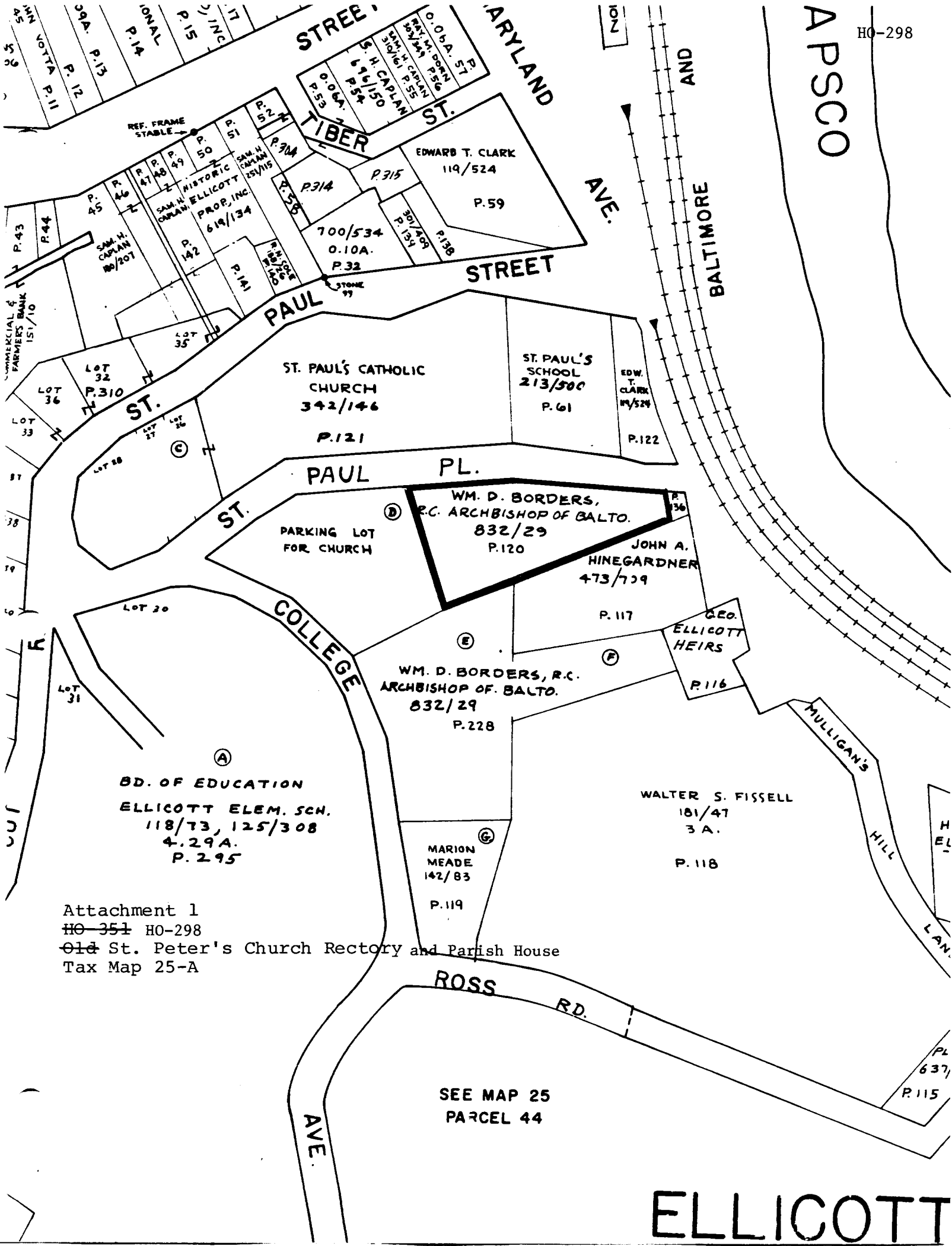

Attachment 1
~~HO-351~~ HO-298
 Old St. Peter's Church Rectory and Parish House
 Tax Map 25-A

ELLICOTT

C O U N

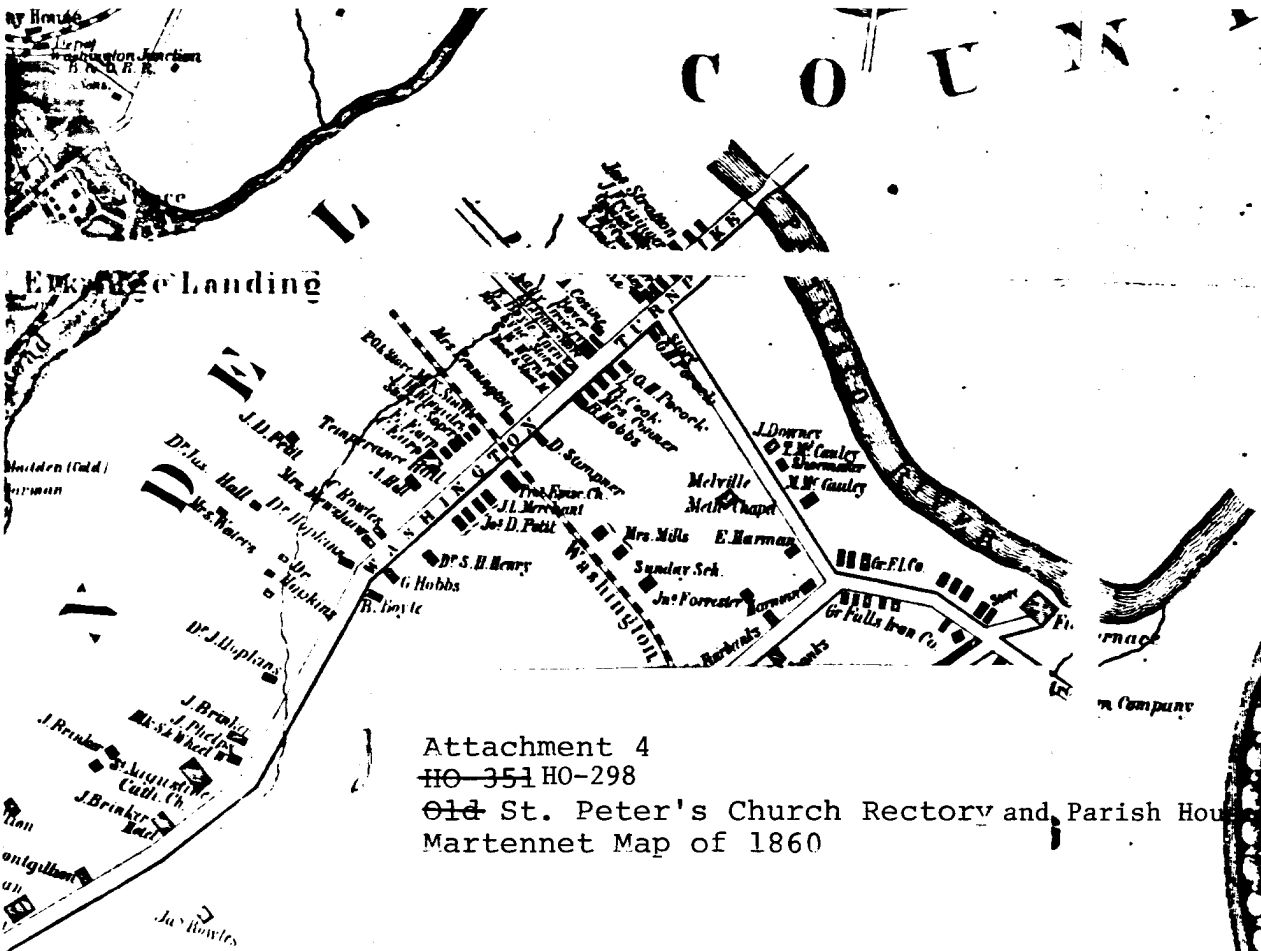

Attachment 4
 HO-351 HO-298
 Old St. Peter's Church Rectory and Parish House
 Martenet Map of 1860

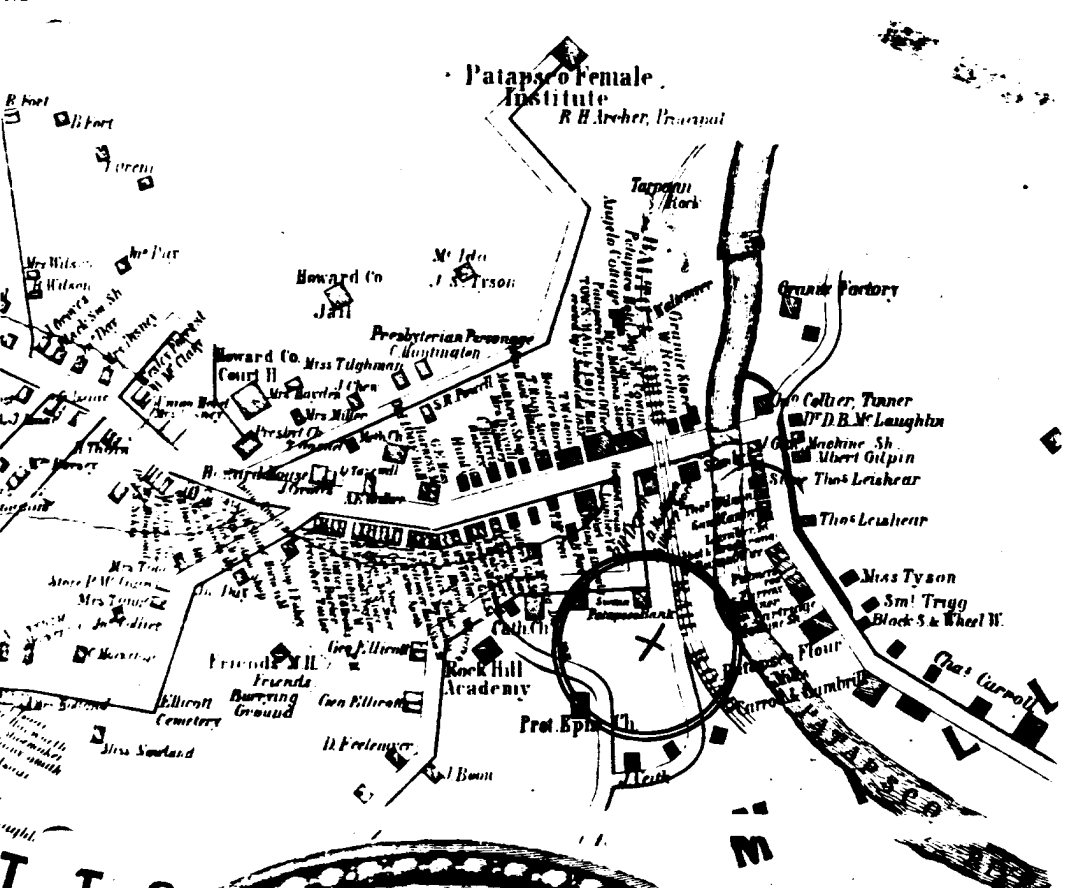

T T S



SECOND DISTRICT

HOWARD COUNTY

Scale 2 Inches per Mile

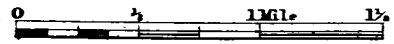

EXPLANATIONS

Dist. & Co Lines

County Roads

Private "

Turapike "

Rail Roads

Streams

The figures along the Roads shows the distance in Rods from junction to junction thereof

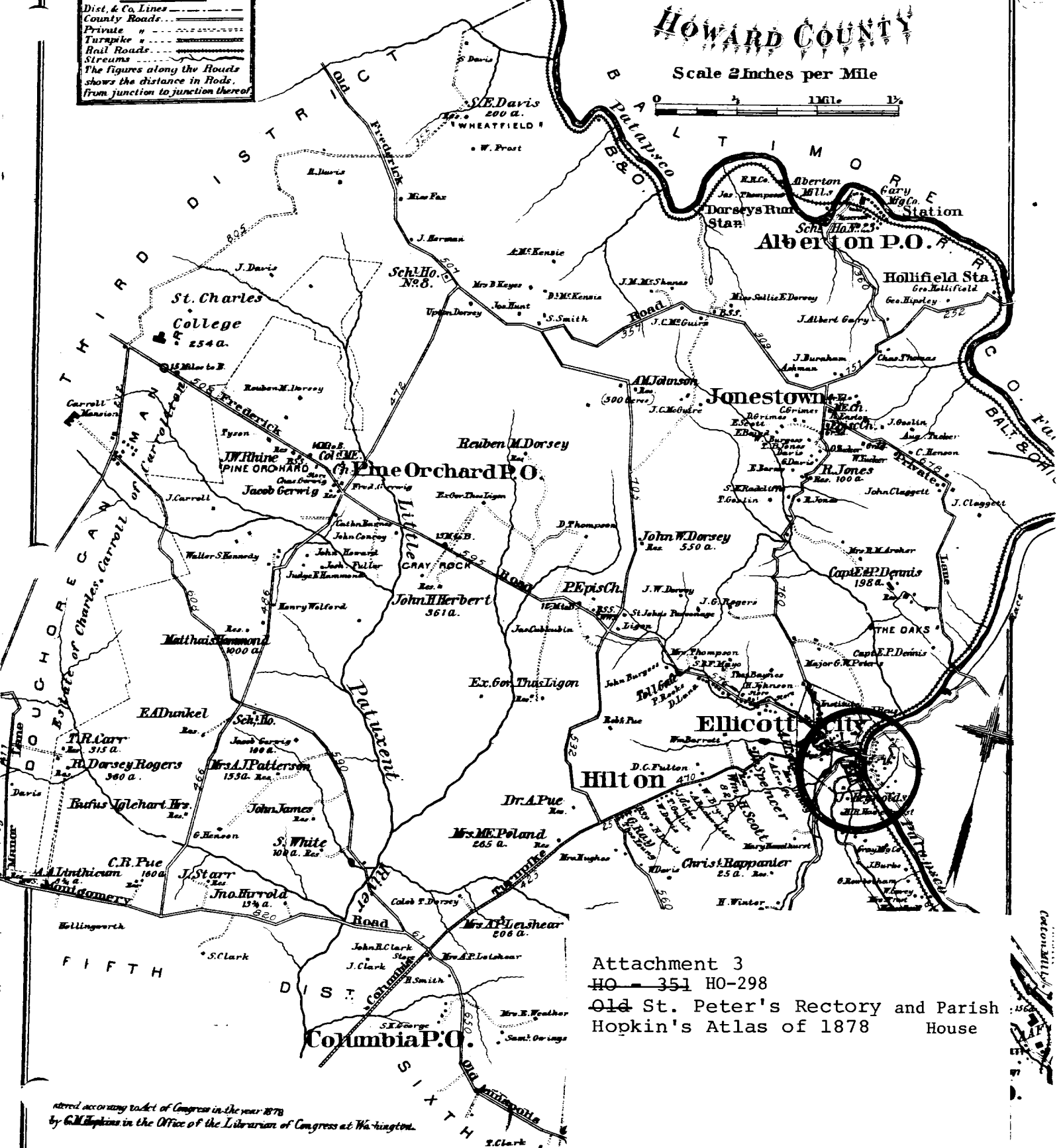

Attachment 3
 HO-351 HO-298
 Old St. Peter's Rectory and Parish
 Hopkin's Atlas of 1878 House

Entered according to Act of Congress in the year 1878
 by G. M. Hopkins in the Office of the Librarian of Congress at Washington.

PLAN OF ELICOTT CITY

HOWARD & BALTIMORE COUNTIES

Scale, 300 feet per inch.

Explanation.

- indicates Stone building
- " Brick "
- " Frame "
- " Brick or Stone Stable.
- " Frame Stable or shed.

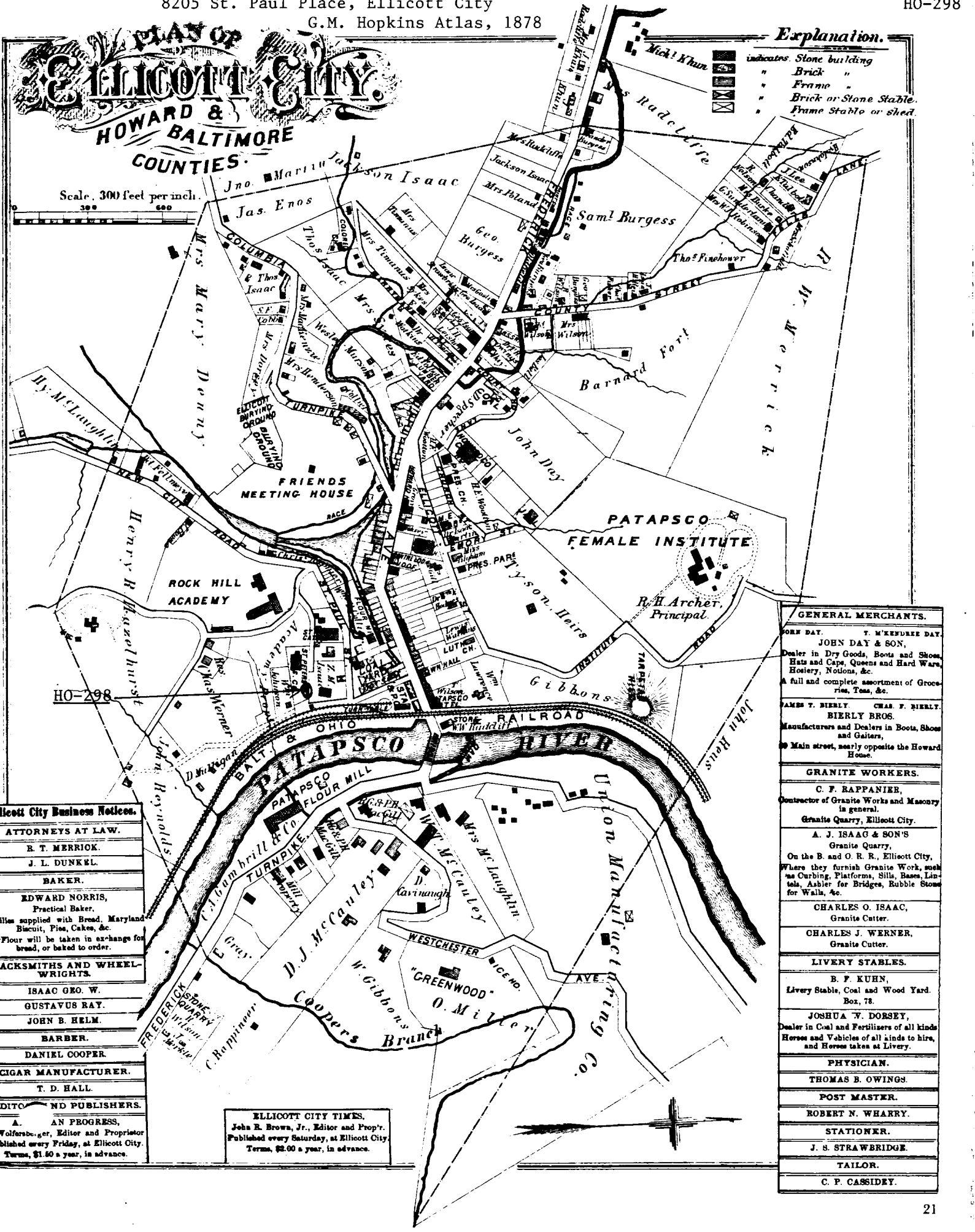

Ellicott City Business Notices.

ATTORNEYS AT LAW.
R. T. MERRIOK.
J. L. DUNKEL.
BAKER.
EDWARD NORRIS, Practical Baker, supplies with Bread, Maryland Biscuit, Pies, Cakes, &c. Flour will be taken in exchange for bread, or baked to order.
BLACKSMITHS AND WHEEL- WRIGHTS.
ISAAC GEO. W.
GUSTAVUS RAY.
JOHN B. HELM.
BARBER.
DANIEL COOPER.
CIGAR MANUFACTURER.
T. D. HALL.
EDITORS AND PUBLISHERS.
A. AN PROGRESS, L. Wolfersberger, Editor and Proprietor Published every Friday, at Ellicott City. Terms, \$1.50 a year, in advance.

ELICOTT CITY TIMES.
 John R. Brown, Jr., Editor and Prop'r.
 Published every Saturday, at Ellicott City.
 Terms, \$2.00 a year, in advance.

GENERAL MERCHANTS.
JOHN DAY. T. McKEURIE DAY. JOHN DAY & SON, Dealer in Dry Goods, Boots and Shoes, Hats and Caps, Queens and Hard Ware, Hosiery, Notions, &c. A full and complete assortment of Groce- ries, Tea, &c.
JAMES T. BIERLY. CHAS. F. BIERLY. BIERLY BROS. Manufacturers and Dealers in Boots, Shoes and Gaiters, Main street, nearly opposite the Howard House.
GRANITE WORKERS.
C. F. RAPPANIER, Contractor of Granite Works and Masonry in general. Granite Quarry, Ellicott City.
A. J. ISAAC & SON'S Granite Quarry, On the B. and O. R. R., Ellicott City, Where they furnish Granite Work, such as Curbing, Platforms, Sills, Bases, Lin- tels, Ashlar for Bridges, Rubble Stone for Walls, &c.
CHARLES O. ISAAC, Granite Cutter.
CHARLES J. WERNER, Granite Cutter.
LIVERY STABLES.
B. F. KUHN, Livery Stable, Coal and Wood Yard. Box, 78.
JOSHUA V. DORSEY, Dealer in Coal and Fertilizers of all kinds Horses and Vehicles of all kinds to hire, and Horses taken at Livery.
PHYSICIAN.
THOMAS B. OWINGS.
POST MASTER.
ROBERT N. WHERRY.
STATIONER.
J. S. STRAWBRIDGE.
TAILOR.
C. P. CASSIDY.

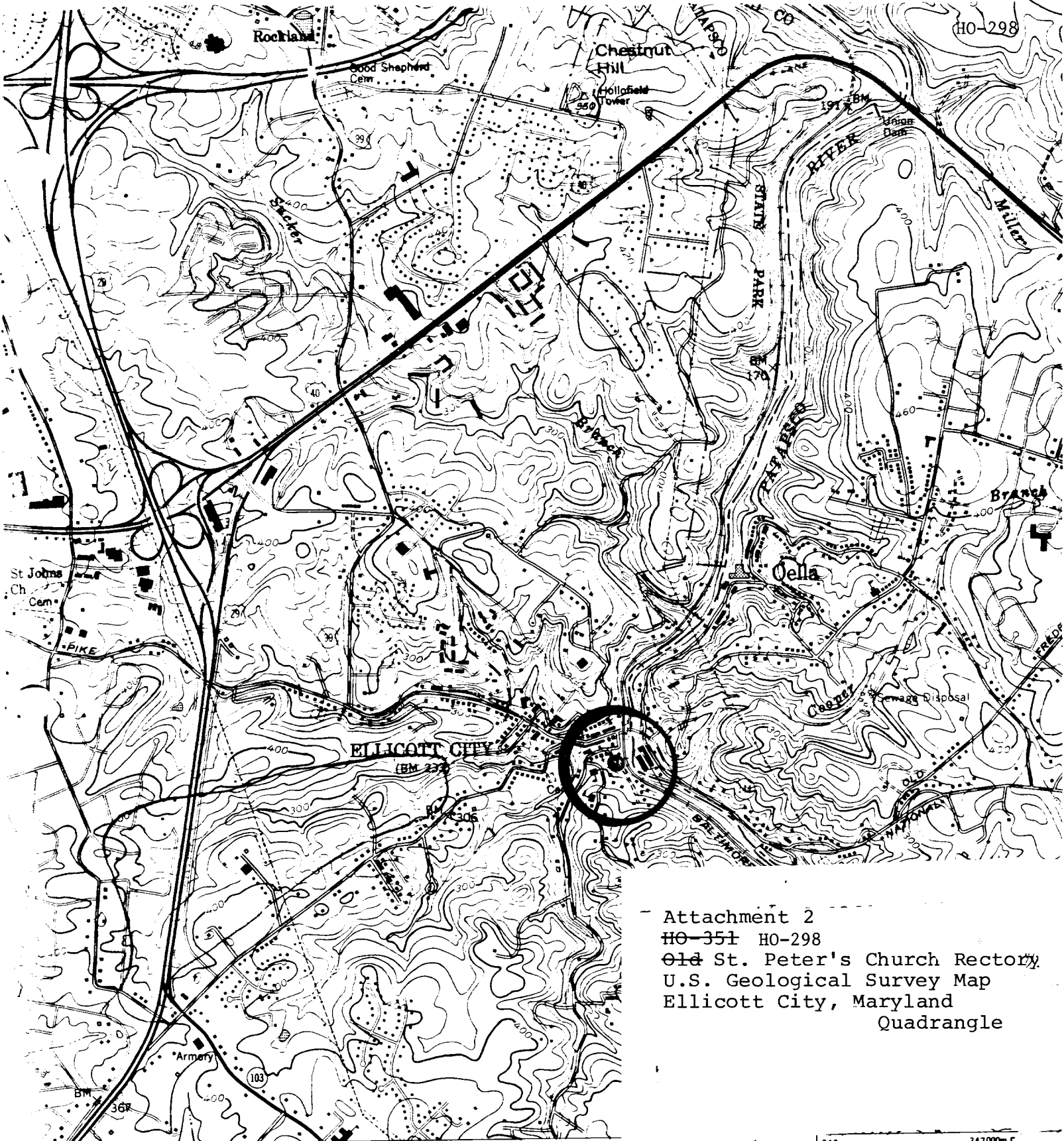

Attachment 2
 HO-351 HO-298
 Old St. Peter's Church Rectory
 U.S. Geological Survey Map
 Ellicott City, Maryland
 Quadrangle

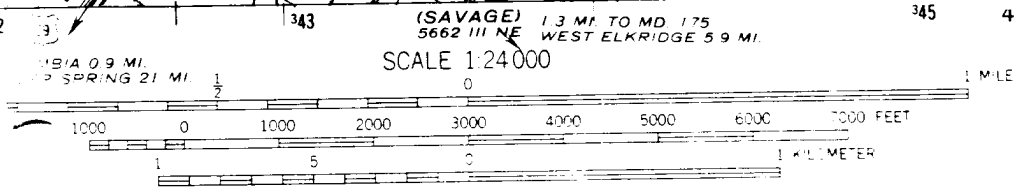

CONTOUR INTERVAL 20 FEET
 NATIONAL GEODETIC VERTICAL DATUM OF 1929

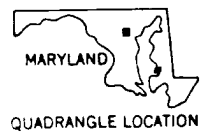



HO-~~298~~
298
A2

HO-298

Shirley City

342E

Inside Meeting

8205 St. Paul Place

2 Parish House

Off St Paul's Church Rectory

8/72



Name: ~~HO-351~~ HO-298
~~Old~~ St. Peter's Rectory & Parish House
Location: 820~~9~~5 St. Paul Place
Ellicott City, Maryland 21043
Photographer: Cleora B. Thompson, A.I.C.P.
Date of photograph: April, 1980
Negatives in possession of the Maryland Historical Trust
View: West
Photographer looking: East
Photograph number: 1 of 1