

The Ruth Daggett House faces east at the west end of Old Frederick Road and its intersection with Route 97. It is a four bay wide, one room deep, two and a half story high, gabled roof (running north-south) log (covered with German siding) house, resting on a stone foundation, with square central chimney and a two story high, two bay wide, one room deep, intersecting gable roof (running east-west) log (covered with German siding) service wing off the south side of its west wall, which creates an "L" plan.

The east elevation features two central, rectangular, cross paneled entrance doors flanked by single rectangular, double-hung windows, holding two-over-two lights, underlined by projecting wooden sills and decorated by wooden shutters. A one story high, hipped roof, screened in porch runs along the entire east elevation, resting on log supports. Two similar, second floor, end bay windows are vertically aligned and proportionally scaled to those below. A central intersecting attic gable holds a two-over-two light, gothic arched window.

This log building is made notable by its stylistic detail additions of the Gothic Revival Period and its associations with William Henry Smith, a free black man and owner of the property from 1855 to 1863.

MARYLAND HISTORICAL TRUST

HO-288
Woodbine
District 4
MAGI #1402885504

INVENTORY FORM FOR STATE HISTORIC SITES SURVEY

1 NAME

HISTORIC

AND/OR COMMON

The Ruth Daggett House

2 LOCATION

STREET & NUMBER

1276 Route 97, Hoods Mill Road

CITY, TOWN

Cooksville

— VICINITY OF

CONGRESSIONAL DISTRICT

6th

STATE

Maryland

COUNTY

Howard

3 CLASSIFICATION

CATEGORY	OWNERSHIP	STATUS	PRESENT USE	
<input type="checkbox"/> DISTRICT	<input type="checkbox"/> PUBLIC	<input checked="" type="checkbox"/> OCCUPIED	<input type="checkbox"/> AGRICULTURE	<input type="checkbox"/> MUSEUM
<input checked="" type="checkbox"/> BUILDING(S)	<input checked="" type="checkbox"/> PRIVATE	<input type="checkbox"/> UNOCCUPIED	<input type="checkbox"/> COMMERCIAL	<input type="checkbox"/> PARK
<input type="checkbox"/> STRUCTURE	<input type="checkbox"/> BOTH	<input type="checkbox"/> WORK IN PROGRESS	<input type="checkbox"/> EDUCATIONAL	<input checked="" type="checkbox"/> PRIVATE RESIDENCE
<input type="checkbox"/> SITE	PUBLIC ACQUISITION	ACCESSIBLE	<input type="checkbox"/> ENTERTAINMENT	<input type="checkbox"/> RELIGIOUS
<input type="checkbox"/> OBJECT	<input type="checkbox"/> IN PROCESS	<input checked="" type="checkbox"/> YES: RESTRICTED	<input type="checkbox"/> GOVERNMENT	<input type="checkbox"/> SCIENTIFIC
	<input type="checkbox"/> BEING CONSIDERED	<input type="checkbox"/> YES: UNRESTRICTED	<input type="checkbox"/> INDUSTRIAL	<input type="checkbox"/> TRANSPORTATION
		<input type="checkbox"/> NO	<input type="checkbox"/> MILITARY	<input type="checkbox"/> OTHER

4 OWNER OF PROPERTY

NAME

Mrs. Clarence S. Daggett

Telephone #: 489-4953

STREET & NUMBER

1276 Route 97

CITY, TOWN

Cooksville

— VICINITY OF

STATE, zip code

Maryland 21723

5 LOCATION OF LEGAL DESCRIPTION

COURTHOUSE,
REGISTRY OF DEEDS, ETC.

Tax Map 8, Blk 11, p.35
Hall of Records

Liber #: 172

Folio #: 69

STREET & NUMBER

Howard County Court House

CITY, TOWN

Ellicott City

STATE

Maryland

6 REPRESENTATION IN EXISTING SURVEYS

TITLE

Howard County Historic Sites Inventory

DATE

1978-1979

—FEDERAL STATE —COUNTY —LOCAL

DEPOSITORY FOR
SURVEY RECORDS

Maryland Historical Trust

CITY, TOWN

21 State Circle, Annapolis

STATE

Maryland

7 DESCRIPTIONHO-288
Woodbine
Dist. 4

CONDITION		CHECK ONE		CHECK ONE	
<input checked="" type="checkbox"/> EXCELLENT	<input type="checkbox"/> DETERIORATED	<input checked="" type="checkbox"/> UNALTERED	<input checked="" type="checkbox"/> ORIGINAL SITE	<input type="checkbox"/> MOVED	DATE _____
<input type="checkbox"/> GOOD	<input type="checkbox"/> RUINS	<input type="checkbox"/> ALTERED			
<input type="checkbox"/> FAIR	<input type="checkbox"/> UNEXPOSED				

DESCRIBE THE PRESENT AND ORIGINAL (IF KNOWN) PHYSICAL APPEARANCE

The Ruth Daggett House faces east at the west end of Old Frederick Road and its intersection with Route 97. It is a four bay wide, one room deep, two and a half story high, gabled roof (running north-south) log (covered with German siding) house, resting on a stone foundation, with square central chimney and a two story high, two bay wide, one room deep, intersecting gable roof (running east-west) log (covered with German siding) service wing off the south side of its west wall, which creates an "L" plan.

THE EAST ELEVATION

The east elevation features two central, rectangular, cross paneled entrance doors flanked by single rectangular, double-hung windows, holding two-over-two lights, underlined by projecting wooden sills and decorated by wooden shutters. A one story high, hipped roof, screened in porch runs along the entire east elevation, resting on log supports. Two similar, second floor, end bay windows are vertically aligned and proportionally scaled to those below. A central intersecting attic gable holds a two-over-two light, gothic arched window.

THE SOUTH ELEVATION

The south elevation holds a similar, first and second floor window in the main building block and two square four light casement

windows. A cellar door to the stone basement is centered on the foundation wall. This basement features log joists, which appear to be the second ones for the building for depressions on the east and west walls appear, which may at one time have held lower log joists. The central brick chimney rises from the center of this basement up through the first and second floors and through the attic.

The south wall of the original service wing holds a rectangular six light, cross paneled entrance door in its east bay, covered by a gabled roof hood. A cement stoop leads to this entrance. West of the entrance another similar, first floor window is placed. Two second floor windows are vertically aligned and proportionally scaled to the door and window below.

NORTH ELEVATION

The north wall of the main building block holds a similar, central, first and second floor window and two four light, attic, casement windows above. Along the north elevation of the service "L" was once a one story high, open porch, which was enclosed and to which a second floor was added in 1955. It is a two bay wide, one room deep, two story high, shed roofed kitchen addition. Its north wall features a tripartite, first floor kitchen window, consisting of a square central picture window, flanked by one-over-one light double-hung windows. A rectangular, second floor, casement window rests in the east bay and a rectangular, second floor, double-hung window, holding six-over-six lights in the west bay.

THE WEST ELEVATION

The west wall of the service wing holds a second floor, rectangular entrance door on to a second floor terrace formed by the flat roofs of the two additions made along the west elevation. A wooden fence runs along the perimeter of this terrace. A square one light attic window also rests on the south side of the service wing's west wall. Along the west elevation of the original service wing a garage was constructed in 1940 and in 1955 made into a family room with wide brick fireplace on its east wall. It is a two bay wide, one room deep, two story high, flat roofed, frame addition, covered with German siding. Its west wall features two first floor, rectangular, double-hung windows, holding two-over-two lights, which match those of the rest of the house.

Along the west elevation of the kitchen addition a one bay wide, one bay deep, one story high, flat roofed, frame (covered with German siding) mud room - bath addition has been made, whose west wall lies flush with that of the family room, and whose roofs join to form the terrace above. It holds a double west window, each component a small, two-over-two light, double-hung, rectangular window.

NORTH WALL OF THE LATER ADDITION

Along the north wall of this 1955 addition, which projects northward from the north wall of the kitchen addition, runs a one

story high, shed roofed open porch, supported by two iron posts and enclosed on the west. A cement stoop leads to a four light, rectangular paneled entrance door.

LOG SMOKE HOUSE

Northwest of the house lies a round stone well and west of the well a one bay wide, one bay deep, one story high, gabled roof (running north-south) log smoke house, resting on a stone foundation. It holds a rectangular batten wood south entrance door and features half notching.

THE INTERIOR PLAN

The interior plan of the main building block of the house features two large, equal, first and second floor, front rooms, the first floor of which holds separate east entrances. These first floor rooms once served as parlor (on the north) and living room (on the south) with a kitchen-dining room and staircase located in the "L". The south entrance door of the "L" leads into the small hall separating the main building block from its "L". A door to the east leads into the living room, a door to the west into the original kitchen (now a library.) Directly in front of the south entrance lies an interior staircase (running north-south) leading to the second floor.

The two, similarly scaled, front rooms of the main building block feature narrow, random width floors and identical mantelpieces,

featuring pilasters, decorated by elongated arches and architraves decorated with central circles, flanked by horizontal elongated arches, topped by curvilinear mantle shelves. The parlor has now become a dining room and its west wall broken to provide entry into the kitchen addition, once an open kitchen porch. These rooms were probably heated by stoves, for on the second floor are found curvilinear mantle shelves only, supported by scrolled wooden brackets.

The plan of the house provided a parlor with a separate outside and inside entrance, which could be completely cut off from the rest of the house.

The service wing held one downstairs and one upstairs room as it does now. No mantelpieces were here but two were found on the property and placed on the west wall of the downstairs library and upstairs master bedroom. These mantelpieces are of an earlier style, featuring flat pilasters and flat architraves and may well have been those originally used in the front of the house before it was remodeled in the late nineteenth century.

The house is beautifully landscaped, featuring mature shrubs and trees and flag stone foot paths.

8 SIGNIFICANCE

HO-288
Woodbine
District 4

Page 1 of 3
September 2, 1980
PERIOD 1800

AREAS OF SIGNIFICANCE -- CHECK AND JUSTIFY BELOW

<input type="checkbox"/> PREHISTORIC	<input type="checkbox"/> ARCHEOLOGY-PREHISTORIC	<input type="checkbox"/> COMMUNITY PLANNING	<input type="checkbox"/> LANDSCAPE ARCHITECTURE	<input type="checkbox"/> RELIGION
<input type="checkbox"/> 1400-1499	<input checked="" type="checkbox"/> ARCHEOLOGY-HISTORIC	<input type="checkbox"/> CONSERVATION	<input type="checkbox"/> LAW	<input type="checkbox"/> SCIENCE
<input type="checkbox"/> 1500-1599	<input type="checkbox"/> AGRICULTURE	<input type="checkbox"/> ECONOMICS	<input type="checkbox"/> LITERATURE	<input type="checkbox"/> SCULPTURE
<input type="checkbox"/> 1600-1699	<input checked="" type="checkbox"/> ARCHITECTURE	<input type="checkbox"/> EDUCATION	<input type="checkbox"/> MILITARY	<input type="checkbox"/> SOCIAL/HUMANITARIAN
<input type="checkbox"/> 1700-1799	<input type="checkbox"/> ART	<input type="checkbox"/> ENGINEERING	<input type="checkbox"/> MUSIC	<input type="checkbox"/> THEATER
<input checked="" type="checkbox"/> 1800-1899	<input type="checkbox"/> COMMERCE	<input type="checkbox"/> EXPLORATION/SETTLEMENT	<input type="checkbox"/> PHILOSOPHY	<input type="checkbox"/> TRANSPORTATION
<input type="checkbox"/> 1900-	<input type="checkbox"/> COMMUNICATIONS	<input type="checkbox"/> INDUSTRY	<input type="checkbox"/> POLITICS/GOVERNMENT	<input checked="" type="checkbox"/> OTHER (SPECIFY) Black history
		<input type="checkbox"/> INVENTION		

SPECIFIC DATES

BUILDER/ARCHITECT

STATEMENT OF SIGNIFICANCE

The Ruth Daggett House is a charming example of Howard County vernacular, log architecture,¹ to which an element of the Gothic Revival Style has been added in its central, intersecting gable, inset with a Gothic arched, double-hung window. Its main building block is built of log, set on a stone foundation, to which a west wing and later still a west addition has been constructed, creating a filled in "L" plan.

Additionally, its history, is associated with Shipley's Discovery² and with a free black man, William Henry Smith³, who bought one and a half acres of the four and a half acre tract in 1855.

EXPLANATORY NOTES

1. Architecturally the Ruth Daggett House is a good example of a simple, log, two story high, four room, building to which later additions have been made. The stone basement walls once held log joists, inset into their walls, which were later replaced by joists, which rested on top of the

stone foundation, thereby raising the first floor.

2. The building is believed to have existed as an auxiliary building on a part of a larger 130 acre tract of land, which in turn was a part of an early land grant called "Shipley's Discovery", owned in 1853 by Thomas Barnes. In 1855 Thomas Barnes conveyed 1½ acres of "Shipley's Discovery" for \$15.00 to William Henry Smith, "together with all singular the tenements, hereditaments, and appertances thereupon belonging." The simple, four room log house is believed to have existed at that time and was later renovated, with the central, intersecting gable added to its east facade, as well as the west wing, which created the "L" plan.

William Henry Smith owned the property for eight years. In 1863 he sold it to Adam C. Raabe for \$100.00, who held it for only three years, making his home in Baltimore City. In 1866 Elizabeth Cawthorn and her husband acquired the property for \$300.00. Between the years 1870 and 1910 it was owned by John M. Delashmutt, Martha A. Powell, Henry Ridgely, Sarah Ridgely, Maggie Rawlings, William H. Stinson, John W. Young and Ulysses Co. and Minnie Poole. In 1910 Margaret Rice acquired the property and raised poultry here until 1940, when its present owner, Ruth Daggett and her husband bought it.

3. The house is associated with the black history of Howard

County, being owned by a free black man, William Henry Smith from 1855 to 1863, several years before the "Emancipation Proclamation", when slavery was outlawed and all through the Civil War. Mr. Smith acquired 1½ acres of land for \$15.00 and sold it some years later at a profit, making his home in Baltimore City, by 1863.

9 MAJOR BIBLIOGRAPHICAL REFERENCES

Interview with Mrs. Daggett at her residence on August 11, 1980.

Howard County Land Records

CONTINUE ON SEPARATE SHEET IF NECESSARY

10 GEOGRAPHICAL DATA

ACREAGE OF NOMINATED PROPERTY 6.685 Acres

Please see Attachment 1, Tax Map 8

VERBAL BOUNDARY DESCRIPTION

Please see Howard County Land Records, Liber 172 Folio 69

LIST ALL STATES AND COUNTIES FOR PROPERTIES OVERLAPPING STATE OR COUNTY BOUNDARIES

STATE Maryland COUNTY Howard

STATE _____ COUNTY _____

11 FORM PREPARED BY

NAME / TITLE

Cleora Barnes Thompson, Archivist

ORGANIZATION

Office of Planning & Zoning-Comprehensive Planning Section

DATE

STREET & NUMBER

3450 Court House Drive

TELEPHONE

CITY OR TOWN

Ellicott City

STATE

Maryland

The Maryland Historic Sites Inventory was officially created by an Act of the Maryland Legislature, to be found in the Annotated Code of Maryland, Article 41, Section 181 KA, 1974 Supplement.

The Survey and Inventory are being prepared for information and record purposes only and do not constitute any infringement of individual property rights.

RETURN TO: Maryland Historical Trust
The Shaw House, 21 State Circle
Annapolis, Maryland 21401
(301) 267-1438

TITLE SEARCH

HO-288-The Ruth Daggett House

Date	Liber-Folio	Grantor	Grantee	Transaction
Oct. 2, 1941	172 69	Margaret O. Rice, Unm.	Mr. & Mrs. Clarence Daggett	Deed to 3 pieces of ground 6.685 A ⁺
Mar. 26, 1910	WWLC88 651	Ulysses G. Poole & Minnie G. Poole 1. Lot #1 3 Acres + 2. Lot #2 1½ A + called "Shipley's Discovery" 3. Lot #3 1½ Acres +	Margaret O. Rice	Deed to 3 pieces of ground
Apr. 15, 1909	87 133	John W. Young & Louisa A. Young	Ulysses G. Poole & Minnie G. Poole	Deed to 3 pieces of ground for \$1,800.00
Dec. 24, 1906	WWLC83 170	William H. Stinson & Estelle T. Stinson	John W. Young & Louisa A. Young	Deed to 3 pieces of ground for \$1,200
Aug. 13, 1898	69 84	Caroline Bradford "P/O a tract of land called "Poole's Chance"	William H. Stinson	Deed to Lot #3 for \$200
Aug. 30, 1898	69 85	Maggie Rawlings "land and premises"	William H. Stinson	Deed to Lot #1 & Lot #2 or 4½ A ⁺ for \$1,000
July 12, 1898	69 15	James Lenmon, Atty. for heirs at law of Sarah E. Ridgely "together with the buildings and improvements thereupon erected"	Maggie Rawlings	Deed to 4½ A of land and buildings for \$1,000.
July 24, 1886	51 187	Henry K. Ridgely "in consideration of the love I have for the said Sarah E. Ridgely, my wife and one dollar in hand."	Sarah E. Ridgely, wife of Henry	Deed to 4½ +
May 10, 1881	44 524	John M. Delashmutt & Mary Delashmutt "subject to a mortgage from Martha A. Powell and James Powell to Henry A. Powell July 10, 1880 for \$100.00 (4+ Acres) 42-644) Lot #2 P/O tract called Poole's Chance or 3 A +"	Henry K. Ridgely Powell to Henry A. Powell	Deed to 2 pieces of ground \$150.00 Lot #1 called Shipley's Discovery 1½ A +. Adjoins the land of Andrew Ellicott, Henry K. Ridgely and John W. Wayman.
Jan. 8, 1881	43 15	Martha A. Powell & James Powell together with all the buildings, etc.	John M. Delashmutt	#1 deed to 1 acre for \$131.50 "Shipley's Discovery"

TITLE SEARCH

HO-288-The Ruth Daggett House - Prepared by Cleora Thompson AICP

Date	Liber-Folio	Grantor	Grantee	Transaction
May 24, 1880	42 315	John M. Delashmutt & Mary "together with all the buildings"	Martha A. Powell	4½ A + all together deed to 2 parcels 1-1¼ Acres ±. 2-3 Acres ± for \$300
May 15, 1879	41 122	Elizabeth Cawthorn & Pearson T. Cawthorn "together with the buildings"	John M. Delashmutt	Deed to 2 parcels 1-1¼ Acres S.D. 2-3 Acres S.D.+P.C. \$337.50
Apr. 7, 1866	25 485	Adam Raabe & Maria Raabe of Baltimore City	Elizabeth Carthorn	Deed to 1¼ A of land \$300
Mar. 23, 1866	25 483	Cassandra Wayman of Burlington City, N.J.	Elizabeth Cawthorn	Deed to 3 Acres of land for \$50
Mar. 23, 1863	22 339	William Henry Smith (coloured) of the City of Baltimore	Adam C. Raabe	Deed to 1¼ Acres of Shipley's Discovery for \$100
Feb. 22, 1855	22 336	Thomas Barnes of Howard County "together with all and singular the tenements, heredita- ments, and appertances thereupon belonging "to hold all and singular the above described premises together with the appurtanances unto the said party of the second part, his heirs and assigns forever and the said party of the first part and his heirs the said promises in the "quiet and peaceable possession of the said party of the second part"	William Henry Smith of Howard County	Deed to 1¼ A + of Shipley's Discovery for sum of \$15
July 14, 1853	13 479	Thomas Barnes & wife	Andrew Ellicott	Deed to Bargain and Sale. Deed to 130 Acres of Shipley's Discovery for \$3,000.
July 14, 1853	13 483	Andrew Ellicott	Thomas Barnes	Deed of Mortgage

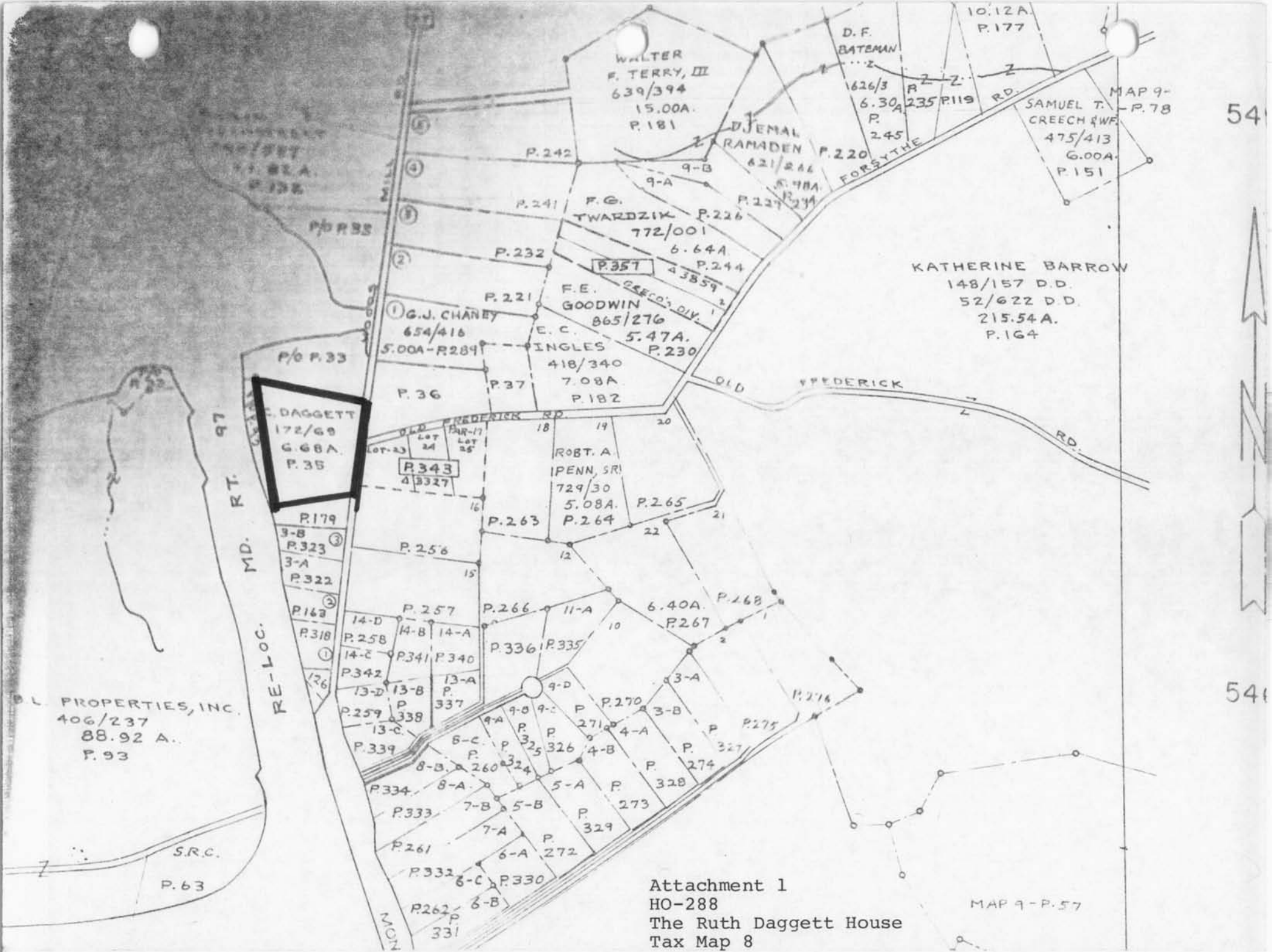

RUTH DAGGETT
 172/68
 G.68A.
 P.35

WALTER
 F. TERRY, III
 639/394
 15.00A.
 P.181

DJEMAL
 RAMADEN P.220
 621/244
 5.48A
 P.221

F.G.
 TWARDZIK P.226
 772/001
 6.64A.
 P.244
 43859

F.E.
 GOODWIN
 865/276
 5.47A.
 P.230

G.J. CHANEY
 654/416
 5.00A-R289
 P.36

E.C.
 INGLES
 418/340
 7.08A
 P.182

ROBT. A.
 PENN, SR
 729/30
 5.08A.
 P.264

KATHERINE BARROW
 148/157 D.D.
 52/622 D.D.
 215.54A.
 P.164

B.L. PROPERTIES, INC.
 406/237
 88.92 A.
 P.93

Attachment 1
 HO-288
 The Ruth Daggett House
 Tax Map 8

MAP 9-P.57

54

54

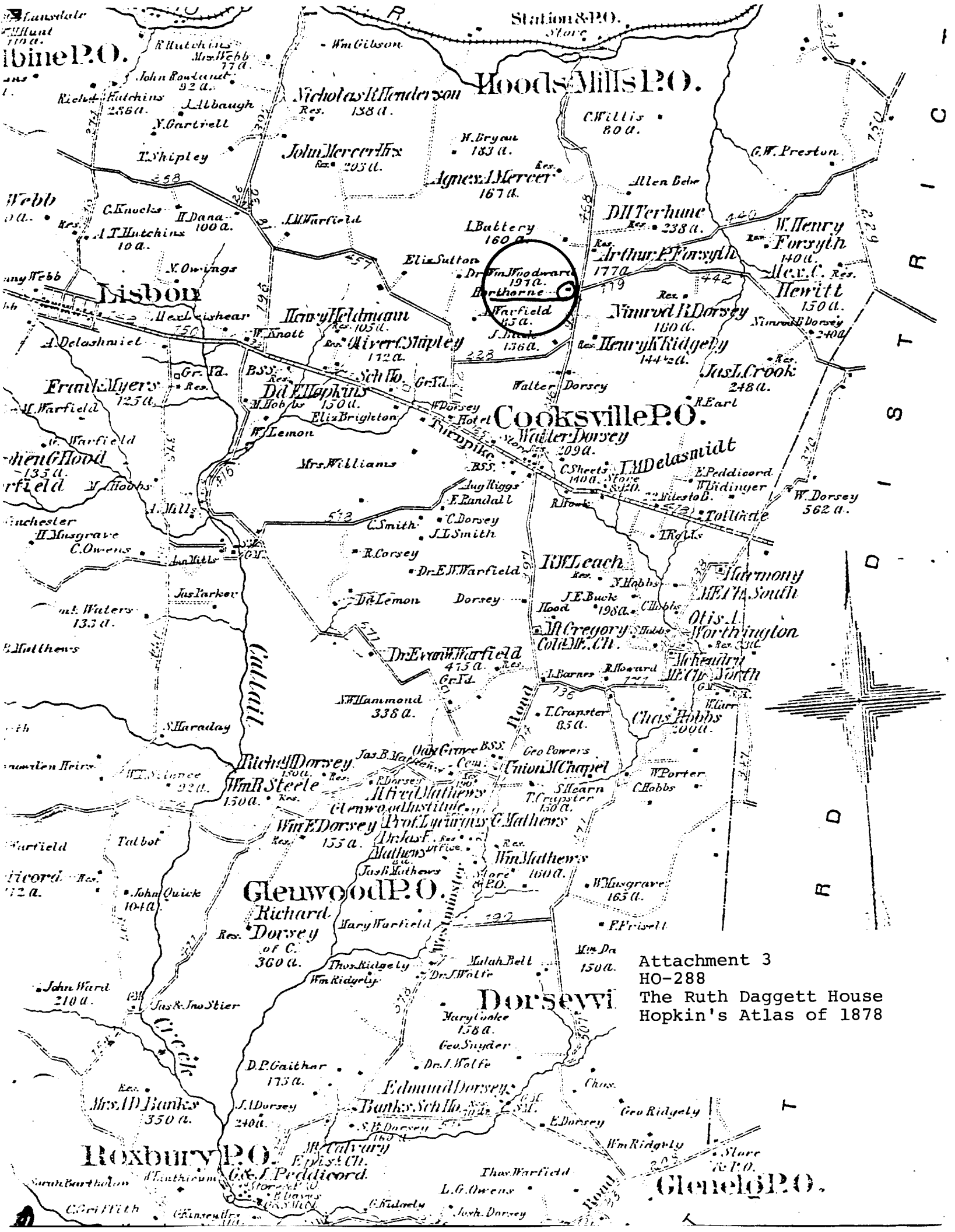

Wm. Gibbons
Station & P.O.
Store

ibine P.O.
R. Hutchins
Mrs. Webb
John Rowland
Richard Hutchins
J. Albaugh
N. Gartrell
T. Shipley

Nicholas Henderson
Res. 138 A.

Hoods Mills P.O.

C. Willis
80 A.

John Mercer
Res. 203 A.

Agnes Mercer
167 A.

D. Terhune
Res. 238 A.

W. Henry Forsyth
140 A.

Webb
C. Knocks
H. Dana
A. T. Hutchins
10 A.

Lisbon

Henry Feldmann
Res. 105 A.

L. Battery
160 A.

Arthur P. Forsyth
177 A.

W. Henry Forsyth
140 A.

Her. C. Res.
Hewitt
150 A.

Frank Myers
125 A.

Rev. J. C. Stimpney
172 A.

Eliz. Sutton
Dr. Wm. Woodward
197 A.

Nimrod B. Dorsey
160 A.

Nimrod B. Dorsey
240 A.

Henry Hood
135 A.

Rev. D. Elliphants
150 A.

Cooksville P.O.

Henry K. Ridgely
144 A.

Just. Crook
248 A.

Wm. Musgrave
C. Owens

Eliz. Brighton
F. Lemon

Walter Dorsey
209 A.

Walter Dorsey
209 A.

R. Earl

Wm. Waters
133 A.

Mrs. Williams

Walter Dorsey
209 A.

J. DeLashmied

W. Dorsey
562 A.

Wm. Matthews

C. Smith
J. L. Smith

Walter Dorsey
209 A.

J. DeLashmied

W. Dorsey
562 A.

Wm. Haraday

R. Corsey
Dr. E. J. Warfield

Walter Dorsey
209 A.

J. DeLashmied

W. Dorsey
562 A.

Wm. Talbot

Dr. E. J. Warfield
475 A.

Walter Dorsey
209 A.

J. DeLashmied

W. Dorsey
562 A.

John Quick
10 A.

Wm. Hammond
338 A.

Walter Dorsey
209 A.

J. DeLashmied

W. Dorsey
562 A.

John Ward
210 A.

Richard Dorsey
150 A.

Walter Dorsey
209 A.

J. DeLashmied

W. Dorsey
562 A.

Mrs. D. Banks
350 A.

Wm. R. Steele
150 A.

Walter Dorsey
209 A.

J. DeLashmied

W. Dorsey
562 A.

Roxbury P.O.

Wm. E. Dorsey
155 A.

Walter Dorsey
209 A.

J. DeLashmied

W. Dorsey
562 A.

Glenwood P.O.

Richard Dorsey
360 A.

Walter Dorsey
209 A.

J. DeLashmied

W. Dorsey
562 A.

Dorseyville

Attachment 3
HO-288
The Ruth Daggett House
Hopkin's Atlas of 1878

Glenwood P.O.

Attachment 2
HO-288
The Ruth Daggett House
U.S. Geological Survey Map
Woodbine Quadrangle

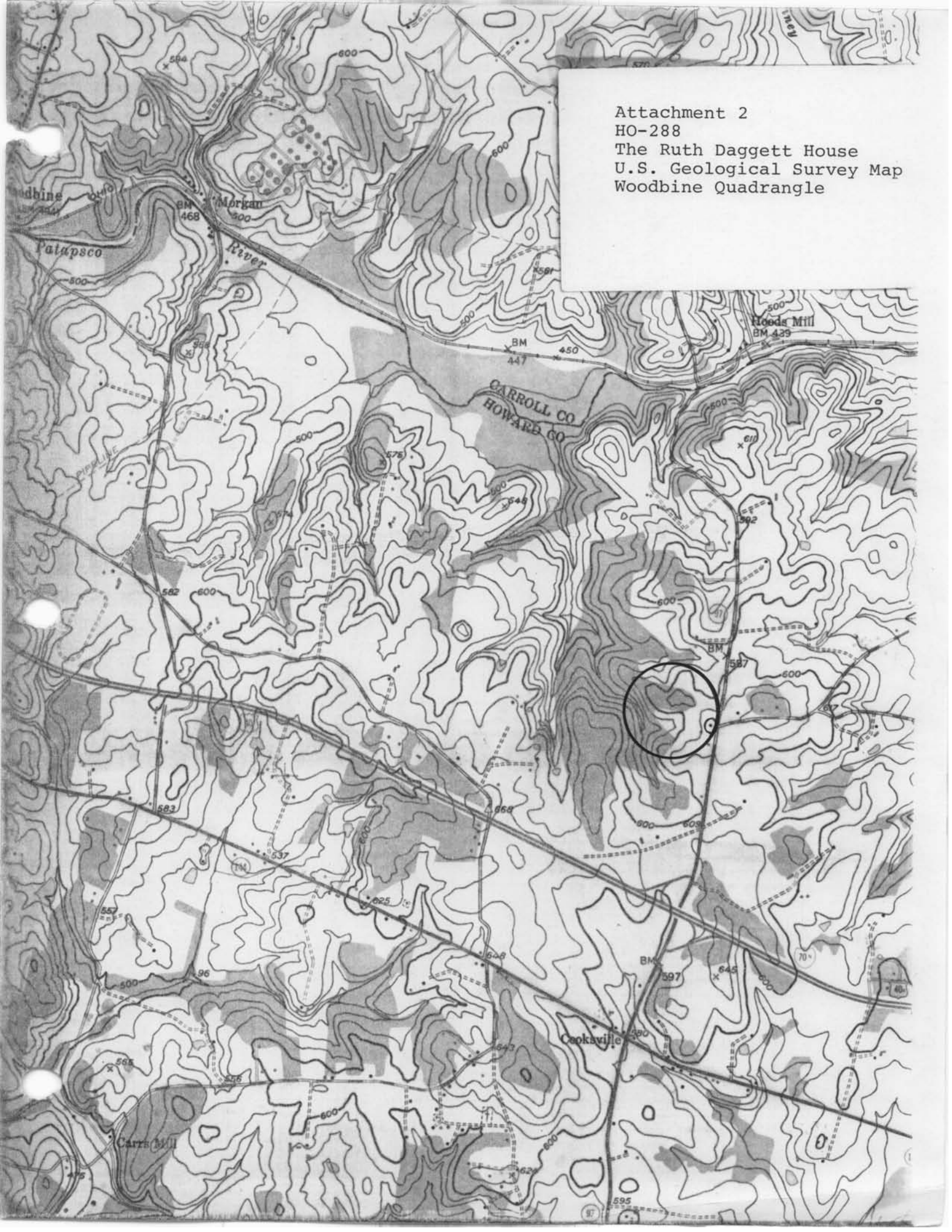



288

Name: HO-288

The Ruth Daggett House

Location: 1276 Route 97

Cooksville, MD 21723

Photographer: Cleora B. Thompson, A.I.C.P.

Date of Photograph: August, 1980

Negatives in possession of the Maryland Historical Trust

View: East elevation

Photographer looking: West

Photograph number: 1 of 1