

corr. copy

HO-266
PHELP'S RESIDENCE/WARFIELD'S RANGE
Laurel
Private

eighteenth and nineteenth
centuries

The Phelp's Residence with its adjoining log cabin is located on the northern most survey of Warfield's Range. (Please see HO-265).

It was built in three clearly defined frame sections. The original house, the present kitchen, is a two story high, two bay wide, one room deep, gabled roof (running north-south) frame structure, placed on a fieldstone foundation whose wide stone south chimney rises from a mammoth blocked fireplace base in the cellar. It at one time may have been a cooking fireplace. Entrances are located on its east and west elevations. At a very early date a single bay was added to the south wall, one room deep, two stories high, gabled roof (running north-south). It rests on a stone foundation but does not have a full basement, but a crawl space. Log beams support its first floor.

The third section of the house forms the L plan, facing south on Gorman Road and constructed by Dr. Thomas Chew Worthington, circa 1845. It is a five bay wide, one room deep, two and a half story high, gable roof (running east-west) frame structure built on a stone foundation with central hall and north and south entrances. Its south entrance is noteworthy, flanked by three side lights and surmounted by a six light transom which extends on either side over the vertical lights. A central intersecting "A" roofed dormer window is flanked by gabled roof dormers, each of which hold roman arched, double-hung windows with two-over-two lights. A one story high, shed roofed porch has been enclosed, lying along the entire east elevation of the north wing.

MARYLAND HISTORICAL TRUST

INVENTORY FORM FOR STATE HISTORIC SITES SURVEY

1 NAME Warfield's Range/"Pilla Terra"/Dr. Thomas Chew Worthington's homestead.
HISTORIC

AND/OR COMMON
Phelp's Residence/Twin Cedars

2 LOCATION

STREET & NUMBER 10504 Gorman Road (now on Patuxent Ridge Way)

CITY, TOWN Laurel VICINITY OF CONGRESSIONAL DISTRICT 6th

STATE Maryland COUNTY Howard

3 CLASSIFICATION

CATEGORY	OWNERSHIP	STATUS	PRESENT USE
<input checked="" type="checkbox"/> DISTRICT	<input type="checkbox"/> PUBLIC	<input checked="" type="checkbox"/> OCCUPIED	<input type="checkbox"/> AGRICULTURE <input type="checkbox"/> MUSEUM
<input type="checkbox"/> BUILDING(S)	<input type="checkbox"/> PRIVATE	<input type="checkbox"/> UNOCCUPIED	<input type="checkbox"/> COMMERCIAL <input type="checkbox"/> PARK
<input type="checkbox"/> STRUCTURE	<input type="checkbox"/> BOTH	<input type="checkbox"/> WORK IN PROGRESS	<input type="checkbox"/> EDUCATIONAL <input checked="" type="checkbox"/> PRIVATE RESIDENCE
<input type="checkbox"/> SITE	PUBLIC ACQUISITION	ACCESSIBLE	<input type="checkbox"/> ENTERTAINMENT <input type="checkbox"/> RELIGIOUS
<input type="checkbox"/> OBJECT	<input type="checkbox"/> IN PROCESS	<input checked="" type="checkbox"/> YES: RESTRICTED	<input type="checkbox"/> GOVERNMENT <input type="checkbox"/> SCIENTIFIC
	<input type="checkbox"/> BEING CONSIDERED	<input type="checkbox"/> YES: UNRESTRICTED	<input type="checkbox"/> INDUSTRIAL <input type="checkbox"/> TRANSPORTATION
		<input type="checkbox"/> NO	<input type="checkbox"/> MILITARY <input type="checkbox"/> OTHER

4 OWNER OF PROPERTY

NAME Mrs. Janet W. Phelps

Home: 725-0737

Telephone #: Office 344-2222(USDA)

STREET & NUMBER
Twin Cedars 10504 Gorman Road

CITY, TOWN Laurel VICINITY OF STATE, zip code
Maryland 20810

5 LOCATION OF LEGAL DESCRIPTION

COURTHOUSE,
REGISTRY OF DEEDS, ETC. Hall of Records

Liber #: 706
Folio #: 340
Tax Maps 41 and 42, p. 80

STREET & NUMBER
Howard County Court House

CITY, TOWN Ellicott City STATE Maryland

6 REPRESENTATION IN EXISTING SURVEYS

TITLE
Howard County Historic Sites Inventory

DATE 1977 FEDERAL STATE COUNTY LOCAL

DEPOSITORY FOR
SURVEY RECORDS Maryland Historical Trust

CITY, TOWN 21 State Circle, Annapolis STATE Maryland

DESCRIPTION

HO-266
District 6

CONDITION		CHECK ONE	CHECK ONE
<input type="checkbox"/> EXCELLENT	<input type="checkbox"/> DETERIORATED	<input type="checkbox"/> UNALTERED	<input checked="" type="checkbox"/> ORIGINAL SITE
<input checked="" type="checkbox"/> GOOD	<input type="checkbox"/> RUINS	<input checked="" type="checkbox"/> ALTERED	<input type="checkbox"/> MOVED DATE _____
<input type="checkbox"/> FAIR	<input type="checkbox"/> UNEXPOSED		

DESCRIBE THE PRESENT AND ORIGINAL (IF KNOWN) PHYSICAL APPEARANCE

The Phelps's Residence is composed of two sections, a south and north section, which form an L plan.

The south section is a five bay wide, two bay deep, two and a half story gabled roof (running east-west) white frame structure, with brick chimneys inset into its east and west walls. A central intersecting gabled roof dormer window lies flush with the south wall and holds a roman arched, double-hung window with two-over-two lights. Gabled roof dormer windows are set into the south elevation of the gable roof on each side of this central gable. They hold similar windows.

A central rectangular open bible and cross paneled door is surmounted by an eight light transom and flanked by four vertical side lights. The entrance faces south and is approached by three wide brick steps. A brick patio lies along the south elevation. Two double-hung rectangular windows holding six-over-six lights are decorated with projecting flat wooden sills, and rest on each side of the entrance. Five second floor windows, vertically aligned and proportionally scaled are similar to the first floor windows.

The east and west walls hold a similar first and second floor window in their north bay and two small rectangular double-hung attic windows with two-over-two lights above.

North Elevation:

The north wall of the house has a first and second floor rectangular window, similar to the others, in its east bay and a similar central bay second floor window.

Springing from the west bay of the north wall is a three bay wide, one bay deep intersecting gabled roof (running north-south) white frame north wing. A giant cornerstone for this section's southeast corner, is located under the one story high shed roofed enclosed porch which runs along its entire east elevation. Large stone pillars with hatch marks support this porch. An early date of construction is also indicated by the hand hewn logs supporting its floor. The basement foundation of the early section also has hand hewn log supporting beams.

Examination of the foundation of the newer south wing section reveals the use of giant granite blocks, while that of the earlier north wing has fewer of these giant granite blocks and more fieldstone.

The shed roofed enclosed porch along the east elevation has a north and east rectangular entrance door and three rectangular double-hung windows with six-over-six lights. Three second floor windows rest in the east wall. A first and second floor window, similar to those described is centered into its north wall. An exterior square brick chimney is located east of these windows. A rectangular cellar entrance lies west.

The west elevation of this section hold a central rectangular door with a first floor rectangular, double-hung window holding six-over-six lights in its north bay and a first floor double window in the south bay, composed of two double-hung rectangular windows with four-over-four lights. Three second floor rectangular windows holding six-over-six lights rest above.

CONTINUE ON SEPARATE SHEET IF NECESSARY

Phelp's Residence - Description
Continued

HO-266
District 6

A large brick chimney is inset into the roof between the south and central bays of the east and west walls. The foundation of the north wing indicates two separate construction periods with a deeply cut root cellar used as the foundation for this frame structure located under the present kitchen in the central and west bays of the east and west walls.

The crawl space beyond this section which is separated by a mammoth stone chimney foundation is under the south bay of the east and west walls and also has hand hewn log supporting beams. This fact indicates a period of early construction circa 1820, for the entire north wing with perhaps an 18th century date for the kitchen section with root cellar foundation. Two interesting log insets into the stone foundation are found on either side of the foundation entrance. It may have been used to pull a log across the door and form a lock.

A peg barn lies northwest and a log cabin (please see HO-265) due north with an Indian mound further north in the woods, surrounding the house which faces Gorman Road, .9 miles east of Route 29.

The interior features random width floors, central hall and staircase, and cross paneled doors.

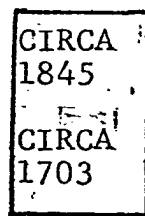
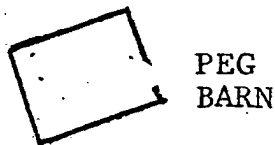

LOG CABIN

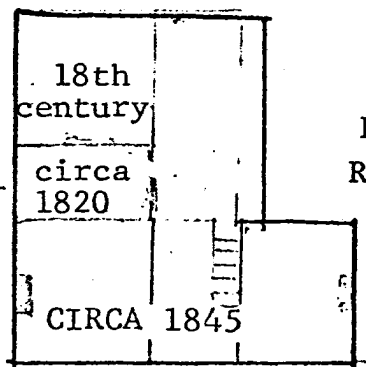

FRAME RESIDENCE

EARLY LOG-
ADDITION

ROUGH SITE PLAN

SIGNIFICANCE

PERIOD	AREAS OF SIGNIFICANCE -- CHECK AND JUSTIFY BELOW			
<input type="checkbox"/> PREHISTORIC	<input type="checkbox"/> ARCHEOLOGY-PREHISTORIC	<input type="checkbox"/> COMMUNITY PLANNING	<input type="checkbox"/> LANDSCAPE ARCHITECTURE	<input type="checkbox"/> RELIGION
<input type="checkbox"/> 1400-1499	<input checked="" type="checkbox"/> ARCHEOLOGY-HISTORIC	<input type="checkbox"/> CONSERVATION	<input type="checkbox"/> LAW	<input type="checkbox"/> SCIENCE
<input type="checkbox"/> 1500-1599	<input type="checkbox"/> AGRICULTURE	<input type="checkbox"/> ECONOMICS	<input type="checkbox"/> LITERATURE	<input type="checkbox"/> SCULPTURE
<input type="checkbox"/> 1600-1699	<input type="checkbox"/> ARCHITECTURE	<input type="checkbox"/> EDUCATION	<input type="checkbox"/> MILITARY	<input type="checkbox"/> SOCIAL/HUMANITARIAN
<input type="checkbox"/> 1700-1799	<input type="checkbox"/> ART	<input type="checkbox"/> ENGINEERING	<input type="checkbox"/> MUSIC	<input type="checkbox"/> THEATER
<input checked="" type="checkbox"/> 1800-1899	<input type="checkbox"/> COMMERCE	<input type="checkbox"/> EXPLORATION/SETTLEMENT	<input type="checkbox"/> PHILOSOPHY	<input type="checkbox"/> TRANSPORTATION
<input type="checkbox"/> 1900-	<input type="checkbox"/> COMMUNICATIONS	<input type="checkbox"/> INDUSTRY	<input type="checkbox"/> POLITICS/GOVERNMENT	<input type="checkbox"/> OTHER (SPECIFY)
		<input type="checkbox"/> INVENTION		

SPECIFIC DATES circa 1820 and circa 1845 BUILDER/ARCHITECT
and eighteenth century

STATEMENT OF SIGNIFICANCE

Research in the Howard County Hall of Records revealed the following property transactions:

1. 18 Day Dec, 1974 (706-340) Ronald S. Goldberg for estate of Charles A. Phelps to Janet Phelps.
2. May 4, 1965 - 434 596 by Strawman, Inc. to Charles & Janet Phelps.
3. Oct 9, 1939 BM 165-294 by George E Daniel - Chester Gilbert 226 A. except 96.8/10 A. by deed March 24 1948 203-592 was conveyed to Edith at Glen Wiltroof.
4. June 30, 1937 (157-315) fr. Citizens National Bank, of Laurel to George Daniel
5. August 16, 1933 (146-111) fr. John S. Stanley, Assignee
6. November 29, 1920 (111-349) fr. James W. Baxley to Citizen's National Bank of Laurel Mortgage for \$6,000 of 226 11/16 Acres.
7. July 9, 1900 (72-231) to Ella Baxley.

The mortgage transaction November 29, 1920 of James W. Baxley mentions the 10 1/2 acres conveyed to Arthur Pue Gorman on August 28, 1903 (77-532).. This was a transaction made by the old senator to take care of Mr. Hobbs, father of his manager, and give him a place to live and care for.

An additional transaction shows Ella Baxley conveyed her interest to Joshva W Baxley (husband) June 25, 1915. (99-537).

8. July 1900 72-231 from Bradley and Mary Worthington to Ella H. Baxley & James W. Baxley (heirs and assigns: in fee simple) for \$2,660.

copy

The property is so described in this deed as "Being all those pieces or parcels of land consisting in the aggregate of 236 13/16 acres of land, more or less, which are conveyed in a deed to The said Bradley Worthington from Thomas Worthington Ridgely and Joshua W. Dorsey, exuc. & trustees, dated July 9, 1900. 72.-229. It is important to note the following: The land hereby conveyed comprising the farm upon which the late Dr. Thomas Chew Worthington resided in Howard County, Maryland." He was a prominent physician of Baltimore and was a descendent of Captain John Worthington and his Son Charles Worthington (1701-1773) whose second wife was Sarah Chew. The deed goes on to enumerate:

"Together with buildings and improvements thereupon erected, made or being; and all and every, the rights, alleys, ways, waters, privileges, appurtenances and advantages belonging or in anywise appertaining."

Thomas Worthington acquired four pieces of land. The first and largest was acquired on March 17, 1845 consisting of 153 acres and 9 square perches by deed (5-472) from John Warfield of Joshua, trustee for the estate of Charles G. Worthington. The second tract of land, consisting of 80 $\frac{1}{2}$ acres was acquired in March 31, 1862 (22-54) from Benjamin H. Dorsey and William H. Warfield, executors.

The third and fourth transactions consisted of 2 $\frac{3}{4}$ acres on Sept. 1, 1888 from Isabella Magruder and husband (53-494) and 2 acres on April 17, 1869 (29-132) from Seth W. Warfield. This latter transaction probably straightened adjoining property lines.

In tracing the 153 acre tract of land, the first transaction in 1845, we find it was.

Part of a tract called "Broken Land", part of a tract called, "Worthingtons Addition" and part of or the entire tract called "Long and Narrow," lying and being in Howard District of Anne Arundel County which included 147 acres. It also comprised the tract of land known as "Pilla Terra" patented to William Sellman. Originally this tract comprised 23 acres but was found by a subsequent survey to contain only six acres and 90 sq. perches, "together with all and singular the buildings, improvements, ways, waters, water courses etc." A William Sellman born, 1689, is noted in Mr. Stein's book on Howard County.

An examination of the basement reveals what once might have been a roof cellar (below the present kitchen) a place for storage, or prison for slaves. Two built in recesses on either side of the cellar door might have been used to put a log beam across the entrance, preventing recalcitrant slaves egress from the basement.

The original framehouse on this property is the present kitchen with second floor above, which may date from the eighteenth century or early nineteenth century. An addition was built which takes in the remainder of the north wing, and stems from a very early date.

During the tenure of Dr. Thomas C. Worthington, who acquired the property in 1845, the south wing facing Gorman Road was constructed. This section of the house is reminiscent of the romanesque revival which hit American domestic architecture in the mid-nineteenth century.

For these reasons, its historic associations and its architectural composition, this building should be considered for inclusion to the National Register & any future local landmark legislation.

9 MAJOR BIBLIOGRAPHICAL REFERENCES

1. Stein, C.F. Origins and History of Howard County, Maryland. Baltimore, 1972
pp 309, 315.
2. Warfield, J.D. Founders of Anne Arundel and Howard Counties, Maryland. Baltimore, 1973.
pp 366, 399, 388, 365.
3. Interview with Mrs. Harwood Owings, Sr.

CONTINUE ON SEPARATE SHEET IF NECESSARY

10 GEOGRAPHICAL DATA

ACREAGE OF NOMINATED PROPERTY 57.907 Acres

Please see Attachment 1
Tax Maps 41 and 42 p. 80.

VERBAL BOUNDARY DESCRIPTION

Please see Attachment 1
Tax Maps 41 and 42 p.80.

LIST ALL STATES AND COUNTIES FOR PROPERTIES OVERLAPPING STATE OR COUNTY BOUNDARIES

STATE	COUNTY

STATE	COUNTY

11 FORM PREPARED BY

NAME / TITLE

Cleora Barnes Thompson, Archivist

ORGANIZATION

Office of Planning & Zoning-Comprehensive Planning Section 465-5000 x257

DATE

STREET & NUMBER

3450 Court House Drive

TELEPHONE

CITY OR TOWN

Ellicott City

STATE

Maryland

The Maryland Historic Sites Inventory was officially created by an Act of the Maryland Legislature, to be found in the Annotated Code of Maryland, Article 41, Section 181 KA, 1974 Supplement.

The Survey and Inventory are being prepared for information and record purposes only and do not constitute any infringement of individual property rights.

RETURN TO: Maryland Historical Trust
The Shaw House, 21 State Circle
Annapolis, Maryland 21401
(301) 267-1438

SELL SR. EWF.
759/220
A.

WESSSELL
59/220

1 67A
409

D. C.
11
23A
P.20

P.21
MAPAN
R.174

MAP 46-P.2

COLUMBIA
MD. 196

REPETTA Ho. CO.
530/34
7.11A
343
312
P.401
WELKER 6.15A
717/278 P.
6.21A. 363

FISHER
647/558
S.78A.
P.386
A.H. YOUNG, JR.
INC.
624/681
S.19A.
P.295
R.L. REVER
647/172
S.20A.
P.395
CARL
FETCHER
647/523
S.27A.
P.395

ALMA MACK
161/215
P.6
280
S.R.C.
9.01A.
P.11

440/295
7.17A.
P.17
440/294
10.29A.
P.16
306
440/298
4.5A
P.298

KINDLER
R.307
R.308
R.309
HAYES PROP
PARTNERSHIP
448/103 - 448/112
43.67A.
P.17

BORIS
F. KIM W.F.
653/554
10.12A.
P.384

MAN
RD.
E. STERKA
285/286
285/287
285/288
285/289
285/290
285/291
285/292
285/293
285/294
285/295
285/296
285/297
285/298
285/299
285/300
DAN BRADLEY
285/131
285/132
285/133
285/134
285/135
285/136
285/137
285/138
285/139
285/140
285/141
285/142
285/143
285/144
285/145
285/146
285/147
285/148
285/149
285/150

MAP 42-P.80

MAP 46-P.2
MAP 42-P.275
MAP 42-P.276
MAP 42-P.277
MAP 42-P.278
MAP 42-P.279
MAP 42-P.280
MAP 42-P.281
MAP 42-P.282
MAP 42-P.283
MAP 42-P.284
MAP 42-P.285
MAP 42-P.286
MAP 42-P.287
MAP 42-P.288
MAP 42-P.289
MAP 42-P.290
MAP 42-P.291
MAP 42-P.292
MAP 42-P.293
MAP 42-P.294
MAP 42-P.295
MAP 42-P.296
MAP 42-P.297
MAP 42-P.298
MAP 42-P.299
MAP 42-P.300

BD. OF
CO. COMM.
498/301
18.16A
P.244

HOWARD CO.
23.18A.
R.140

HOWARD CO.
525/107
36.26A.
P.341

MAP 42-P.
BD. OF
CO. COMM.
494/320
8.77A
P.230

DEV CORP
100/709
160.28A.
P.54

2.70A.
P.380

JANET W PHELPS
706/340
57.91A.
P.80

HOWARD RESEARCH
& DEV. CORP.
406/565
86.8A.
P.337

BD. OF CO. COMM. OF
HO. CO.
497/201
59.18A.
P.379

NOAH P.
SOWERS
201/418
63.67A.
P.81

ES
WILTROU
203/342
6.8A
P.84

SUSQUEHANNA TRANS CO
12.63A
P.82
144/141

Attachment 1
HO-266
Janet Phelps Residence
Tax Maps 41 and 42
800 scale

BD.
OF
67.
3
F

PRINCE

GEORGE

COUNTY

Sixth District.

GENERAL MERCHANT.

A. J. GALL.
Dealer in Groceries, Provisions, Liquors,
&c.
Hooversville.

EXPLANATIONS
 Dist. & Co. Lines
 County Roads
 Private "
 Turnpike "
 Rail Roads
 Streams
 The figures along the Roads
 show the distance in Rods,
 from junction to junction thereof.

Laurel Factory P.O.

Laurel City Factory

Savage Factory
Savage P.O.

Attachment 3

HO-266

Janet Phelp's Residence

Hopkin's Atlas

District 6

1878

GUILFORD DISTRICT

HOWARD COUNTY

Scale 2 1/2 inches per Mile.

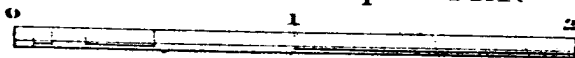

Entered according to Act of Congress in the year 1878 by G.H. Hopkins in the Office of the Librarian of Congress at Washington.

Attachment 2
HO-266
Janet Phelp's Residence
U.S. Geological Survey Map
Savage, Maryland Quad

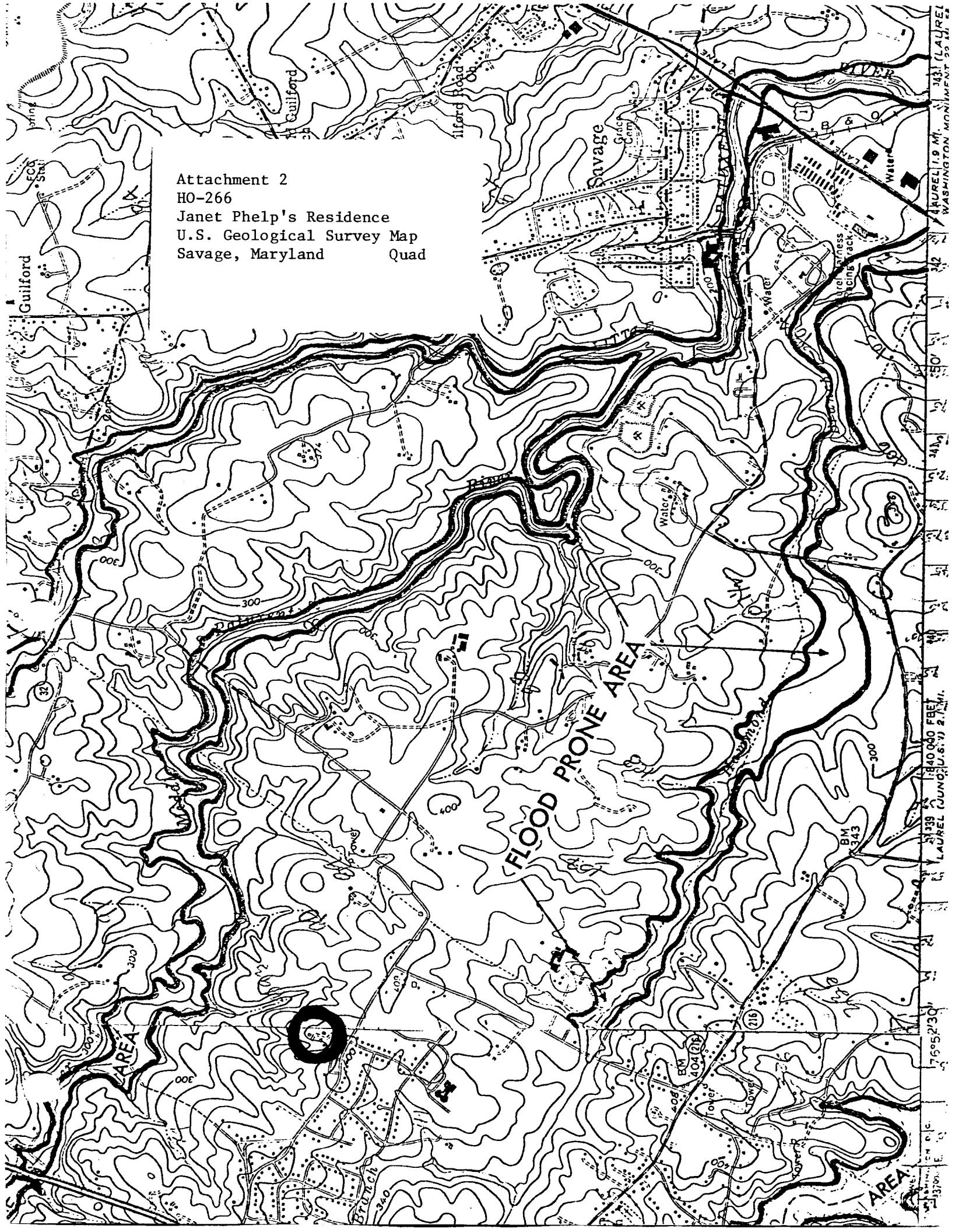

LAUREL 19 M. 343 (LAUREL)
WASHINGTON MONUMENT 99 21 52
342
341
340
339
338
337
336
335
334
333
332
331
330
329
328
327
326
325
324
323
322
321
320
319
318
317
316
315
314
313
312
311
310
309
308
307
306
305
304
303
302
301
300
299
298
297
296
295
294
293
292
291
290
289
288
287
286
285
284
283
282
281
280
279
278
277
276
275
274
273
272
271
270
269
268
267
266
265
264
263
262
261
260
259
258
257
256
255
254
253
252
251
250
249
248
247
246
245
244
243
242
241
240
239
238
237
236
235
234
233
232
231
230
229
228
227
226
225
224
223
222
221
220
219
218
217
216
215
214
213
212
211
210
209
208
207
206
205
204
203
202
201
200
199
198
197
196
195
194
193
192
191
190
189
188
187
186
185
184
183
182
181
180
179
178
177
176
175
174
173
172
171
170
169
168
167
166
165
164
163
162
161
160
159
158
157
156
155
154
153
152
151
150
149
148
147
146
145
144
143
142
141
140
139
138
137
136
135
134
133
132
131
130
129
128
127
126
125
124
123
122
121
120
119
118
117
116
115
114
113
112
111
110
109
108
107
106
105
104
103
102
101
100
99
98
97
96
95
94
93
92
91
90
89
88
87
86
85
84
83
82
81
80
79
78
77
76
75
74
73
72
71
70
69
68
67
66
65
64
63
62
61
60
59
58
57
56
55
54
53
52
51
50
49
48
47
46
45
44
43
42
41
40
39
38
37
36
35
34
33
32
31
30
29
28
27
26
25
24
23
22
21
20
19
18
17
16
15
14
13
12
11
10
9
8
7
6
5
4
3
2
1
0
-1
-2
-3
-4
-5
-6
-7
-8
-9
-10
-11
-12
-13
-14
-15
-16
-17
-18
-19
-20
-21
-22
-23
-24
-25
-26
-27
-28
-29
-30
-31
-32
-33
-34
-35
-36
-37
-38
-39
-40
-41
-42
-43
-44
-45
-46
-47
-48
-49
-50
-51
-52
-53
-54
-55
-56
-57
-58
-59
-60
-61
-62
-63
-64
-65
-66
-67
-68
-69
-70
-71
-72
-73
-74
-75
-76
-77
-78
-79
-80
-81
-82
-83
-84
-85
-86
-87
-88
-89
-90
-91
-92
-93
-94
-95
-96
-97
-98
-99
-100



CLEORA BARNES THOMPSON
FINANCIAL CONSULTANT
HISTORICAL SITES SURVEY

HJ0-266
PHELPS RESIDENCE
JUNE-1977