

HO - 227

The Lewis-Warfield House - Nineteenth century

Lisbon

Private

The Lewis-Warfield House faces south on the north side of Route 144, just east of the old Lisbon Hotel, HO - 206. It is a three bay wide, one room deep, two story high, gabled roof (running east-west) brick (laid in flemish bond) building, laid on a stone foundation, with square brick chimney inset into its east wall and central rectangular entrance, surmounted by a four light transom flanked by single, rectangular, double-hung windows.

The building is notable as the residence of Reuben Warfield, local surveyor and of his son, Dr. Orlander Dorsey Warfield, local physician. It has been beautifully restored by its present owners, Mr. & Mrs. Lewis.

INVENTORY FORM FOR STATE HISTORIC SITES SURVEY

1 NAME

HISTORIC The Lewis-Warfield House

AND/OR COMMON

2 LOCATION

STREET & NUMBER
15948 Frederick Road (MD 144)

CITY, TOWN
Lisbon

CONGRESSIONAL DISTRICT

6th

___ VICINITY OF

STATE
Maryland

COUNTY

Howard

3 CLASSIFICATION

CATEGORY	OWNERSHIP	STATUS	PRESENT USE	
<input checked="" type="checkbox"/> DISTRICT	<input type="checkbox"/> PUBLIC	<input checked="" type="checkbox"/> OCCUPIED	<input type="checkbox"/> AGRICULTURE	<input type="checkbox"/> MUSEUM
<input type="checkbox"/> BUILDING(S)	<input checked="" type="checkbox"/> PRIVATE	<input type="checkbox"/> UNOCCUPIED	<input type="checkbox"/> COMMERCIAL	<input type="checkbox"/> PARK
<input type="checkbox"/> STRUCTURE	<input type="checkbox"/> BOTH	<input type="checkbox"/> WORK IN PROGRESS	<input type="checkbox"/> EDUCATIONAL	<input checked="" type="checkbox"/> PRIVATE RESIDENCE
<input type="checkbox"/> SITE	PUBLIC ACQUISITION	ACCESSIBLE	<input type="checkbox"/> ENTERTAINMENT	<input type="checkbox"/> RELIGIOUS
<input type="checkbox"/> OBJECT	<input type="checkbox"/> IN PROCESS	<input checked="" type="checkbox"/> YES RESTRICTED	<input type="checkbox"/> GOVERNMENT	<input type="checkbox"/> SCIENTIFIC
	<input type="checkbox"/> BEING CONSIDERED	<input type="checkbox"/> YES UNRESTRICTED	<input type="checkbox"/> INDUSTRIAL	<input type="checkbox"/> TRANSPORTATION
		<input type="checkbox"/> NO	<input type="checkbox"/> MILITARY	<input type="checkbox"/> OTHER

4 OWNER OF PROPERTY

NAME
Mr. and Mrs. Dennis Lee Lewis

Telephone #:

STREET & NUMBER
15948 Frederick Road

CITY, TOWN
Lisbon, ___ VICINITY OF

STATE, zip code
Maryland 21765

5 LOCATION OF LEGAL DESCRIPTION

COURTHOUSE, REGISTRY OF DEEDS, ETC. Hall of Records Tax Map 7 p.237

Liber #: 534
Folio #: 338

STREET & NUMBER
Howard County Court House

CITY, TOWN
Ellicott City

STATE
Maryland

6 REPRESENTATION IN EXISTING SURVEYS

TITLE
Howard County Historic Sites Inventory

DATE
1978-1979

___ FEDERAL STATE ___ COUNTY ___ LOCAL

DEPOSITORY FOR SURVEY RECORDS
Maryland Historical Trust

CITY, TOWN
21 State Circle, Annapolis

STATE
Maryland

7 DESCRIPTIONHO-227
District 4

CONDITION		CHECK ONE	CHECK ONE
<input checked="" type="checkbox"/> EXCELLENT	<input type="checkbox"/> DETERIORATED	<input type="checkbox"/> UNALTERED	<input checked="" type="checkbox"/> ORIGINAL SITE
<input type="checkbox"/> GOOD	<input type="checkbox"/> RUINS	<input checked="" type="checkbox"/> ALTERED	<input type="checkbox"/> MOVED DATE _____
<input type="checkbox"/> FAIR	<input type="checkbox"/> UNEXPOSED		

DESCRIBE THE PRESENT AND ORIGINAL (IF KNOWN) PHYSICAL APPEARANCE

The Lewis-Warfield House faces south on the north side of Route 144, just east of the Old Lisbon Hotel, HO-206 at the intersection of old Route 94 and Route 144. It is a three bay wide, one room deep, two story high, gabled roof (running east-west) brick (laid in flemish bond) house, laid on a stone foundation with a square brick chimney inset into its east wall.

The south elevation holds an open bible and cross paneled central entrance door, surmounted by a four light transom and flanked by single, rectangular, double-hung windows with six-over-one lights. Five wooden steps lead to the landing of the one story high, shed roofed open porch, supported by four rounded posts, which runs along almost the entire elevation. Three vertically aligned and proportionally scaled second floor windows are placed above. They are decorated with projecting wooden sills and flat arched brick lintels.

The east elevation holds a six light basement window and two square attic vents, decorated with projecting wooden sills and header brick flat lintels.

The west elevation holds a rectangular second floor, double-hung window with two-over-two lights, decorated with a header brick projecting sill and header brick flat lintel.

The second floor of the north elevation of the house holds a central bay one-over-one light window and a six-over-one light east bay window. Extending north from the west bay is a two bay deep, one bay wide, two story high, intersecting gable roof (running north-south) frame addition. Two second floor, double-hung windows, holding two-over-two lights rest in both its east and west walls. A rectangular west entrance leads on to a one story high, shed roof enclosed sun porch-den, holding a continuous row of windows, and running along the entire west elevation of both the frame addition and the original brick structure.

An additional one story high shed roofed appendage runs along the east wall of the frame addition, meeting the shed roofed, one story high, open porch, placed along the remainder of the brick building's north wall.

The entire house has obviously been recently renovated and is extremely well maintained.

Pleasant side and back yards, well planted and cared for complete the picture.

CONTINUE ON SEPARATE SHEET IF NECESSARY

8 SIGNIFICANCE

PERIOD		AREAS OF SIGNIFICANCE -- CHECK AND JUSTIFY BELOW				
<input type="checkbox"/> PREHISTORIC	<input type="checkbox"/> ARCHEOLOGY-PREHISTORIC	<input type="checkbox"/> COMMUNITY PLANNING	<input type="checkbox"/> LANDSCAPE ARCHITECTURE	<input type="checkbox"/> RELIGION		
<input type="checkbox"/> 1400-1499	<input type="checkbox"/> ARCHEOLOGY-HISTORIC	<input type="checkbox"/> CONSERVATION	<input type="checkbox"/> LAW	<input type="checkbox"/> SCIENCE		
<input type="checkbox"/> 1500-1599	<input type="checkbox"/> AGRICULTURE	<input type="checkbox"/> ECONOMICS	<input type="checkbox"/> LITERATURE	<input type="checkbox"/> SCULPTURE		
<input type="checkbox"/> 1600-1699	<input checked="" type="checkbox"/> ARCHITECTURE	<input type="checkbox"/> EDUCATION	<input type="checkbox"/> MILITARY	<input type="checkbox"/> SOCIAL/HUMANITARIAN		
<input type="checkbox"/> 1700-1799	<input type="checkbox"/> ART	<input type="checkbox"/> ENGINEERING	<input type="checkbox"/> MUSIC	<input type="checkbox"/> THEATER		
<input checked="" type="checkbox"/> 1800-1899	<input type="checkbox"/> COMMERCE	<input type="checkbox"/> EXPLORATION/SETTLEMENT	<input type="checkbox"/> PHILOSOPHY	<input type="checkbox"/> TRANSPORTATION		
<input type="checkbox"/> 1900-	<input type="checkbox"/> COMMUNICATIONS	<input type="checkbox"/> INDUSTRY	<input type="checkbox"/> POLITICS/GOVERNMENT	<input checked="" type="checkbox"/> OTHER (SPECIFY)	Local History	
		<input type="checkbox"/> INVENTION				

SPECIFIC DATES: Early Nineteenth Century BUILDER/ARCHITECT

STATEMENT OF SIGNIFICANCE

The Lewis-Warfield House is significant architecturally and historically to the town of Lisbon and the State of Maryland.

Architecturally, it is one of the six brick houses constructed in Lisbon during the early decades of the nineteenth century. The others are the Mayne Brick-Log House HO - 202, the Presbyterian Manse, HO - 204, the Old Lisbon Hotel, HO - 206, the Dorsey - John House, HO - 228 and the Old Female Seminary, HO - 230.

Each is individual in its own right. The Mayne House, similar to the Warfield House in its three bay width, is now covered with cement and has additions to its east and north walls. The Presbyterian Manse is similar in scale to the Warfield House's spaciousness, but may have originally been a four bay wide, double house, similar to the Warfield House's neighbor to the east, the Dorsey - John House, HO -228 while the old Female Seminary, HO - 230 is three bays in width but smaller in scale than the Warfield House.

The Warfield House is also an important architectural link in the streetscape on the north side of Route 144, connecting the old Lisbon Hotel with the Dorsey - John House.

Historically, it has been pointed out by local historian, Mrs. Celia Holland, that this house was the home of Reuben Warfield, surveyor and "man of marked ability". According to Mrs. Holland, his surveys were said to cover most of Howard County. He was a member of the prominent Warfield family of Howard County, the son of Elie and Frances Dorsey Chapman Warfield and the grandson of Seth Warfield of Warfield Forest. His son, Dr. Orlander Dorsey Warfield inherited the house, used the front room as his office, and lived as a bachelor on the second floor.

Significant architecturally and historically to the village of Lisbon, the County of Howard and the State of Maryland, the Lewis-Warfield House should be placed, along with the entire village of Lisbon, on the National Register of Historic Landmarks and the State Critical Areas Program.

CONTINUE ON SEPARATE SHEET IF NECESSARY

9 MAJOR BIBLIOGRAPHICAL REFERENCES

Holland, Celia. "Out of the Past:
Lisbon" The Times: Ellicott City, Maryland
June 14, 1973 p. 1D

CONTINUE ON SEPARATE SHEET IF NECESSARY

10 GEOGRAPHICAL DATA

ACREAGE OF NOMINATED PROPERTY .25 Acres plus part of 1/4 acre lots #63 & #64 on Lisbon Plat

Please see Attachment 1, Tax Map 7 p.237

VERBAL BOUNDARY DESCRIPTION

Please see Howard County Land Records, Liber 534 Folio 338

LIST ALL STATES AND COUNTIES FOR PROPERTIES OVERLAPPING STATE OR COUNTY BOUNDARIES

STATE Maryland COUNTY Howard

STATE _____ COUNTY _____

11 FORM PREPARED BY

NAME / TITLE

Cleora Barnes Thompson, Archivist

ORGANIZATION

Office of Planning & Zoning-Comprehensive Planning Section

DATE

STREET & NUMBER

3450 Court House Drive

TELEPHONE

CITY OR TOWN

Ellicott City

STATE

Maryland

The Maryland Historic Sites Inventory was officially created by an Act of the Maryland Legislature, to be found in the Annotated Code of Maryland, Article 41, Section 181 KA, 1974 Supplement.

The Survey and Inventory are being prepared for information and record purposes only and do not constitute any infringement of individual property rights.

RETURN TO: Maryland Historical Trust
The Shaw House, 21 State Circle
Annapolis, Maryland 21401
(301) 267-1438

MD. HISTORICAL TRUST
BOX 1704
ANNAPOLIS, MD. 21404

NATIONAL REGISTER OF HISTORIC PLACES
INVENTORY - NOMINATION FORM

(Type all entries - complete applicable sections)

STATE:	
COUNTY:	
FOR NPS USE ONLY	
ENTRY NUMBER	DATE

1. NAME

COMMON: Lewis ~~Warfield~~ - Warfield house

AND/OR HISTORIC: ~~Warfield~~ Warfield house

2. LOCATION

STREET AND NUMBER: 15948 Old National Pike

CITY OR TOWN: Lisbon

STATE: Md CODE: COUNTY: Howard CODE:

3. CLASSIFICATION

CATEGORY (Check One)	OWNERSHIP	STATUS	ACCESSIBLE TO THE PUBLIC
District <input type="checkbox"/> Building <input checked="" type="checkbox"/>	Public <input type="checkbox"/>	Occupied <input checked="" type="checkbox"/>	Yes: <input checked="" type="checkbox"/> Restricted <input type="checkbox"/>
Site <input type="checkbox"/> Structure <input type="checkbox"/> Private <input checked="" type="checkbox"/>	Private <input type="checkbox"/>	In Process <input type="checkbox"/>	Unoccupied <input type="checkbox"/>
Object <input type="checkbox"/>	Both <input type="checkbox"/>	Being Considered <input type="checkbox"/>	Unrestricted <input type="checkbox"/>
PRESENT USE (Check One or More as Appropriate)			
Agricultural <input type="checkbox"/>	Government <input type="checkbox"/>	Park <input type="checkbox"/>	Transportation <input type="checkbox"/> Comments <input type="checkbox"/>
Commercial <input type="checkbox"/>	Industrial <input type="checkbox"/>	Private Residence <input checked="" type="checkbox"/>	Other (Specify) <input type="checkbox"/>
Educational <input type="checkbox"/>	Military <input type="checkbox"/>	Religious <input type="checkbox"/>	
Entertainment <input type="checkbox"/>	Museum <input type="checkbox"/>	Scientific <input type="checkbox"/>	

4. OWNER OF PROPERTY

OWNERS NAME: Dennis & M. Susan Lewis ?

STREET AND NUMBER: 15948 Old National Pike

CITY OR TOWN: Lisbon STATE: Md CODE:

5. LOCATION OF LEGAL DESCRIPTION

COURTHOUSE, REGISTRY OF DEEDS, ETC: CLERK OF THE CIRCUIT COURT

STREET: ~~HOWARD COUNTY COURTHOUSE~~ ~~70 S. MAIN ST.~~

CITY OR TOWN: ~~DEL AIR~~ Ellicott City STATE: MARYLAND CODE: 21043

APPROXIMATE ACREAGE OF NOMINATED PROPERTY:

6. REPRESENTATION IN EXISTING SURVEYS

TITLE OF SURVEY:

DATE OF SURVEY: Federal State County Local

DEPOSITORY FOR SURVEY RECORDS:

STREET AND NUMBER:

CITY OR TOWN: STATE: CODE:

SEE INSTRUCTIONS

STATE:
COUNTY:
ENTRY NUMBER
DATE
FOR NPS USE ONLY

7. DESCRIPTION

CONDITION	(Check One)					
	Excellent <input type="checkbox"/>	Good <input checked="" type="checkbox"/>	Fair <input type="checkbox"/>	Deteriorated <input type="checkbox"/>	Ruins <input type="checkbox"/>	Unexposed <input type="checkbox"/>
INTEGRITY	(Check One)			(Check One)		
	Altered <input checked="" type="checkbox"/>	Unaltered <input type="checkbox"/>		Moved <input type="checkbox"/>	Original Site <input checked="" type="checkbox"/>	

DESCRIBE THE PRESENT AND ORIGINAL (if known) PHYSICAL APPEARANCE

This painted brick house, 2 stories, is L shaped. Facing south, 3 bays by 1, its wing runs north along the west end wall. The wing is of frame, clap board.

The ^{tin} A frame roof ridge line runs east-west, with a chimney in side the east end wall. Windows have 6 lights over 1. A one-story porch shelters the south side of the house, and another the west end wall.

SEE INSTRUCTIONS

8. SIGNIFICANCE

PERIOD (Check One or More as Appropriate)

- Pre-Columbian
- 15th Century
- 16th Century
- 17th Century
- 18th Century
- 19th Century
- 20th Century

SPECIFIC DATE(S) (If Applicable and Known)

AREAS OF SIGNIFICANCE (Check One or More as Appropriate)

- | | | | |
|---|---------------------------------------|--|--|
| Aboriginal | Education <input type="checkbox"/> | Political <input type="checkbox"/> | Urban Planning <input type="checkbox"/> |
| Prehistoric <input type="checkbox"/> | Engineering <input type="checkbox"/> | Religion/Philosophy <input type="checkbox"/> | Other (Specify) <input type="checkbox"/> |
| Historic <input type="checkbox"/> | Industry <input type="checkbox"/> | Science <input type="checkbox"/> | _____ |
| Agriculture <input type="checkbox"/> | Invention <input type="checkbox"/> | Sculpture <input type="checkbox"/> | _____ |
| Art <input type="checkbox"/> | Landscape <input type="checkbox"/> | Social/Humanitarian <input type="checkbox"/> | _____ |
| Commerce <input type="checkbox"/> | Architecture <input type="checkbox"/> | Theater <input type="checkbox"/> | _____ |
| Communications <input type="checkbox"/> | Literature <input type="checkbox"/> | Transportation <input type="checkbox"/> | _____ |
| Conservation <input type="checkbox"/> | Military <input type="checkbox"/> | | |
| | Music <input type="checkbox"/> | | |

STATEMENT OF SIGNIFICANCE (Include Personages, Dates, Events, Etc.)

This plain well-proportioned house remains in good condition as the demand for housing increases.

The first owner was Reuben Warfield, surveyor, and his son Dr. Orlando Warfield had his office on the first floor while his daughter Frances (Fanny) Warfield lived upstairs.

SEE INSTRUCTIONS

9. MAJOR BIBLIOGRAPHICAL REFERENCES

Mastered's Map of Howard County shows Reuben Warfield as owner.

10. GEOGRAPHICAL DATA

LATITUDE AND LONGITUDE COORDINATES DEFINING A RECTANGLE LOCATING THE PROPERTY			O R	LATITUDE AND LONGITUDE COORDINATES DEFINING THE CENTER POINT OF A PROPERTY OF LESS THAN ONE ACRE		
CORNER	LATITUDE			LATITUDE		LONGITUDE
	Degrees	Minutes	Seconds	Degrees	Minutes	Seconds
NW	°	'	"	°	'	"
NE	°	'	"	°	'	"
SE	°	'	"	°	'	"
SW	°	'	"	°	'	"

LIST ALL STATES AND COUNTIES FOR PROPERTIES OVERLAPPING STATE OR COUNTY BOUNDARIES

STATE:	CODE	COUNTY	CODE
STATE:	CODE	COUNTY:	CODE
STATE:	CODE	COUNTY:	CODE
STATE:	CODE	COUNTY:	CODE

11. FORM PREPARED BY

NAME AND TITLE: _____

ORGANIZATION _____ DATE _____

STREET AND NUMBER: _____

CITY OR TOWN: _____ STATE _____ CODE _____

12. STATE LIAISON OFFICER CERTIFICATION

NATIONAL REGISTER VERIFICATION

As the designated State Liaison Officer for the National Historic Preservation Act of 1966 (Public Law 89-665), I hereby nominate this property for inclusion in the National Register and certify that it has been evaluated according to the criteria and procedures set forth by the National Park Service. The recommended level of significance of this nomination is:

National State Local

Name _____

Title _____

Date _____

I hereby certify that this property is included in the National Register.

Chief, Office of Archeology and Historic Preservation

Date _____

ATTEST:

Keeper of The National Register

Date _____

SEE INSTRUCTIONS

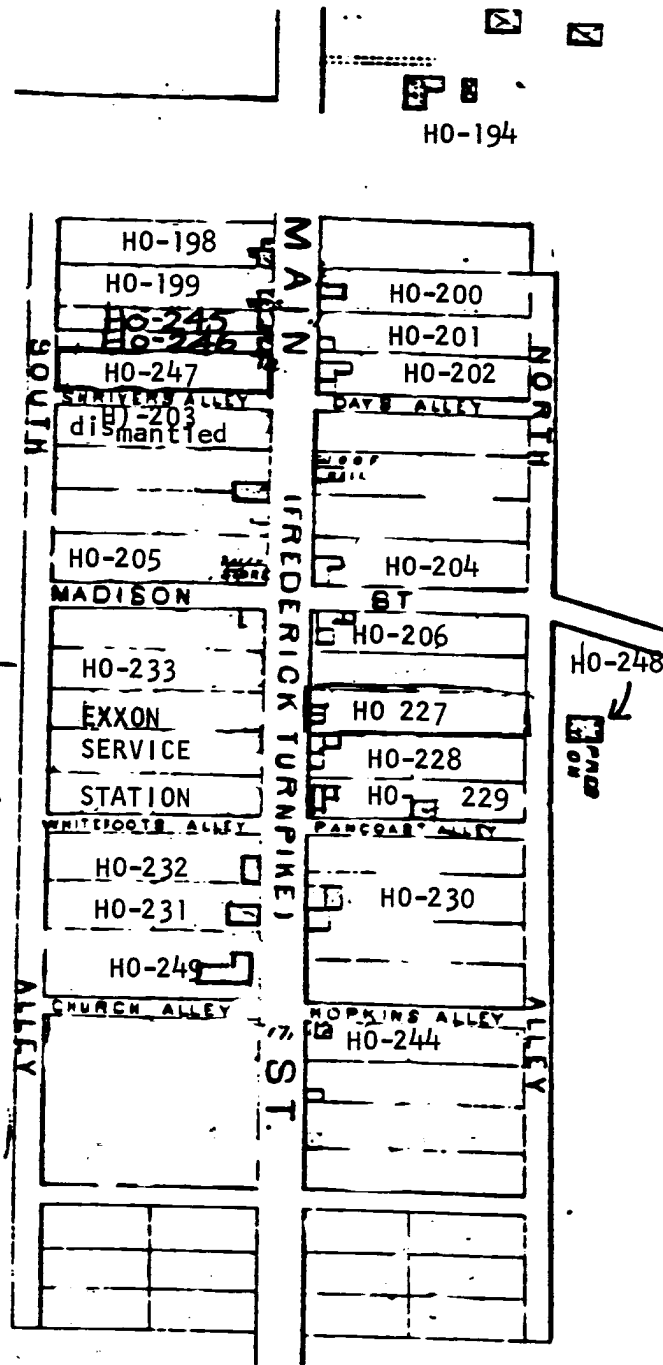

ATTACHMENT 5
 LISBON HISTORIC
 DISTRICT
 HO-NUMBERS
 CORRESPONDENCE to 1978
 HISTORIC SITES INVENTORY

Attachment 4
 HO - 227
 The Lewis-Warfield House
 Hopkins Atlas of 1878

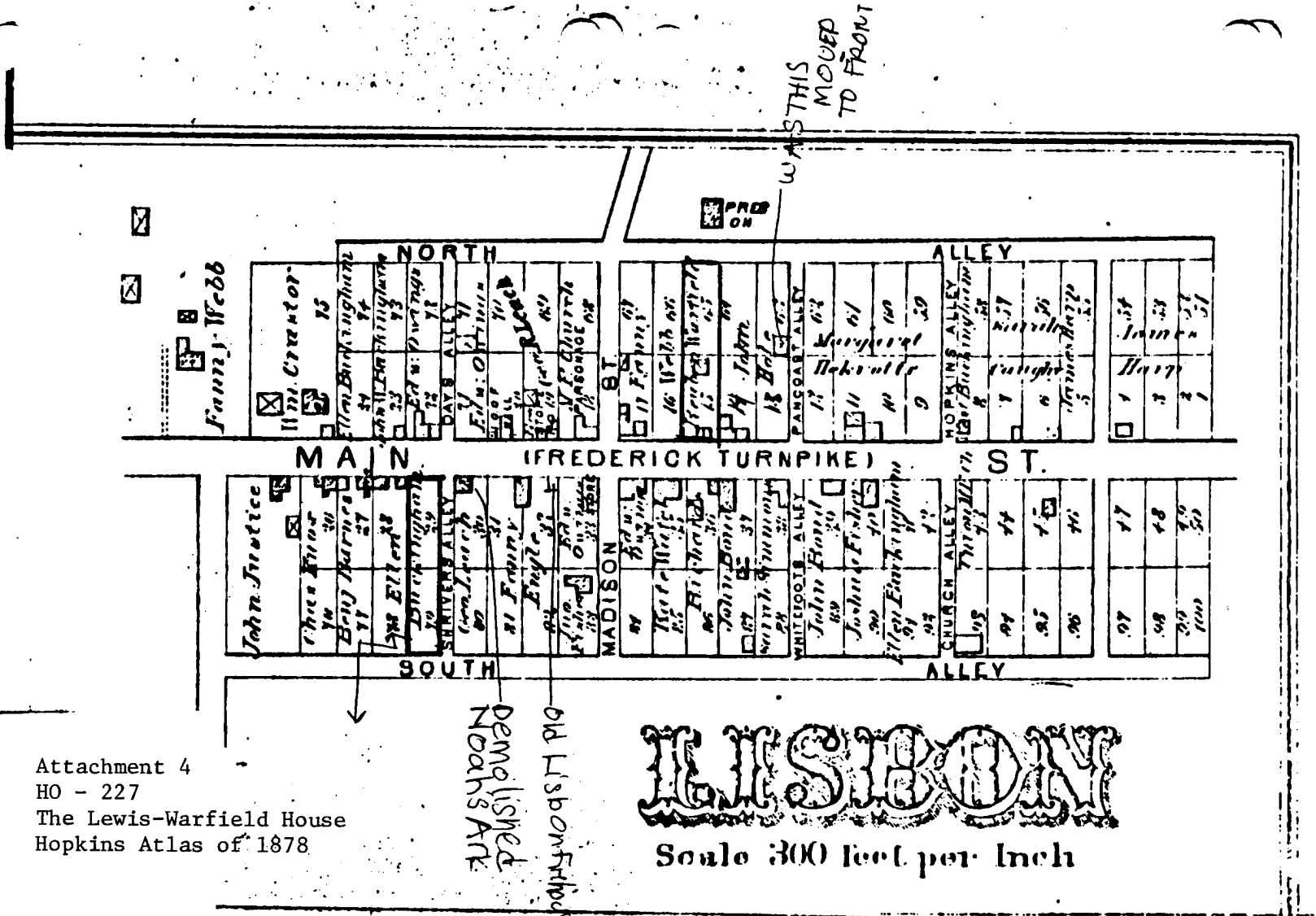

Lisbon District, No. 4
 Copied from:

Hopkins, Atlas of Howard County, 1878
 R. Md. 917 5281

copied from:

Hopkins, Atlas of Howard County, 1878

R. Md. 917. 5281

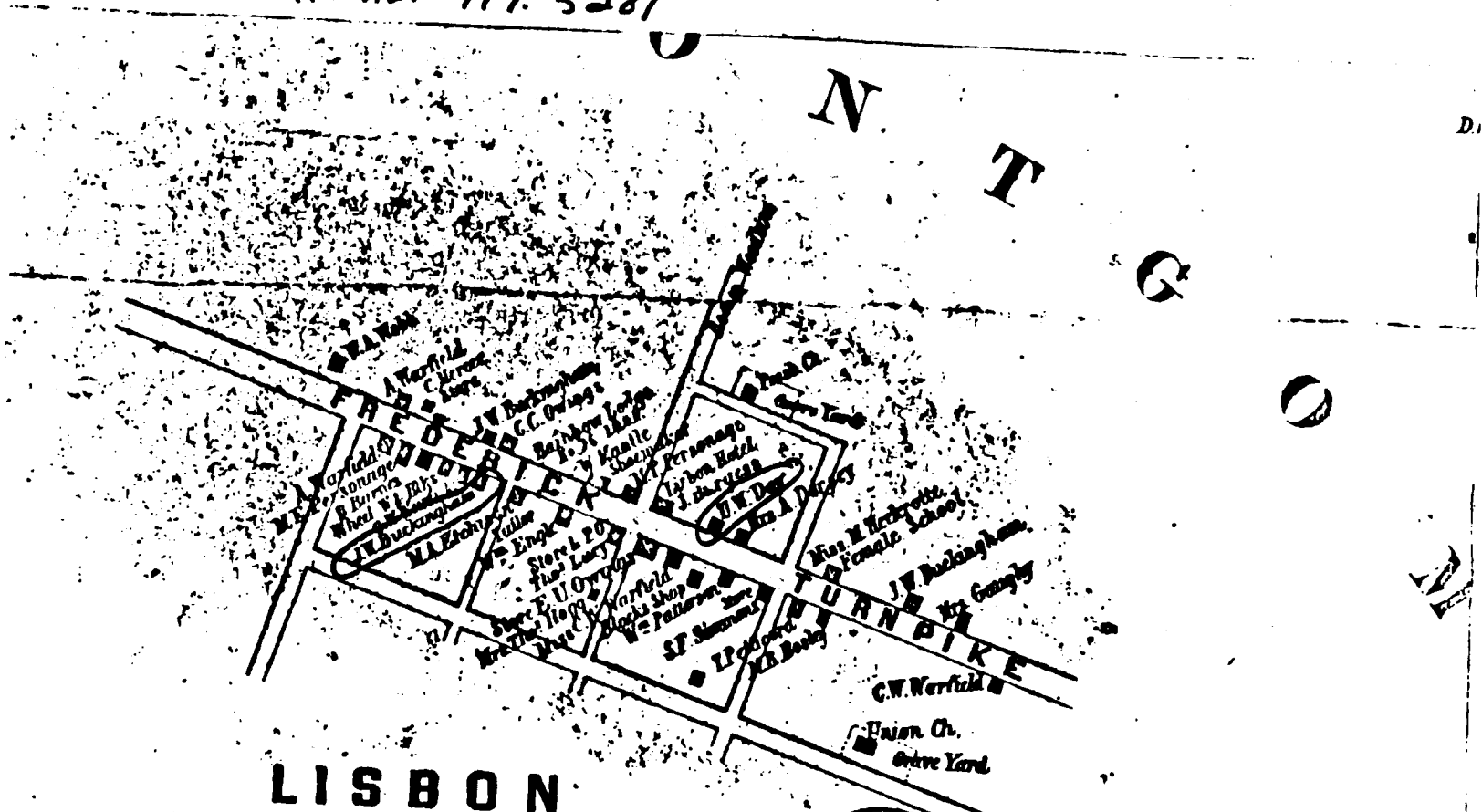

Attachment 3
HO-227
The Lewis-Warfield House
Martenet's Map of Lisbon 1860

MARTENET'S
OF
HOWARD CO. 1860

DOPLAR
NGS

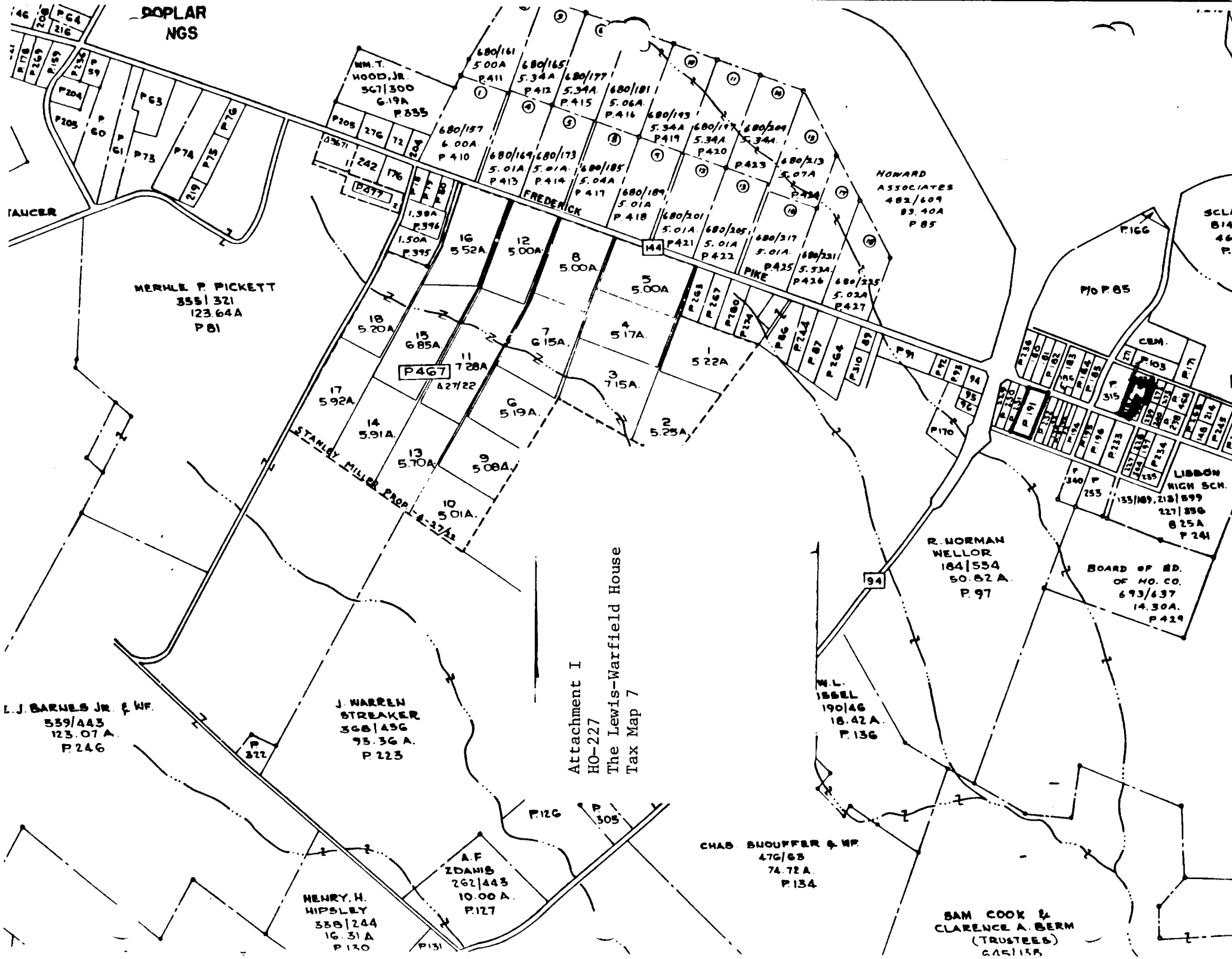

L. J. BARNES JR. & WF.
539/443
123.07A
P246

MERLE P. PICKETT
355/321
123.64A
P81

J. WARREN
STREAKER
368/456
93.36A
P223

HENRY. H.
HIPSLEY
338/244
16.31A
P130

A.F.
ZDANIS
262/443
10.00A
P127

Attachment I
HO-227
The Lewis-Warfield House
Tax Map 7

CHAD SNOUFFER & WF.
476/68
74.72A
P134

W.F.
IBBEL
190/46
18.42A
P136

R. NORMAN
WELLOR
184/534
50.82A
P97

SAM COOK &
CLARENCE A. BERM
(TRUSTEES)
681/158

BOARD OF ED.
OF HO. CO.
693/637
14.30A
P429

LIBBON
HIGH SCH.
227/856
825A
P241

HOWARD
ASSOCIATES
482/609
83.40A
P85

SCLA
814
46.
P1

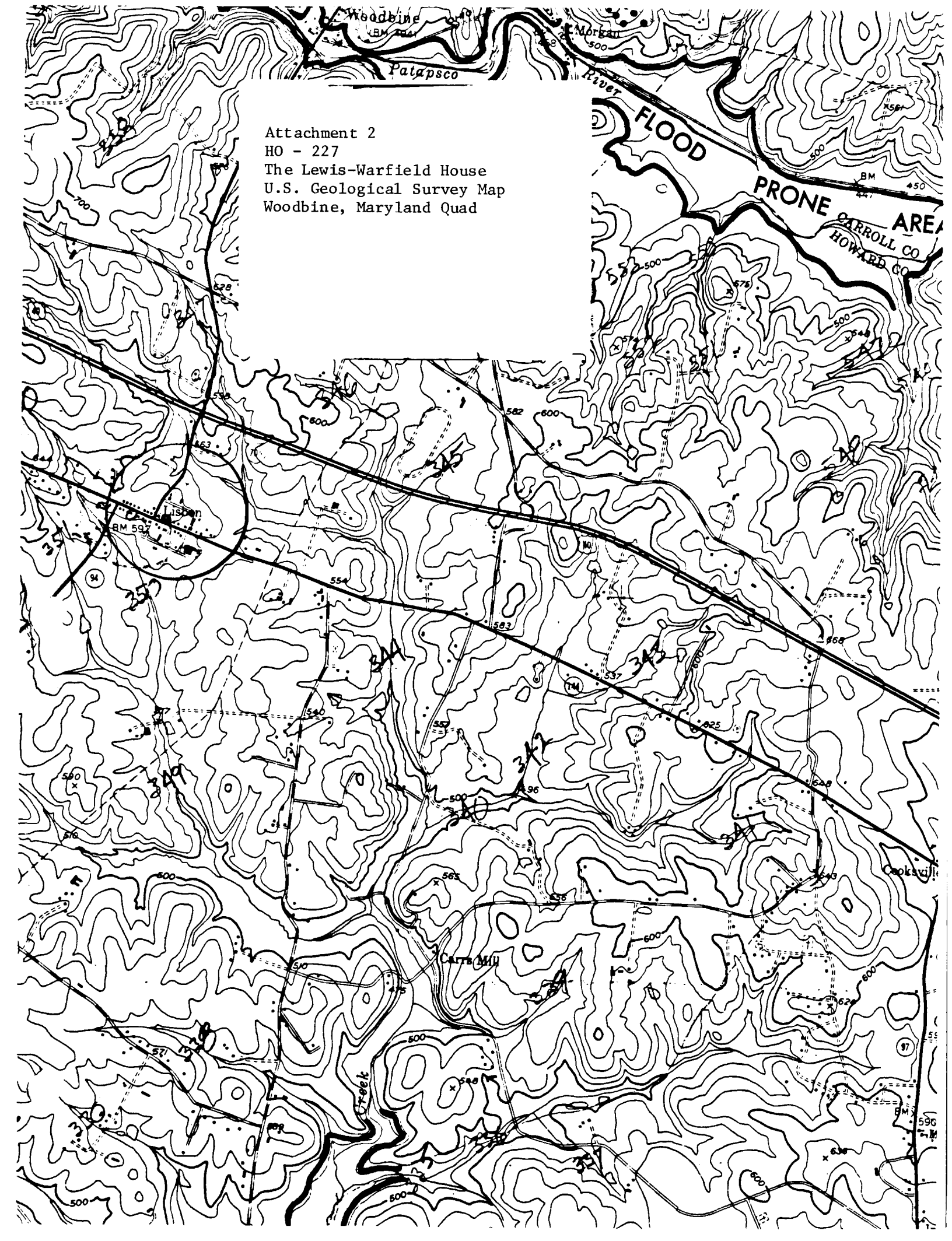
A topographic map of the Woodbine area in Maryland. The map features contour lines indicating elevation, with 500-foot contours being prominent. The Patapsco River flows from the top center towards the bottom center. A large area in the upper right is outlined with a thick black line and labeled 'FLOOD PRONE AREA'. This area is situated near the confluence of the Patapsco River and another waterway. Other labeled locations include Woodbine, Morgan, Carrs Mill, and Cooks Mill. The map also shows various structures, roads, and survey points (e.g., BM 594, BM 597, BM 598, BM 599). Handwritten annotations include the number '3' and '34' in several locations, and '34' is written near a circled area on the left side. The map is a black and white line drawing. The flood-prone area is roughly bounded by the river to the north and west, and by a series of contour lines and a straight line to the east and south.

Attachment 2
HO - 227
The Lewis-Warfield House
U.S. Geological Survey Map
Woodbine, Maryland Quad

FLOOD

PRONE AREA
CARROLL CO.
HOWARD CO.

Woodbine
BM 594

Morgan
500

Patapsco River

Carrs Mill

Cooks Mill

Truck

BM 598

BM 597

BM 599

BM 590

HO-227
Lewiswarfield House

Jennifer K. Cosham
April 16, 2004
Digital color photo on file at MHT



1



SC
4

HO. 227

Lewis - Warfield
~~Lewis~~ house, Lisbon

JS 11/72



