

Ho-225
Millworkers' Houses
Savage
Private

nineteenth century

These five detached duplexes located on the south side of Baltimore Street face north. They are all precisely the same in exterior appearance. Each is a four bay wide, two bay deep, two story high, gabled roof (running east-west) brick (laid in common bond) structure with wide brick chimneys inset into the dividing wall of the houses on each side of their gabled roofs. Built for the Savage Cotton Mill to house their mill workers, they and their neighbors along Baltimore and Washington Streets comprise a fine example, amazingly intact, of town planning in the grid pattern by early American industrialists.

INVENTORY FORM FOR STATE HISTORIC SITES SURVEY MAGI # 1402255504

1 NAME

HISTORIC Millworkers' Houses

AND/OR COMMON

Storch Realty Duplex Mill Houses

2 LOCATION

STREET & NUMBER

9051-9069 Baltimore St.

6th Dist.

CITY, TOWN

Savage

CONGRESSIONAL DISTRICT

--- VICINITY OF

Howard

STATE

Maryland

COUNTY

3 CLASSIFICATION

CATEGORY	OWNERSHIP	STATUS	PRESENT USE
<input checked="" type="checkbox"/> DISTRICT	<input type="checkbox"/> PUBLIC	<input checked="" type="checkbox"/> OCCUPIED	<input type="checkbox"/> AGRICULTURE <input type="checkbox"/> MUSEUM
<input type="checkbox"/> BUILDING(S)	<input checked="" type="checkbox"/> PRIVATE	<input type="checkbox"/> UNOCCUPIED	<input type="checkbox"/> COMMERCIAL <input type="checkbox"/> PARK
<input type="checkbox"/> STRUCTURE	<input type="checkbox"/> BOTH	<input type="checkbox"/> WORK IN PROGRESS	<input type="checkbox"/> EDUCATIONAL <input checked="" type="checkbox"/> PRIVATE RESIDENCE
<input type="checkbox"/> SITE	PUBLIC ACQUISITION	ACCESSIBLE	<input type="checkbox"/> ENTERTAINMENT <input type="checkbox"/> RELIGIOUS
<input type="checkbox"/> OBJECT	<input type="checkbox"/> IN PROCESS	<input checked="" type="checkbox"/> YES, RESTRICTED	<input type="checkbox"/> GOVERNMENT <input type="checkbox"/> SCIENTIFIC
	<input type="checkbox"/> BEING CONSIDERED	<input type="checkbox"/> YES UNRESTRICTED	<input type="checkbox"/> INDUSTRIAL <input type="checkbox"/> TRANSPORTATION
		<input type="checkbox"/> NO	<input type="checkbox"/> MILITARY <input type="checkbox"/> OTHER

4 OWNER OF PROPERTY

NAME

Mr. & Mrs. Bourough Storch

Home: 764-3206

Telephone #: off. 792-0393

STREET & NUMBER

8930 Baltimore Street

Maryland 20863

CITY, TOWN

Savage

--- VICINITY OF

STATE, zip code

5 LOCATION OF LEGAL DESCRIPTION

COURTHOUSE,
REGISTRY OF DEEDS, ETC.

Hall of Records

Tax Map 47
p. 684

Liber #: 630

Folio #: 745

STREET & NUMBER

Howard County Court House

CITY, TOWN

Ellicott City

STATE

Maryland

6 REPRESENTATION IN EXISTING SURVEYS

TITLE National Register of Historic Places

Nomination form for Savage Mill Historic District

DATE

September 1973

FEDERAL STATE COUNTY LOCAL

DEPOSITORY FOR
SURVEY RECORDS

Office of Archeology and Historic
Preservation NPS

CITY, TOWN

Washington

STATE

D.C.

7 DESCRIPTIONHo-225
Dist 6

CONDITION		CHECK ONE	CHECK ONE
<input checked="" type="checkbox"/> EXCELLENT	<input type="checkbox"/> DETERIORATED	<input checked="" type="checkbox"/> UNALTERED	<input checked="" type="checkbox"/> ORIGINAL SITE
<input type="checkbox"/> GOOD	<input type="checkbox"/> RUINS	<input type="checkbox"/> ALTERED	<input type="checkbox"/> MOVED DATE _____
<input type="checkbox"/> FAIR	<input type="checkbox"/> UNEXPOSED		

DESCRIBE THE PRESENT AND ORIGINAL (IF KNOWN) PHYSICAL APPEARANCE

These five detached duplexes, facing north, are located on the south side of Baltimore Street between Foundry and Commerce Streets. Each is a four bay wide, two bay deep, two story high, gabled roof (running east-west) brick (laid in common bond) structure with wide brick chimneys inset into the north and south sides of the dividing walls. They rest on full foundations of stone.

Rectangular entrances occupy the end bays of each duplex and are fronted by later brick stoops. Fenestration is vertically aligned and proportionally scaled. Windows are rectangular, double-hung and hold six-over-six lights.

CONTINUE ON SEPARATE SHEET IF NECESSARY

PERIOD	AREAS OF SIGNIFICANCE -- CHECK AND JUSTIFY BELOW			
<input type="checkbox"/> PREHISTORIC	<input type="checkbox"/> ARCHEOLOGY-PREHISTORIC	<input checked="" type="checkbox"/> COMMUNITY PLANNING	<input type="checkbox"/> LANDSCAPE ARCHITECTURE	<input type="checkbox"/> RELIGION
<input type="checkbox"/> 1400-1499	<input checked="" type="checkbox"/> ARCHEOLOGY-HISTORIC	<input type="checkbox"/> CONSERVATION	<input type="checkbox"/> LAW	<input type="checkbox"/> SCIENCE
<input type="checkbox"/> 1500-1599	<input type="checkbox"/> AGRICULTURE	<input type="checkbox"/> ECONOMICS	<input type="checkbox"/> LITERATURE	<input type="checkbox"/> SCULPTURE
<input type="checkbox"/> 1600-1699	<input checked="" type="checkbox"/> ARCHITECTURE	<input type="checkbox"/> EDUCATION	<input type="checkbox"/> MILITARY	<input type="checkbox"/> SOCIAL/HUMANITARIAN
<input type="checkbox"/> 1700-1799	<input type="checkbox"/> ART	<input type="checkbox"/> ENGINEERING	<input type="checkbox"/> MUSIC	<input type="checkbox"/> THEATER
<input checked="" type="checkbox"/> 1800-1899	<input type="checkbox"/> COMMERCE	<input type="checkbox"/> EXPLORATION/SETTLEMENT	<input type="checkbox"/> PHILOSOPHY	<input type="checkbox"/> TRANSPORTATION
<input type="checkbox"/> 1900-	<input type="checkbox"/> COMMUNICATIONS	<input checked="" type="checkbox"/> INDUSTRY	<input type="checkbox"/> POLITICS/GOVERNMENT	<input type="checkbox"/> OTHER (SPECIFY)
		<input type="checkbox"/> INVENTION		

SPECIFIC DATES

BUILDER/ARCHITECT

STATEMENT OF SIGNIFICANCE

These five detached duplexes marching up the south side of Baltimore Street are significant historically, architecturally, industrially and in the area of community and town planning.

Historically the houses are significant as part of the architectural fabric of the old mill town which sprang up around Savage Mill. They were constructed by 1878 and appear on the Hopkins' Atlas. See Attachment 4.

The history of the mill dates to the early 1800's. George Williams for some years had been developing a cotton mill at the falls of the Little Patuxent River. He with his brothers Amos and Cumberland and a good friend from Philadelphia, John Savage, chartered the enterprise as the Savage Manufacturing Company, incorporated by Act by the Maryland General Assembly in December 1821.

In 1853 the heirs of John Savage of Philadelphia filed a complaint for payment of a \$20,000 debt. In September 1859 the factory and its surrounding lands were sold at public auction for \$42,000 to William H. Baldwin, Jr. of Baltimore, a member of Woodward, Baldwin Company, a dry goods marketing corporation for which the Savage factory was purchased.

Architecturally these brick worker's houses form the main body of the architectural fabric of the town. They are uniform in structural appearance and detail, presenting themselves very much as they did in 1878. All contain two dwelling units, are two stories high and four bays wide. They are slightly smaller but similar in plan and detail to their neighbors on the north side of Baltimore Street. See Ho-223 and Ho-224.

These houses are significant industrially and in the area of town planning as an example of how early American industrialists planned company towns to serve as an adjunct to the factory, providing housing and the company store for their employees in the form of a grid pattern.

9 MAJOR BIBLIOGRAPHICAL REFERENCES

Howard County Land Records
Filbey, Vera. Savage, Maryland. Savage, 1965.
National Register Nomination Form for Savage Historic District
Hopkins Atlas of 1878

CONTINUE ON SEPARATE SHEET IF NECESSARY

10 GEOGRAPHICAL DATA

ACREAGE OF NOMINATED PROPERTY _____

12 lots on the south side of Baltimore Street (9051-9069)
Please see Attachment 1, Tax Map 47 p. 684.

VERBAL BOUNDARY DESCRIPTION

Please see Houward County Land Records Liber 630, folio 745.

LIST ALL STATES AND COUNTIES FOR PROPERTIES OVERLAPPING STATE OR COUNTY BOUNDARIES

STATE Maryland COUNTY Howard

STATE COUNTY

11 FORM PREPARED BY

NAME / TITLE

Cleora Barnes Thompson, Archivist

ORGANIZATION

Office of Planning & Zoning-Comprehensive Planning Section

DATE

STREET & NUMBER

3450 Court House Drive

TELEPHONE

CITY OR TOWN

Ellicott City

STATE

Maryland

The Maryland Historic Sites Inventory was officially created by an Act of the Maryland Legislature, to be found in the Annotated Code of Maryland, Article 41, Section 181 KA, 1974 Supplement.

The Survey and Inventory are being prepared for information and record purposes only and do not constitute any infringement of individual property rights.

RETURN TO: Maryland Historical Trust
The Shaw House, 21 State Circle
Annapolis, Maryland 21401
(301) 267-1438

NATIONAL REGISTER OF HISTORIC PLACES
INVENTORY - NOMINATION FORM

(Type all entries - complete applicable sections)

STATE:	
COUNTY:	
FOR NPS USE ONLY	
ENTRY NUMBER	DATE

1. NAME

COMMON: Storch's Mill workers' houses

AND/OR HISTORIC:

2. LOCATION

STREET AND NUMBER: 9053-9069 Baltimore Street

CITY OR TOWN: Savage

STATE: MD CODE: COUNTY: HOWARD CODE:

3. CLASSIFICATION

CATEGORY (Check One)	OWNERSHIP	STATUS	ACCESSIBLE TO THE PUBLIC
District <input type="checkbox"/> Building <input checked="" type="checkbox"/>	Public <input type="checkbox"/>	Occupied <input checked="" type="checkbox"/>	Yes: <input checked="" type="checkbox"/>
Site <input type="checkbox"/> Structure <input checked="" type="checkbox"/>	Private <input checked="" type="checkbox"/>	Unoccupied <input type="checkbox"/>	Restricted <input type="checkbox"/>
Object <input type="checkbox"/>	Both <input type="checkbox"/>	Preservation work in progress <input type="checkbox"/>	Unrestricted <input type="checkbox"/>
			No: <input type="checkbox"/>

PRESENT USE (Check One or More as Appropriate)

Agricultural <input type="checkbox"/>	Government <input type="checkbox"/>	Park <input type="checkbox"/>	Transportation <input type="checkbox"/>	Comments <input type="checkbox"/>
Commercial <input type="checkbox"/>	Industrial <input type="checkbox"/>	Private Residence <input type="checkbox"/>	Other (Specify) <input type="checkbox"/>	
Educational <input type="checkbox"/>	Military <input type="checkbox"/>	Religious <input type="checkbox"/>	<u>Rental houses</u>	
Entertainment <input type="checkbox"/>	Museum <input type="checkbox"/>	Scientific <input type="checkbox"/>		

4. OWNER OF PROPERTY

OWNERS NAME: Storch Realty

STREET AND NUMBER: Baltimore Street

CITY OR TOWN: Savage STATE: MD CODE:

5. LOCATION OF LEGAL DESCRIPTION

COURTHOUSE, REGISTRY OF DEEDS, ETC.: clerk of the Circuit Court

STREET AND NUMBER: Howard County Courthouse Court St

CITY OR TOWN: Ellicott City STATE: MD CODE:

ACREAGE APPROXIMATE ACREAGE OF NOMINATED PROPERTY:

6. REPRESENTATION IN EXISTING SURVEYS

TITLE OF SURVEY:

DATE OF SURVEY: Federal State County Local

DEPOSITORY FOR SURVEY RECORDS:

STREET AND NUMBER:

CITY OR TOWN: STATE: CODE:

STATE: MD

COUNTY: HOWARD

FOR NPS USE ONLY

ENTRY NUMBER: DATE:

7. DESCRIPTION

CONDITION

(Check One)

Excellent Good Fair Deteriorated Ruins Unexposed

INTEGRITY

(Check One)

Altered Unaltered

(Check One)

Moved Original Site

DESCRIBE THE PRESENT AND ORIGINAL (if known) PHYSICAL APPEARANCE

Double houses, five in a row on spacious lots. Apparently identical, they are also similar front to back. Almost square, 4 bays by 2, 2 stories high, they face north, the roof ridges running east-west. Chimneys rise from the center wall of the house coming through each slope of the roof on either side of the peak (see sketch) from fireplaces on each side of the family-dividing walls. Fireplaces were on both floors, 4 to each house.

Windows have
6 light over 6,
unshuttered.



SIGNIFICANCE

PERIOD (Check One or More as Appropriate)

Pre-Columbian <input type="checkbox"/>	16th Century <input type="checkbox"/>	<u>18th Century</u> <input type="checkbox"/>	20th Century <input type="checkbox"/>
15th Century <input type="checkbox"/>	17th Century <input type="checkbox"/>	19th Century <input type="checkbox"/>	

SPECIFIC DATE(S) (If Applicable and Known)

AREAS OF SIGNIFICANCE (Check One or More as Appropriate)

Aboriginal <input type="checkbox"/>	Education <input type="checkbox"/>	Political <input type="checkbox"/>	Urban Planning <input type="checkbox"/>
Prehistoric <input type="checkbox"/>	Engineering <input type="checkbox"/>	Religion/Philosophy <input type="checkbox"/>	Other (Specify) <input type="checkbox"/>
Historic <input type="checkbox"/>	<u>Industry</u> <input type="checkbox"/>	Science <input type="checkbox"/>	_____
Agriculture <input type="checkbox"/>	Invention <input type="checkbox"/>	Sculpture <input type="checkbox"/>	_____
Art <input type="checkbox"/>	Landscape <input type="checkbox"/>	Social/Humanitarian <input type="checkbox"/>	_____
Commerce <input type="checkbox"/>	Architecture <input type="checkbox"/>	Theater <input type="checkbox"/>	_____
Communications <input type="checkbox"/>	Literature <input type="checkbox"/>	Transportation <input type="checkbox"/>	_____
Conservation <input type="checkbox"/>	Military <input type="checkbox"/>		
Architecture <input type="checkbox"/>	Music <input type="checkbox"/>		

STATEMENT OF SIGNIFICANCE (Include Personages, Dates, Events, Etc.)

These five buildings appear to be older than most of the village, and probably date to the Warfield-Simpson era, 1750-1850. As mill workers houses they were rented for a few dollars a month.

As village landscape their proportions, location along the hillside, and their setup of wide yards and fine trees make their a memorable streetscape.

9. MAJOR BIBLIOGRAPHICAL REFERENCES

Aswad County Times 30 November 1972

10. GEOGRAPHICAL DATA

LATITUDE AND LONGITUDE COORDINATES DEFINING A RECTANGLE LOCATING THE PROPERTY			O R	LATITUDE AND LONGITUDE COORDINATES DEFINING THE CENTER POINT OF A PROPERTY OF LESS THAN ONE ACRE		
CORNER	LATITUDE	LONGITUDE		LATITUDE	LONGITUDE	
	Degrees Minutes Seconds	Degrees Minutes Seconds		Degrees Minutes Seconds	Degrees Minutes Seconds	
NW	° ' "	° ' "		° ' "	° ' "	
NE	° ' "	° ' "		° ' "	° ' "	
SE	° ' "	° ' "		° ' "	° ' "	
SW	° ' "	° ' "		° ' "	° ' "	

LIST ALL STATES AND COUNTIES FOR PROPERTIES OVERLAPPING STATE OR COUNTY BOUNDARIES

STATE:	CODE	COUNTY	CODE

11. FORM PREPARED BY

NAME AND TITLE: JEFF S. EWING

ORGANIZATION: NATIONAL HISTORIC PRESERVATION DATE: _____

STREET AND NUMBER: _____

CITY OR TOWN: _____ STATE: _____ CODE: _____

12. STATE LIAISON OFFICER CERTIFICATION

As the designated State Liaison Officer for the National Historic Preservation Act of 1966 (Public Law 89-665), I hereby nominate this property for inclusion in the National Register and certify that it has been evaluated according to the criteria and procedures set forth by the National Park Service. The recommended level of significance of this nomination is:

National State Local

Name _____

Title _____

Date _____

NATIONAL REGISTER VERIFICATION

I hereby certify that this property is included in the National Register.

Chief, Office of Archeology and Historic Preservation

Date _____

ATTEST:

Keeper of The National Register

Date _____

SAVAGE PARK

HO-42
District Boundary

COMMERCIAL

FOUNDRY

STREET

BALTIMO

★
220

221

223

224

FAIR

222

★ ★ ★ ★ ★
225

214

BALDWIN
COMMON

522 ★

ST.

219

218

216

215

STREET

SAVAGE

WILLIAMS

STREET

★ WASHINGTON

★
217

★
213

RACE

ROAD

BLVD.

SAVAGE

Scale, 1"=200'

Historic Monument
BOLLMAN TRUSS BRIDGE
HO 81

RAILROAD

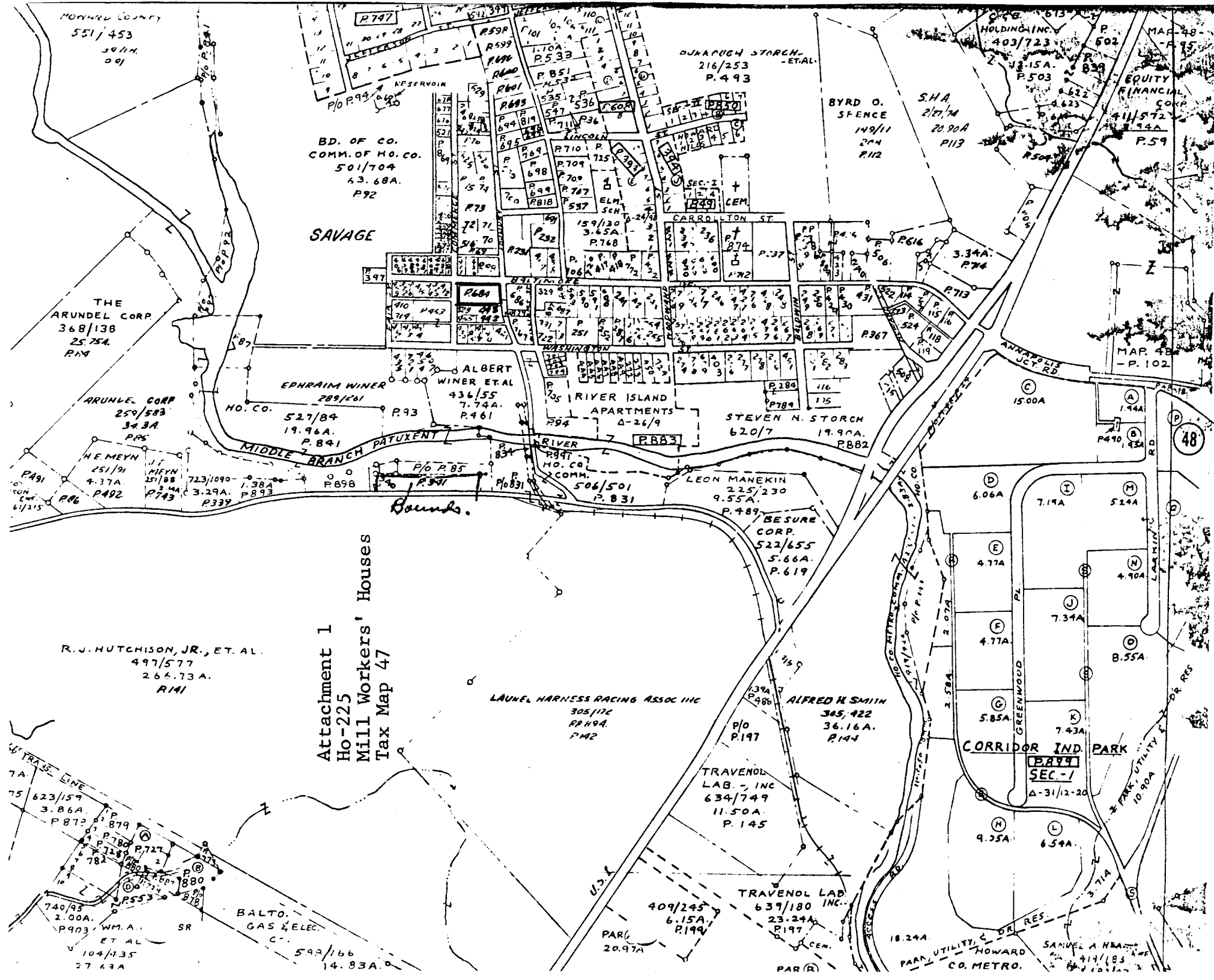

BD. OF CO.
COMM. OF HO. CO.
501/704
63.68A.
P.92

Savage

THE
ARUNDEL CORP.
368/138
25.75A.
P.89

ARUNDEL CORP
259/583
34.3A.
P.85

H.E. MEYN
251/91
4.37A
P.86

R.J. HUTCHISON, JR., ET. AL.
497/577
266.73A.
P.141

Attachment I
Ho-225
Mill Workers' Houses
Tax Map 47

LAUREL HARNESS RACING ASSOC INC
305/176
P.142

TRAVENOL
LAB., INC
634/749
11.50A.
P.145

TRAVENOL LAB
639/180 INC.
23.24A.
P.197

409/245
6.15A.
P.144

LEON MANEKIN
225/230
9.55A.
P.489

BESURE
CORP.
522/655
5.66A.
P.619

ALFRED H SMITH
345/422
36.16A.
P.144

STEVEN N. STORCH
620/7
19.90A.
P.882

MIDDLE BRANCH PATUXENT

RIVER

RIVER ISLAND
APARTMENTS
A-26/9

CARROLLTON ST

BYRD O.
SFENCE
149/11
244
P.112

S.H.A.
217/14
20.90A
P.113

HOLDING INC.
403/723

EQUITY
FINANCIAL
CORP
411/572
P.59

MAR 48
P.95

MAR 48
P.102

48

CORRIDOR IND PARK

SEC-1
A-31/12-20

BALTO.
GAS & ELEC.
C.

CO. METRO.

SAMUEL A. HARRIS

SAVAGE QUADRANGLE
USGS 7.5 minute map
scale: 1: 24,000
1957

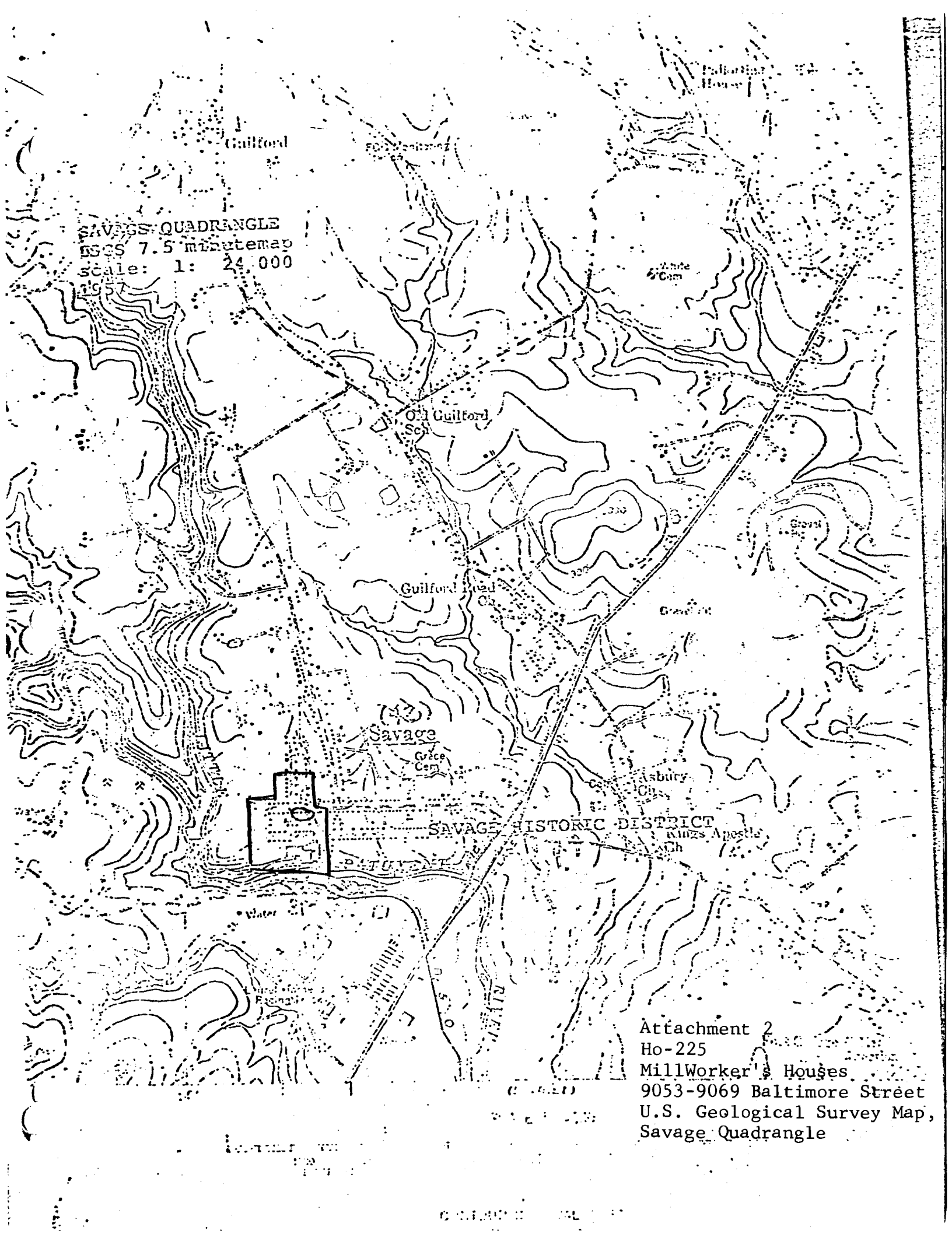

Attachment 2
Ho-225
MillWorker's Houses
9053-9069 Baltimore Street
U.S. Geological Survey Map,
Savage Quadrangle

BY:

- I C. 1820 to 1878
- 1 1879 to 1940
-] 1941 to

== Historic District Boundaries

SAVAGE HISTORIC DISTRICT

SAVAGE, MARYLAND

Attachment 3

Ho-225

Millworker's Houses

9053-9069 Baltimore Street

Savage Historic District Map

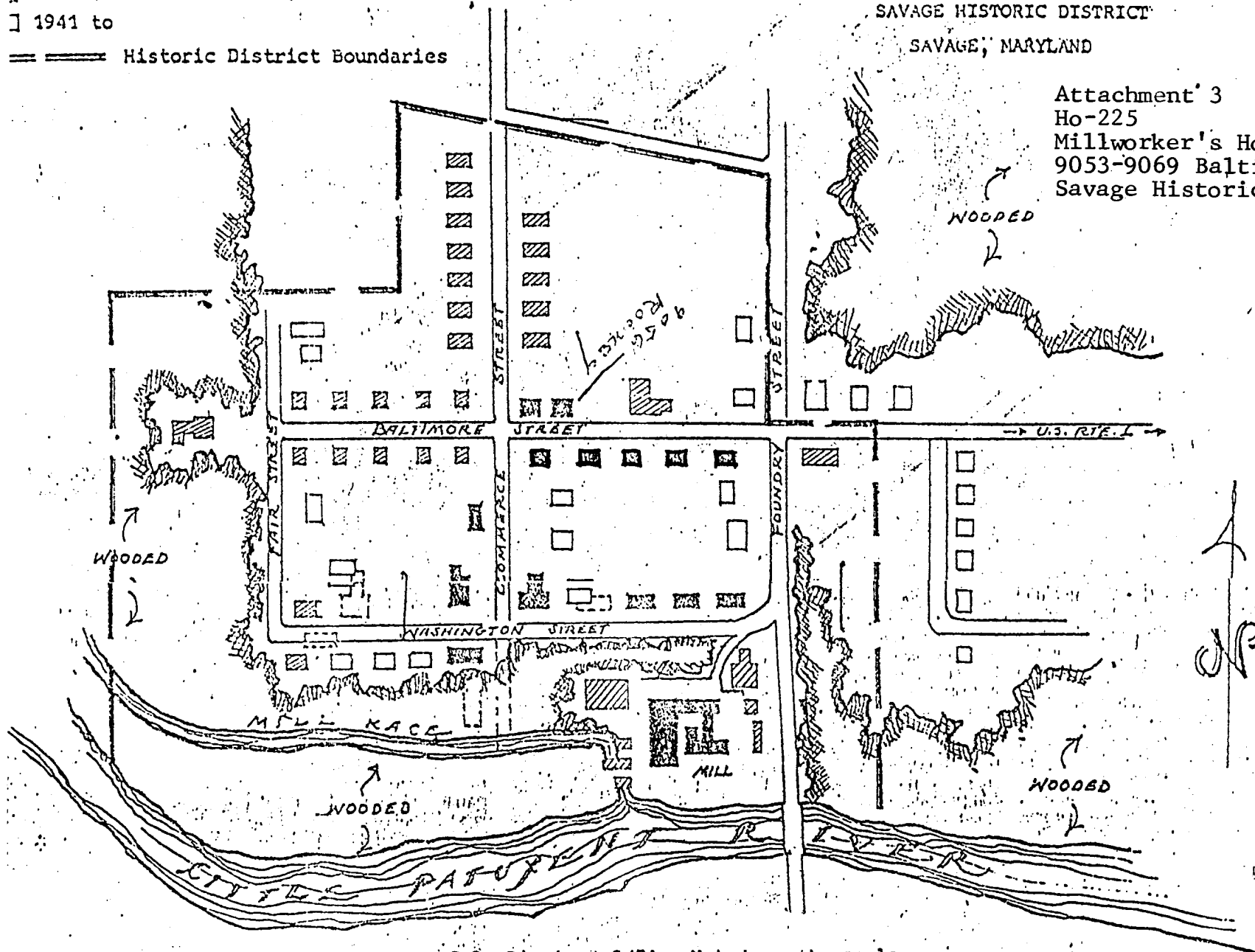

J.R. Rivoire, 5/74. Not drawn to scale.

Savage Mill District Gets National Designation

... Maryland Historical Places. The district includes ... The National Register ... money for maintenance and building as the natural center ...

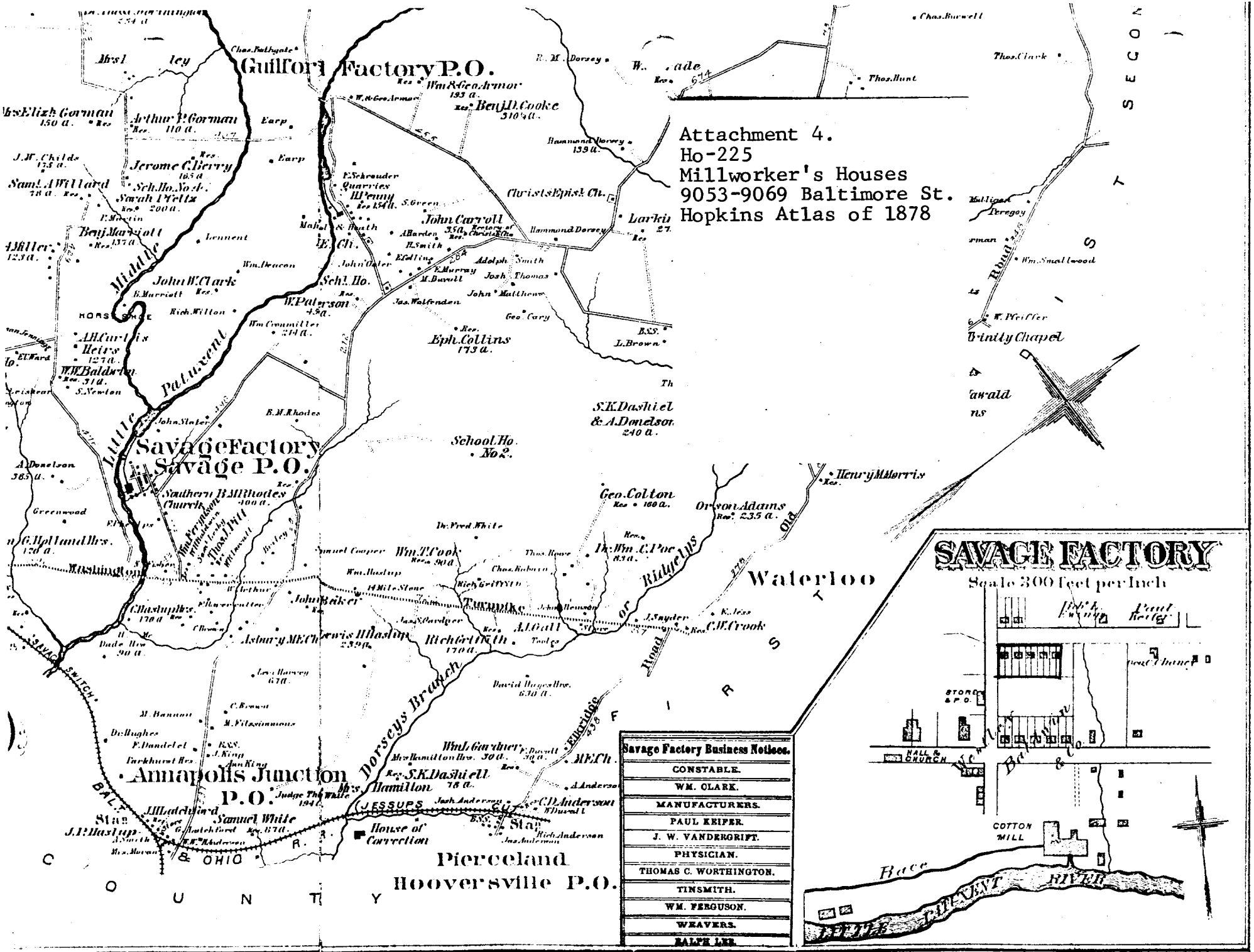



H0225

Mill Houses, Sawape Md

11/77
HSS



HO 225

Mill houses

Savage

He 11/72



Savage from northwest

Sheet scope - Mill houses,

H0225

21 Nov 35P



#0 225

from south west

Mill Houses

Savage

MD

85 11/77



HO-225
MILL WORKERS' HOUSES
90 53-69 BALTIMORE ST
SAVAGE
NORTHWEST

CHEORA THOMPSON, AIP
NOV. 1977