

HO-109

Addendum:

This small log house is now in ruins. The roof is gone, and only two of the walls are standing (west and north). The west elevation (towards Daisy Road) had a central door flanked by two window openings, and smaller square windows above that, just below the eave line.

Field visit, J.K. Cosham, 3/19/98

H0-109

Ann B. Dunn's Log House

Woodbine

Private

nineteenth century

Ann B. Dunn's Log House faces south on the north side of Daisy Road, just west of its intersection with Jennings Chapel Road. It is a two bay wide, one room deep, two story high, gabled roof (running east-west) log house of a comfortable scale, with patches in its tin roof where once stood a brick chimney on the west wall.

The hand hewn logs are overlaid at the corners and chinked with a composition of thin stone slabs and mortar.

Used two decades ago as a black tavern it is presently abandoned, settling on its north elevation and no longer features window sashes or doors.

INVENTORY FORM FOR STATE HISTORIC SITES SURVEY

1 NAME

HISTORIC
Ann B. Dunn's Log House
AND/OR COMMON

2 LOCATION

STREET & NUMBER
North east corner of Daisy Road and Jennings Chapel Road
CITY, TOWN
Woodbine, _____ VICINITY OF _____ CONGRESSIONAL DISTRICT
6th
STATE
Maryland _____ COUNTY
Howard

3 CLASSIFICATION

CATEGORY	OWNERSHIP	STATUS	PRESENT USE
<input checked="" type="checkbox"/> DISTRICT	<input type="checkbox"/> PUBLIC	<input type="checkbox"/> OCCUPIED	<input type="checkbox"/> AGRICULTURE
<input type="checkbox"/> BUILDING(S)	<input checked="" type="checkbox"/> PRIVATE	<input checked="" type="checkbox"/> UNOCCUPIED	<input type="checkbox"/> MUSEUM
<input type="checkbox"/> STRUCTURE	<input type="checkbox"/> BOTH	<input type="checkbox"/> WORK IN PROGRESS	<input type="checkbox"/> COMMERCIAL
<input type="checkbox"/> SITE	<input type="checkbox"/> PUBLIC ACQUISITION	<input type="checkbox"/> ACCESSIBLE	<input type="checkbox"/> EDUCATIONAL
<input type="checkbox"/> OBJECT	<input type="checkbox"/> IN PROCESS	<input checked="" type="checkbox"/> YES: RESTRICTED	<input type="checkbox"/> ENTERTAINMENT
	<input type="checkbox"/> BEING CONSIDERED	<input type="checkbox"/> YES: UNRESTRICTED	<input type="checkbox"/> GOVERNMENT
		<input type="checkbox"/> NO	<input type="checkbox"/> INDUSTRIAL
			<input type="checkbox"/> MILITARY
			<input checked="" type="checkbox"/> OTHER vacant

4 OWNER OF PROPERTY

NAME
Mrs. Ann B. Dunn
Waterford Farms
Telephone #:
STREET & NUMBER
Jennings Chapel Road
CITY, TOWN
Woodbine, MD _____ VICINITY OF _____ STATE, zip code
21797

5 LOCATION OF LEGAL DESCRIPTION

COURTHOUSE, REGISTRY OF DEEDS, ETC.
Tax Map 20 p.20 PAR III
Hall of Records
Liber #: 364
Folio #: 499
STREET & NUMBER
Howard County Court House
CITY, TOWN
Ellicott City _____ STATE
Maryland

6 REPRESENTATION IN EXISTING SURVEYS

TITLE
Howard County Historic Sites Inventory
DATE
1978-1979
____FEDERAL STATE ____COUNTY ____LOCAL
DEPOSITORY FOR SURVEY RECORDS
Maryland Historical Trust
CITY, TOWN
21 State Circle, Annapolis _____ STATE
Maryland

7 DESCRIPTIONHO-109
District 4

CONDITION		CHECK ONE	CHECK ONE
<input type="checkbox"/> EXCELLENT	<input type="checkbox"/> DETERIORATED	<input type="checkbox"/> UNALTERED	<input checked="" type="checkbox"/> ORIGINAL SITE
<input type="checkbox"/> GOOD	<input type="checkbox"/> RUINS	<input type="checkbox"/> ALTERED	<input type="checkbox"/> MOVED DATE _____
<input type="checkbox"/> FAIR	<input type="checkbox"/> UNEXPOSED		

X Delap.

DESCRIBE THE PRESENT AND ORIGINAL (IF KNOWN) PHYSICAL APPEARANCE

The Ann Dunn Log Cabin faces south on the north side of Daisy Road, just west of its intersection with Jennings Chapel Road. It is a two bay wide, one room deep, two story high, gabled roof (running east-west) log house with patches in its roof where once probably stood a brick chimney on the west wall.

The south elevation holds two rectangular apertures with two square second floor windows above, all of which have no sashes. A central door is located on its north wall with a window to its west, and two square second floor windows above. An additional entrance is located on its east wall with a square second floor window centered above. The west wall holds no apertures. The building is composed of hand hewn logs, separated and filled with thin stone slabs and mortar chinking. The roof appears to be of a later period than the log house with six inch boards (running east-west) covered with tin sheets of varying sizes.

The log house was at one time covered with clapboards which have been removed except in the A's formed by the gables. The house has settled considerably on its north elevation and is in a state of disrepair with no window sashes. It appears, however, quite intact and sound otherwise and should be considered for rehabilitation and future reuse with required modernization.

CONTINUE ON SEPARATE SHEET IF NECESSARY

8 SIGNIFICANCE

PERIOD	AREAS OF SIGNIFICANCE -- CHECK AND JUSTIFY BELOW				
<input type="checkbox"/> PREHISTORIC	<input type="checkbox"/> ARCHEOLOGY-PREHISTORIC	<input type="checkbox"/> COMMUNITY PLANNING	<input type="checkbox"/> LANDSCAPE ARCHITECTURE	<input type="checkbox"/> RELIGION	
<input type="checkbox"/> 1400-1499	<input type="checkbox"/> ARCHEOLOGY-HISTORIC	<input type="checkbox"/> CONSERVATION	<input type="checkbox"/> LAW	<input type="checkbox"/> SCIENCE	
<input type="checkbox"/> 1500-1599	<input type="checkbox"/> AGRICULTURE	<input type="checkbox"/> ECONOMICS	<input type="checkbox"/> LITERATURE	<input type="checkbox"/> SCULPTURE	
<input type="checkbox"/> 1600-1699	<input checked="" type="checkbox"/> ARCHITECTURE	<input type="checkbox"/> EDUCATION	<input type="checkbox"/> MILITARY	<input type="checkbox"/> SOCIAL/HUMANITARIAN	
<input type="checkbox"/> 1700-1799	<input type="checkbox"/> ART	<input type="checkbox"/> ENGINEERING	<input type="checkbox"/> MUSIC	<input type="checkbox"/> THEATER	
<input checked="" type="checkbox"/> 1800-1899	<input type="checkbox"/> COMMERCE	<input type="checkbox"/> EXPLORATION/SETTLEMENT	<input type="checkbox"/> PHILOSOPHY	<input type="checkbox"/> TRANSPORTATION	
<input type="checkbox"/> 1900-	<input type="checkbox"/> COMMUNICATIONS	<input type="checkbox"/> INDUSTRY	<input type="checkbox"/> POLITICS/GOVERNMENT	<input type="checkbox"/> OTHER (SPECIFY)	black history
		<input type="checkbox"/> INVENTION			

SPECIFIC DATES

BUILDER/ARCHITECT

STATEMENT OF SIGNIFICANCE

The Ann B. Dunn Log House is significant architecturally to Howard County and the State of Maryland as a representative log house of the nineteenth century of a comfortable scale. Though settling on its north elevation and presently abandoned and in a deteriorating state, it is not beyond repair and renovation.

Thaddeus Crapster's Log House on Route 94 serves as a fine example of such renovation and use as a single family dwelling unit. The second floor of this log house is higher than that of the Thaddeus Crapster's loft and could very well provide comfortable living space of a similar nature.

Local historians point out that many of the log houses scattered throughout this district were moved from Cherry Grove, H0-1, when the slaves were freed and given their quarters after the Civil War.

Whether this log house was such or not, it stands as representative of a log house of the nineteenth century, a class of building which many Howard Countians have successfully preserved.

The Log House was used some two decades ago as a black tavern with adjacent wing. This wing which was rather unsightly, was torn down by Mrs. Dunn on the acquisition of the property. The integrity of the log house has thus been reestablished and needs only to be renovated.

CONTINUE ON SEPARATE SHEET IF NECESSARY

9 MAJOR BIBLIOGRAPHICAL REFERENCES

Interview with Mrs. Willis Cissel, September 18, 1978

CONTINUE ON SEPARATE SHEET IF NECESSARY

10 GEOGRAPHICAL DATA

ACREAGE OF NOMINATED PROPERTY 352.81

Please see Attachment 1, Tax Map 20

VERBAL BOUNDARY DESCRIPTION

Please see Howard County Land Records, Liber 364 Folio 499

LIST ALL STATES AND COUNTIES FOR PROPERTIES OVERLAPPING STATE OR COUNTY BOUNDARIES

STATE Maryland COUNTY Howard

STATE _____ COUNTY _____

11 FORM PREPARED BY

NAME / TITLE

Cleora Barnes Thompson, Archivist

ORGANIZATION

Office of Planning & Zoning-Comprehensive Planning Section

DATE

465-5000 x257

STREET & NUMBER

3450 Court House Drive

TELEPHONE

CITY OR TOWN

Ellicott City

STATE

Maryland

The Maryland Historic Sites Inventory was officially created by an Act of the Maryland Legislature, to be found in the Annotated Code of Maryland, Article 41, Section 181 KA, 1974 Supplement.

The Survey and Inventory are being prepared for information and record purposes only and do not constitute any infringement of individual property rights.

RETURN TO: Maryland Historical Trust
The Shaw House, 21 State Circle
Annapolis, Maryland 21401
(301) 267-1438

common "Waterford Farm?" (ruin?)

Anne Dunn log bldg.

Daisy Rd, north of Jennings Chapel Rd., Brookville

2-story log - 2-bays plus center door
previously used as a tavern by Negroes
(about 5 yrs ago)

Now abandoned + vandalized

located in field by MMB
7/24/20

falling in - 2.7.72

for map #20

Anne B. Dunn

364/499 Por III

352.81 A.

p 20

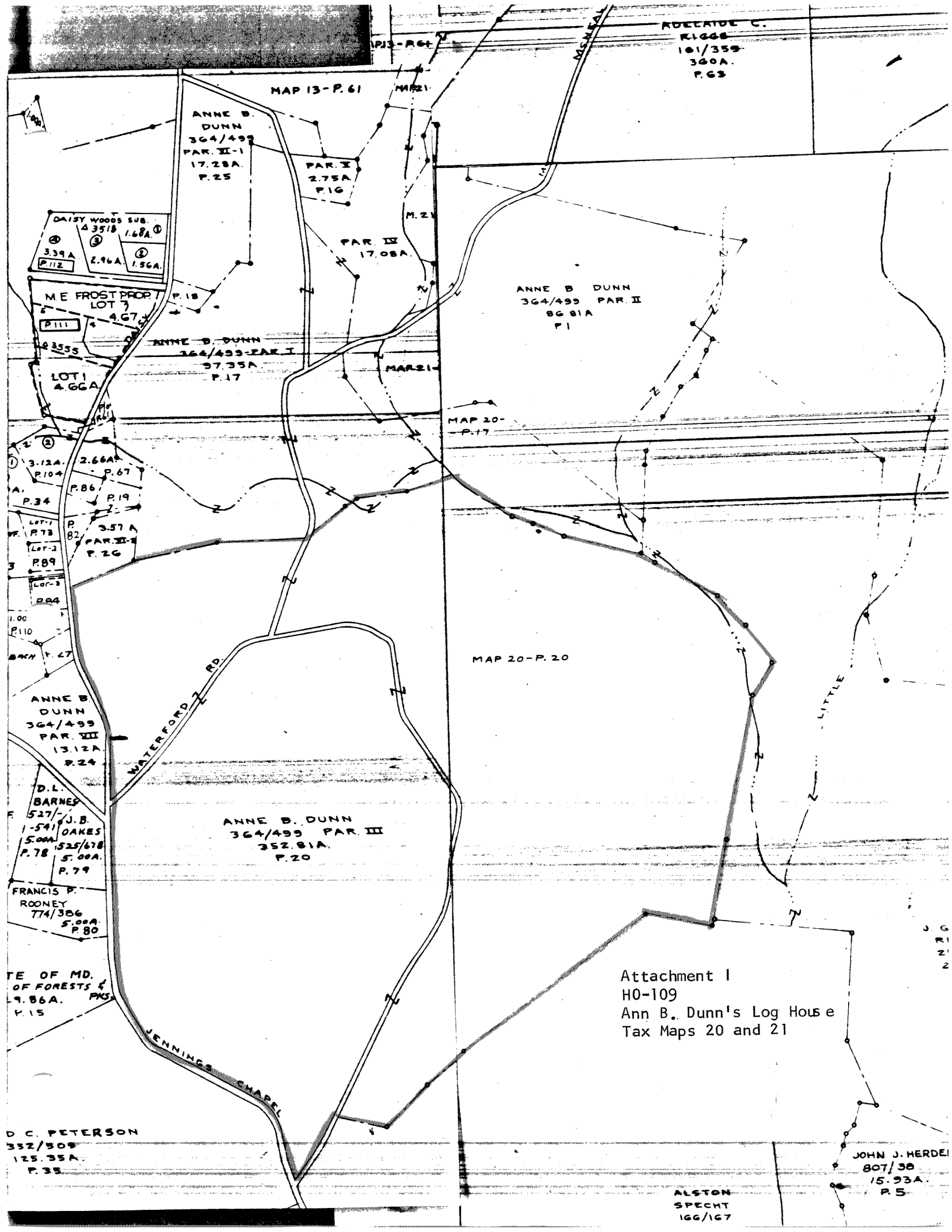

ROBERT C. RIGGS
101/359
300A.
P.63

MAP 13-P.61

ANNE B. DUNN
364/499
PAR. II-1
17.28A.
P.25

PAR. I
2.75A
P.16

PAR. II
17.08A

ANNE B. DUNN
364/499 PAR. II
86.81A
P.1

ANNE B. DUNN
364/499-PAR. I
97.35A
P.17

MAP 20-P.17

MAP 20-P.20

DAISY WOODS SUB.
43518 1.68A
339A 2.96A 1.56A
P.112

M.E. FROST PROP.
LOT 7
4.67A
P.111

LOT 1
4.66A

3.12A 2.66A
P.104 P.67

LOT 1 P.78
LOT 2 P.89
LOT 3 P.84

1.00
P.110

ANNE B. DUNN
364/499
PAR. III
13.12A
P.24

D.L. BARNES
527/J.B.
591 OAKES
5.00A 5.25/678
P.78 5.00A
P.79

FRANCIS P. ROONEY
774/386
5.00A
P.80

ANNE B. DUNN
364/499 PAR. III
352.81A.
P.20

STATE OF MD.
OF FORESTS &
9.86A. PMS
P.15

D.C. PETERSON
352/509
125.35A
P.35

Attachment I
H0-109
Ann B. Dunn's Log House
Tax Maps 20 and 21

JOHN J. HERDE
807/38
15.93A
P.5

ALSTON
SPECHT
166/167

Attachment 2
 H0-109
 Ann B. Dunn's Log House
 U.S. Geological Survey Map
 Woodbine, Maryland Quadrangle
 Scale 1: 24000

FLOOD PRONE AREA

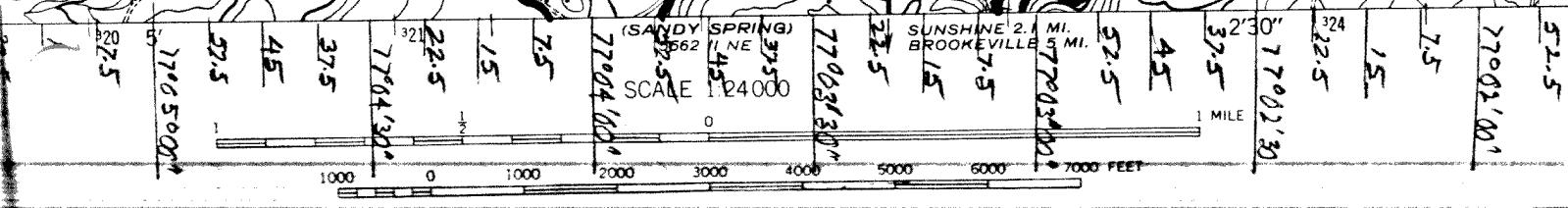
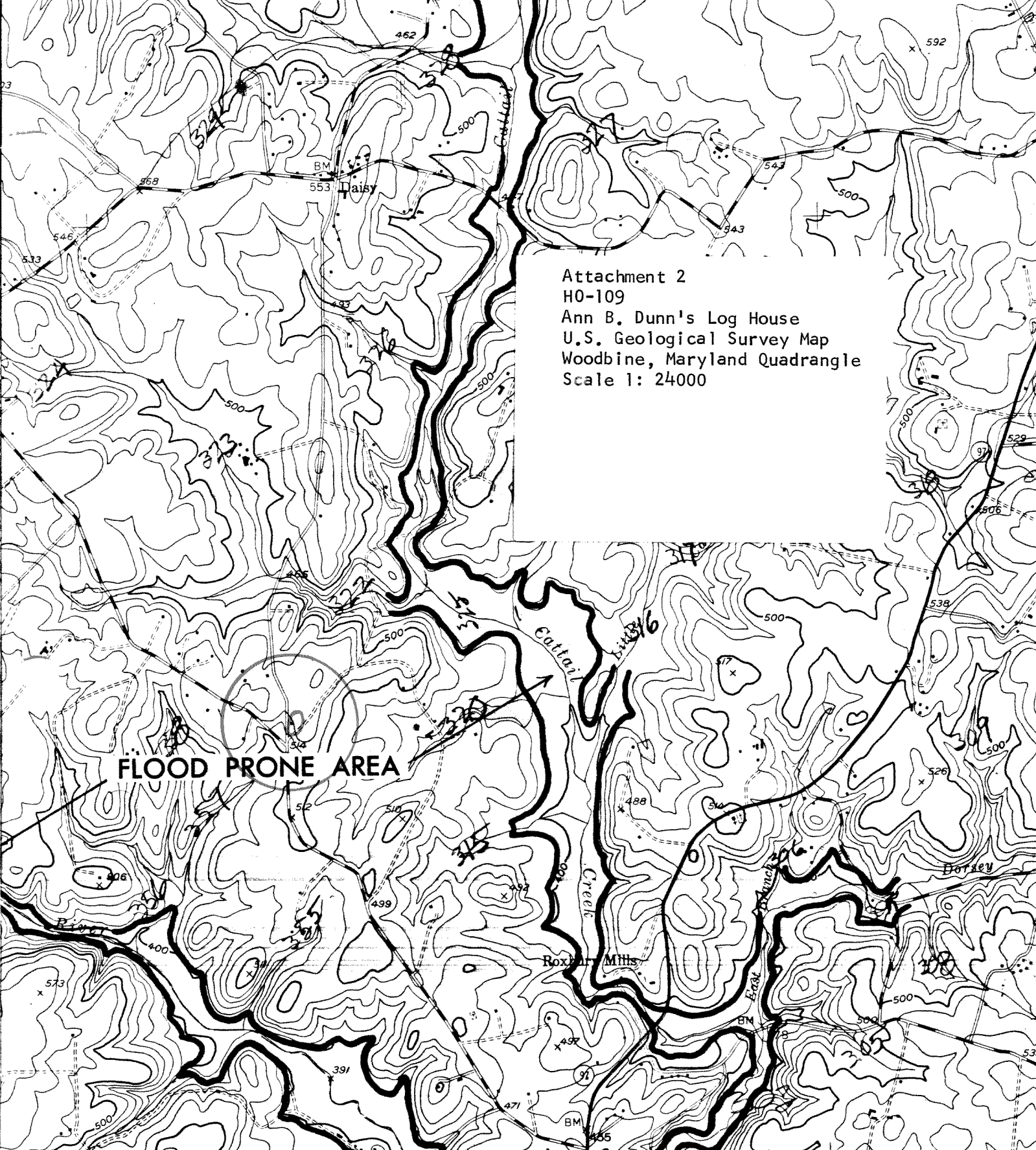

CONTOUR INTERVAL 20 FEET
 DATUM IS MEAN SEA LEVEL

MARYLAND

HO-109
Ann B. Dunn's Log House, ruin
Daisy Road north of Jennings Chapel Road, east side
Woodbine
Jennifer K. Cosham
April 21, 2004
Digital color photo on file at MHT



HO-109

Ann B. Dunn's Log House, ruin

Daisy Road north of Jennings Chapel Road, east side

Woodbine

Jennifer K. Cosham

April 21, 2004

Digital color photo on file at MHT



HO-109
Ann B. Dunn's Log House, ruin
Daisy Road north of Jennings Chapel Road, east side
Woodbine
Ruin on left, intersection on right, looking south
Jennifer K. Cosham
April 21, 2004
Digital color photo on file at MHT





HO-109
ANN B. DUNN'S LOG HOUSE
SOUTH WEST

CLEORA THOMPSON AIP
AUGUST 1978