

HO-24

FONT HILL

Eighteenth & nineteenth century

Ellicott City

Private

Font Hill is an outstanding example of Howard County's stone architecture which spans the 18th and 19th centuries. It consists of three wings, the earliest being a four bay wide, two bay deep two story stone dwelling with east and west rectangular entrances and wide stone chimneys inset into its north and south walls.

In the early 1800s the orientation of the building was turned north with the addition of a five bay wide two bay deep, two and a half story Manor House facing north to the Old Frederick Road, which featured wide stone chimneys inset into its east and west walls, three gabled roof dormer windows and a central gabled roof portico covering its rectangular entrance surmounted by a fan lite.

A four bay wide, two bay deep two story west wing was added in the early 1900's whose gabled roof ran east-west springing from the west wall of the early 1800 wing. A wide stone central chimney is inset into its west wall and a rectangular entrance facing east, approached by an open porch.

Located on lands called Kendall's Delight and constructed by the Hammond Family whose member Edward became first Judge of the Circuit Court for Howard County, it was later acquired by the Clark family. Frequently the home of lawyers, the present owner Mr. Timothy Welsh carries on this tradition.

MARYLAND HISTORICAL TRUST WORKSHEET

NOMINATION FORM  
for the  
NATIONAL REGISTER OF HISTORIC PLACES, NATIONAL PARKS SERVICE

<b>1. NAME</b>						
COMMON: Font Hill						
AND/OR HISTORIC: Font Hill						
<b>2. LOCATION</b>						
STREET AND NUMBER: Font Hill Manor						
CITY OR TOWN: Ellicott City						
STATE Maryland			COUNTY: Howard			
<b>3. CLASSIFICATION</b>						
CATEGORY (Check One)		OWNERSHIP		STATUS	ACCESSIBLE TO THE PUBLIC	
<input checked="" type="checkbox"/> District <input type="checkbox"/> Building <input type="checkbox"/> Site <input type="checkbox"/> Structure <input type="checkbox"/> Object		<input type="checkbox"/> Public <input checked="" type="checkbox"/> Private <input type="checkbox"/> Both		Public Acquisition: <input type="checkbox"/> In Process <input type="checkbox"/> Being Considered	<input checked="" type="checkbox"/> Occupied <input type="checkbox"/> Unoccupied <input type="checkbox"/> Preservation work in progress	Yes: <input checked="" type="checkbox"/> Restricted <input type="checkbox"/> Unrestricted <input type="checkbox"/> No
PRESENT USE (Check One or More as Appropriate)						
<input type="checkbox"/> Agricultural	<input type="checkbox"/> Government	<input type="checkbox"/> Park	<input type="checkbox"/> Transportation	<input type="checkbox"/> Comments		
<input type="checkbox"/> Commercial	<input type="checkbox"/> Industrial	<input checked="" type="checkbox"/> Private Residence	<input type="checkbox"/> Other (Specify)	_____		
<input type="checkbox"/> Educational	<input type="checkbox"/> Military	<input type="checkbox"/> Religious	_____	_____		
<input type="checkbox"/> Entertainment	<input type="checkbox"/> Museum	<input type="checkbox"/> Scientific	_____	_____		
<b>4. OWNER OF PROPERTY</b>						
OWNER'S NAME: Mr. & Mrs. Timothy Welsh						
STREET AND NUMBER: Font Hill Manor						
CITY OR TOWN: Ellicott City			STATE: Maryland		21043	
<b>5. LOCATION OF LEGAL DESCRIPTION</b>						
COURTHOUSE, REGISTRY OF DEEDS, ETC.: Hall of Records						
STREET AND NUMBER: Howard County Court House						
CITY OR TOWN: Ellicott City			STATE: Maryland		21043	
Title Reference of Current Deed (Book & Pg. #): Tax Map 24/						
<b>5. REPRESENTATION IN EXISTING SURVEYS</b> 595/473, p.725    22.34 Acres						
TITLE OF SURVEY: Howard County Historic Sites Inventory						
DATE OF SURVEY: 1976 <input type="checkbox"/> Federal <input checked="" type="checkbox"/> State <input type="checkbox"/> County <input type="checkbox"/> Local						
DEPOSITORY FOR SURVEY RECORDS: Maryland Historic Trust						
STREET AND NUMBER: 21 State Circle						
CITY OR TOWN: Annapolis			STATE: Maryland		21401	

INSTRUCTIONS

7. DESCRIPTION

CONDITION	(Check One)					
	<input checked="" type="checkbox"/> Excellent	<input type="checkbox"/> Good	<input type="checkbox"/> Fair	<input type="checkbox"/> Deteriorated	<input type="checkbox"/> Ruins	<input type="checkbox"/> Unexposed
	(Check One)			(Check One)		
	<input type="checkbox"/> Altered	<input checked="" type="checkbox"/> Unaltered		<input type="checkbox"/> Moved	<input checked="" type="checkbox"/> Original Site	

DESCRIBE THE PRESENT AND ORIGINAL (if known) PHYSICAL APPEARANCE

The original structure of the house dating from the 1700's is a four bay wide two bay deep two story stone dwelling with stone chimneys on the north and south walls. The <sup>west</sup> entrance door is on the second south bay, is rectangular in shape surmounted by a four lite transom and protected by a slate shed roof front porch supported by two square columns. The south elevation has two second floor windows set into its wall. A flat roofed porch runs along the entire east facade supported by square columns which in turn support a second floor screened in porch with ballustrade.

The main structure which looks north toward Frederick Road from a broad and gently sloping hill is well proportioned and soundly constructed of fine granite with gable slate roofs. The two and one half <sup>story</sup> west wing dating from the 1900's is four bays wide and two bays deep whose gable roof sets into the gable roof of the east wing. A fine stone chimney is inset into the west wall. Two 1st and second story double hung windows with six-over-six lites proportionally scaled are set into the west wall surmounted by two third story casement windows with four lites.

Four similar second floor windows are set into the north wall while the first floor contains three such windows.

The south elevation contains four second floor windows and three first floor windows, each with six-over-six lites. The entrance is located in the west bay. A slate shed roof porch runs along the two west bays supported by three square columns.

Three gabled dormer windows are set into the gabled roof on the south elevation. They hold rectangular double hung windows with six-over-six lites surmounted by a pediment.

The imposing east wing, the main body of the house dating from the early 1800's is five bays wide, two and a half stories high and two bays deep with a fine stone chimney inset into the west wall.

Three stone steps lead to the central entrance portico decorated with a segmental arch enclosed by a slate gabled roof and supported by columns.

The landing leads to a double paneled rectangular door with fan lite transom flanked by two windows to the east and west which are decorated with splayed brick flat arched lintels. This decoration characterizes the windows of the east wing. A later addition was constructed of granite which connected the east wing to the original south wing of the building. Its gabled roof intersects with that of the east wing and a pediment with centered bull's eye decorates the south elevation of this connecting addition which contain the bathrooms for the house.

A one story gabled slate roof stone house lies south west of the original structure. Its west elevation contains two

SEE INSTRUCTIONS

casement windows with three-three-lites, wooden sills and fine stretcher stone flat arched lintels. Its south wall contains an inset stone chimney. There is an east central rectangular entrance decorated with a stretcher stone flat arched lintel.

There is an additional door north; each of these rectangular doors have a one lite inset.

Another one story stone building is located southwest of the house. It has a hipped roof and large amounts of window openings on its east elevation. A two story red wooden gambrel roofed barn of eight bays, three bays deep is surmounted by a cupola with conical roof southwest of the house.

The oldest structure on the property is located east of the house and is a two story gabled roof dwelling with central east entrance. Brick chimneys are inset into the north and south walls.

Originally there were no windows on the north elevation and only one on the south. A one story, one bay deep shed roof addition on the west wall has altered this as the north and south walls of this addition contain double hung rectangular windows with six-over-six lites. A shed roof entrance porch covers the door which contains four lites.

8. SIGNIFICANCE

PERIOD (Check One or More as Appropriate)

<input type="checkbox"/> Pre-Columbian	<input type="checkbox"/> 16th Century	<input checked="" type="checkbox"/> 18th Century	<input checked="" type="checkbox"/> 20th Century
<input type="checkbox"/> 15th Century	<input type="checkbox"/> 17th Century	<input checked="" type="checkbox"/> 19th Century	

SPECIFIC DATE(S) (If Applicable and Known)

AREAS OF SIGNIFICANCE (Check One or More as Appropriate)

<input type="checkbox"/> Aboriginal	<input type="checkbox"/> Education	<input type="checkbox"/> Political	<input type="checkbox"/> Urban Planning
<input type="checkbox"/> Prehistoric	<input type="checkbox"/> Engineering	<input type="checkbox"/> Religion/Philosophy	<input type="checkbox"/> Other (Specify)
<input checked="" type="checkbox"/> Historic	<input type="checkbox"/> Industry	<input type="checkbox"/> Science	_____
<input type="checkbox"/> Agriculture	<input type="checkbox"/> Invention	<input type="checkbox"/> Sculpture	_____
<input checked="" type="checkbox"/> Architecture	<input type="checkbox"/> Landscape Architecture	<input type="checkbox"/> Social/Humanitarian	_____
<input type="checkbox"/> Art	<input type="checkbox"/> Literature	<input type="checkbox"/> Theater	_____
<input type="checkbox"/> Commerce	<input type="checkbox"/> Military	<input type="checkbox"/> Transportation	_____
<input type="checkbox"/> Communications	<input type="checkbox"/> Music		_____
<input type="checkbox"/> Conservation			_____

STATEMENT OF SIGNIFICANCE

Font Hill was first built in the 1700's by Admiral Hammond related to Colonel Rezin Hammond of Burleigh and Matthias Hammond builder of the Hammond-Harwood house at Annapolis. When originally built, Font Hill was a very simple rectangular building, constructed of local granite on lands originally called Kendalls Delight.

This structure's chief architectural significance is that it was built first as a very simple building, but in the 19th and 20th centuries received several distinctive additions which deliberately and successfully create the fine, well proportioned, well integrated building we experience today.

In the early 1800's the orientation of the building was turned with the addition of a five bay wide, two bay deep Manor House facing north to the Old Frederick Road from a gently sloping hill. The splayed brick flat arched lintels which decorate this portion of the house are a notable architectural feature as are the fine well proportioned stone chimneys.

In the early 1900's an additional west wing was added to the Manor House which also faced Old Frederick Road and produced a unified architectural complex, its gable roof fitting into the west wall of the Manor House. Today it is used as a separate four bedroom residence.

Font Hill's significance is enhanced by its setting; the Manor House stands on the knoll of gently sloping land surrounded by lawn and approached by an easement from the Old Frederick Road which is flanked by mature trees. The manor is far enough from the present Font Hill Subdivision to seem isolated from it, but near enough to it to create a focal point and offer an historic element to the modern twentieth century development.

Historically the building has ties with the Hammond family and has been a home for lawyers. Judge Edward Hammond, the first Judge of the Circuit Court for Howard County resided here.

Later Font Hill passed into the hands of Louis Dorsey Clark, an Ellicott City lawyer. The present owner Timothy Welsh is also a practicing lawyer, thus carrying on a Font Hill tradition.

SEE INSTRUCTIONS

## Significance

The house has also been a home for large and happy families. Louis Dorsey Clark raised eleven children here and Mr. & Mrs. Somerset O. Jones raised eight.

From 1926-1950 Font Hill was known as Abbottston . The property now the site of City College, Baltimore was known as Abbottston and was owned by Isaac Cate who had an iron foundry in Baltimore. Family tradition relates that Isaac's father rolled the iron for the Monitor (the northern ship) during the Civil War. His granddaughter , Caroline Lycett Jones and her husband Somerset O. Jones bought Font Hill. Through an architect Worth Jamieson they restored the house to its present appearance minus many porches, and redid the interior.

The area surrounding Font Hill will probably experience further residential development but the 22 acres immediately surrounding the property, and owned by it, is sufficient to preserve the immediate setting, which speaks of 18th and 19th century tranquility, a stable element in our fast paced 20th century.

The entrance easement which runs from Frederick Road to the manor and is flanked by lovely old trees should be maintained as an integral part of the manor and its preservation insured.

9. MAJOR BIBLIOGRAPHICAL REFERENCES

Interview with Carol J. Carlson, daughter of Caroline Lycett Jones, previous owner of Font Hill. Doughoregan Manor, June 6, 1976.

Interview with Timothy Welsh, present owner of Font Hill. Font Hill Manor, July 16, 1976.

10. GEOGRAPHICAL DATA

LATITUDE AND LONGITUDE COORDINATES DEFINING A RECTANGLE LOCATING THE PROPERTY			O R	LATITUDE AND LONGITUDE COORDINATES DEFINING THE CENTER POINT OF A PROPERTY OF LESS THAN TEN ACRES		
CORNER	LATITUDE	LONGITUDE		LATITUDE	LONGITUDE	
	Degrees Minutes Seconds	Degrees Minutes Seconds		Degrees Minutes Seconds	Degrees Minutes Seconds	
NW	° ' "	° ' "		° ' "	° ' "	
NE	° ' "	° ' "		° ' "	° ' "	
SE	° ' "	° ' "		° ' "	° ' "	
SW	° ' "	° ' "		° ' "	° ' "	

APPROXIMATE ACREAGE OF NOMINATED PROPERTY:

Acreage Justification:  
22.3 Acres  
Please see Tax Map #24  
p. 725  
595/473

SEE INSTRUCTIONS

11. FORM PREPARED BY

NAME AND TITLE:  
Cleora B. Thompson, Archivist

ORGANIZATION: Howard County Comprehensive Planning Section

DATE: 1976

STREET AND NUMBER:  
3450 Court House Drive

CITY OR TOWN: Ellicott City

STATE: Maryland

21043

12. State Liaison Officer Review: (Office Use Only)

Significance of this property is:  
National  State  Local

Signature

NO-24

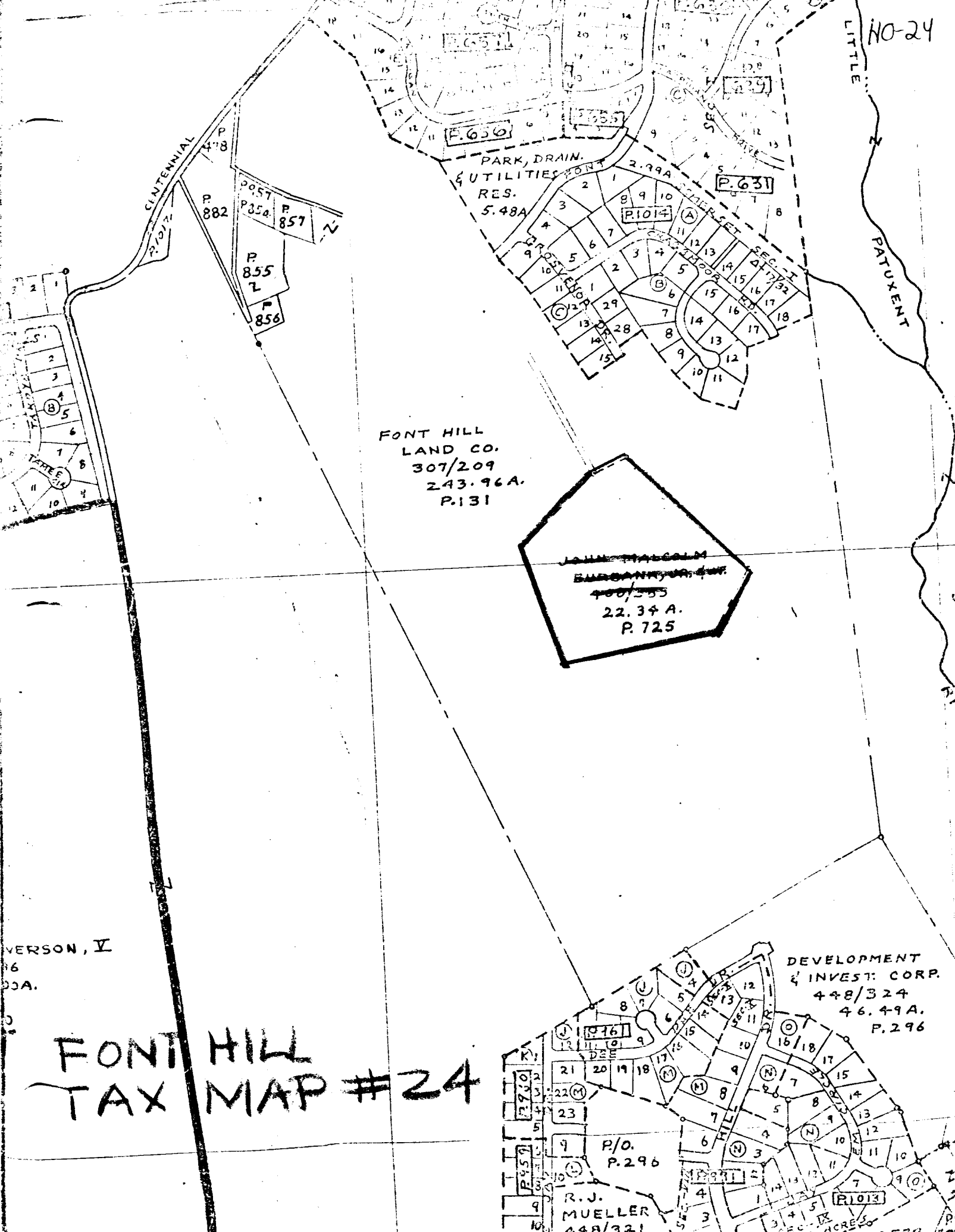

FONT HILL  
 LAND CO.  
 307/209  
 243.96A.  
 P.131

JOHN W. ALGAM  
 BARBARA W. ALGAM  
 400/385  
 22.34 A.  
 P. 725

DEVELOPMENT  
 & INVEST. CORP.  
 448/324  
 46.49A.  
 P.296

R.O.  
 P.296  
 R.J.  
 MUELLER  
 448/321

VERSON, V  
 16  
 00A.

FONT HILL  
 TAX MAP #24

LITTLE PATUXENT

CANTONIAL  
 RIDGE

PARK, DRAIN.  
 UTILITIES FRONT  
 RES.  
 5.48A

2.99A  
 P.631

P.1014

P.857  
 P.854  
 P.857  
 P.855  
 P.856

P.882

1  
 2  
 3  
 4  
 5  
 6  
 7  
 8  
 9  
 10  
 11  
 12

1  
 2  
 3  
 4  
 5  
 6  
 7  
 8  
 9  
 10  
 11  
 12  
 13  
 14  
 15  
 16  
 17  
 18  
 19  
 20  
 21  
 22  
 23  
 24  
 25  
 26  
 27  
 28  
 29  
 30  
 31  
 32  
 33  
 34  
 35  
 36  
 37  
 38  
 39  
 40  
 41  
 42  
 43  
 44  
 45  
 46  
 47  
 48  
 49  
 50  
 51  
 52  
 53  
 54  
 55  
 56  
 57  
 58  
 59  
 60  
 61  
 62  
 63  
 64  
 65  
 66  
 67  
 68  
 69  
 70  
 71  
 72  
 73  
 74  
 75  
 76  
 77  
 78  
 79  
 80  
 81  
 82  
 83  
 84  
 85  
 86  
 87  
 88  
 89  
 90  
 91  
 92  
 93  
 94  
 95  
 96  
 97  
 98  
 99  
 100





HO-24 DIST 2  
FONT HILL

CLEORA BARNES THOMPSON  
PLANNING CONSULTANT  
HISTORICAL SITES SURVEY



HO-24 DIST 2  
FONT HILL (FR. HSE)

CLEORA BARNES THOMPSON  
PLANNING CONSULTANT  
HISTORICAL SITES SURVEY



HO-24 DIST 2  
FONT HILL  
OLD FRAME HSE

CLEORA BARNES THOMPSON  
PLANNING CONSULTANT  
HISTORICAL SITES SURVEY