

THE REQUIREMENTS OF 3-108, THE REAL PROPERTY ARTICLE, ANNOTATED CODE OF MARYLAND, 1988 REPLACEMENT VOLUME, (AS SUPPLEMENTED) AS FAR AS THEY RELATE TO THE MAKING OF THIS PLAT AND THE SETTING OF MARKERS HAVE BEEN COMPLIED WITH.

Mark C. Martin 3/13/07
 MARK C. MARTIN DATE
 PROFESSIONAL LAND SURVEYOR NO. 10884
Robert J. Brosmer 3/13/07
 YOUNG MEN'S CHRISTIAN ASSOCIATION OF BALTIMORE DATE
 BY: ROBERT J. BROSMER, CHIEF OPERATING OFFICER

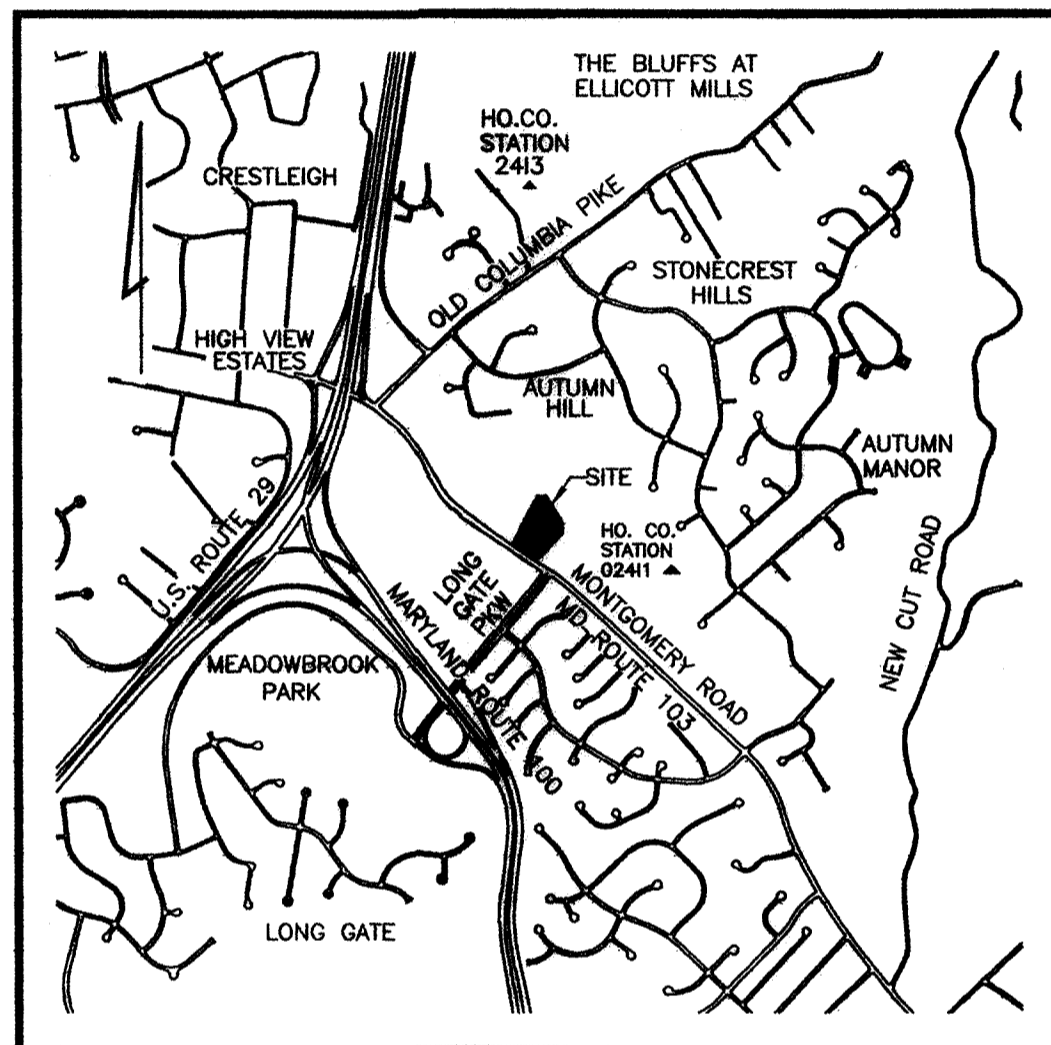

VICINITY MAP
 SCALE 1" = 2000'
 ADC MAP 12D12

GENERAL NOTES

- 1.) SUBJECT PROPERTY IS ZONED R-SA-8-1 AND R-SC-1 PER 02-02-04 COMPREHENSIVE ZONING PLAN AND THE COMP LITE ZONING REGULATIONS EFFECTIVE ON 7/28/06.
- 2.) COORDINATES BASED ON NAD 83 MARYLAND COORDINATE SYSTEM AS PROJECTED BY HOWARD COUNTY CONTROL STATIONS NO. 2411 AND 2413.
 2411 N 577298.654 E 1366075.133
 2413 N 580648.910 E 1364974.458
- 3.) THIS PLAT IS BASED ON A FIELD RUN BOUNDARY SURVEY PERFORMED ON OR ABOUT NOVEMBER, 2006 BY ROBERT H. VOGEL ENGINEERING, INC.
- 4.) ● DENOTES IRON PIPE FOUND
 ○ DENOTES ANGULAR CHANGE IN BEARING OF BOUNDARY OR RIGHT OF WAY.
- 5.) THIS FOREST CONSERVATION EASEMENT HAS BEEN ESTABLISHED TO FULFILL THE REQUIREMENTS OF SECTION 16.1200 OF THE HOWARD COUNTY CODE AND THE FOREST CONSERVATION ACT. NO CLEARING, GRADING OR CONSTRUCTION IS PERMITTED WITHIN THE FOREST CONSERVATION EASEMENT; HOWEVER, FOREST MANAGEMENT PRACTICES AS DEFINED IN THE DEED OF FOREST CONSERVATION EASEMENT ARE ALLOWED.
- 6.) WETLAND DELINEATION REPORT WAS PREPARED BY ECO-SCIENCE PROFESSIONALS, INC. DATED FEBRUARY 21, 2005.
- 7.) A FOREST CONSERVATION REPORT IS PROVIDED BY ECO-SCIENCE PROFESSIONALS, INC. DATED FEBRUARY 21, 2005.

ROBERT H. VOGEL ENGINEERING, INC.
 8407 MAIN STREET
 ELLICOTT CITY, MARYLAND 21043
 410-461-7666

OWNER/DEVELOPER
 YOUNG MEN'S CHRISTIAN ASSOCIATION OF BALTIMORE
 4331 MONTGOMERY ROAD
 ELLICOTT CITY, MARYLAND
 21043

THE PURPOSE OF THIS PLAT IS TO CREATE A FOREST CONSERVATION EASEMENT TO IDENTIFY 0.25275 ACRES OF RETENTION TO SATISFY THE FOREST CONSERVATION OBLIGATION FOR THE YOUNG MEN'S CHRISTIAN ASSOCIATION DEVELOPMENT (SDP-06-71)

OWNER'S CERTIFICATE

YOUNG MEN'S CHRISTIAN ASSOCIATION OF BALTIMORE, BY ROBERT J. BROSMER, CHIEF OPERATING OFFICER OF THE PROPERTY SHOWN AND DESCRIBED HEREON, HEREBY ADOPTS THIS PLAN IN CONSIDERATION OF THE APPROVAL OF THIS PLAT OF FOREST CONSERVATION EASEMENT BY THE DEPARTMENT OF PLANNING AND ZONING, TO ESTABLISH THE REQUIRED FOREST CONSERVATION EASEMENTS.

Robert J. Brosmer
 YOUNG MEN'S CHRISTIAN ASSOCIATION OF BALTIMORE
 BY: ROBERT J. BROSMER, CHIEF OPERATING OFFICER

Megan Brett
 WITNESS

SURVEYOR'S CERTIFICATE

I HEREBY CERTIFY THAT THE FINAL EASEMENT SHOWN HEREON IS CORRECT; THAT IT DEFINES A FOREST CONSERVATION EASEMENT ON A PART OF A PARCEL WHICH BY DEED DATED MAY 21, 1963 RECORDED IN LIBER 400 FOLIO 260 AMONG THE LAND RECORDS OF HOWARD COUNTY, MARYLAND WAS CONVEYED BY WILLIAM E. TAYLOR AND MARY E. TAYLOR TO THE YOUNG MEN'S CHRISTIAN ASSOCIATION OF BALTIMORE.

I HEREBY CERTIFY THAT ALL MONUMENTS ARE IN OR WILL BE IN PLACE PRIOR TO THE ACCEPTANCE OF THE STREETS IN THE SUBDIVISION BY HOWARD COUNTY AS SHOWN, IN ACCORDANCE WITH THE ANNOTATED CODE OF MARYLAND, AS AMENDED AND THAT THE BOUNDARY IS IN ACCORDANCE WITH THE HOWARD COUNTY SUBDIVISION REGULATIONS.

Mark C. Martin
 MARK C. MARTIN
 PROFESSIONAL LAND SURVEYOR NO. 10884

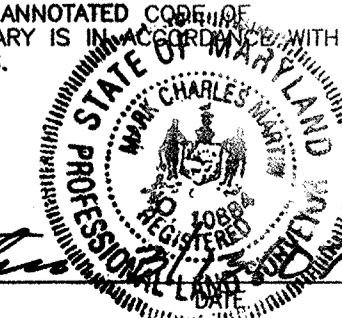

RECORDED AS PLAT No. 18936 ON 3-23-07
 AMONG THE LAND RECORDS OF HOWARD COUNTY, MARYLAND.

SHEET 1 OF 2

PLAT OF FOREST CONSERVATION EASEMENT
 PROPERTY OF
**YOUNG MEN'S CHRISTIAN ASSOCIATION
 OF BALTIMORE**
 TAX MAP 24, GRID 24, PART OF PARCEL 767
 ZONED R-SA-8-1, R-SC-1
 HOWARD COUNTY FILE NO. SDP-06-71
 SECOND ELECTION DISTRICT, HOWARD COUNTY, MARYLAND

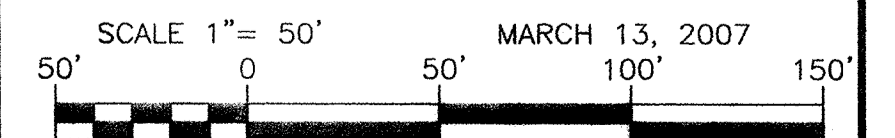

SDP-06-071 (FC)

APPROVED: HOWARD COUNTY DEPARTMENT OF PLANNING AND ZONING



Mark H. Vogel 3/13/07
 DIRECTOR DATE

CURVE DATA					
CURVE	ARC	RADIUS	TANGENT	DELTA	CHORD
C1	160.09'	220.00'	83.77'	41°41'40"	S09°38'03"E 156.59'

LINE TABLE		
L1	S59°27'17"W	35.55'
L2	N59°13'42"W	22.40'
L3	S86°16'16"W	10.51'
L4	N44°53'53"W	17.93'
L5	N80°06'44"W	14.78'
L6	N14°46'10"E	16.96'
L7	N26°19'16"W	15.66'
L8	N85°36'36"W	6.58'
L9	S37°08'43"W	15.68'
L10	N39°16'44"W	20.02'
L11	N51°15'03"W	26.78'
L12	N62°48'11"W	35.36'

COORDINATE LIST		
POINT	NORTH	EAST
215	577873.72730	1365106.13007
216	577638.07502	1365244.83214
218	577483.69701	1365271.03822
219	577463.29550	1365266.99368
234	577190.11526	1365004.25407
1801	577850.92889	1365020.47126
1848	577357.47125	1364754.92938
1852	577866.88414	1365012.40897
1853	577850.01707	1365007.98333

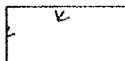
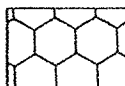
WETLAND LINE TABLE		
W1	S23°43'02"E	24.23'
W2	S31°33'02"E	19.61'
W3	S27°58'46"E	21.88'
W4	S68°05'54"E	18.49'
W5	S33°14'55"E	22.25'
W6	S10°17'47"W	15.50'
W7	N29°28'48"W	16.87'
W8	N24°31'09"W	17.22'
W9	N64°33'17"W	24.87'
W10	S37°37'45"W	16.50'
W11	N06°42'20"W	32.15'
W12	N19°23'06"W	19.86'
W13	N39°22'35"W	18.98'
W14	N02°04'40"E	5.03'
W15	N85°49'26"E	13.35'

- LEGEND**
-  WETLANDS
 -  FOREST CONSERVATION EASEMENT (RETENTION)
 -  EXISTING FOREST CONSERVATION EASEMENT

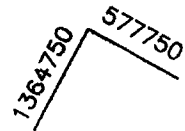

TRIANGLE OLD ANNAPOLIS ASSOCIATES KKC
L 8770 F 163
ZONES R-SA-8

FOREST CONSERVATION EASEMENT
(RETENTION)
11010 SQ. FT.
0.25275 ACRES

THE BOARD OF EDUCATION
OF HOWARD COUNTY
L 9030 F 437

THE BOARD OF EDUCATION
OF HOWARD COUNTY
L 9030 F 201

YOUNG MEN'S CHRISTIAN ASSOCIATION OF BALTIMORE

L 400 F 260
4.66212 ACRES

MONTGOMERY ROAD
MARYLAND ROUTE 103
MINOR ARTERIAL
P.W. VARIES
SHA R.W. PLAT NO. 11122

ROBERT H. VOGEL ENGINEERING, INC.
8407 MAIN STREET
ELLICOTT CITY, MARYLAND 21043
410-461-7666

OWNER/DEVELOPER
YOUNG MEN'S CHRISTIAN ASSOCIATION OF BALTIMORE
4331 MONTGOMERY ROAD
ELLICOTT CITY, MARYLAND
21043

THE BOARD OF EDUCATION
OF HOWARD COUNTY
L 10203 F 009
R-SA-8

THE REQUIREMENTS OF 3-108, THE REAL PROPERTY ARTICLE, ANNOTATED CODE OF MARYLAND, 1988 REPLACEMENT VOLUME, (AS SUPPLEMENTED) AS FAR AS THEY RELATE TO THE MAKING OF THIS PLAT AND THE SETTING OF MARKERS HAVE BEEN COMPLIED WITH.

Mark C. Martin 3/13/07
MARK C. MARTIN
PROFESSIONAL LAND SURVEYOR NO. 10884
DATE
Robert J. Brosmer 3/13/07
YOUNG MEN'S CHRISTIAN ASSOCIATION OF BALTIMORE
BY: ROBERT J. BROSMER, CHIEF OPERATING OFFICER
DATE

APPROVED: HOWARD COUNTY DEPARTMENT OF PLANNING AND ZONING

Robert H. Vogel 3/15/07
DIRECTOR DATE

OWNER'S CERTIFICATE

YOUNG MEN'S CHRISTIAN ASSOCIATION OF BALTIMORE, BY ROBERT J. BROSMER, CHIEF OPERATING OFFICER OF THE PROPERTY SHOWN AND DESCRIBED HEREON, HEREBY ADOPTS THIS PLAN IN CONSIDERATION OF THE APPROVAL OF THIS PLAT OF FOREST CONSERVATION EASEMENT BY THE DEPARTMENT OF PLANNING AND ZONING, TO ESTABLISH THE REQUIRED FOREST CONSERVATION EASEMENTS.

Robert J. Brosmer
YOUNG MEN'S CHRISTIAN ASSOCIATION OF BALTIMORE
BY: ROBERT J. BROSMER, CHIEF OPERATING OFFICER

Megan Brett
WITNESS

SURVEYOR'S CERTIFICATE

I HEREBY CERTIFY THAT THE FINAL EASEMENT SHOWN HEREON IS CORRECT; THAT IT DEFINES A FOREST CONSERVATION EASEMENT ON A PART OF A PARCEL WHICH BY DEED DATED MAY 21, 1963 RECORDED IN LIBER 400 FOLIO 260 AMONG THE LAND RECORDS OF HOWARD COUNTY, MARYLAND WAS CONVEYED BY WILLIAM E. TAYLOR AND MARY E. TAYLOR TO THE YOUNG MEN'S CHRISTIAN ASSOCIATION OF BALTIMORE.

I HEREBY CERTIFY THAT ALL MONUMENTS ARE IN OR WILL BE IN PLACE PRIOR TO THE ACCEPTANCE OF THE STREETS IN THE SUBDIVISION BY HOWARD COUNTY AS SHOWN, IN ACCORDANCE WITH THE ANNOTATED CODE OF MARYLAND, AS AMENDED AND THAT THE BOUNDARY IS IN ACCORDANCE WITH THE HOWARD COUNTY SUBDIVISION REGULATIONS.

Mark C. Martin
MARK C. MARTIN
PROFESSIONAL LAND SURVEYOR NO. 10884



RECORDED AS PLAT No. 18937 ON 3-23-07
AMONG THE LAND RECORDS OF HOWARD COUNTY, MARYLAND.

SHEET 2 OF 2

PLAT OF FOREST CONSERVATION EASEMENT
PROPERTY OF
**YOUNG MEN'S CHRISTIAN ASSOCIATION
OF BALTIMORE**

TAX MAP 24, GRID 24, PART OF PARCEL 767
ZONED R-SA-8-1, R-SC-1
HOWARD COUNTY FILE NO. SDP-06-71
SECOND ELECTION DISTRICT, HOWARD COUNTY, MARYLAND

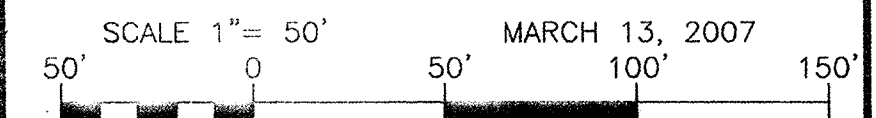

SDP-06-071 (FC)