

SHEET INDEX	
SHEET NO.	DESCRIPTION
1	TITLE SHEET
2	GRADING, EROSION AND SEDIMENT CONTROL PLAN
3	SEDIMENT CONTROL NOTES AND DETAILS
4	NOTES, DETAILS AND TYPICAL SECTIONS
5	ROADWAY PLAN AND PROFILE
6	STORM DRAIN PROFILES
7	DRAINAGE AREA MAP
8	CROSS SECTIONS
9	CROSS SECTIONS
10	CROSS SECTIONS

# ROAD CONSTRUCTION PLANS DORSEY RUN ROAD STA. 592+45.12 TO STA. 604+40.10

- LEGEND:**
- DC FIRE HYDRANT
  - WATER VALVE
  - WATER MANHOLE
  - STORM DRAIN MANHOLE
  - SEWER MANHOLE
  - C.O.
  - CATCH BASIN
  - LIGHT POLE
  - POWER POLE
  - GAS METER
  - GAS VALVE
  - PERIMETER FENCE
  - SIGN
  - EXISTING TREE LINE
  - PROPOSED TREE LINE
  - ONE OVERHEAD ELECTRIC
  - WETLANDS AREA
  - EXISTING CONTOUR 2' INTERVAL
  - EROSION CONSERVATION ASSESSMENT EXISTING CONTOUR 10' INTERVAL
  - PROPOSED CONTOUR 2' INTERVAL
  - PROPOSED CONTOUR 10' INTERVAL
  - SPOT ELEVATION + 524
  - SILT FENCE -SF-
  - SUPER SILT FENCE -SSF-
  - BERM
  - L.O.D. LIMIT OF DISTURBANCE

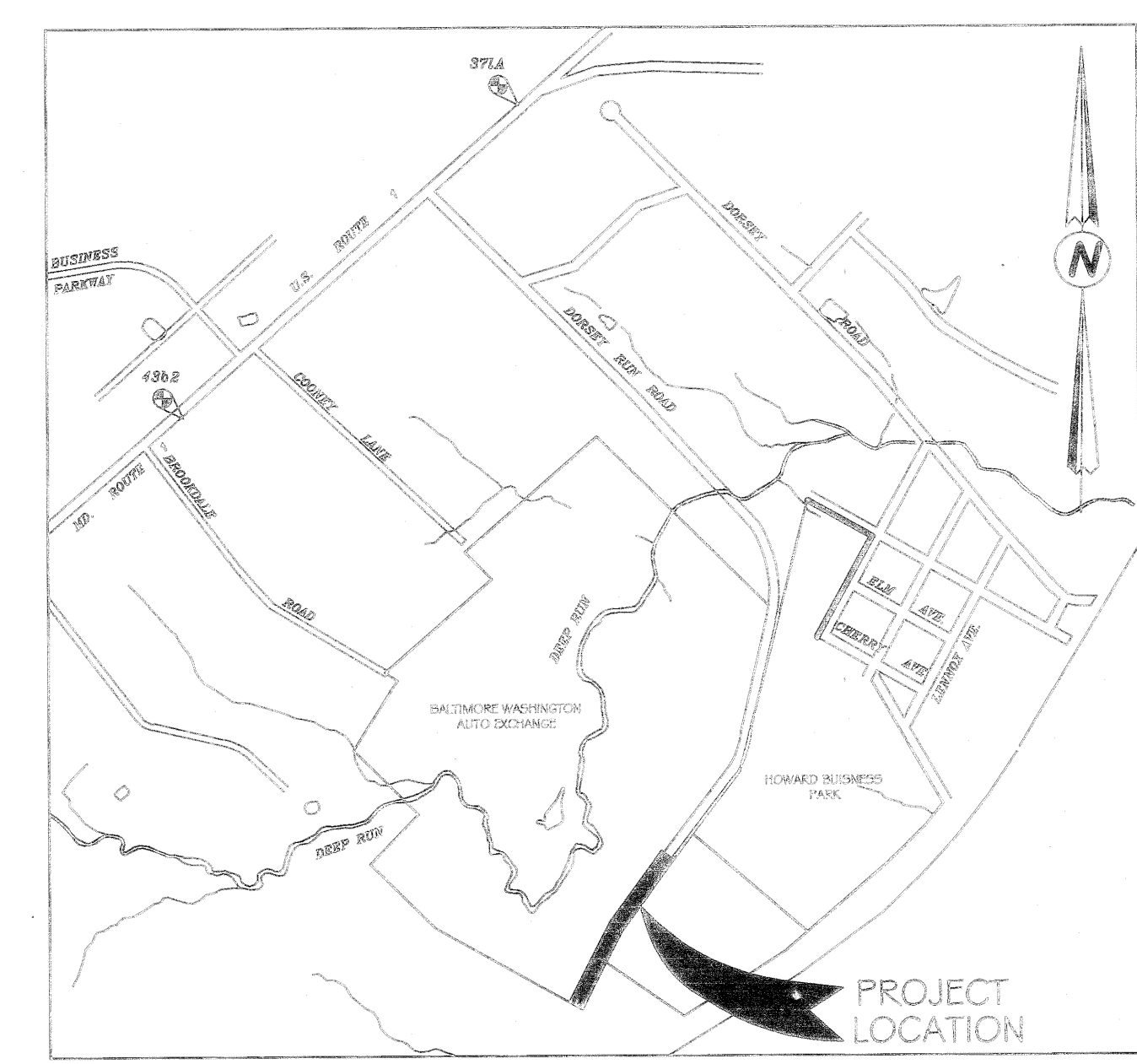

**VICINITY MAP**  
SCALE: 1" = 1000'

- GENERAL NOTES**
- THE CONTRACTOR SHALL NOTIFY THE CONSTRUCTION INSPECTION DIVISION AT (410) 313-1880 AT LEAST (5) FIVE WORKING DAYS PRIOR TO THE START OF WORK.
  - THE CONTRACTOR SHALL NOTIFY "MISS UTILITY" AT 1-800-257-7777 AT LEAST 48 HOURS PRIOR TO ANY EXCAVATION WORK.
  - ALL EXTERIOR LIGHTING SHALL COMPLY WITH SECTION 134 OF THE ZONING REGULATIONS.
  - BOUNDARY SURVEY PERFORMED BY: VIKI, INC. ON OR ABOUT MARCH 2002.
  - EXISTING TOPOGRAPHY SHOWN HEREON WAS PREPARED BY VIKI, INC. AND BASED UPON FIELD RUN TOPOGRAPHY SURVEY.
  - HORIZONTAL AND VERTICAL CONTROL DATUM IS BASED ON HOWARD COUNTY GEODETIC CONTROL STATIONS:  
HOWARD COUNTY MONUMENT No. 4382: N 551,654.953 E 1,378,176.951 Elev. 208.585'  
HOWARD COUNTY MONUMENT No. 4386: N 550,801.597 E 1,376,866.071 Elev. 210.543'  
HOWARD COUNTY MONUMENT No. 371A: N 553,315.147 E 1,379,982.153 Elev. 195.75'  
HOWARD COUNTY MONUMENT No. 43R1: N 548,305.502 E 1,382,025.818 Elev. 134.53'
  - ANY DAMAGE TO THE COUNTY'S RIGHT-OF-WAY SHALL BE CORRECTED AT THE CONTRACTOR'S EXPENSE.
  - THIS PLAN IS FOR ROAD CONSTRUCTION AND ASSOCIATED IMPROVEMENTS.
  - ALL CONSTRUCTION SHALL BE IN ACCORDANCE WITH THE LATEST STANDARDS AND SPECIFICATIONS OF HOWARD COUNTY PLUS MSHA STANDARDS AND SPECIFICATIONS IF APPLICABLE.
  - ALL PLAN DIMENSIONS ARE TO FACE OF CURB UNLESS OTHERWISE NOTED.
  - NO FLOODPLAIN OR WETLANDS, OR THEIR BUFFERS ARE DISTURBED FROM THIS WORK.

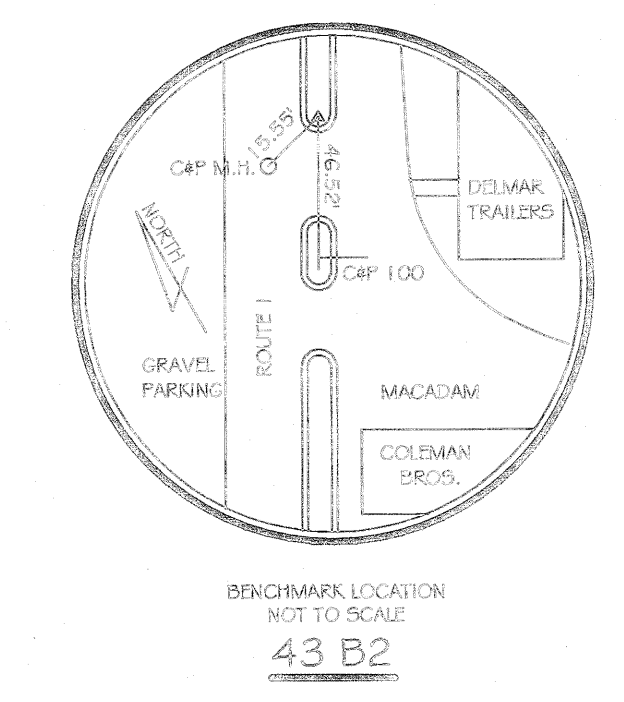
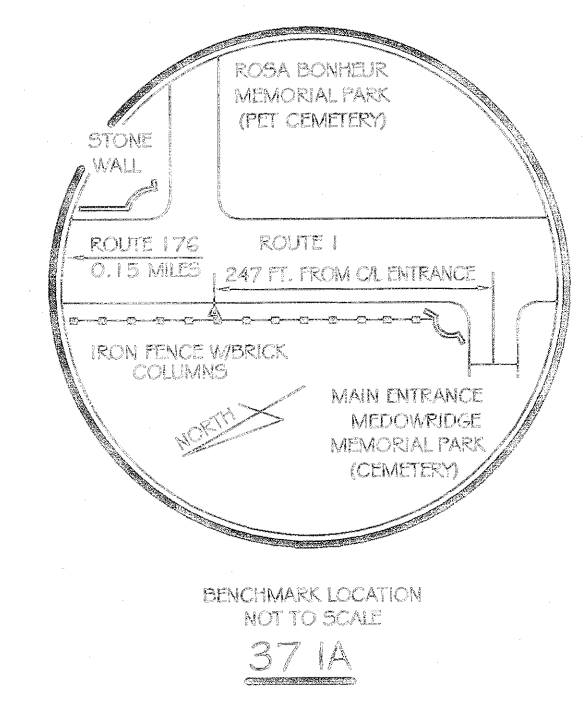

APPROVED:  
THESE PLANS FOR SMALL CONSTRUCTION SOIL EROSION, AND SEDIMENT CONTROL MEET THE REQUIREMENTS OF THE HOWARD SOIL CONSERVATION DISTRICT.

*John R. Roberts* 4/17/03  
HOWARD SOIL CONSERVATION DISTRICT DATE

APPROVED:  
THESE PLANS HAVE BEEN REVIEWED FOR THE HOWARD SOIL CONSERVATION DISTRICT AND MEET THE TECHNICAL REQUIREMENTS FOR CONSTRUCTION SOIL EROSION, AND SEDIMENT CONTROL.

*John J. Meyer* 4/15/03  
USDA-NATURAL RESOURCES CONSERVATION SERVICE DATE

1. THE CONTRACTOR OR DEVELOPER SHALL CONTACT THE CONSTRUCTION INSPECTION DIVISION 24 HOURS IN ADVANCE OF COMMENCEMENT OF WORK AT (410) 313-1880.

2. PLEASE BE ADVISED THAT ANY PROJECT WHICH CREATES A DISTURBANCE OF FIVE (5) ACRES OR MORE WILL REQUIRE A NOTICE OF INTENT TO COMPLY WITH GENERAL PERMIT FOR CONSTRUCTION ACTIVITY (NOI). THE NOI IS A REQUIREMENT FROM THE EPA FOR CONSTRUCTION ACTIVITY FOR STORMWATER DISCHARGES AND IS REGULATED UNDER THE MARYLAND DEPARTMENT OF THE ENVIRONMENT, SEDIMENT AND STORMWATER ADMINISTRATION (MDES/SSA). THE NOI IS TO BE COMPLETELY FILLED OUT AND SUBMITTED WITH THE APPROPRIATE FEES DIRECTLY TO THE MARYLAND DEPARTMENT OF THE ENVIRONMENT. THIS REGULATION BECOMES EFFECTIVE APRIL 15, 1994. FOR MORE INFORMATION CONTACT:

Maryland Department of the Environment  
Sediment and Stormwater Administration  
25000 Broening Highway  
Baltimore, MD 21284

DEPARTMENT OF PUBLIC WORKS  
HOWARD COUNTY, MARYLAND

*James J. ...* 10/30/03  
DIRECTOR OF PUBLIC WORKS DATE

*Evelyn S. Joubert* 10/30/03  
CHIEF, BUREAU OF HIGHWAYS DATE

THAYER & ASSOCIATES, INC.  
2868 CONSTELLATION WAY  
FINKSBURG, MARYLAND 21048  
TEL: 410-840-8797  
FAX: 410-840-0280

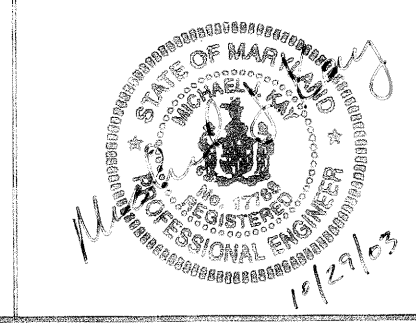

DES:	M.J.J.				
DRN:	M.J.J.				
CHK:	M.J.J.				
DATE:	JUNE 2003	BY:	NO.	REVISION	DATE

TITLE SHEET

600' SCALE MAP NO. \_\_\_\_\_ BLOCK NO. \_\_\_\_\_

DORSEY RUN ROAD EXTENSION  
STA. 592+45.12 TO STA. 604+40.10  
CAPITAL PROJECT J-4148  
FIRST ELECTION DISTRICT  
HOWARD COUNTY, MARYLAND

SCALE:  
AS SHOWN

SHEET  
1 OF 10

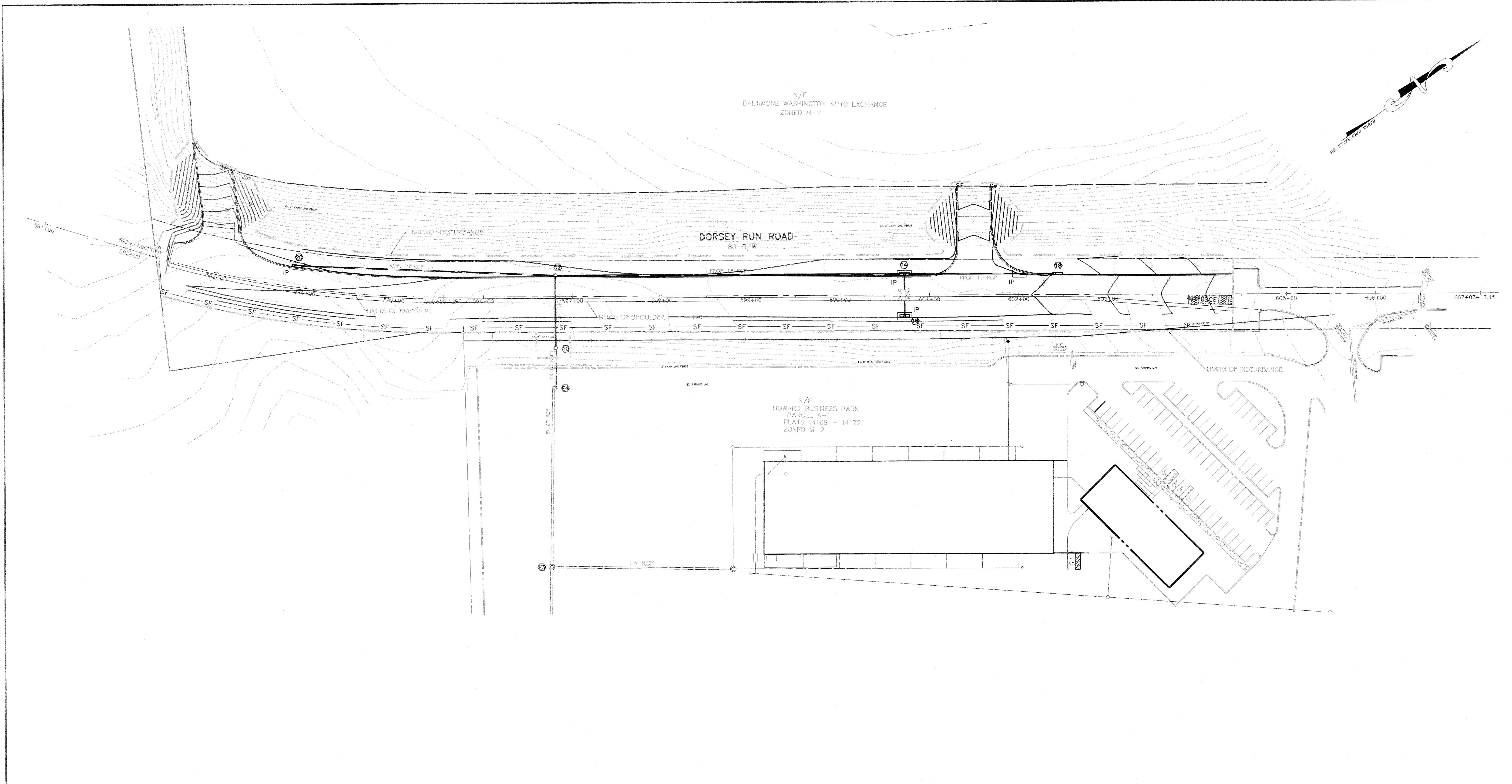

APPROVED:  
 THESE PLANS FOR ~~CONSTRUCTION~~ SOIL EROSION, AND SEDIMENT CONTROL MEET THE REQUIREMENTS OF THE HOWARD SOIL CONSERVATION DISTRICT.  
*[Signature]* 11/6/03  
 HOWARD SOIL CONSERVATION DISTRICT DATE

APPROVED:  
 THESE PLANS HAVE BEEN REVIEWED FOR THE HOWARD SOIL CONSERVATION DISTRICT AND MEET THE TECHNICAL REQUIREMENTS FOR ~~CONSTRUCTION~~ SOIL EROSION, AND SEDIMENT CONTROL.  
*[Signature]* 4/5/03  
 USDA-NATURAL RESOURCES CONSERVATION SERVICE DATE

DEPARTMENT OF PUBLIC WORKS  
 HOWARD COUNTY, MARYLAND  
 Director of Public Works: *[Signature]* 10/20/03  
 Chief, Bureau of Highways: *[Signature]* 10/20/03  
 Chief, Bureau of Transportation and Special Projects: *[Signature]* 10/30/03

THAYER & ASSOCIATES, INC.  
 2868 CONSTELLATION WAY  
 FINKSBURG, MARYLAND 21048  
 TEL: 410-840-8797  
 FAX: 410-840-0280

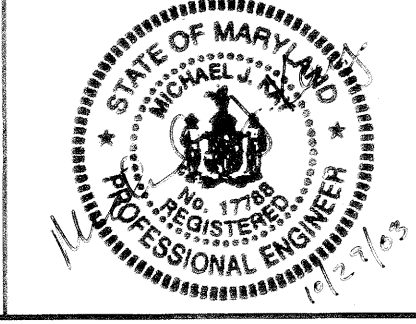

DES: M.J.K.			
DRN: M.J.K.			
CHK: M.J.K.			
DATE: JUNE 2003	BY: NO.	REVISION	DATE

GRADING, EROSION AND SEDIMENT CONTROL PLAN  
 DATE: JUNE 2003  
 600' SCALE MAP NO. \_\_\_\_\_ BLOCK NO. \_\_\_\_\_

DORSEY RUN ROAD EXTENSION  
 STA. 592+45.12 TO STA. 604+40.10  
 CAPITAL PROJECT J-4148  
 FIRST ELECTION DISTRICT  
 HOWARD COUNTY, MARYLAND

SCALE: 1" = 50'  
 SHEET 2 OF 10

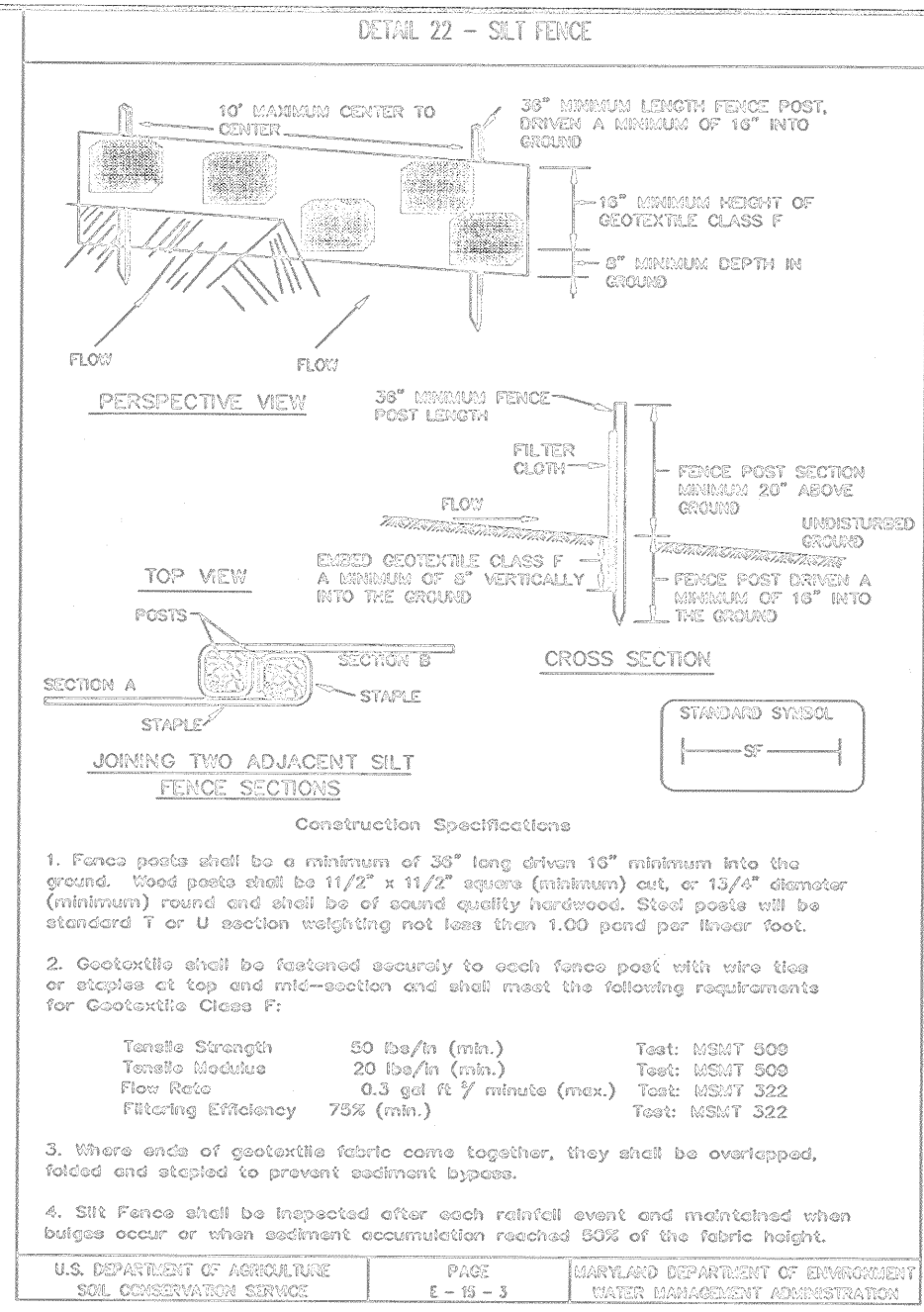
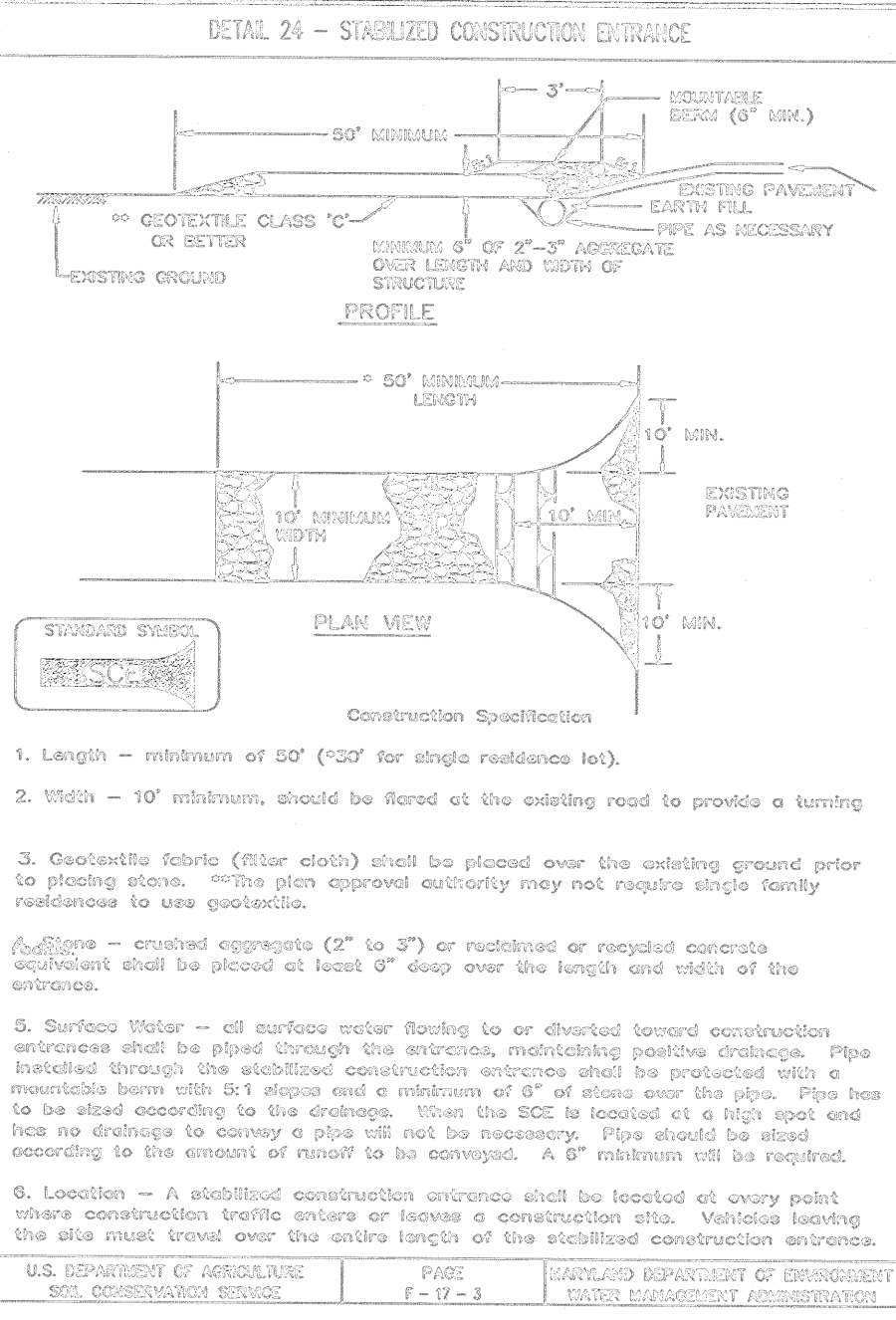

**21.0 STANDARD & SPECIFICATIONS FOR TOPSOIL**

**DEFINITION:** TOPSOIL IS THE SOIL WHICH IS FOUND IN THE SURFACE LAYER OF THE SOIL WHICH IS USUALLY 10 TO 15 CM DEEP AND WHICH IS USUALLY 10 TO 15 CM DEEP AND WHICH IS USUALLY 10 TO 15 CM DEEP.

**PLACEMENT OF TOPSOIL:** TOPSOIL SHALL BE PLACED IN THE SURFACE LAYER OF THE SOIL WHICH IS USUALLY 10 TO 15 CM DEEP AND WHICH IS USUALLY 10 TO 15 CM DEEP.

**CONSTRUCTION SPECIFICATIONS:**

1. THE TEXTURE OF THE EXPOSED SURFACE/PAVING MATERIAL IS NOT ADEQUATE TO PREVENT VEGETATIVE GROWTH.
2. THE SOIL MATERIAL IS SO SHALLOW THAT THE ROOTING ZONE IS NOT DEEP ENOUGH TO SUPPORT PLANTS OR FURNISH SUFFICIENT SUPPLIES OF MOISTURE AND PLANT NUTRIENTS.
3. THE ORIGINAL SOIL TO BE VEGETATED CONTAINS MATERIAL TOG TO PLANT GROWTH.

**CONSTRUCTION & MATERIAL SPECIFICATIONS:**

1. TOPSOIL SPECIFICATIONS FOR THE EXISTING SITE MAY BE USED, PROVIDED THAT IT MEETS THE SPECIFICATIONS SET FORTH IN THESE SPECIFICATIONS. TYPICALLY, THE TOPSOIL TO BE USED IS CLASSIFIED AS A GOOD TO VERY POOR SOIL.
2. TOPSOIL SPECIFICATIONS TO BE USED AS TOPSOIL MUST MEET THE FOLLOWING:
  - a. TOPSOIL SHALL BE A LOAM, SANDY LOAM, CLAY LOAM, SILTY LOAM, SANDY CLAY LOAM, LOAMY SAND, OR SILTY SAND.
  - b. TOPSOIL SHALL BE FREE OF PLANTS OR PLANT PARTS SUCH AS BARK, BRUSH, GRASS, LIMBS, TWIGS, AND OTHER MATERIALS LARGER THAN 10\"/>

**22.0 MATERIALS SPECIFICATIONS TABLE 27 GEOTEXTILE FABRICS**

CLASS	APPROXIMATE UNIT WEIGHT (GSM)	MINIMUM TENSILE STRENGTH (KPa)	MINIMUM TENSILE ELONGATION (%)
A	6.35	200	50
B	6.09	200	30
C	6.35	200	30
D	6.35	200	15
E	6.35	150	15
F (SILT FENCE)	6.09 - 6.35	50	15

**CONSTRUCTION & MATERIAL SPECIFICATIONS:**

1. THE FABRIC SHALL BE MADE OF POLYESTER, POLYPROPYLENE, POLYETHYLENE, OR POLYVINYL CHLORIDE.
2. THE FABRIC SHALL BE MADE OF POLYESTER, POLYPROPYLENE, POLYETHYLENE, OR POLYVINYL CHLORIDE.
3. THE FABRIC SHALL BE MADE OF POLYESTER, POLYPROPYLENE, POLYETHYLENE, OR POLYVINYL CHLORIDE.

**23.0 MATERIALS SPECIFICATIONS TABLE 28 SLOPE PROTECTION**

CLASS	APPROXIMATE UNIT WEIGHT (GSM)	MINIMUM TENSILE STRENGTH (KPa)	MINIMUM TENSILE ELONGATION (%)
A	6.35	200	50
B	6.09	200	30
C	6.35	200	30
D	6.35	200	15
E	6.35	150	15
F (SILT FENCE)	6.09 - 6.35	50	15

**CONSTRUCTION & MATERIAL SPECIFICATIONS:**

1. THE FABRIC SHALL BE MADE OF POLYESTER, POLYPROPYLENE, POLYETHYLENE, OR POLYVINYL CHLORIDE.
2. THE FABRIC SHALL BE MADE OF POLYESTER, POLYPROPYLENE, POLYETHYLENE, OR POLYVINYL CHLORIDE.
3. THE FABRIC SHALL BE MADE OF POLYESTER, POLYPROPYLENE, POLYETHYLENE, OR POLYVINYL CHLORIDE.

**24.0 MATERIALS SPECIFICATIONS TABLE 29 SLOPE PROTECTION**

CLASS	APPROXIMATE UNIT WEIGHT (GSM)	MINIMUM TENSILE STRENGTH (KPa)	MINIMUM TENSILE ELONGATION (%)
A	6.35	200	50
B	6.09	200	30
C	6.35	200	30
D	6.35	200	15
E	6.35	150	15
F (SILT FENCE)	6.09 - 6.35	50	15

**CONSTRUCTION & MATERIAL SPECIFICATIONS:**

1. THE FABRIC SHALL BE MADE OF POLYESTER, POLYPROPYLENE, POLYETHYLENE, OR POLYVINYL CHLORIDE.
2. THE FABRIC SHALL BE MADE OF POLYESTER, POLYPROPYLENE, POLYETHYLENE, OR POLYVINYL CHLORIDE.
3. THE FABRIC SHALL BE MADE OF POLYESTER, POLYPROPYLENE, POLYETHYLENE, OR POLYVINYL CHLORIDE.

**DEFINITION:** TOPSOIL IS THE SOIL WHICH IS FOUND IN THE SURFACE LAYER OF THE SOIL WHICH IS USUALLY 10 TO 15 CM DEEP AND WHICH IS USUALLY 10 TO 15 CM DEEP.

**PLACEMENT OF TOPSOIL:** TOPSOIL SHALL BE PLACED IN THE SURFACE LAYER OF THE SOIL WHICH IS USUALLY 10 TO 15 CM DEEP AND WHICH IS USUALLY 10 TO 15 CM DEEP.

**CONSTRUCTION SPECIFICATIONS:**

1. THE TEXTURE OF THE EXPOSED SURFACE/PAVING MATERIAL IS NOT ADEQUATE TO PREVENT VEGETATIVE GROWTH.
2. THE SOIL MATERIAL IS SO SHALLOW THAT THE ROOTING ZONE IS NOT DEEP ENOUGH TO SUPPORT PLANTS OR FURNISH SUFFICIENT SUPPLIES OF MOISTURE AND PLANT NUTRIENTS.
3. THE ORIGINAL SOIL TO BE VEGETATED CONTAINS MATERIAL TOG TO PLANT GROWTH.

**CONSTRUCTION & MATERIAL SPECIFICATIONS:**

1. TOPSOIL SPECIFICATIONS FOR THE EXISTING SITE MAY BE USED, PROVIDED THAT IT MEETS THE SPECIFICATIONS SET FORTH IN THESE SPECIFICATIONS. TYPICALLY, THE TOPSOIL TO BE USED IS CLASSIFIED AS A GOOD TO VERY POOR SOIL.
2. TOPSOIL SPECIFICATIONS TO BE USED AS TOPSOIL MUST MEET THE FOLLOWING:
  - a. TOPSOIL SHALL BE A LOAM, SANDY LOAM, CLAY LOAM, SILTY LOAM, SANDY CLAY LOAM, LOAMY SAND, OR SILTY SAND.
  - b. TOPSOIL SHALL BE FREE OF PLANTS OR PLANT PARTS SUCH AS BARK, BRUSH, GRASS, LIMBS, TWIGS, AND OTHER MATERIALS LARGER THAN 10\"/>

**22.0 MATERIALS SPECIFICATIONS TABLE 27 GEOTEXTILE FABRICS**

CLASS	APPROXIMATE UNIT WEIGHT (GSM)	MINIMUM TENSILE STRENGTH (KPa)	MINIMUM TENSILE ELONGATION (%)
A	6.35	200	50
B	6.09	200	30
C	6.35	200	30
D	6.35	200	15
E	6.35	150	15
F (SILT FENCE)	6.09 - 6.35	50	15

**CONSTRUCTION & MATERIAL SPECIFICATIONS:**

1. THE FABRIC SHALL BE MADE OF POLYESTER, POLYPROPYLENE, POLYETHYLENE, OR POLYVINYL CHLORIDE.
2. THE FABRIC SHALL BE MADE OF POLYESTER, POLYPROPYLENE, POLYETHYLENE, OR POLYVINYL CHLORIDE.
3. THE FABRIC SHALL BE MADE OF POLYESTER, POLYPROPYLENE, POLYETHYLENE, OR POLYVINYL CHLORIDE.

**23.0 MATERIALS SPECIFICATIONS TABLE 28 SLOPE PROTECTION**

CLASS	APPROXIMATE UNIT WEIGHT (GSM)	MINIMUM TENSILE STRENGTH (KPa)	MINIMUM TENSILE ELONGATION (%)
A	6.35	200	50
B	6.09	200	30
C	6.35	200	30
D	6.35	200	15
E	6.35	150	15
F (SILT FENCE)	6.09 - 6.35	50	15

**CONSTRUCTION & MATERIAL SPECIFICATIONS:**

1. THE FABRIC SHALL BE MADE OF POLYESTER, POLYPROPYLENE, POLYETHYLENE, OR POLYVINYL CHLORIDE.
2. THE FABRIC SHALL BE MADE OF POLYESTER, POLYPROPYLENE, POLYETHYLENE, OR POLYVINYL CHLORIDE.
3. THE FABRIC SHALL BE MADE OF POLYESTER, POLYPROPYLENE, POLYETHYLENE, OR POLYVINYL CHLORIDE.

**24.0 MATERIALS SPECIFICATIONS TABLE 29 SLOPE PROTECTION**

CLASS	APPROXIMATE UNIT WEIGHT (GSM)	MINIMUM TENSILE STRENGTH (KPa)	MINIMUM TENSILE ELONGATION (%)
A	6.35	200	50
B	6.09	200	30
C	6.35	200	30
D	6.35	200	15
E	6.35	150	15
F (SILT FENCE)	6.09 - 6.35	50	15

**CONSTRUCTION & MATERIAL SPECIFICATIONS:**

1. THE FABRIC SHALL BE MADE OF POLYESTER, POLYPROPYLENE, POLYETHYLENE, OR POLYVINYL CHLORIDE.
2. THE FABRIC SHALL BE MADE OF POLYESTER, POLYPROPYLENE, POLYETHYLENE, OR POLYVINYL CHLORIDE.
3. THE FABRIC SHALL BE MADE OF POLYESTER, POLYPROPYLENE, POLYETHYLENE, OR POLYVINYL CHLORIDE.

**25.0 MATERIALS SPECIFICATIONS TABLE 30 SLOPE PROTECTION**

CLASS	APPROXIMATE UNIT WEIGHT (GSM)	MINIMUM TENSILE STRENGTH (KPa)	MINIMUM TENSILE ELONGATION (%)
A	6.35	200	50
B	6.09	200	30
C	6.35	200	30
D	6.35	200	15
E	6.35	150	15
F (SILT FENCE)	6.09 - 6.35	50	15

**CONSTRUCTION & MATERIAL SPECIFICATIONS:**

1. THE FABRIC SHALL BE MADE OF POLYESTER, POLYPROPYLENE, POLYETHYLENE, OR POLYVINYL CHLORIDE.
2. THE FABRIC SHALL BE MADE OF POLYESTER, POLYPROPYLENE, POLYETHYLENE, OR POLYVINYL CHLORIDE.
3. THE FABRIC SHALL BE MADE OF POLYESTER, POLYPROPYLENE, POLYETHYLENE, OR POLYVINYL CHLORIDE.

**DEFINITION:** TOPSOIL IS THE SOIL WHICH IS FOUND IN THE SURFACE LAYER OF THE SOIL WHICH IS USUALLY 10 TO 15 CM DEEP AND WHICH IS USUALLY 10 TO 15 CM DEEP.

**PLACEMENT OF TOPSOIL:** TOPSOIL SHALL BE PLACED IN THE SURFACE LAYER OF THE SOIL WHICH IS USUALLY 10 TO 15 CM DEEP AND WHICH IS USUALLY 10 TO 15 CM DEEP.

**CONSTRUCTION SPECIFICATIONS:**

1. THE TEXTURE OF THE EXPOSED SURFACE/PAVING MATERIAL IS NOT ADEQUATE TO PREVENT VEGETATIVE GROWTH.
2. THE SOIL MATERIAL IS SO SHALLOW THAT THE ROOTING ZONE IS NOT DEEP ENOUGH TO SUPPORT PLANTS OR FURNISH SUFFICIENT SUPPLIES OF MOISTURE AND PLANT NUTRIENTS.
3. THE ORIGINAL SOIL TO BE VEGETATED CONTAINS MATERIAL TOG TO PLANT GROWTH.

**CONSTRUCTION & MATERIAL SPECIFICATIONS:**

1. TOPSOIL SPECIFICATIONS FOR THE EXISTING SITE MAY BE USED, PROVIDED THAT IT MEETS THE SPECIFICATIONS SET FORTH IN THESE SPECIFICATIONS. TYPICALLY, THE TOPSOIL TO BE USED IS CLASSIFIED AS A GOOD TO VERY POOR SOIL.
2. TOPSOIL SPECIFICATIONS TO BE USED AS TOPSOIL MUST MEET THE FOLLOWING:
  - a. TOPSOIL SHALL BE A LOAM, SANDY LOAM, CLAY LOAM, SILTY LOAM, SANDY CLAY LOAM, LOAMY SAND, OR SILTY SAND.
  - b. TOPSOIL SHALL BE FREE OF PLANTS OR PLANT PARTS SUCH AS BARK, BRUSH, GRASS, LIMBS, TWIGS, AND OTHER MATERIALS LARGER THAN 10\"/>

**22.0 MATERIALS SPECIFICATIONS TABLE 27 GEOTEXTILE FABRICS**

CLASS	APPROXIMATE UNIT WEIGHT (GSM)	MINIMUM TENSILE STRENGTH (KPa)	MINIMUM TENSILE ELONGATION (%)
A	6.35	200	50
B	6.09	200	30
C	6.35	200	30
D	6.35	200	15
E	6.35	150	15
F (SILT FENCE)	6.09 - 6.35	50	15

**CONSTRUCTION & MATERIAL SPECIFICATIONS:**

1. THE FABRIC SHALL BE MADE OF POLYESTER, POLYPROPYLENE, POLYETHYLENE, OR POLYVINYL CHLORIDE.
2. THE FABRIC SHALL BE MADE OF POLYESTER, POLYPROPYLENE, POLYETHYLENE, OR POLYVINYL CHLORIDE.
3. THE FABRIC SHALL BE MADE OF POLYESTER, POLYPROPYLENE, POLYETHYLENE, OR POLYVINYL CHLORIDE.

**23.0 MATERIALS SPECIFICATIONS TABLE 28 SLOPE PROTECTION**

CLASS	APPROXIMATE UNIT WEIGHT (GSM)	MINIMUM TENSILE STRENGTH (KPa)	MINIMUM TENSILE ELONGATION (%)
A	6.35	200	50
B	6.09	200	30
C	6.35	200	30
D	6.35	200	15
E	6.35	150	15
F (SILT FENCE)	6.09 - 6.35	50	15

**CONSTRUCTION & MATERIAL SPECIFICATIONS:**

1. THE FABRIC SHALL BE MADE OF POLYESTER, POLYPROPYLENE, POLYETHYLENE, OR POLYVINYL CHLORIDE.
2. THE FABRIC SHALL BE MADE OF POLYESTER, POLYPROPYLENE, POLYETHYLENE, OR POLYVINYL CHLORIDE.
3. THE FABRIC SHALL BE MADE OF POLYESTER, POLYPROPYLENE, POLYETHYLENE, OR POLYVINYL CHLORIDE.

**24.0 MATERIALS SPECIFICATIONS TABLE 29 SLOPE PROTECTION**

CLASS	APPROXIMATE UNIT WEIGHT (GSM)	MINIMUM TENSILE STRENGTH (KPa)	MINIMUM TENSILE ELONGATION (%)
A	6.35	200	50
B	6.09	200	30
C	6.35	200	30
D	6.35	200	15
E	6.35	150	15
F (SILT FENCE)	6.09 - 6.35	50	15

**CONSTRUCTION & MATERIAL SPECIFICATIONS:**

1. THE FABRIC SHALL BE MADE OF POLYESTER, POLYPROPYLENE, POLYETHYLENE, OR POLYVINYL CHLORIDE.
2. THE FABRIC SHALL BE MADE OF POLYESTER, POLYPROPYLENE, POLYETHYLENE, OR POLYVINYL CHLORIDE.
3. THE FABRIC SHALL BE MADE OF POLYESTER, POLYPROPYLENE, POLYETHYLENE, OR POLYVINYL CHLORIDE.

**25.0 MATERIALS SPECIFICATIONS TABLE 30 SLOPE PROTECTION**

CLASS	APPROXIMATE UNIT WEIGHT (GSM)	MINIMUM TENSILE STRENGTH (KPa)	MINIMUM TENSILE ELONGATION (%)
A	6.35	200	50
B	6.09	200	30
C	6.35	200	30
D	6.35	200	15
E	6.35	150	15
F (SILT FENCE)	6.09 - 6.35	50	15

**CONSTRUCTION & MATERIAL SPECIFICATIONS:**

1. THE FABRIC SHALL BE MADE OF POLYESTER, POLYPROPYLENE, POLYETHYLENE, OR POLYVINYL CHLORIDE.
2. THE FABRIC SHALL BE MADE OF POLYESTER, POLYPROPYLENE, POLYETHYLENE, OR POLYVINYL CHLORIDE.
3. THE FABRIC SHALL BE MADE OF POLYESTER, POLYPROPYLENE, POLYETHYLENE, OR POLYVINYL CHLORIDE.

**DEFINITION:** TOPSOIL IS THE SOIL WHICH IS FOUND IN THE SURFACE LAYER OF THE SOIL WHICH IS USUALLY 10 TO 15 CM DEEP AND WHICH IS USUALLY 10 TO 15 CM DEEP.

**PLACEMENT OF TOPSOIL:** TOPSOIL SHALL BE PLACED IN THE SURFACE LAYER OF THE SOIL WHICH IS USUALLY 10 TO 15 CM DEEP AND WHICH IS USUALLY 10 TO 15 CM DEEP.

**CONSTRUCTION SPECIFICATIONS:**

1. THE TEXTURE OF THE EXPOSED SURFACE/PAVING MATERIAL IS NOT ADEQUATE TO PREVENT VEGETATIVE GROWTH.
2. THE SOIL MATERIAL IS SO SHALLOW THAT THE ROOTING ZONE IS NOT DEEP ENOUGH TO SUPPORT PLANTS OR FURNISH SUFFICIENT SUPPLIES OF MOISTURE AND PLANT NUTRIENTS.
3. THE ORIGINAL SOIL TO BE VEGETATED CONTAINS MATERIAL TOG TO PLANT GROWTH.

**CONSTRUCTION & MATERIAL SPECIFICATIONS:**

1. TOPSOIL SPECIFICATIONS FOR THE EXISTING SITE MAY BE USED, PROVIDED THAT IT MEETS THE SPECIFICATIONS SET FORTH IN THESE SPECIFICATIONS. TYPICALLY, THE TOPSOIL TO BE USED IS CLASSIFIED AS A GOOD TO VERY POOR SOIL.
2. TOPSOIL SPECIFICATIONS TO BE USED AS TOPSOIL MUST MEET THE FOLLOWING:
  - a. TOPSOIL SHALL BE A LOAM, SANDY LOAM, CLAY LOAM, SILTY LOAM, SANDY CLAY LOAM, LOAMY SAND, OR SILTY SAND.
  - b. TOPSOIL SHALL BE FREE OF PLANTS OR PLANT PARTS SUCH AS BARK, BRUSH, GRASS, LIMBS, TWIGS, AND OTHER MATERIALS LARGER THAN 10\"/>

**22.0 MATERIALS SPECIFICATIONS TABLE 27 GEOTEXTILE FABRICS**

CLASS	APPROXIMATE UNIT WEIGHT (GSM)	MINIMUM TENSILE STRENGTH (KPa)	MINIMUM TENSILE ELONGATION (%)
A	6.35	200	50
B	6.09	200	30
C	6.35	200	30
D	6.35	200	15
E	6.35	150	15
F (SILT FENCE)	6.09 - 6.35	50	15

**CONSTRUCTION & MATERIAL SPECIFICATIONS:**

1. THE FABRIC SHALL BE MADE OF POLYESTER, POLYPROPYLENE, POLYETHYLENE, OR POLYVINYL CHLORIDE.
2. THE FABRIC SHALL BE MADE OF POLYESTER, POLYPROPYLENE, POLYETHYLENE, OR POLYVINYL CHLORIDE.
3. THE FABRIC SHALL BE MADE OF POLYESTER, POLYPROPYLENE, POLYETHYLENE, OR POLYVINYL CHLORIDE.

**23.0 MATERIALS SPECIFICATIONS TABLE 28 SLOPE PROTECTION**

CLASS	APPROXIMATE UNIT WEIGHT (GSM)	MINIMUM TENSILE STRENGTH (KPa)	MINIMUM TENSILE ELONGATION (%)
A	6.35	200	50
B	6.09	200	30
C	6.35	200	30
D	6.35	200	15
E	6.35	150	15
F (SILT FENCE)	6.09 - 6.35	50	15

**CONSTRUCTION & MATERIAL SPECIFICATIONS:**

1. THE FABRIC SHALL BE MADE OF POLYESTER, POLYPROPYLENE, POLYETHYLENE, OR POLYVINYL CHLORIDE.
2. THE FABRIC SHALL BE MADE OF POLYESTER, POLYPROPYLENE, POLYETHYLENE, OR POLYVINYL CHLORIDE.
3. THE FABRIC SHALL BE MADE OF POLYESTER, POLYPROPYLENE, POLYETHYLENE, OR POLYVINYL CHLORIDE.

**24.0 MATERIALS SPECIFICATIONS TABLE 29 SLOPE PROTECTION**

CLASS	APPROXIMATE UNIT WEIGHT (GSM)	MINIMUM TENSILE STRENGTH (KPa)	MINIMUM TENSILE ELONGATION (%)
A	6.35	200	50
B	6.09	200	30
C	6.35	200	30
D	6.35	200	15
E	6.35	150	15
F (SILT FENCE)	6.09 - 6.35	50	15

**CONSTRUCTION & MATERIAL SPECIFICATIONS:**

1. THE FABRIC SHALL BE MADE OF POLYESTER, POLYPROPYLENE, POLYETHYLENE, OR POLYVINYL CHLORIDE.
2. THE FABRIC SHALL BE MADE OF POLYESTER, POLYPROPYLENE, POLYETHYLENE, OR POLYVINYL CHLORIDE.
3. THE FABRIC SHALL BE MADE OF POLYESTER, POLYPROPYLENE, POLYETHYLENE, OR POLYVINYL CHLORIDE.

**25.0 MATERIALS SPECIFICATIONS TABLE 30 SLOPE PROTECTION**

CLASS	APPROXIMATE UNIT WEIGHT (GSM)	MINIMUM TENSILE STRENGTH (KPa)	MINIMUM TENSILE ELONGATION (%)
A	6.35	200	50
B	6.09	200	30
C	6.35	200	30
D	6.35	200	15
E	6.35	150	15
F (SILT FENCE)	6.09 - 6.35	50	15

**CONSTRUCTION & MATERIAL SPECIFICATIONS:**

1. THE FABRIC SHALL BE MADE OF POLYESTER, POLYPROPYLENE, POLYETHYLENE, OR POLYVINYL CHLORIDE.
2. THE FABRIC SHALL BE MADE OF POLYESTER, POLYPROPYLENE, POLYETHYLENE, OR POLYVINYL CHLORIDE.
3. THE FABRIC SHALL BE MADE OF POLYESTER, POLYPROPYLENE, POLYETHYLENE, OR POLYVINYL CHLORIDE.

**APPROVED:** [Signature] 10/20/03  
 THESE PLANS FOR SOIL EROSION, AND SEDIMENT CONTROL MEET THE REQUIREMENTS OF THE HOWARD SOIL CONSERVATION DISTRICT.

**APPROVED:** [Signature] 10/20/03  
 THESE PLANS HAVE BEEN REVIEWED FOR THE HOWARD SOIL CONSERVATION DISTRICT AND MEET THE TECHNICAL REQUIREMENTS FOR SOIL EROSION, AND SEDIMENT CONTROL.

**USDA-NATURAL RESOURCE CONSERVATION SERVICE**

**DEPARTMENT OF PUBLIC WORKS**  
 HOWARD COUNTY, MARYLAND

**THAYER & ASSOCIATES, INC.**  
 2888 CONSTELLATION WAY  
 FINKSBURG, MARYLAND 21048  
 TEL: 410-840-8797  
 FAX: 410-840-0280

**DES: M.J.K.**  
**DRN: M.J.K.**  
**CHK: G.D.T.**  
**DATE: SEPT 2003**

**SEQUENCE OF CONSTRUCTION**

1. OBTAIN GRADING PERMIT.
2. INSTALL SEDIMENT & EROSION CONTROL MEASURES. OBTAIN PERMISSION FROM THE SEDIMENT CONTROL INSPECTOR TO PROCEED.
3. CLEAR AND GRUB TO LIMITS OF DISTURBANCE.
4. ROUGH GRADE TO SUB-GRADE. USE DUST CONTROL MEASURES PER MEDE SPECIFICATIONS. INSTALL STORM DRAINAGE SYSTEM WITH INLET PROTECTION DEVICES.
5. STABILIZE ALL DISTURBED AREAS NOT TO BE PAVED.
6. FINE GRADE, INSTALL CURB AND GUTTER, AND PAVING OPERATION.
7. PERMANENTLY STABILIZE ALL REMAINING DISTURBED AREAS.
8. OBTAIN PERMISSION FROM THE SEDIMENT CONTROL INSPECTOR AND REMOVE ALL REMAINING SEDIMENT CONTROL DEVICES.

**CERTIFICATION OF QUANTITIES**

I hereby certify that the estimated total amount of excavation and fill as shown on these plans has been computed to 5,800 cubic yards of excavation, 4,600 cubic yards of fill and the total area to be disturbed as shown on these plans has been determined to be 123,750 square feet.

**Michael J. Kay**  
 Design Engineer Signature  
 Michael J. Kay  
 Maryland Registered Professional Engineer No. 17768  
 10/23/03

**SEDIMENT CONTROL NOTES AND DETAILS**

**DORSEY RUN ROAD EXTENSION**  
 STA. 592+45.12 TO STA. 604+40.10  
 CAPITAL PROJECT J-4148  
 FIRST ELECTION DISTRICT  
 HOWARD COUNTY, MARYLAND

**SCALE:**  
 AS SHOWN  
**SHEET**  
 3 OF 10

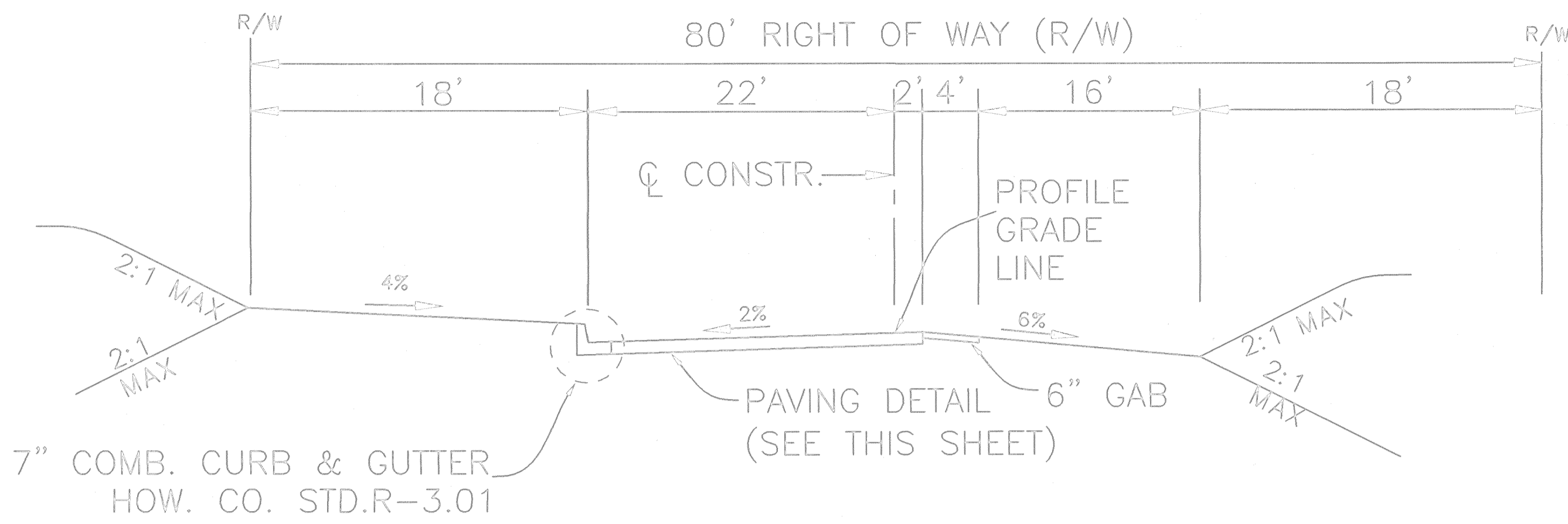

**TYPICAL SECTION -- MAJOR COLLECTOR STREET**

(NOT TO SCALE)  
 DORSEY RUN ROAD - STA. 595+44.48 TO STA. 605+00.00  
 HOWARD COUNTY STANDARD FIGURE R-1.04  
 DESIGN SPEED - 40 MPH

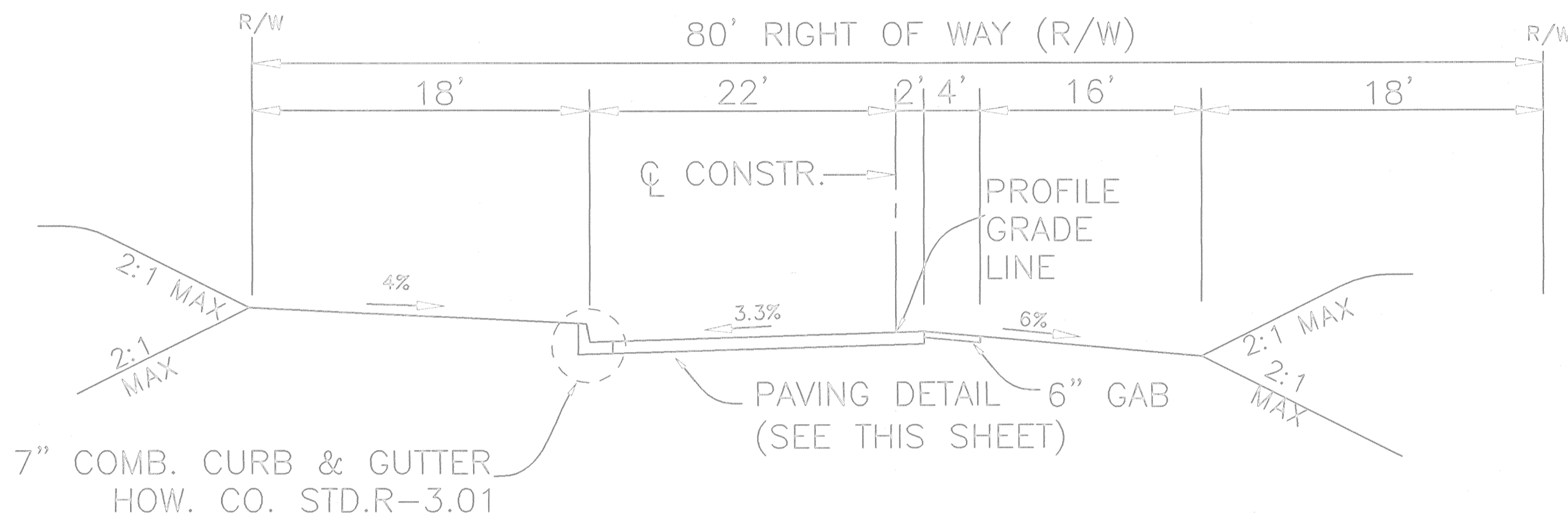

**FULL SUPER ELEVATION -- TYPICAL SECTION**

(NOT TO SCALE)  
 DORSEY RUN ROAD - STA. 592+11.90 TO STA. 595+55.12  
 HOWARD COUNTY STANDARD FIGURE R-1.04  
 DESIGN SPEED - 40 MPH

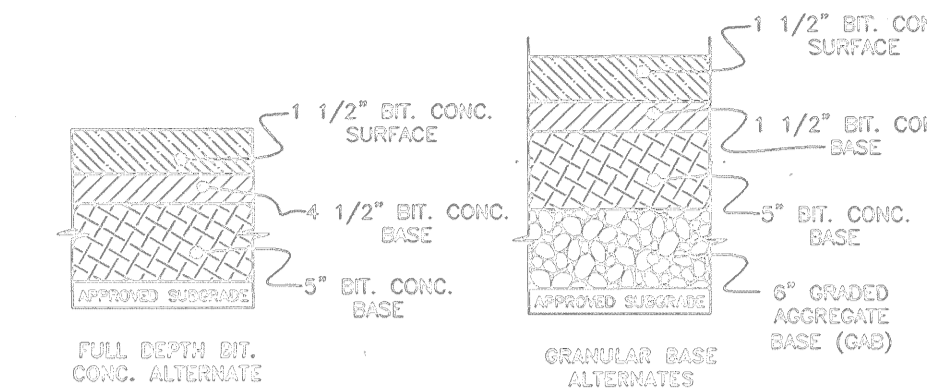

SECTION NUMBER	ROAD AND STREET CLASSIFICATION
P-5	COMMERCIAL-INDUSTRIAL ZONES MAJOR COLLECTOR ALL ZONES MINOR ARTERIAL

**TYPICAL PAVING SECTION**  
(NOT TO SCALE)

**PAVING NOTES**

1. ALL MATERIALS AND METHODS OF CONSTRUCTION SHALL BE IN ACCORDANCE WITH THE LATEST STANDARD AND SPECIFICATIONS OF HOWARD COUNTY PLUS SHA STANDARDS AND SPECIFICATIONS, IF APPLICABLE.
2. ALL CONNECTIONS AT EXISTING IMPROVEMENTS SHALL BE WITH A CLEAN VERTICAL JOINT. SEE HOWARD COUNTY STANDARD DETAIL C4.01.
3. ALL SPOT GRADES SHOWN ARE FLOW LINE ELEVATIONS (FL) UNLESS OTHERWISE NOTED.
4. THE CONTRACTOR SHALL NOTIFY MISS UTILITY AT 1-800-257-7777 48 HOURS IN ADVANCE OF ANY EXCAVATION.
5. THE CONTRACTOR SHALL NOTIFY THE DEPARTMENT PUBLIC WORK/ CONSTRUCTION INSPECTION DIVISION AT (410) 313-1680 AT LEAST FIVE (5) WORKING DAYS PRIOR TO THE START OF WORK.
6. CURBS, CUTTERS, SIDEWALKS, AND ALL PAVING SHALL BE INSTALLED IN SUCH A MANNER AS TO PROVIDE POSITIVE DRAINAGE OF ALL AREAS SO THERE IS NO ACCUMULATION OF SURFACE WATER.
7. WHERE PROPOSED CURB MEETS EX. CURB, THE CONTRACTOR SHALL MATCH EX. CURB & GUTTER IN LINE AND ON GRADE OR AS DIRECTED BY THE INSPECTOR.
8. FOR SIDEWALK HANDICAP RAMP DETAIL & CONSTRUCTION SPECIFICATIONS, SEE HOWARD COUNTY STANDARD DETAIL R-4.02.
9. ALL CURB AND GUTTERS SHOWN ON THE PLANS ARE HOWARD COUNTY STANDARDS AND DETAILS.
10. ALL ROADWAY SUBGRADE SHALL MEET HOWARD COUNTY STANDARD AND SPECIFICATIONS.
11. ALL DRIVEWAY APRON SHALL BE CONSTRUCTED PER HOWARD COUNTY STANDARD DETAIL R-6.01
12. ALL CURB FILLET RADIUS SHALL BE 25' UNLESS NOTED OTHERWISE
13. CONTRACTOR SHALL PROVIDE SPILL GUTTER ON CURB FILLETS AS NEEDED TO CONVEY WATER ACROSS INTERSECTIONS.
14. GRADE ALL DISTURBED AREAS TO PROVIDE POSITIVE DRAINAGE.
15. INFORMATION CONCERNING UNDERGROUND UTILITIES WAS OBTAINED FROM AVAILABLE RECORDS, BUT THE CONTRACTOR MUST DETERMINE THE EXACT LOCATION AND ELEVATIONS OF THE MAINS BY DIGGING TEST PITS BY HAND AT ALL UTILITY CROSSINGS, WELL IN ADVANCE OF TRENCHING. IF CLEARANCES ARE LESS THAN SHOWN ON THIS PLAN, OR TWELVE (12) INCHES, WHICHEVER IS LESS, CONTACT THE HOWARD COUNTY DEPARTMENT OF PUBLIC WORK AND THE APPROPRIATE UTILITY OWNER BEFORE PROCEEDING WITH CONSTRUCTION.

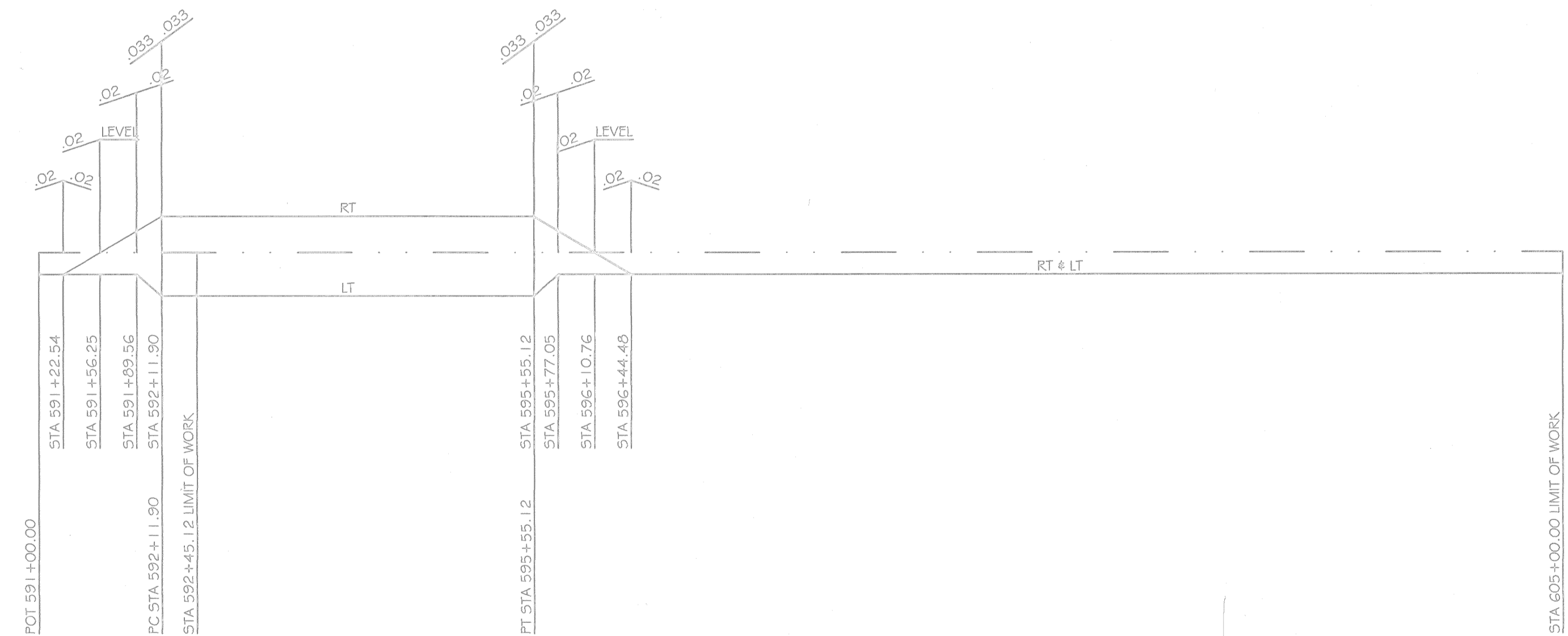

**SUPERELEVATION TRANSITION DIAGRAM**

HORZ. SCALE: 1" = 100'

DEPARTMENT OF PUBLIC WORKS HOWARD COUNTY, MARYLAND Director of Public Works: <i>[Signature]</i> 10/30/03 Chief, Bureau of Engineering: <i>[Signature]</i> 10/30/03 Chief, Bureau of Highways: <i>[Signature]</i> 10/30/03 Chief, Division of Transportation Projects and Watershed Management: <i>[Signature]</i> 10/30/03		THAYER & ASSOCIATES, INC. 2888 CONSTELLATION WAY FINKSBURG, MARYLAND 21048 TEL: 410-840-8797 FAX: 410-840-0280 <i>[Signature]</i> 10/30/03		DES: M.J.K. DRN: M.J.K. CHK: G.D.T. DATE: SEPT 2003		NOTES, DETAILS AND TYPICAL SECTIONS		DORSEY RUN ROAD EXTENSION STA. 592+45.12 TO STA. 604+40.10 CAPITAL PROJECT J-4148 FIRST ELECTION DISTRICT HOWARD COUNTY, MARYLAND		SCALE: AS SHOWN SHEET 4 OF 10
				BY NO. REVISION DATE		600' SCALE MAP NO. BLOCK NO.				

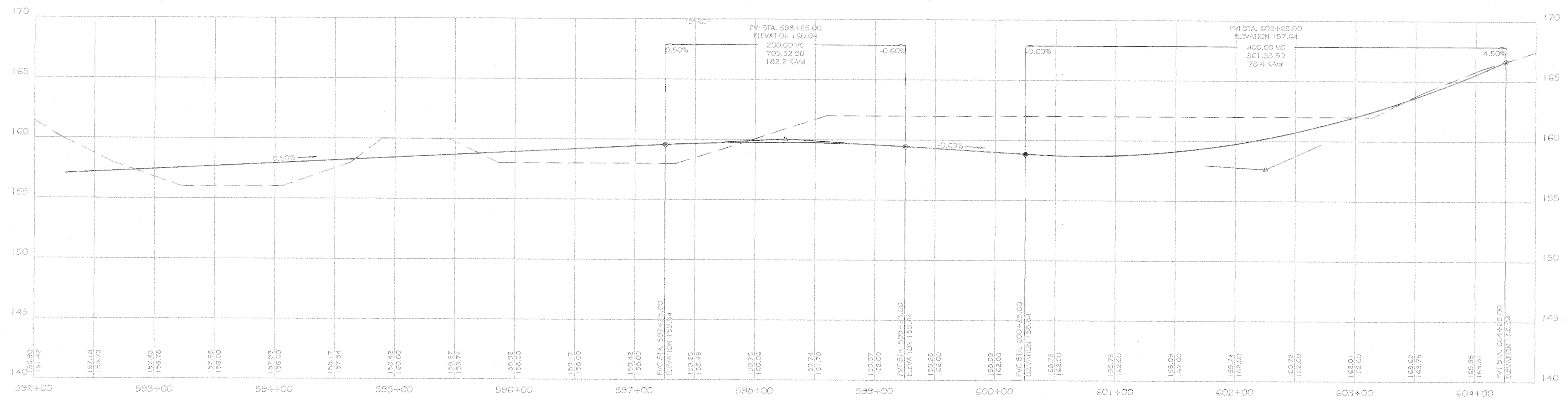
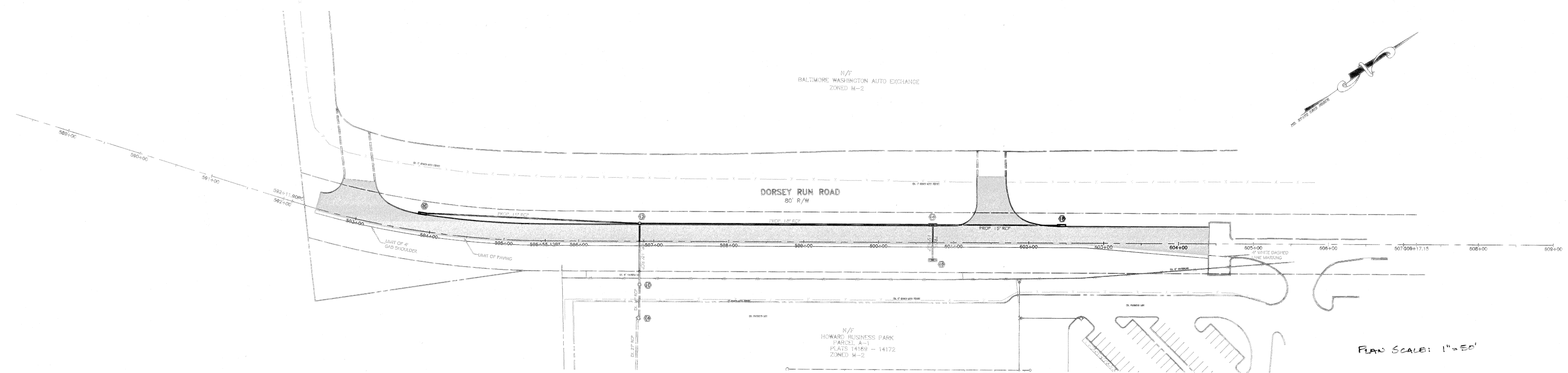

DEPARTMENT OF PUBLIC WORKS  
HOWARD COUNTY, MARYLAND

*James J. [Signature]*  
DIRECTOR OF PUBLIC WORKS  
DATE: 10/30/03

*Paul [Signature]*  
CHIEF, BUREAU OF ENGINEERING  
DATE: 10/30/03

*Evelyn E. [Signature]*  
CHIEF, BUREAU OF HIGHWAYS  
DATE: 10/30/03

*Evelyn E. [Signature]*  
CHIEF, BUREAU OF PROJECTS AND WATERSHED MANAGEMENT  
DATE: 10/30/03

THAYER & ASSOCIATES, INC.  
2868 CONSTELLATION WAY  
FINKSBURG, MARYLAND 21048  
TEL: 410-840-8797  
FAX: 410-840-0280

STATE OF MARYLAND  
REGISTERED PROFESSIONAL ENGINEER  
12/1/03

DES:	M.J.K.			
DRN:	M.J.K.			
CHK:	M.J.K.			
DATE:	JUNE 2003	BY:	NO.	REVISION

PLAN AND PROFILE

DATE: \_\_\_\_\_

600' SCALE MAP NO. \_\_\_\_\_ BLOCK NO. \_\_\_\_\_

DORSEY RUN ROAD EXTENSION  
STA. 592+45.12 TO STA. 604+40.10  
CAPITAL PROJECT J-4 | 48  
FIRST ELECTION DISTRICT  
HOWARD COUNTY, MARYLAND

SCALE:  
AS SHOWN

SHEET  
5 OF 10

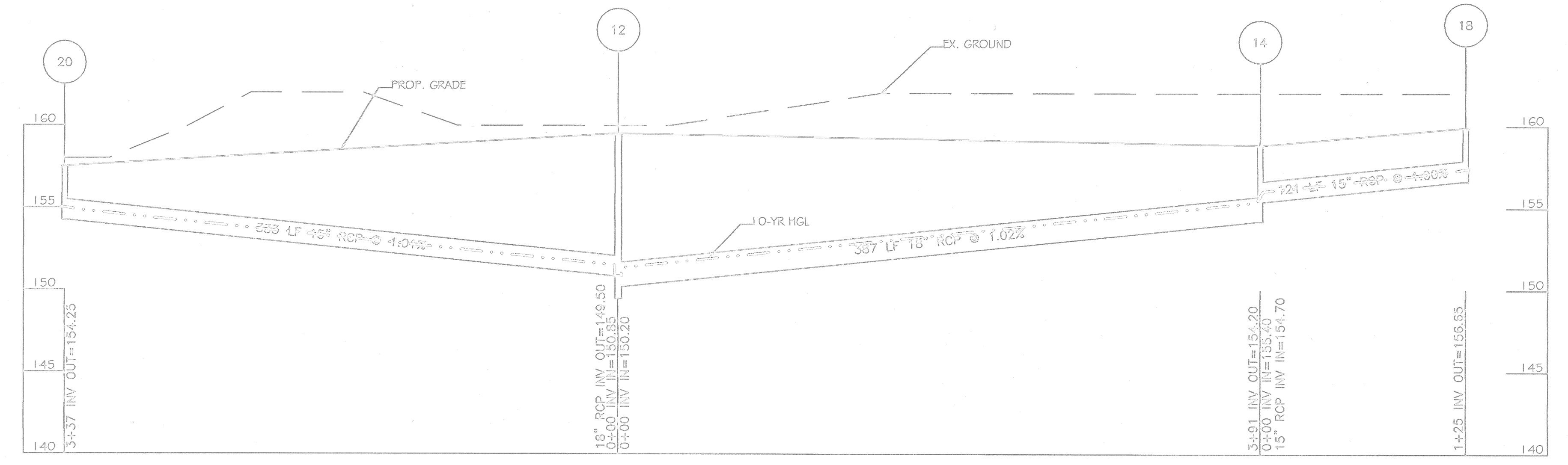
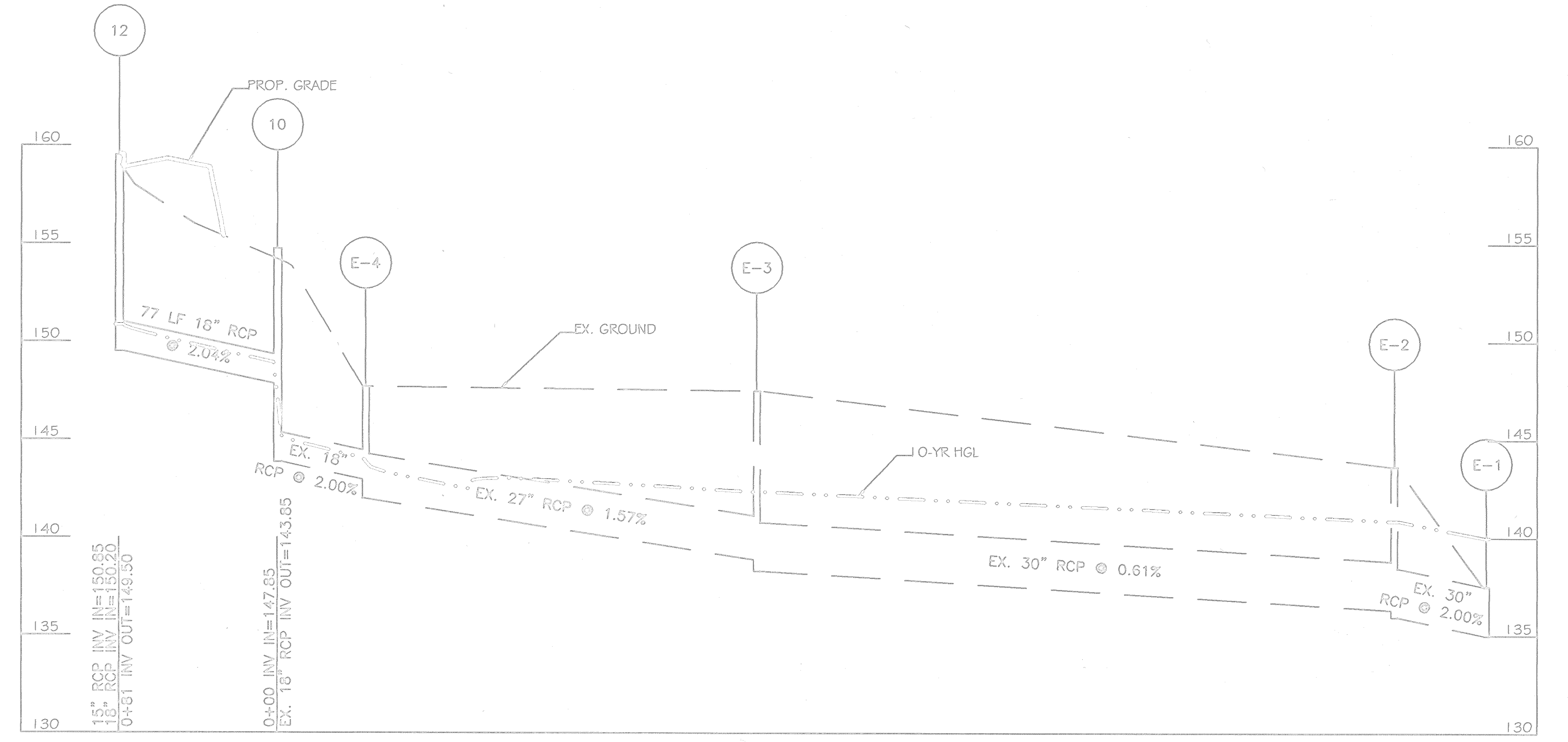
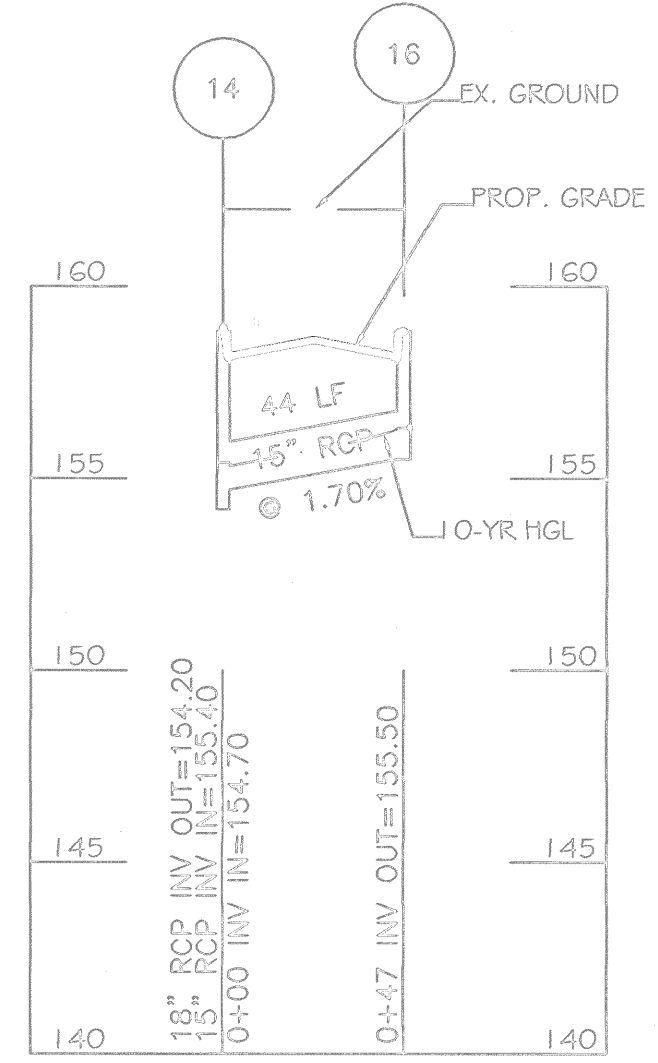

PIPE SCHEDULE				
FROM	TO	SIZE	TYPE	LENGTH
20	12	15"	RCP, CL. IV	333 L.F.
18	14	15"	RCP, CL. IV	121 L.F.
16	14	15"	RCP, CL. IV	44 L.F.
14	12	16"	RCP, CL. IV	387 L.F.
12	10	16"	RCP, CL. IV	77 L.F.

STRUCTURE SCHEDULE							
STR. No.	STRUCTURE TYPE	STRUCTURE LOCATION	STRUCTURE ELEVATION	INVERT (IN)	INVERT (IN)	INVERT (OUT)	REMARKS
20	STANDARD TYPE "A-10" INLET HOWARD CO. STD. SD-4.41	STA. 593+42.62 O/S 22.00' LT.	157.48 / 157.54	----	----	154.25 (15")	
18	STANDARD TYPE "A-10" INLET HOWARD CO. STD. SD-4.41	STA. 602+01.00 O/S 22.00' LT.	159.81 / 159.89	----	----	158.65 (15")	
16	STANDARD TYPE "A-10" INLET HOWARD CO. STD. SD-4.41	STA. 600+72.05 O/S 22.00' RT.	158.84	----	----	155.50 (15")	
14	STANDARD TYPE "A-10" INLET HOWARD CO. STD. SD-4.41	STA. 600+72.05 O/S 22.00' LT.	158.84	155.40 (15")	154.70 (15")	154.20 (18")	
12	4'-0" PRECAST MANHOLE HOWARD CO. STD. C-5.12	STA. 598+60.69 O/S 23.58' LT.	159.52	150.85 (15")	150.20 (18")	149.50 (18")	
10	4'-0" PRECAST MANHOLE HOWARD CO. STD. C5.11	STA. 596+80.89 O/S 57.59' RT.	154.75	147.85 (18")	----	143.85 (18")	EX. 18" STUB FROM SDP-00-114

- NOTES:
- ALL CURB INLETS SHALL BE CAST FOR STANDARD 7" COMBINATION CURB & GUTTER (HOWARD CO. STD. R-3.01).
  - OFFSET FOR INLETS IS TO FACE OF CURB, AND FOR MANHOLES IS TO CENTER OF STRUCTURE.
  - STATION INDICATES THE CENTER OF THE OUTSIDE WALL OF THE THROAT SECTION FOR INLETS AND THE CENTER OF THE STRUCTURE FOR MANHOLES.
  - TC. ELEV. / TO ELEV. DENOTES THE UPSTREAM AND DOWNSTREAM EDGE OF THE OUTSIDE WALL OF THE THROAT SECTION FOR INLETS AND CENTER OF THE STRUCTURE FOR MANHOLES.

STORM DRAIN PROFILES  
SCALE: VERT. 1"=5', HOR. 1"=50'

DEPARTMENT OF PUBLIC WORKS HOWARD COUNTY, MARYLAND Director of Public Works: <i>[Signature]</i> 10/30/03 Chief, Bureau of Highways: <i>[Signature]</i> 10/30/03		THAYER & ASSOCIATES, INC. 2868 CONSTELLATION WAY FINKSBURG, MARYLAND 21048 TEL: 410-840-8787 FAX: 410-840-0280 Chief, Division of Transportation Projects and Watershed Management: <i>[Signature]</i> 10/30/03		DES: M.J.K. DRN: M.J.K. CHK: M.J.K. DATE: JUNE 2003		STORM DRAIN PROFILES		DORSEY RUN ROAD EXTENSION STA. 592+45.12 TO STA. 604+40.10 CAPITAL PROJECT J-4148 FIRST ELECTION DISTRICT HOWARD COUNTY, MARYLAND		SCALE: V: 1"=5' H: 1"=50' SHEET 6 OF 10
				BY: NO. REVISION DATE		600' SCALE MAP NO. BLOCK NO.				

N/F  
BALTIMORE WASHINGTON AUTO EXCHANGE  
ZONED M-2

DORSEY RUN ROAD  
80' R/W

INLET 14  
DA=0.71 AC.  
C=0.46

INLET 15  
DA=0.65 AC.  
C=0.46

N/F  
HOWARD BUSINESS PARK  
PARCEL A-1  
PLATS 14169 - 14172  
ZONED M-2

INLET 16  
DA=0.76 AC.  
C=0.63

15' RCP

APPROVED:  
THESE PLANS FOR \_\_\_\_\_ SOIL EROSION, AND  
SEDIMENT CONTROL MEET THE REQUIREMENTS OF THE HOWARD SOIL  
CONSERVATION DISTRICT.  
*[Signature]* 11/19/03  
DATE

APPROVED:  
THESE PLANS HAVE BEEN REVIEWED FOR THE HOWARD SOIL  
CONSERVATION DISTRICT AND MEET THE TECHNICAL REQUIREMENTS FOR  
SOIL EROSION, AND SEDIMENT CONTROL.  
*[Signature]* 11/19/03  
DATE

DEPARTMENT OF PUBLIC WORKS  
HOWARD COUNTY, MARYLAND

*[Signature]* 10/30/03  
DIRECTOR OF PUBLIC WORKS  
DATE

*[Signature]* 10/30/03  
CHIEF, BUREAU OF HIGHWAYS  
DATE

THAYER & ASSOCIATES, INC.  
2858 CONSTELLATION WAY  
FINKSBURG, MARYLAND 21048  
TEL: 410-840-8797  
FAX: 410-840-0280

*[Signature]*  
11/21/03

DES: M.J.K.  
DRN: M.J.K.  
CHK: M.J.K.  
DATE: JUNE 2003

BY	NO.	REVISION	DATE	600' SCALE MAP NO.	BLOCK NO.

DRAINAGE AREA MAP

DORSEY RUN ROAD EXTENSION  
STA. 592+45.12 TO STA. 604+40.10  
CAPITAL PROJECT J-4148  
FIRST ELECTION DISTRICT  
HOWARD COUNTY, MARYLAND

SCALE:  
1"=50'  
SHEET  
7 OF 10

102

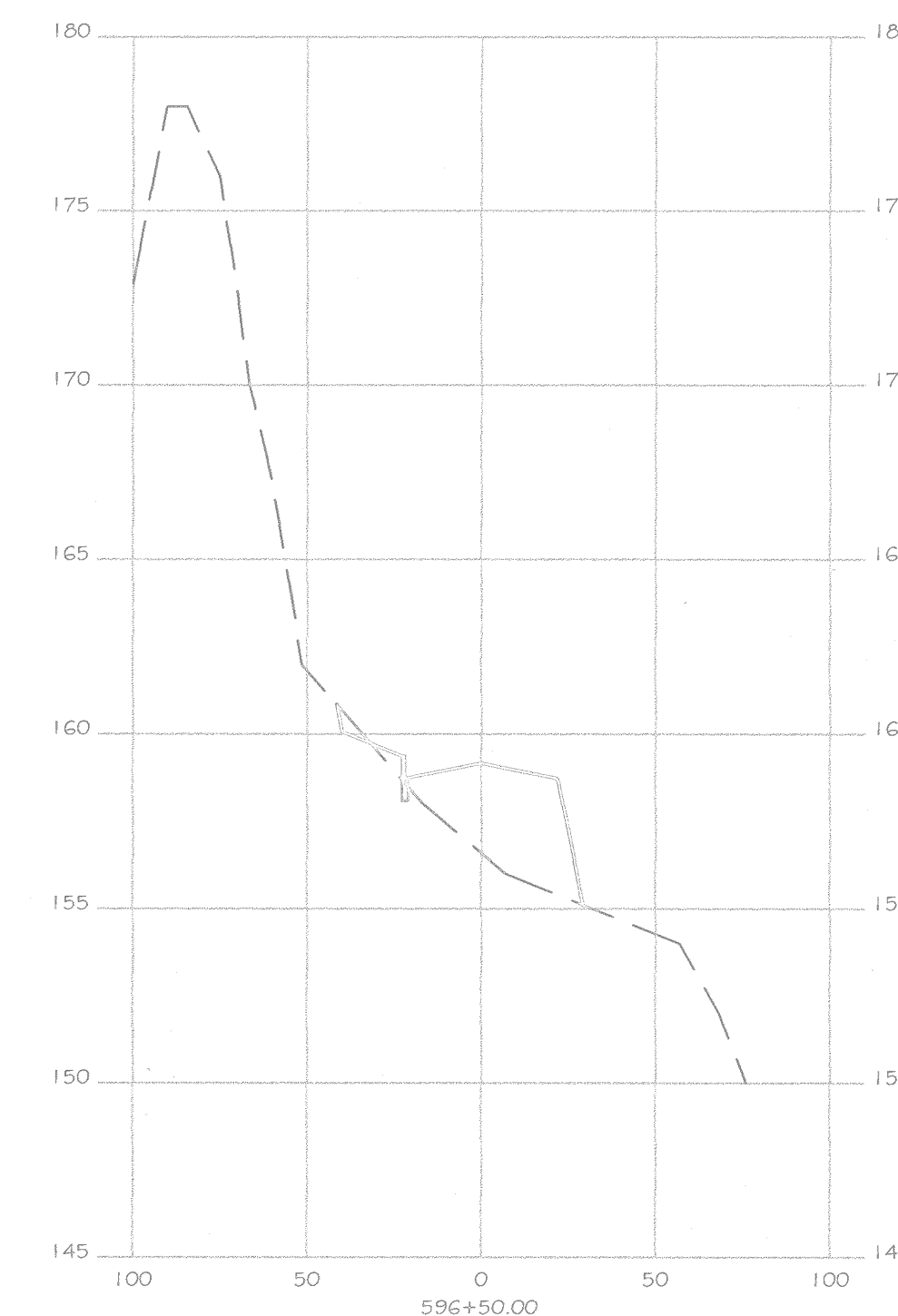
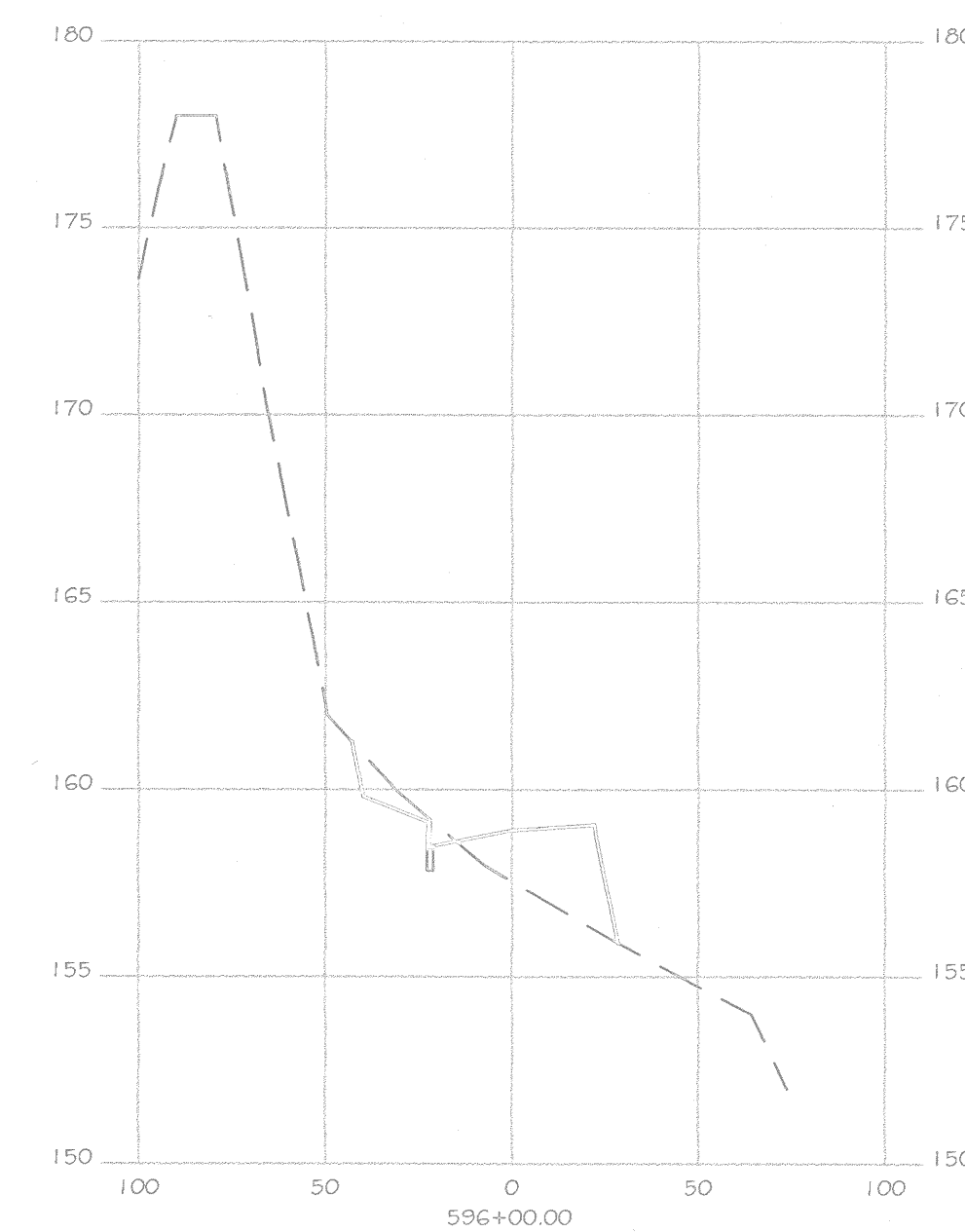
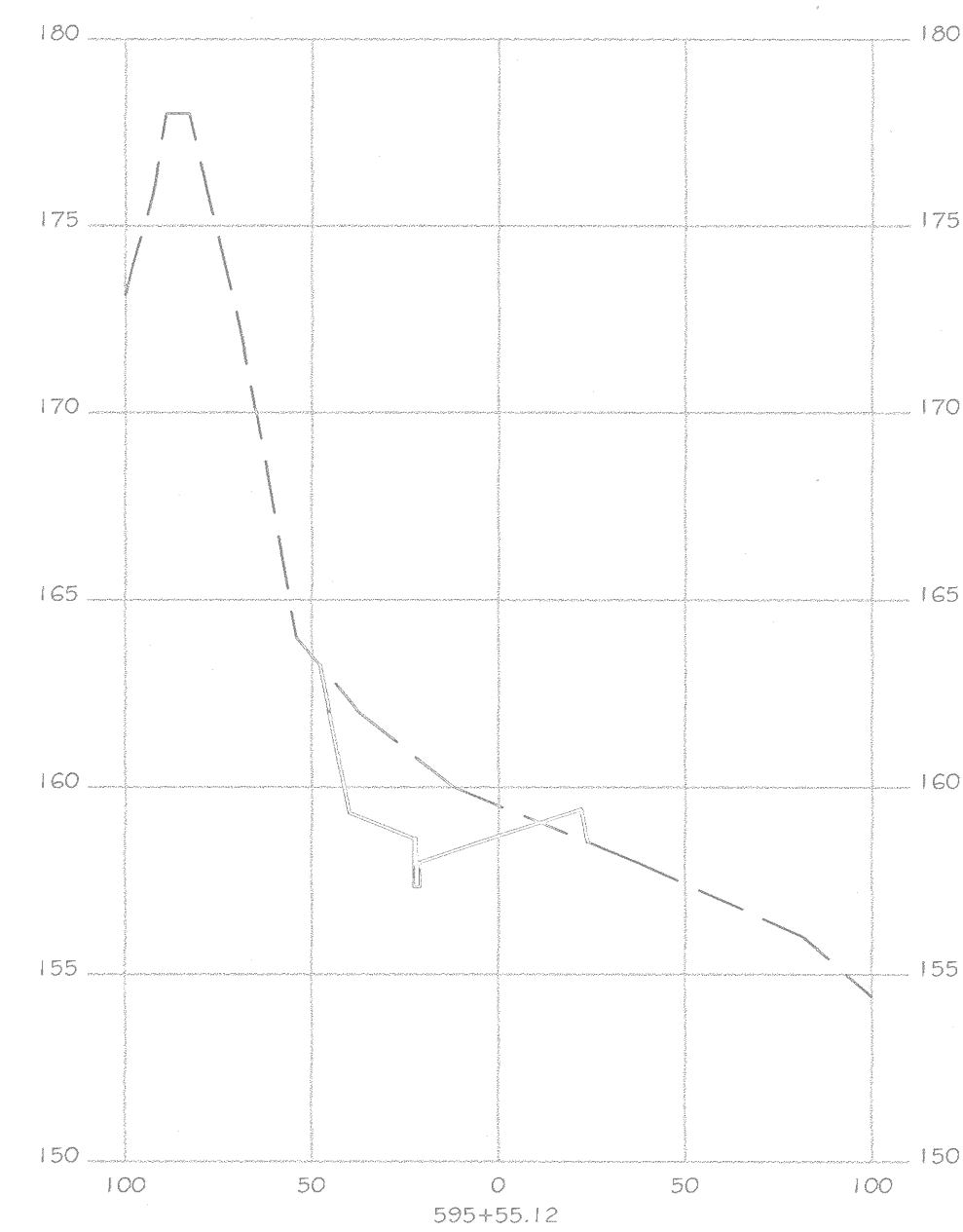
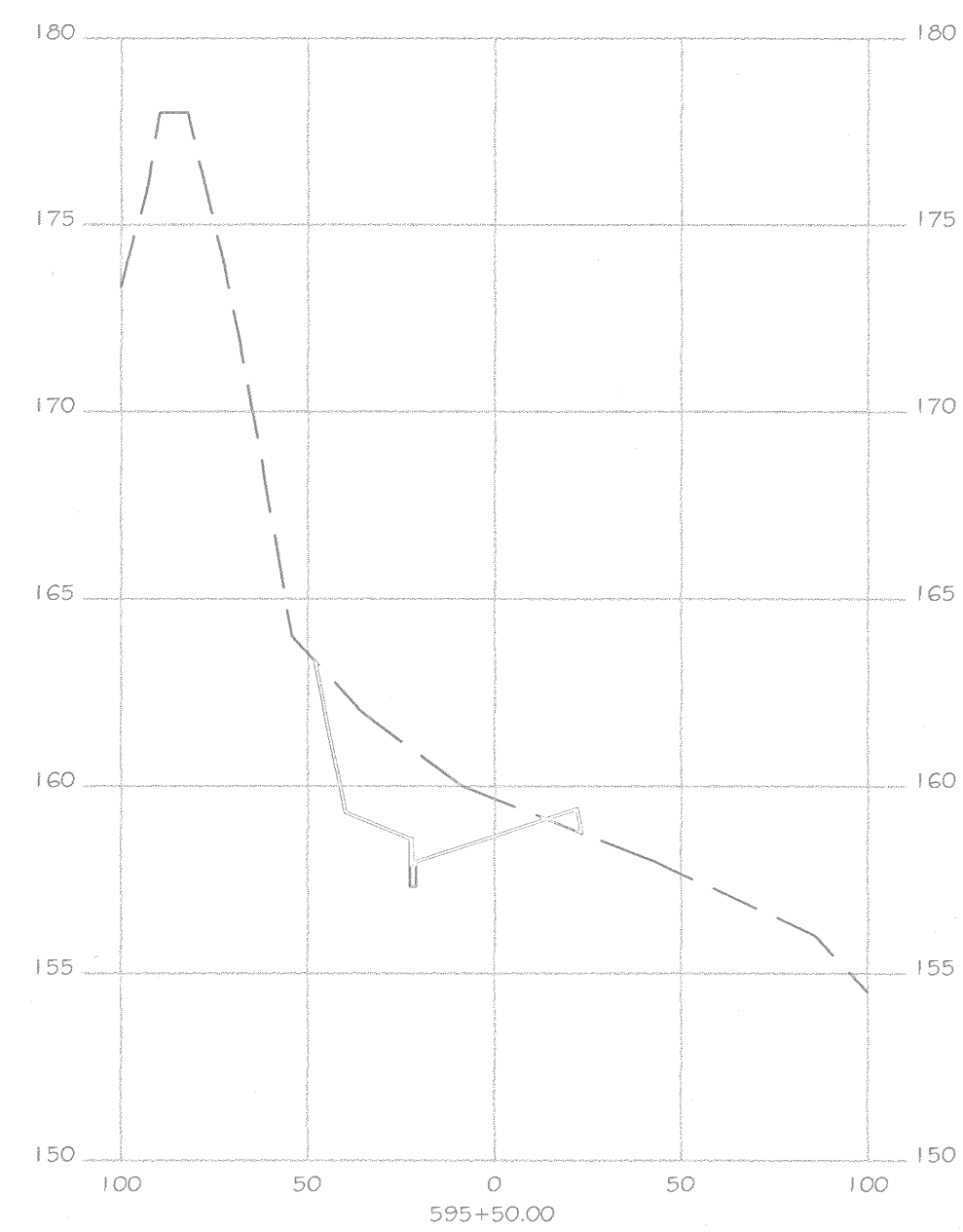
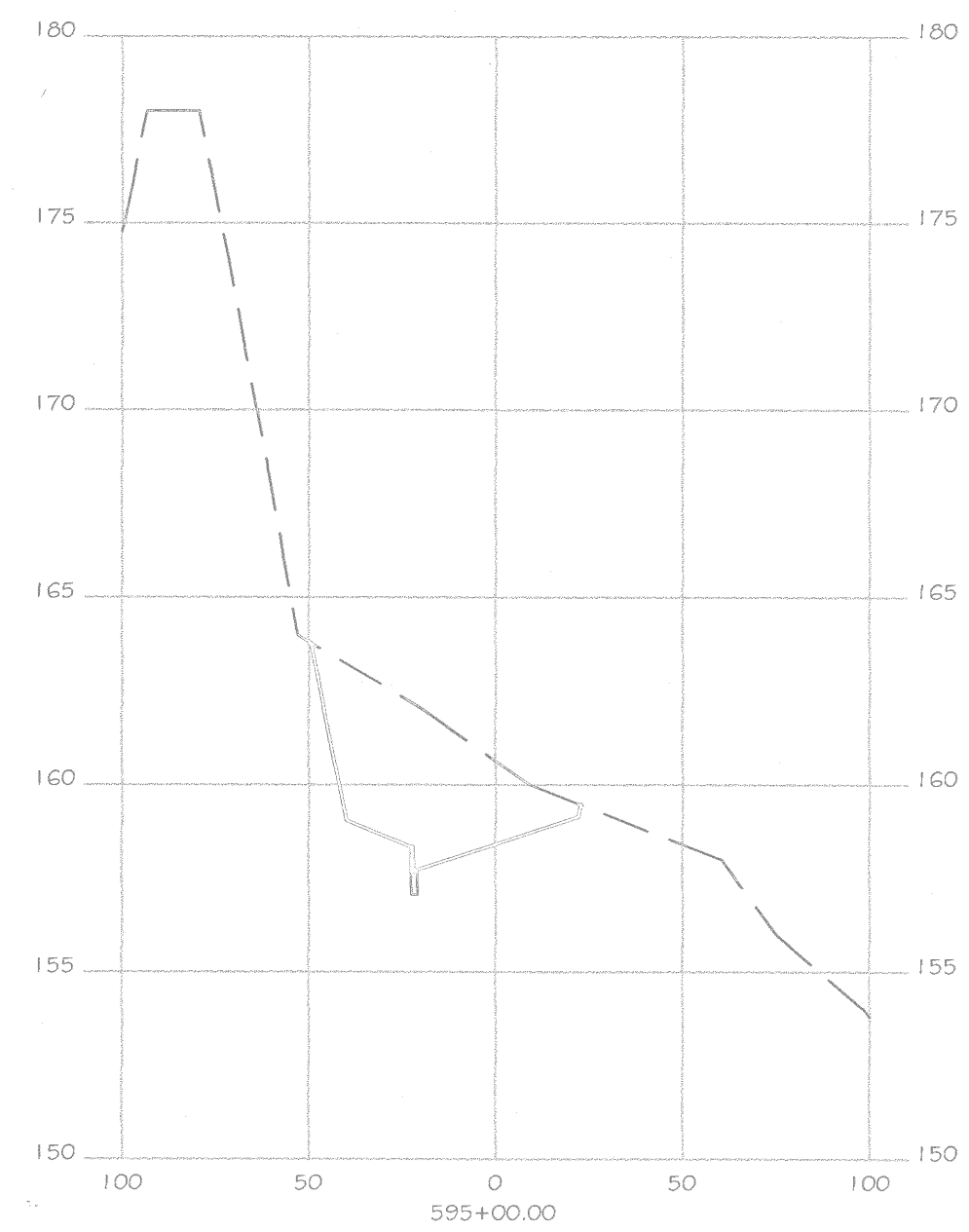
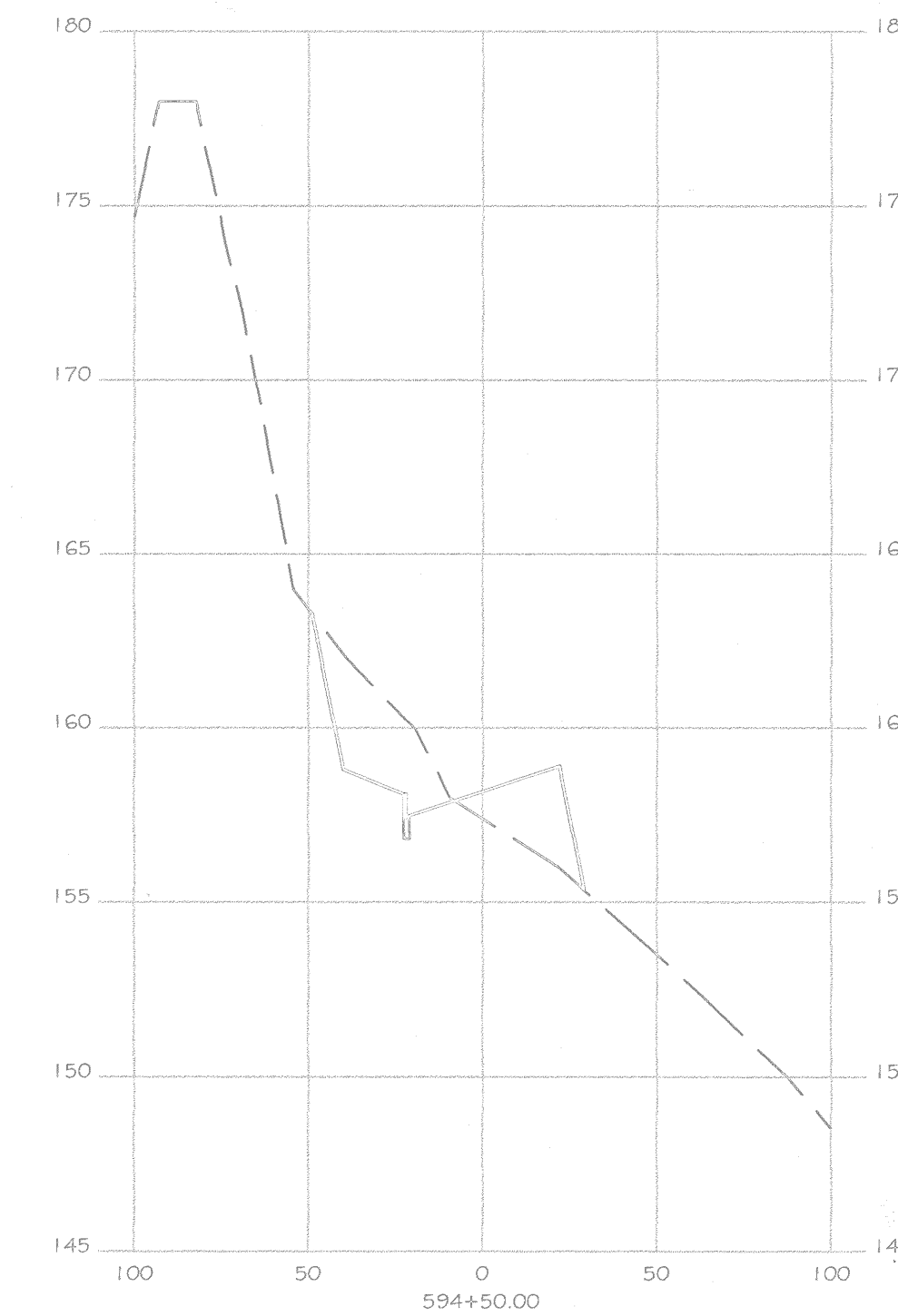
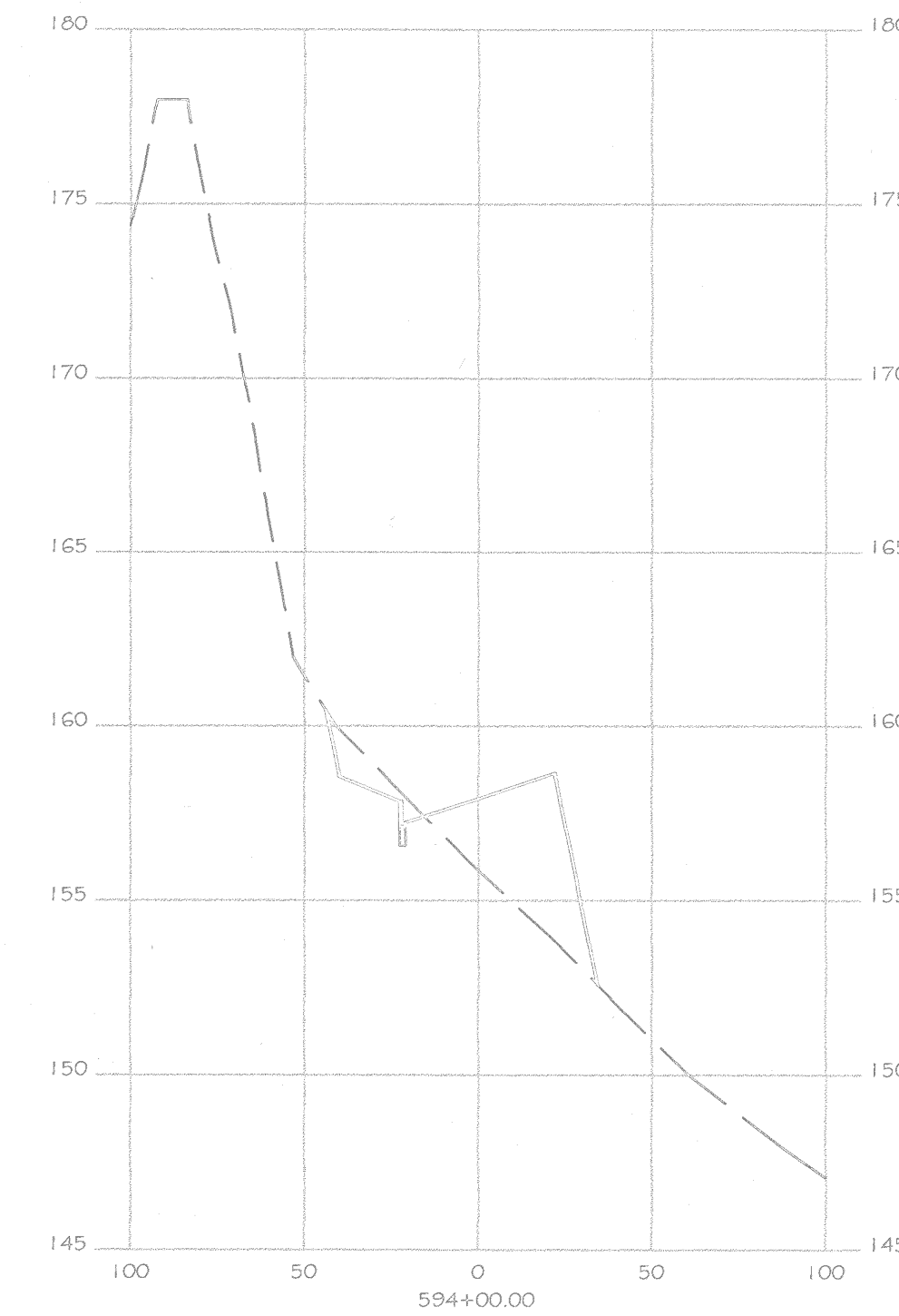
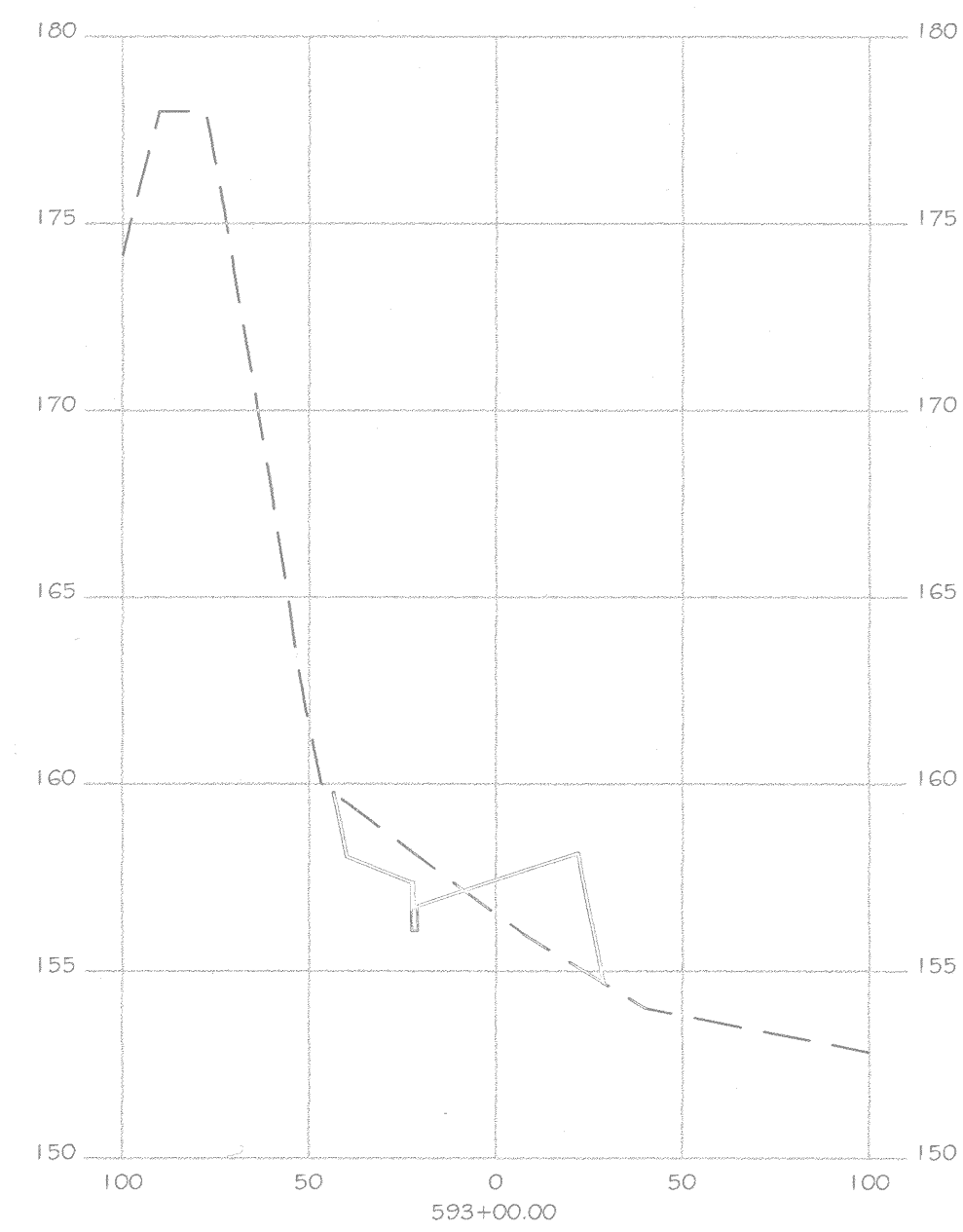
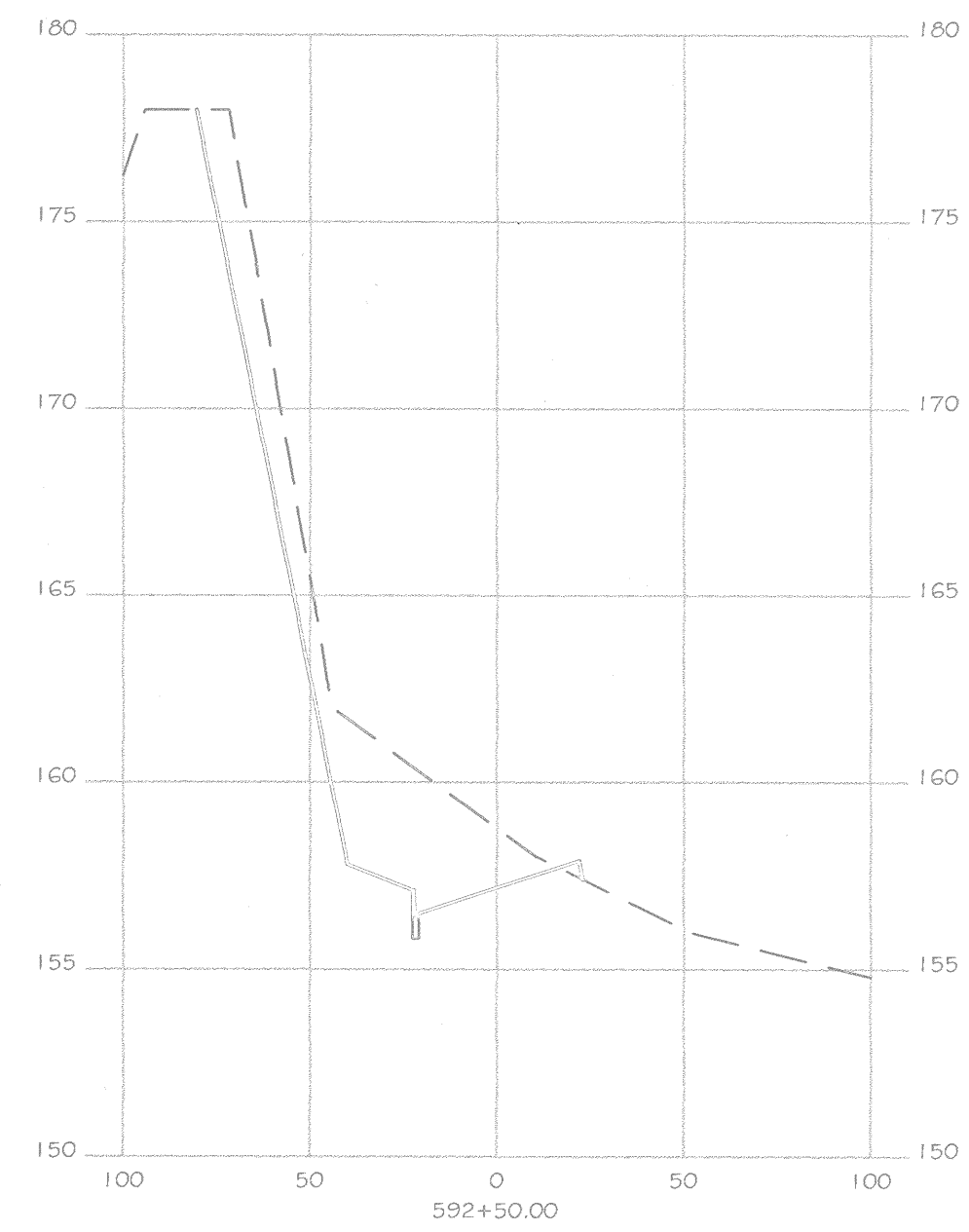

DEPARTMENT OF PUBLIC WORKS  
HOWARD COUNTY, MARYLAND

*[Signature]* 10/30/03  
DIRECTOR OF PUBLIC WORKS DATE

*[Signature]* 10/30/03  
CHIEF, BUREAU OF ENGINEERING DATE

*[Signature]* 10/30/03  
CHIEF, DIVISION OF TRANSPORTATION DATE

*[Signature]* 10/30/03  
CHIEF, BUREAU OF HIGHWAYS DATE

CHIEF, DIVISION OF TRANSPORTATION  
PROJECTS AND WATERSHED MANAGEMENT

THAYER & ASSOCIATES, INC.  
2888 CONSTELLATION WAY  
FINKSBURG, MARYLAND 21048  
TEL: 410-840-8797  
FAX: 410-840-0250



DES:	M.J.K.				
DRN:	M.J.K.				
CHK:	G.D.T.				
DATE:	SEPT 2003	BY:	NO.	REVISION	DATE
			600' SCALE MAP NO.	BLOCK NO.	

DORSEY RUN ROAD EXTENSION  
STA. 592+45.12 TO STA. 604+40.10  
CAPITAL PROJECT J-4148  
FIRST ELECTION DISTRICT  
HOWARD COUNTY, MARYLAND

SCALE:  
V: 1" = 5'  
H: 1" = 50'

SHEET  
8 OF 10



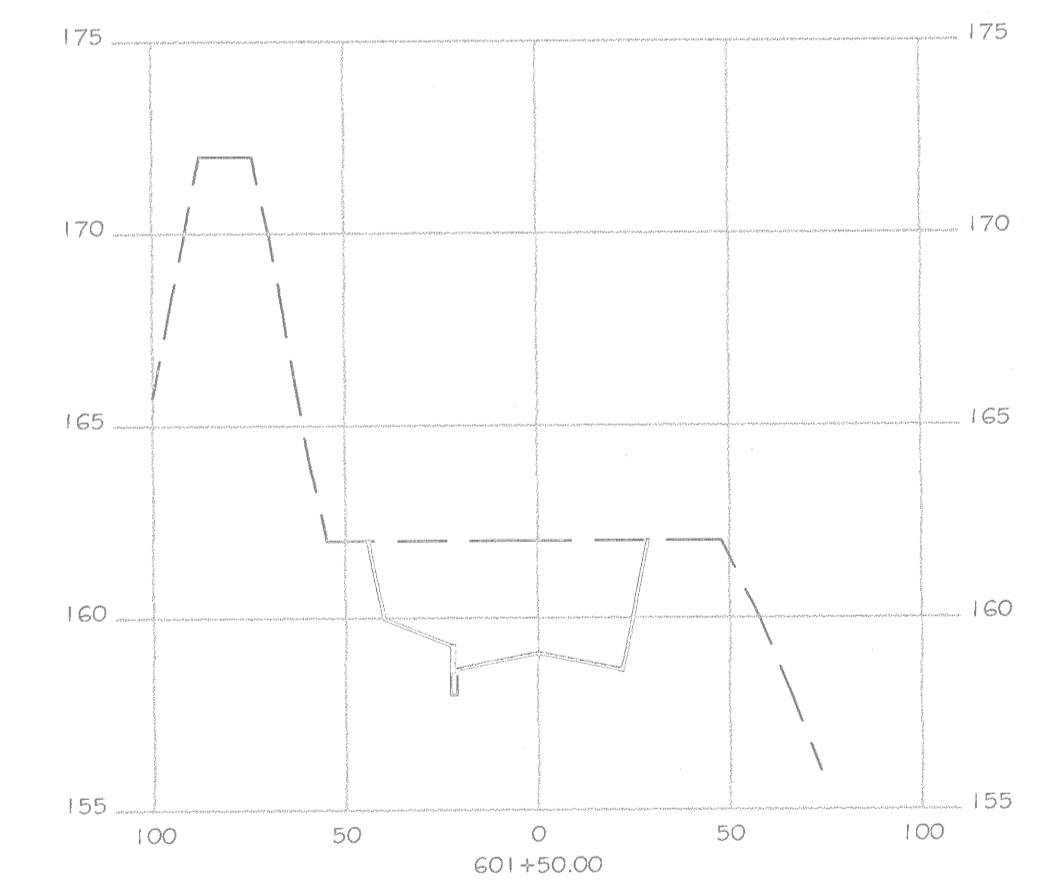
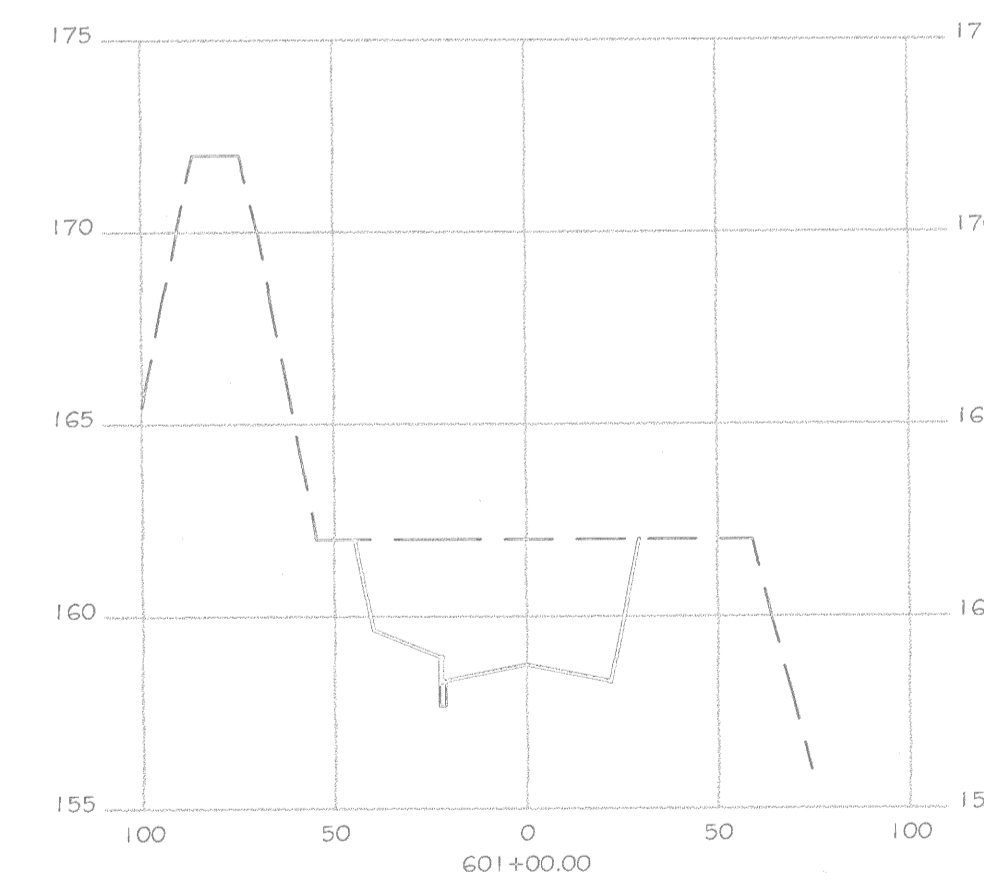
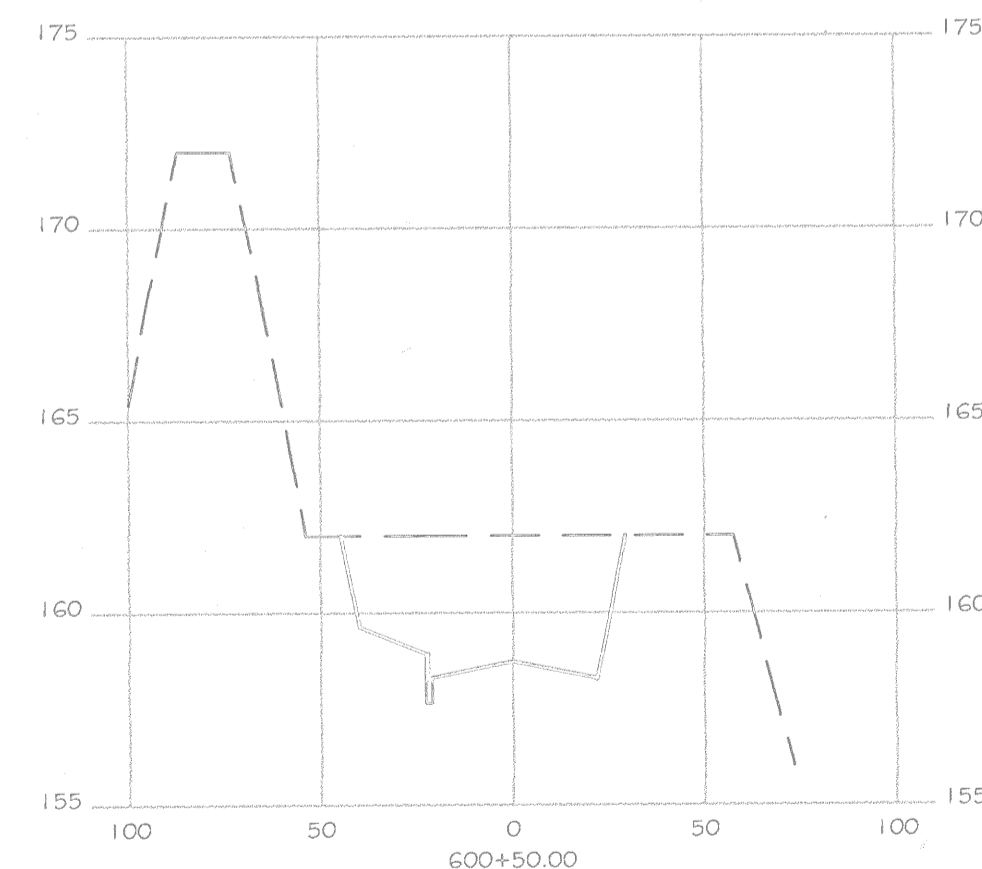
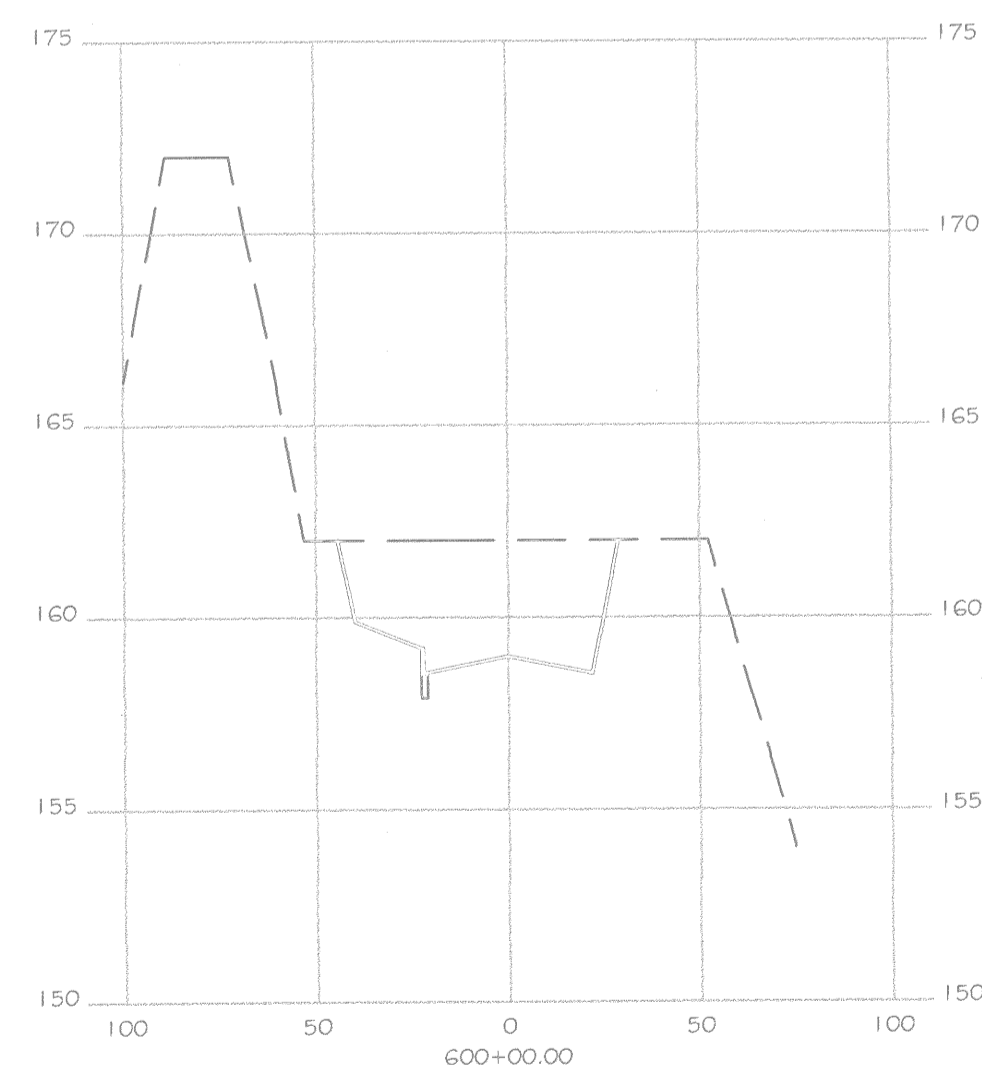
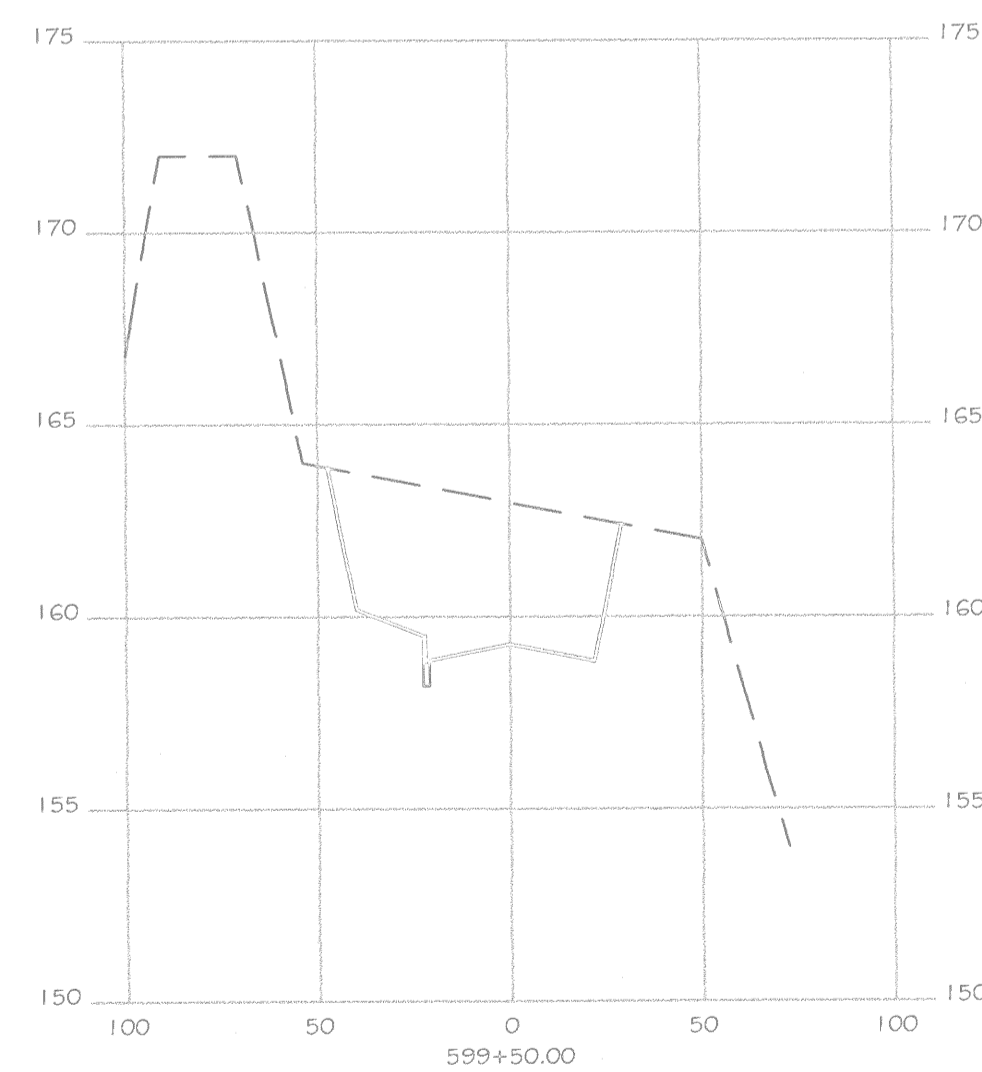
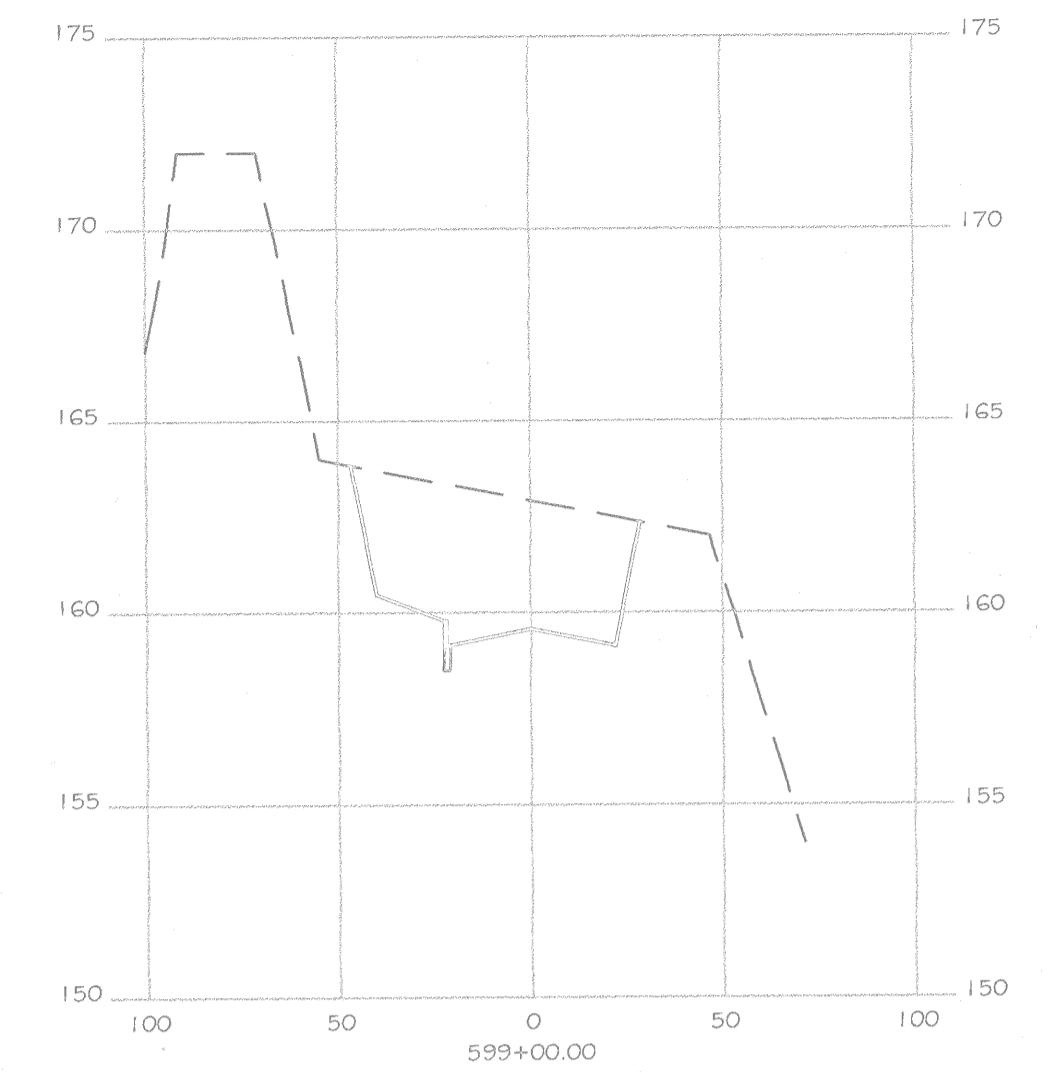
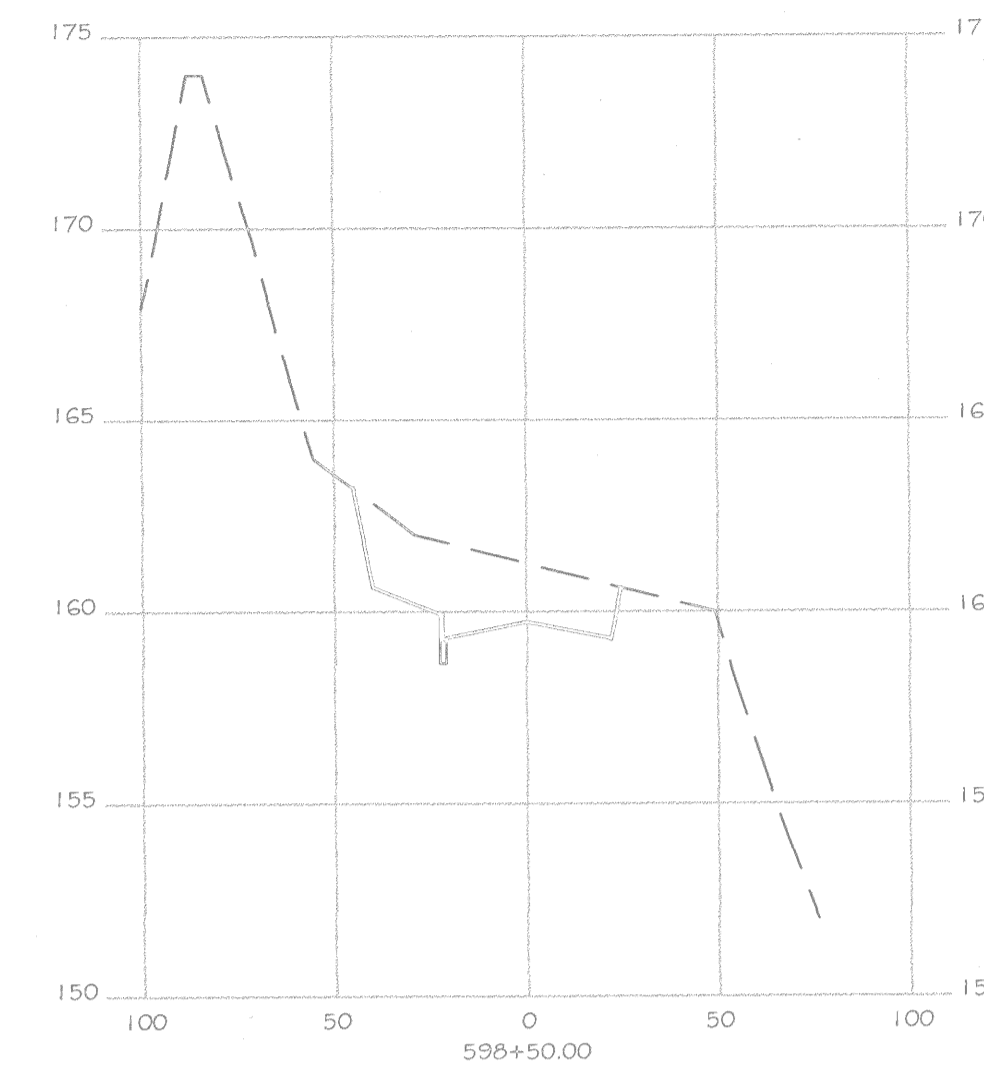
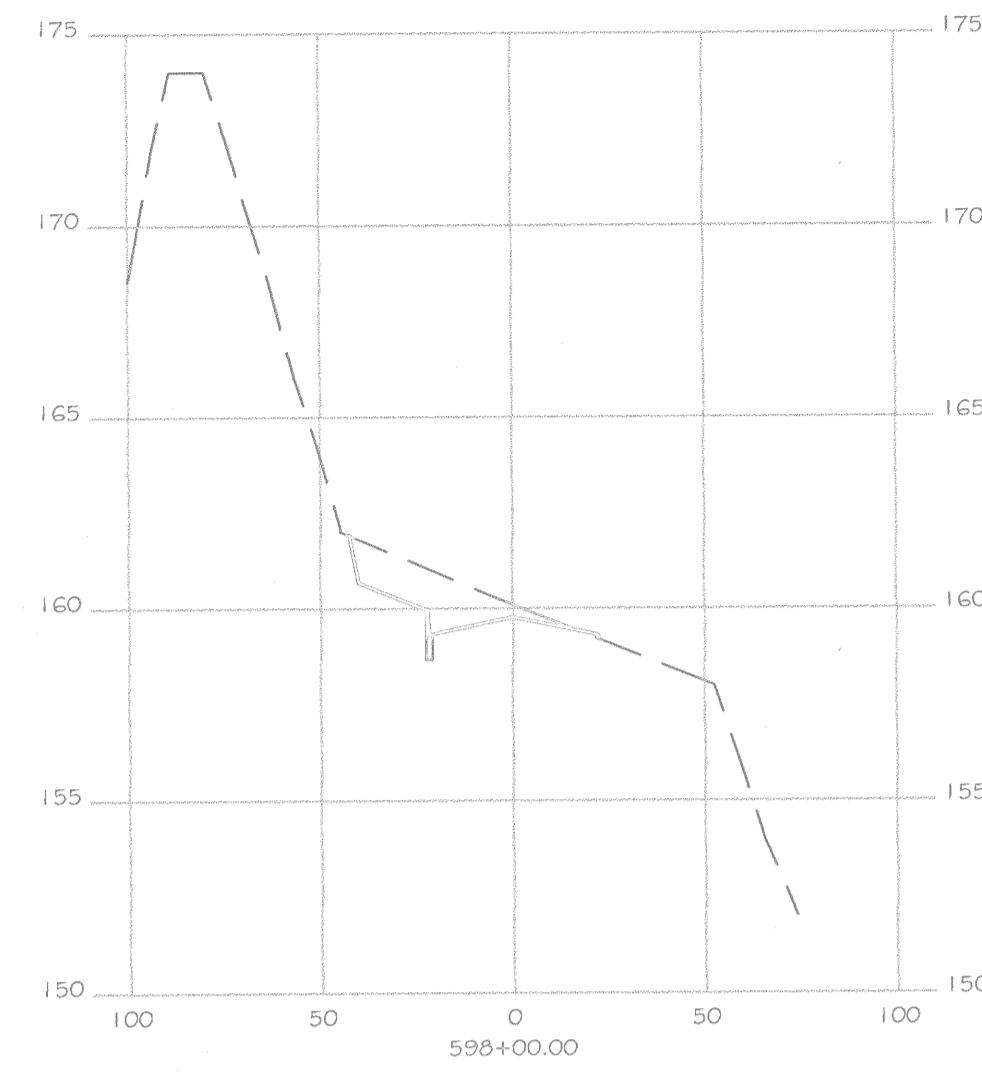
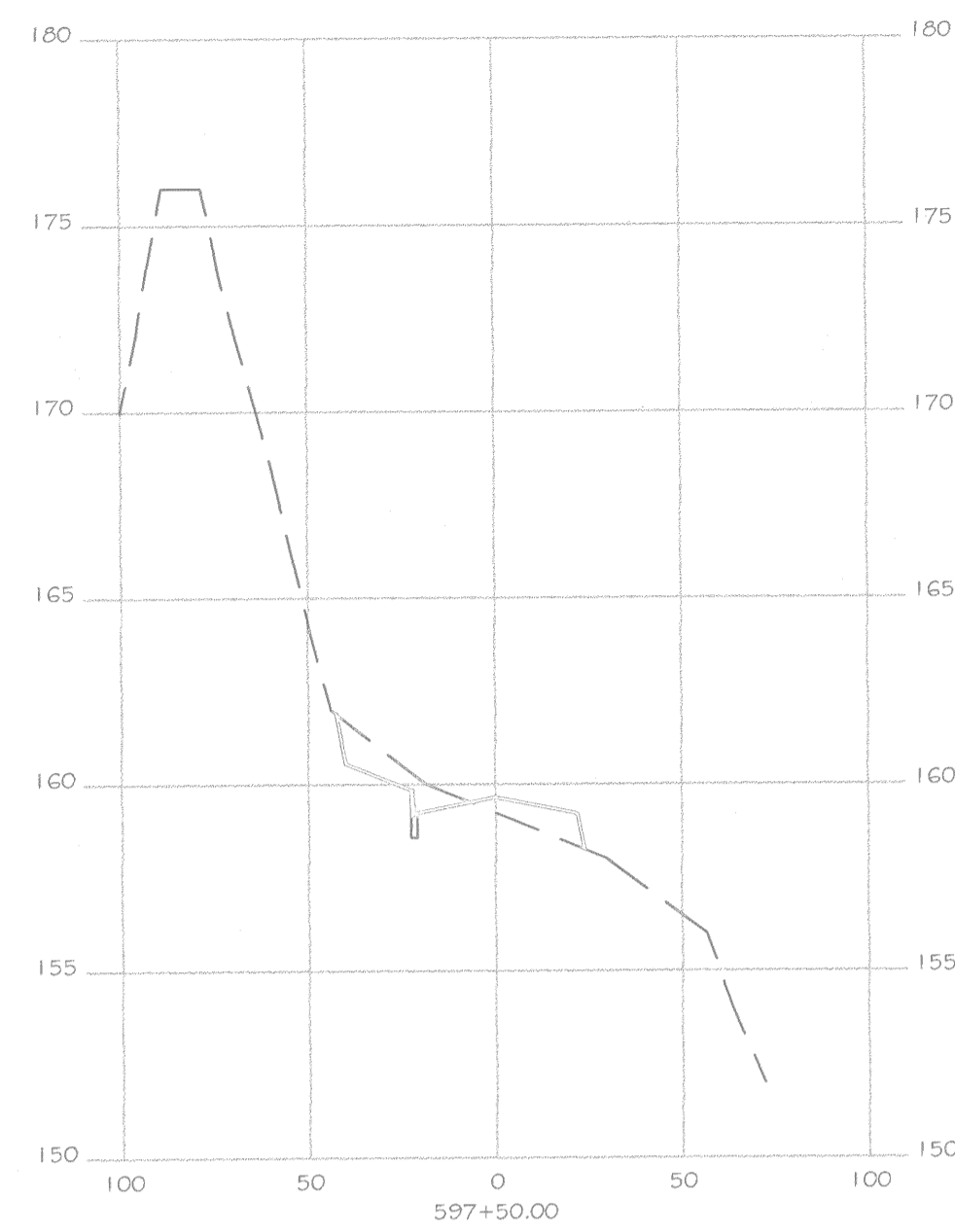
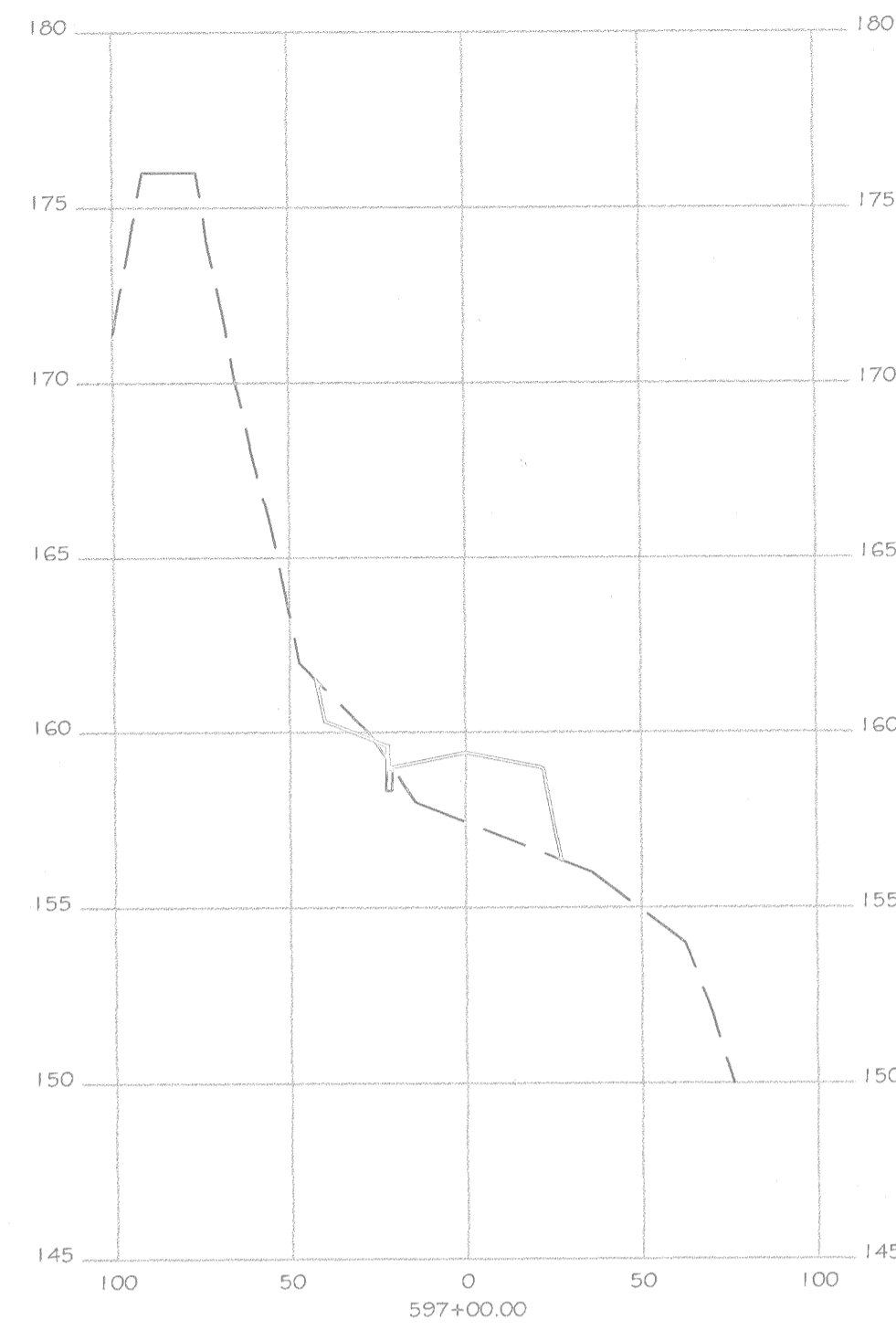

DEPARTMENT OF PUBLIC WORKS  
HOWARD COUNTY, MARYLAND

*Jan M. Chan* 10/30/03  
DIRECTOR OF PUBLIC WORKS DATE

*Earl E. Jones* 10/30/03  
CHIEF, BUREAU OF HIGHWAYS DATE

*Earl E. Jones* 10/30/03  
CHIEF, DIVISION OF TRANSPORTATION  
PROJECTS AND WATERSHED MANAGEMENT DATE

THAYER & ASSOCIATES, INC.  
2868 CONSTELLATION WAY  
FINKSBURG, MARYLAND 21048  
TEL: 410-840-8797  
FAX: 410-840-0280

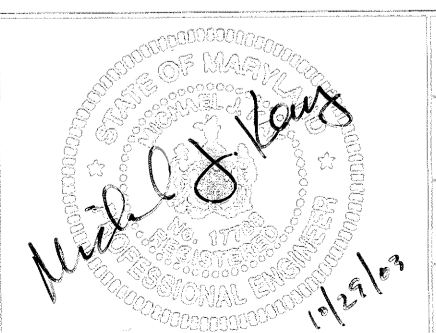

DES: M.J.K.  
DRN: M.J.K.  
CHK: G.D.T.  
DATE: SEPT 2003

BY	NO.	REVISION	DATE	600' SCALE MAP NO.	BLOCK NO.

ROAD CROSS SECTIONS

DORSEY RUN ROAD EXTENSION  
STA. 592+45.12 TO STA. 604+40.10  
CAPITAL PROJECT J-4148  
FIRST ELECTION DISTRICT  
HOWARD COUNTY, MARYLAND

SCALE:  
V: 1" = 5'  
H: 1" = 50'

SHEET  
9 OF 10

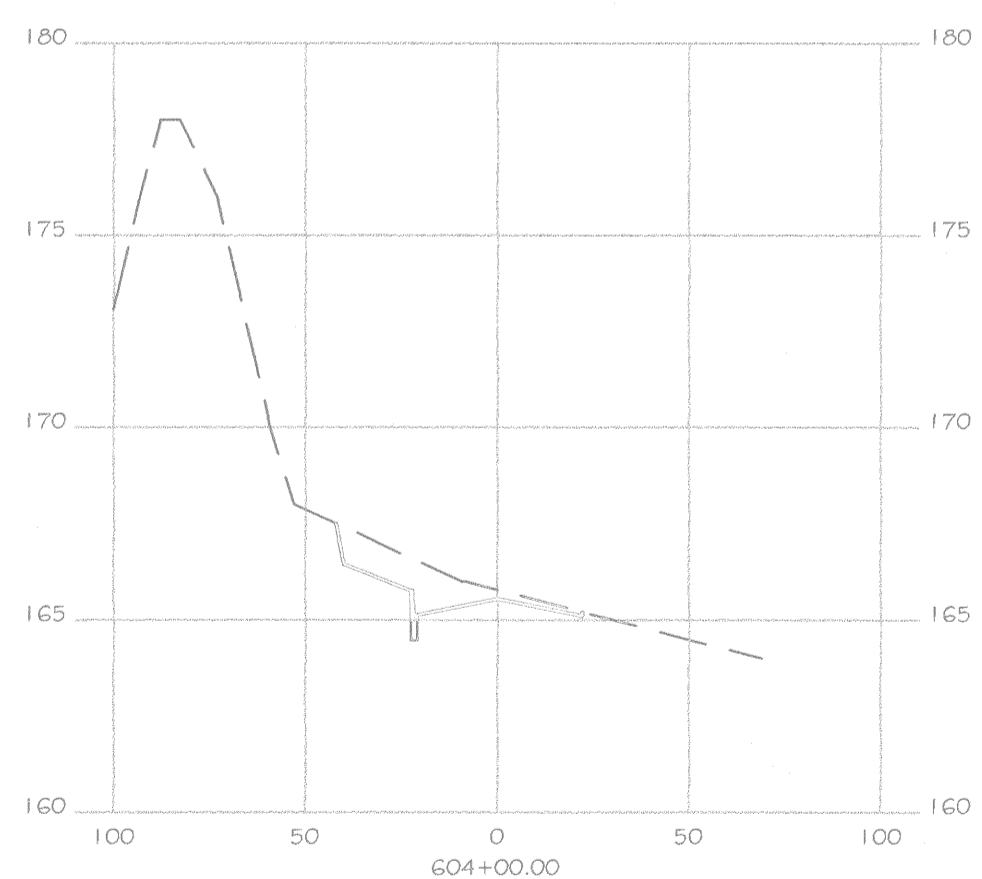
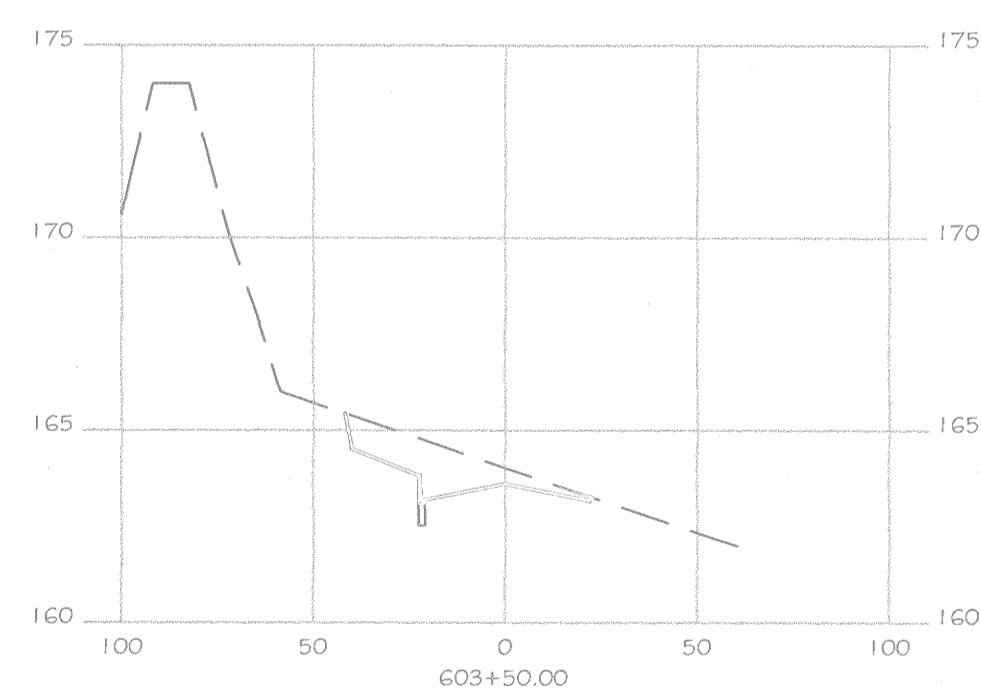
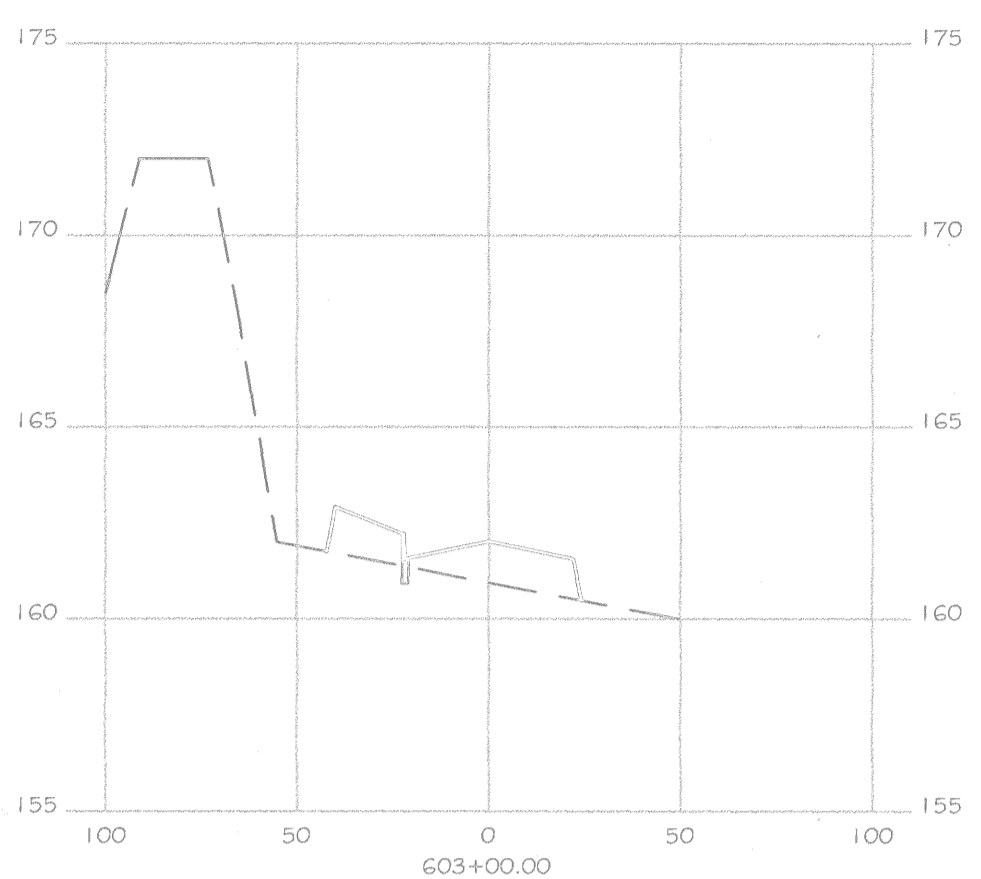
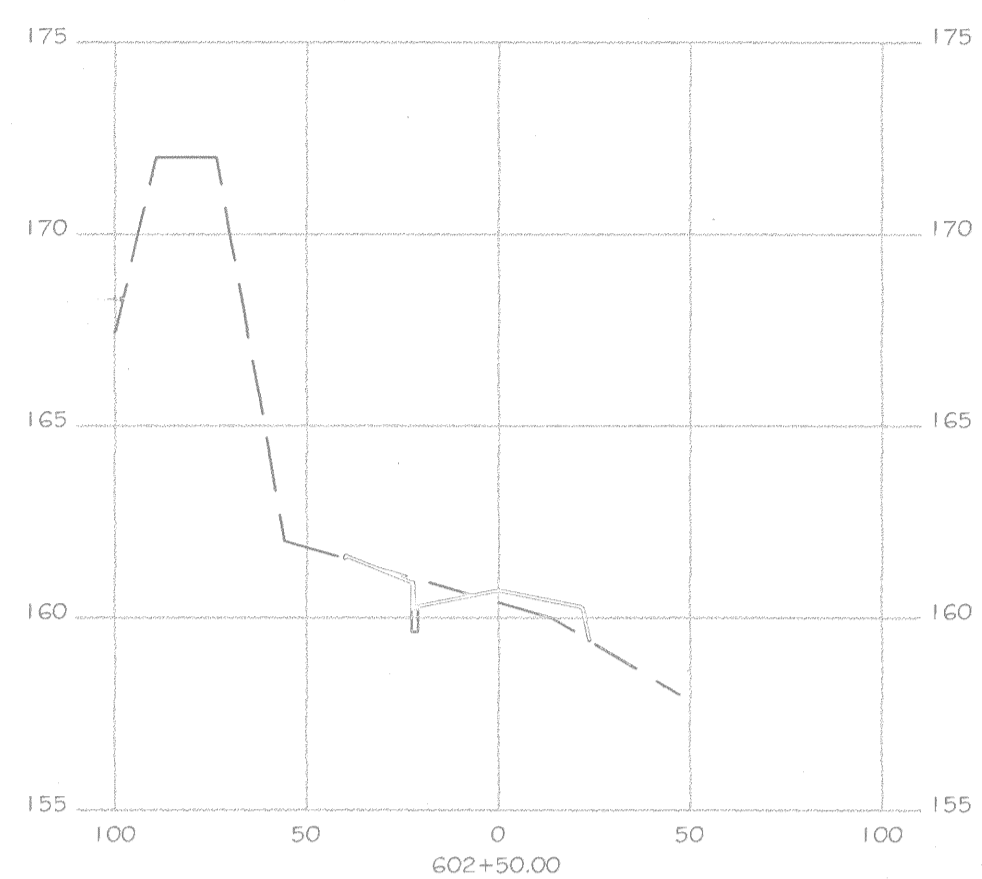
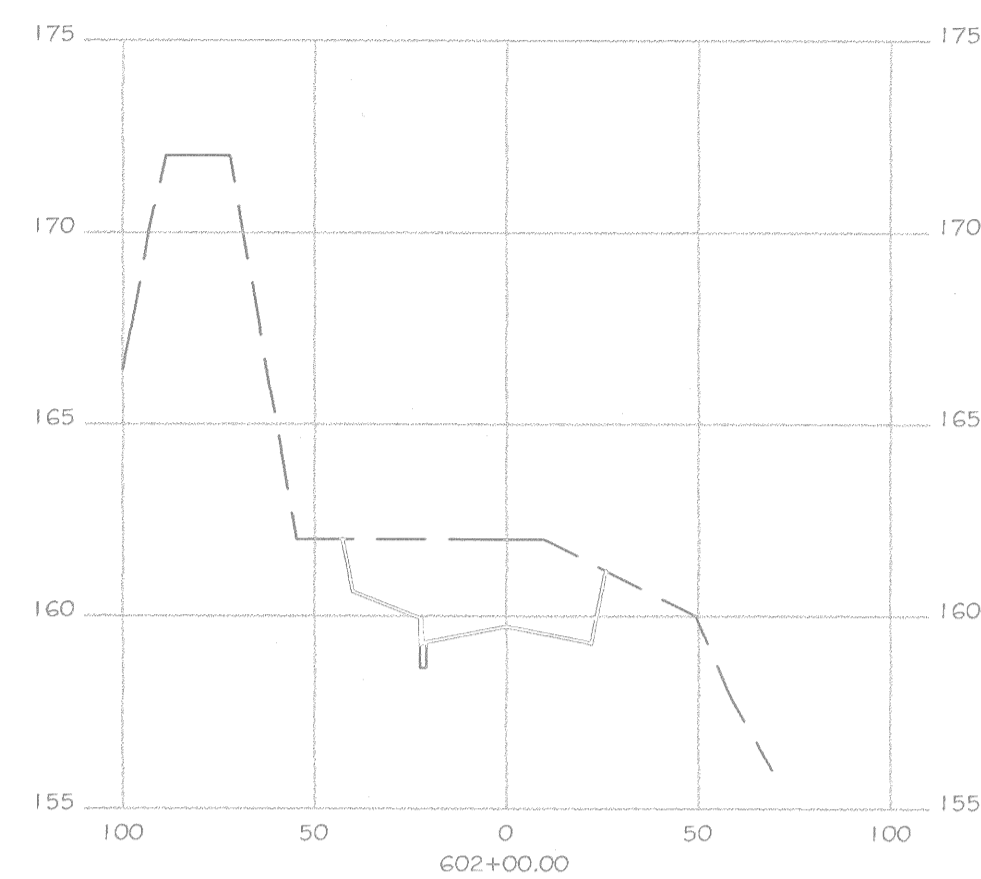

DEPARTMENT OF PUBLIC WORKS  
HOWARD COUNTY, MARYLAND

*Cam P. Ibr...* 10/30/03  
DIRECTOR OF PUBLIC WORKS DATE

*Michelle...* 10/30/03  
CHIEF, BUREAU OF ENGINEERING DATE

*Evelyn E. Jones* 10/30/03  
CHIEF, DIVISION OF TRANSPORTATION DATE

*...* 10/30/03  
CHIEF, BUREAU OF HIGHWAYS DATE

PROJECT: ROAD WATERSHED MANAGEMENT

THAYER & ASSOCIATES, INC.  
2888 CONSTELLATION WAY  
FINKSBURG, MARYLAND 21048  
TEL: 410-840-8797  
FAX: 410-840-0280



DES:	M.J.K.			
DRN:	M.J.K.			
CHK:	G.D.T.			
DATE:	SEPT 2003	BY:	NO.	REVISION
				DATE

ROAD CROSS SECTIONS

600' SCALE MAP NO. \_\_\_\_\_ BLOCK NO. \_\_\_\_\_

DORSEY RUN ROAD EXTENSION  
STA. 592+45.12 TO STA. 604+40.10  
CAPITAL PROJECT J-4148  
FIRST ELECTION DISTRICT  
HOWARD COUNTY, MARYLAND

SCALE:  
V: 1" = 5'  
H: 1" = 50'

SHEET  
10 OF 10