

INDEX OF SHEETS

SHEET NO.	DESCRIPTION
1	TITLE SHEET
2	INTERSECTION PLAN
3	TRAFFIC CONTROL PLAN

GENERAL NOTES

- ALL INFORMATION AND DETAILS ON THESE DRAWINGS SHALL BE AS DIRECTED BY THE HOWARD COUNTY ENGINEER.
- ALL STATIONING AND DIMENSIONING ARE TO BE FIELD VERIFIED BY THE CONTRACTOR.
- APPROXIMATE LOCATION OF EXISTING UTILITIES ARE SHOWN. THE CONTRACTOR SHALL TAKE ALL NECESSARY PRECAUTIONS TO PROTECT EXISTING UTILITIES AND TO MAINTAIN UNINTERRUPTED SERVICE. ANY DAMAGE INCURRED SHALL BE REPAIRED IMMEDIATELY TO THE SATISFACTION OF THE ENGINEER AND TO THE SATISFACTION OF THE UTILITY OWNER BY THE CONTRACTOR AT THE CONTRACTOR'S EXPENSE. THE CONTRACTOR SHALL NOTIFY THE FOLLOWING UTILITIES OR AGENCIES AT LEAST FIVE (5) DAYS BEFORE STARTING WORK SHOWN ON THESE PLANS.

MISS UTILITY 1-800-257-7777

THE CONTRACTOR SHALL CONTACT THE HOWARD COUNTY CONSTRUCTION INSPECTION DIVISION OF ENGINEERING FOR VERIFICATION AND/OR INFORMATION REGARDING:

A. MAINTENANCE OF TRAFFIC DURING CONSTRUCTION.
- SEE HOWARD COUNTY STANDARD DETAILS NO'S G-1.01 & G-1.02 FOR STANDARD SYMBOLS.
- MAINTENANCE OF TRAFFIC ALONG GUILFORD ROAD AND HALL SHOP ROAD SHALL BE HANDLED BY SHA STANDARD MD-104.42-02 - PARTIAL ROADWAY CLOSURE/MULTILANE UNDIV. EQL/LESS THAN 40 MPH/15 MIN-12 HRS. OR DAYTIME ONLY, WHEN TRAFFIC CONTROL PLAN IS NOT IN USE.
- NO GUARANTEE IS MADE TO THE ACCURACY OF THESE PLANS. THE CONTRACTOR SHALL BE RESPONSIBLE TO PROVIDE ACCURATE COORDINATE GEOMETRY TO MEET THE EXISTING FIELD CONDITIONS, AND THE INTENT OF THESE DRAWINGS.

PROJECT LOCATION

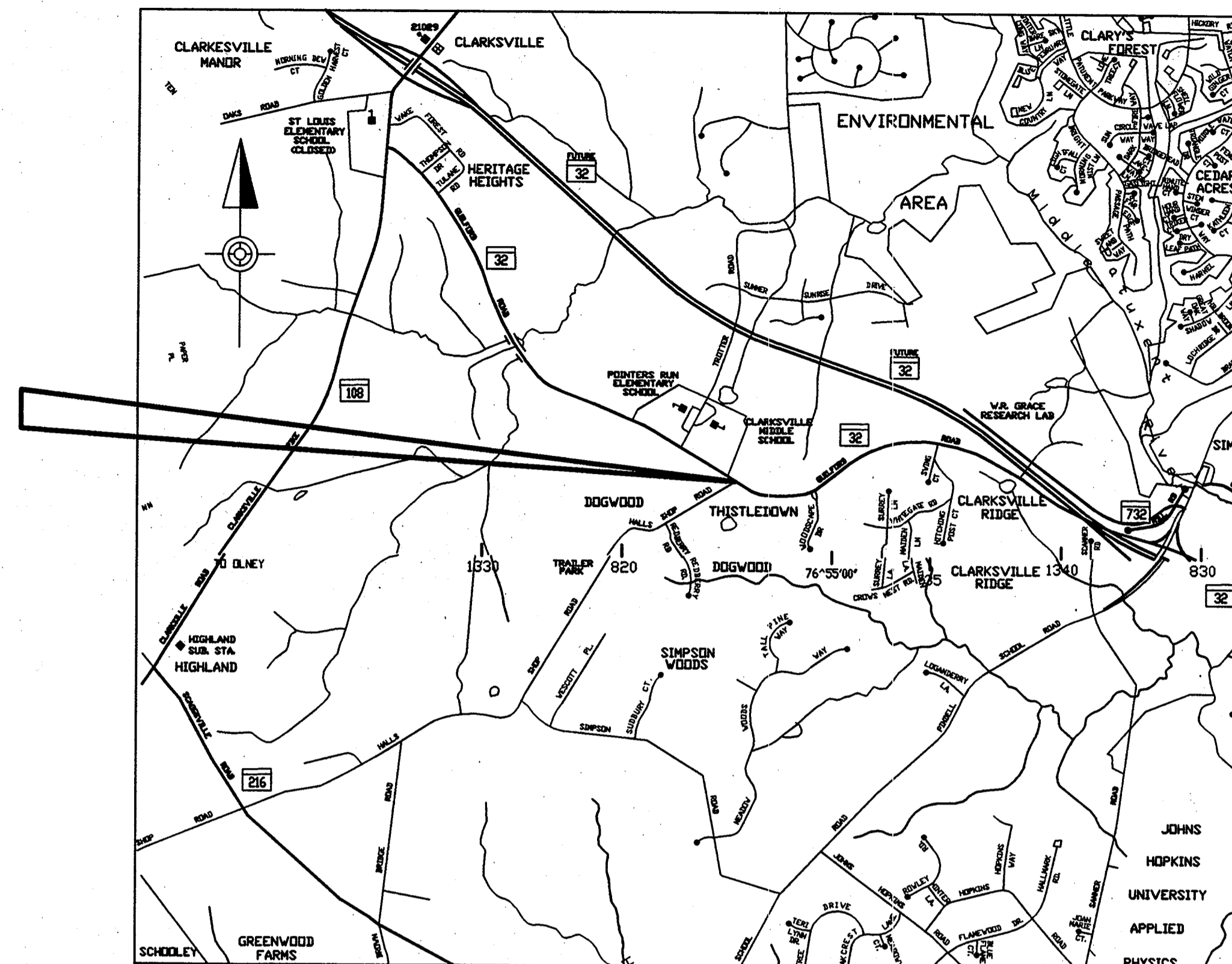

LOCATION MAP

SCALE: 1" = 2000'

CAPITAL PROJECT NO. J - 4142-A

GUILFORD ROAD AND HALL SHOP ROAD "INTERSECTION IMPROVEMENTS"

HOWARD COUNTY, MARYLAND
DEPARTMENT OF PUBLIC WORKS

REVIEWED FOR HOWARD COUNTY SOIL CONSERVATION DISTRICT AND MEETS TECHNICAL REQUIREMENTS.

U.S. Natural Resources Conservation Service Date
THIS DEVELOPMENT IS APPROVED FOR EROSION AND SEDIMENT CONTROL BY THE HOWARD SOIL CONSERVATION DISTRICT.

Howard Soil Conservation District Date

APPROVED: FOR STORM DRAINAGE SYSTEMS AND PUBLIC ROADS, HOWARD COUNTY DEPARTMENT OF PUBLIC WORKS.

Elly M. G. Calia 5/08/01 Date
Chief, Division of Transportation Projects and Watershed Management

DEPARTMENT OF PUBLIC WORKS HOWARD COUNTY, MARYLAND DIRECTOR OF PUBLIC WORKS DATE CHIEF, BUREAU OF HIGHWAYS DATE	GPI Greenman-Pedersen, Inc. ENGINEERS, ARCHITECTS, PLANNERS, CONSTRUCTION ENGINEERS & INSPECTORS 14502 GREENVIEW DRIVE, SUITE 100, LAUREL, MD. 20708 WASH. (301) 470-2772 BALT. (410) 880-3055 FAX: (301) 490-2649 www.gpinet.com	STATE OF MARYLAND DANIEL JOSEPH MALETIC REGISTERED PROFESSIONAL ENGINEER No. 18759	DES: SAY	BY: NO	REVISION	DATE	TITLE SHEET	ROADWAY IMPROVEMENTS TO GUILFORD ROAD & HALL SHOP ROAD HOWARD COUNTY, MARYLAND CAPITAL PROJECT NO. - J - 4142-A	SCALE AS SHOWN SHEET 1 OF 3
			DRN: SAY	CHK: KP	DATE: 12/00	600' SCALE MAP NO.			

ALIGNMENT GEOMETRY

Alignment : Guilford Road C/L									
Curve Station	TL	LC	CD	DC	RC	Bearing	North	East	
0+00.00 POB	244.8897					S 58°48'54.04" E	554207.503	1334149.356	
1	2+44.87 PC 3+92.00 PI 5+39.09 PT	294.2209	2'17"43.37"	0'46"48.56"	-7344.151		554080.709 554004.524 553933.442	1334358.842 1334484.712 1334613.532	
Alignment : Hall Shop Road C/L #3									
Curve Station	TL	LC	CD	DC	RC	Bearing	North	East	
0+00.00 PC						N 59°18'05.31" E	552798.215	1332166.800	
1	1+01.04 PI 2+02.07 PCC	202.0714	0'47"38.86"	0'23"34.78"	14579.336		552884.988 552971.036	1332218.559 1332271.515	
2	5+07.10 PI 7+58.91 PRC	556.8337	58°06'48.00"	10'26"11.00"	549.000		553230.808 553232.284	1332431.387 1332736.409	
3	8+15.65 PI 8+72.39 PCC	113.4811	0'31'03.31"	0'27'21.95"	-12582.150		553232.558 553233.345	1332793.150 1332849.885	
4	10+03.01 PI 11+28.86 PCC	256.4757	26°46'00.48"	10'26"11.00"	-549.000		553235.157 553295.596	1332880.495 1333096.293	
5	12+11.04 PI 12+93.12 PRC	164.2546	5°06'32.57"	3'06'37.60"	-1842.045		553333.622 553377.984	1333169.148 1333238.328	
6	15+16.24 PI 17+39.31 PT	446.1942	1°58'19.61"	0'26'31.15"	12963.261		553498.426 553612.333	1333426.147 1333617.999	
7	20+72.95 PC 21+47.04 PI 22+21.14 PCC	333.6346					553782.661 553930.845 553857.490	1333904.880 1334160.056 1334032.789	
8	23+25.63 PI 25+14.85 PRC	293.7161	3°06'47.08"	1°03'35.62"	5405.805		553911.663 553997.180	1334122.158 1334291.119	
9	25+81.38 PI 26+44.42 PT	129.5646	32°03'39.96"	24°44'42.97"	-231.542		554027.222 554084.191	1334350.477 1334384.834	

CONSTRUCTION GEOMETRY

STATION/OFFSET	REMARK
GUILFORD ROAD	
2+20 / 20' +/- RT.	BEGIN MOUNTABLE CURB MEDIAN
2+35.50 / 20' +/- RT.	END MOUNTABLE CURB MEDIAN
2+77 / 18' +/- RT.	BEGIN PAINTED MEDIAN
2+98 / 18' +/- RT.	END PAINTED MEDIAN
HALL SHOP ROAD	
25+55 / 0-4' LT.	BEGIN MOUNTABLE CURB MEDIAN
26+05 / 0-4' LT.	END MOUNTABLE CURB MEDIAN
2+85 / 23' LT.	END MOUNTABLE CURB MEDIAN
25+96 / 14' RT.	END PAINTED MEDIAN

NOTE:
 * CONSTRUCTION GEOMETRY HAS BEEN DEVELOPED FROM ASSUMED STATIONING ALONG GUILFORD AND HALL SHOP ROADS. THE CONTRACTOR SHALL BE RESPONSIBLE FOR THE DETERMINATION OF MORE PRECISE STATIONING AND CONSTRUCTION GEOMETRY TO MEET THE INTENT OF THE DESIGN. SEE GENERAL NOTES ON TITLE SHEET.

NOTES

- BAG OR COVER ALL EXISTING TRAFFIC SIGNS IN CONFLICT WITH TEMPORARY TRAFFIC CONTROL. UNCOVER WHEN DIRECTED BY THE COUNTY.
- RELOCATE OR REMOVE, STORE AND RESET EXISTING SIGNS AS DIRECTED BY THE COUNTY.
- WHEN THE NEW MEDIAN IS COMPLETE REMOVE ALL EXISTING STRIPING AS SHOWN ON THIS PLAN OR AS DIRECTED BY THE COUNTY AND REPLACE WITH NEW STRIPING AS SHOWN ON THIS PLAN. ALL STRIPING IS EXISTING UNLESS OTHERWISE INDICATED.

IF POSSIBLE ALL STRIPING WORK SHOULD BE DONE IN ONE DAY. IF STRIPING WORK CANNOT BE COMPLETED IN ONE DAY, THE PLACEMENT OF NEW STRIPING AT THE END OF THE WORK DAY SHALL NOT CONFLICT WITH EXISTING STRIPING.

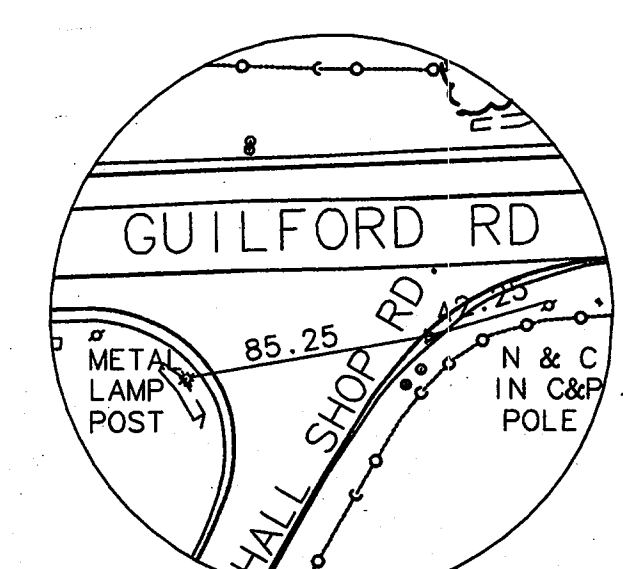
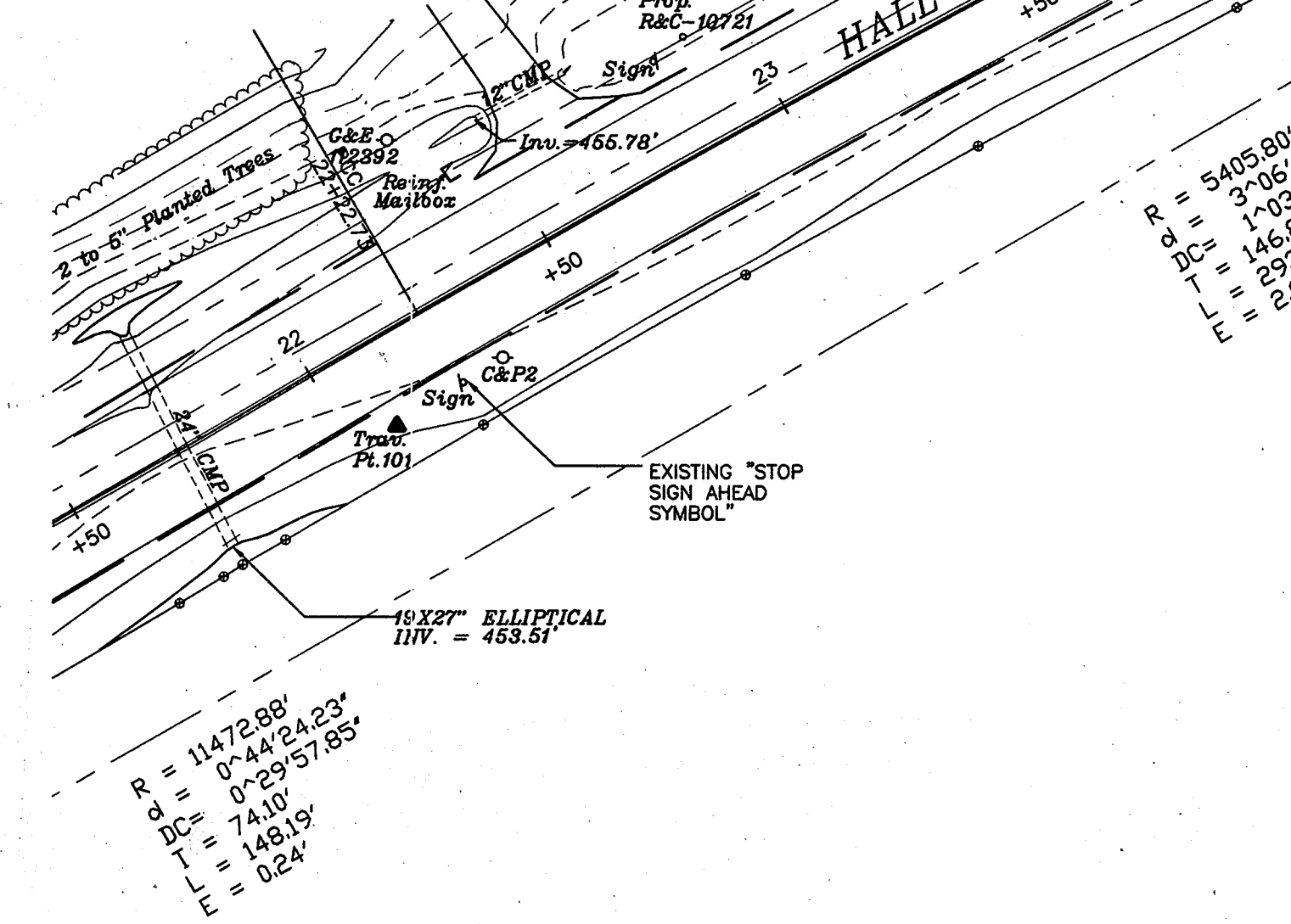
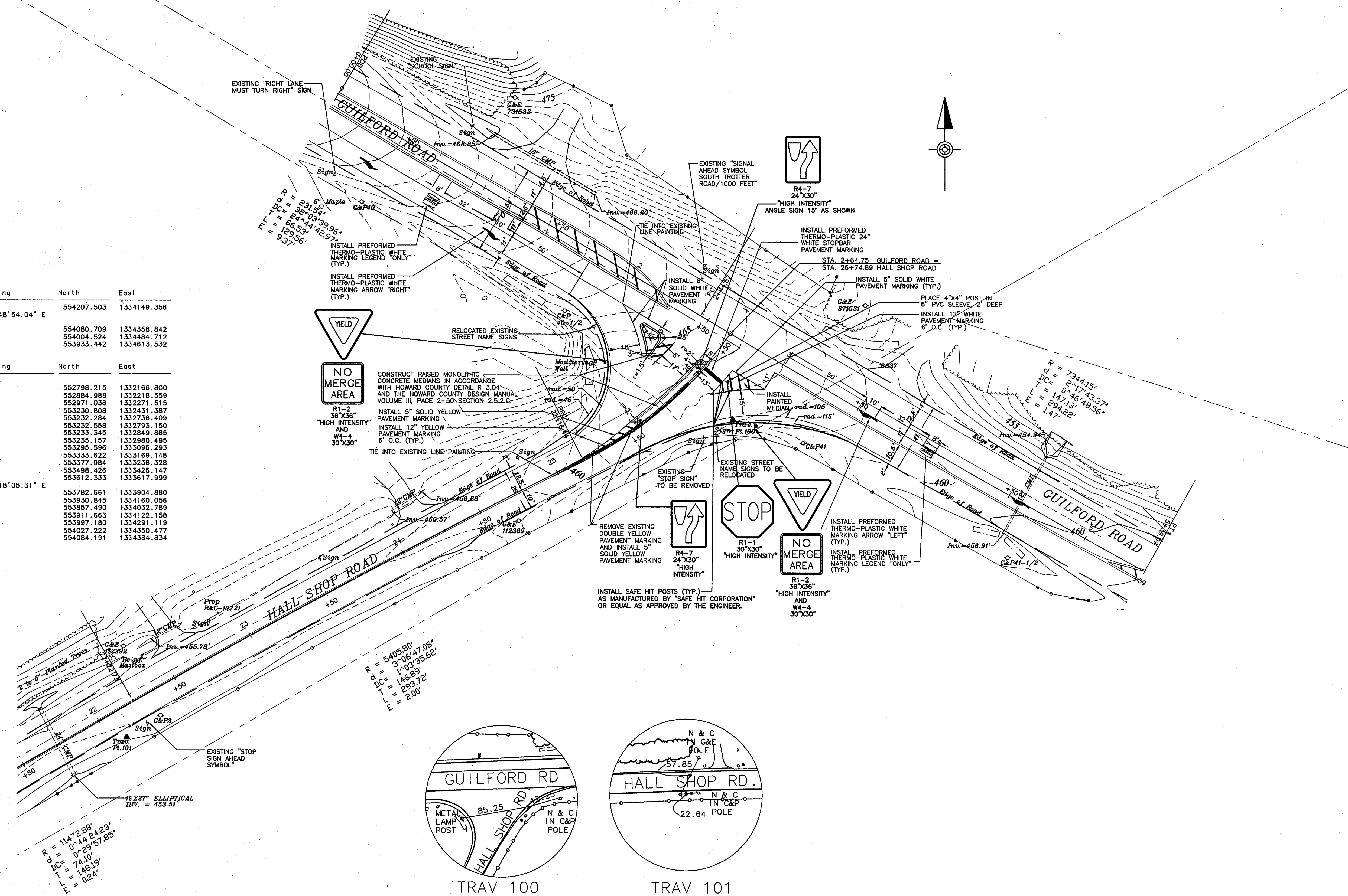

TRAV 100
 N 553836.740
 E 1334029.119
 ELEV. 456.07

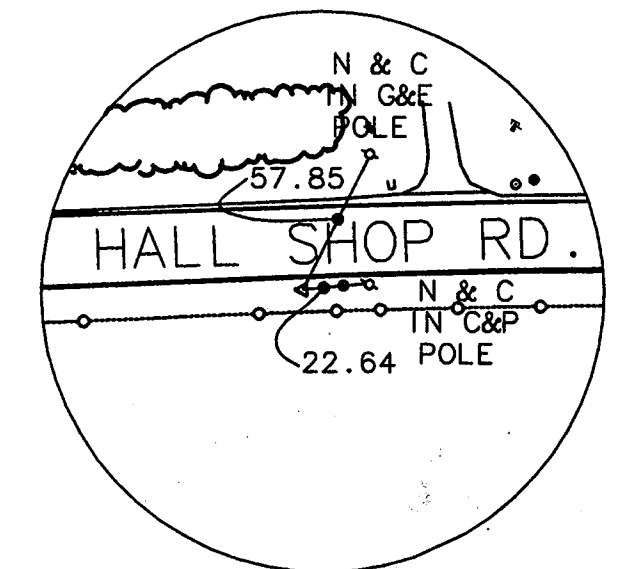

TRAV 101
 N 554020.435
 E 1334377.235
 ELEV. 462.14

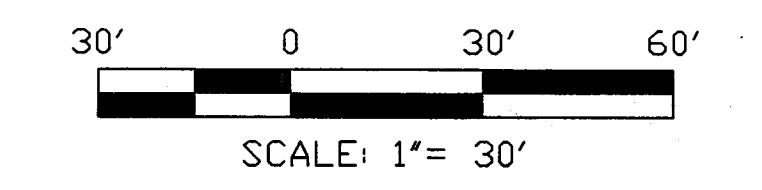

DEPARTMENT OF PUBLIC WORKS HOWARD COUNTY, MARYLAND 5/16/01 5/9/01	GPI Greenman-Pedersen, Inc. ENGINEERS, ARCHITECTS, PLANNERS, CONSTRUCTION ENGINEERS & INSPECTORS 14502 GREENVIEW DRIVE, SUITE 100, LAUREL, MD. 20708 WASH. (301) 470-2772 BALT. (410) 880-3055 FAX: (301) 490-2649 www.gpinet.com	DANIEL JOSEPH MALETT REGISTERED PROFESSIONAL ENGINEER	DES: SAY	BY: NO	REVISION	DATE	INTERSECTION PLAN ROADWAY IMPROVEMENTS TO GUILFORD ROAD & HALL SHOP ROAD HOWARD COUNTY, MARYLAND CAPITAL PROJECT NO. - J-4142-A	SCALE AS SHOWN SHEET 2 OF 3
			DRN: SAY	CHK: KP	DATE: 12/00	600' SCALE MAP NO. _____ BLOCK NO. _____ DATE _____		

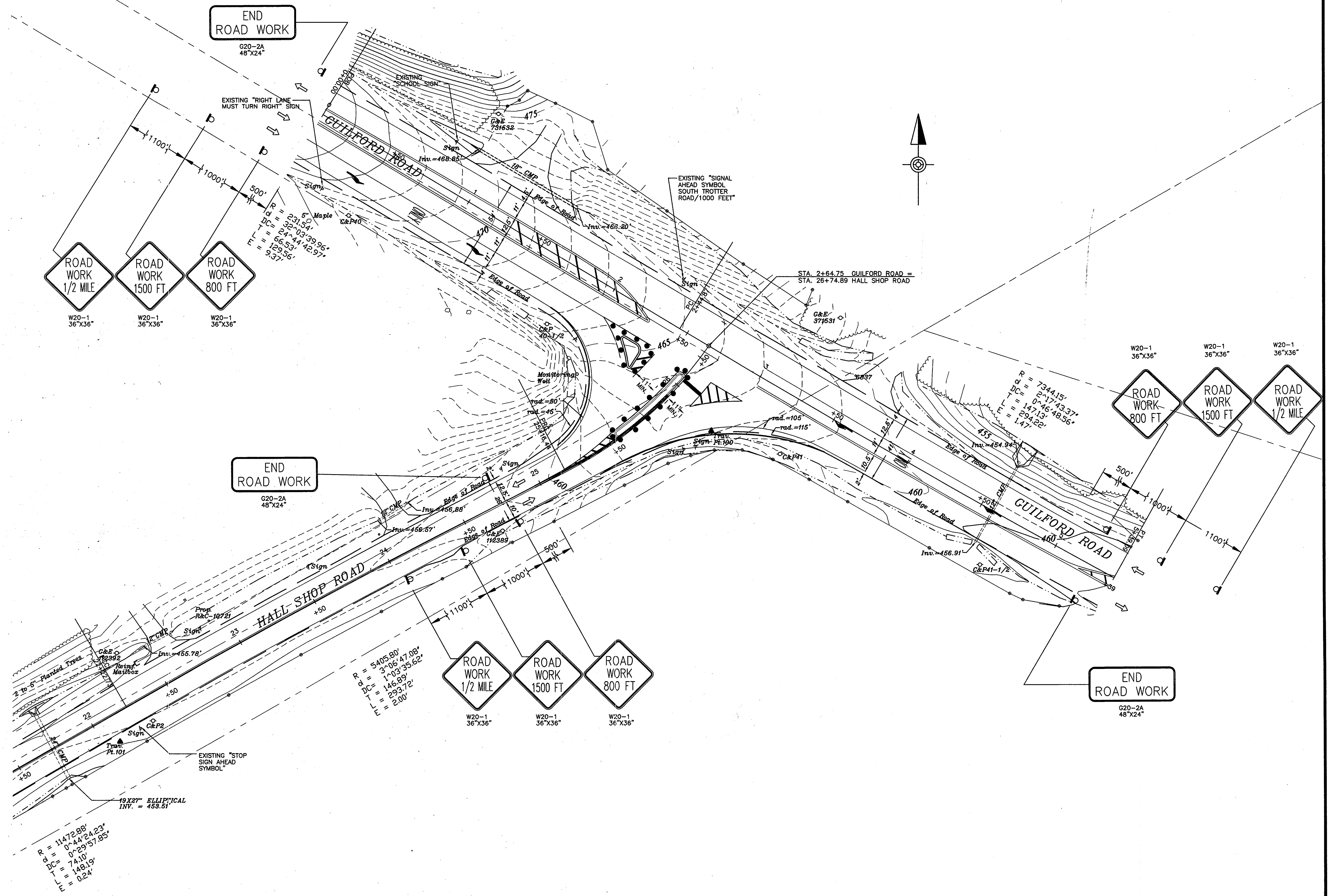

GENERAL NOTES

1. THE MAINTENANCE OF TRAFFIC PLAN AS SHOWN HEREON SHALL BE USED BY THE CONTRACTOR UNLESS AN ALTERNATE PLAN IS SUBMITTED, REVIEWED AND APPROVED BY THE HOWARD COUNTY ENGINEER.
1. USE MARYLAND STD. FLAGGER SIGNAGE WHEN NEEDED. (STD. NO. 104.31-02)

CONSTRUCTION PHASING

1. SET UP SIGNING AND CHANNELIZING DEVICES AS SHOWN ON THE PLANS. BAG OR COVER ALL EXISTING SIGNS IN CONFLICT WITH TEMPORARY SIGNS.
2. CONSTRUCT NEW MOUNTABLE CURB MEDIANS ALONG GUILFORD ROAD AND HALL SHOP ROAD.
3. REMOVE AND REPLACE EXISTING PAVEMENT STRIPING TO THE NEW CONFIGURATION.
4. REMOVE TEMPORARY TRAFFIC CONTROL DEVICES AT THE DIRECTION OF THE HOWARD COUNTY ENGINEER.

LEGEND

- CHANNELIZATION DEVICE
- ☐ SIGN WITH SUPPORT
- ⇒ DIRECTIONAL ARROW

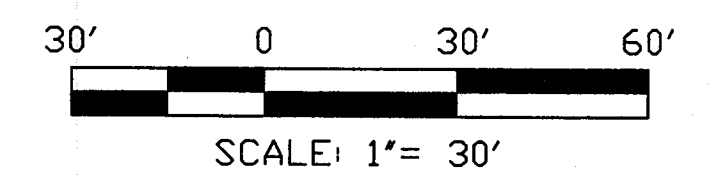

DEPARTMENT OF PUBLIC WORKS
HOWARD COUNTY, MARYLAND

Carly
DIRECTOR OF PUBLIC WORKS
DATE: 5/26/01
CHIEF, BUREAU OF HIGHWAYS

Robert S. ...
CHIEF, BUREAU OF ENGINEERING
DATE: 5/18/01
Elizabeth ...
CHIEF, DIVISION OF TRANSPORTATION PROJECTS AND WATERSHED MANAGEMENT
DATE: 5/08/01

GPI Greenman-Pedersen, Inc.
ENGINEERS, ARCHITECTS, PLANNERS,
CONSTRUCTION ENGINEERS & INSPECTORS
14502 GREENVIEW DRIVE, SUITE 100,
LAUREL, MD. 20708
WASH. (301) 470-2772 BALT. (410) 880-3055
FAX: (301) 490-2649 www.gpinet.com

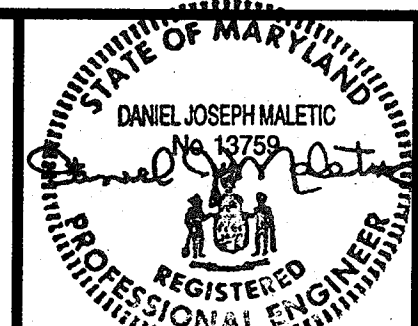

DES:	BY:	NO:	REVISION:	DATE:
SAY				
SAY				
CHK:	KP			
DATE:	12/00			

TRAFFIC CONTROL

ROADWAY IMPROVEMENTS TO
GUILFORD ROAD & HALL SHOP ROAD
HOWARD COUNTY, MARYLAND
CAPITAL PROJECT NO. - J-4142-A

SCALE AS SHOWN
SHEET 3 OF 3