

HANDICAPPED PARKING SIGN SPECIFICATIONS

I. Fine Sign:

Pursuant to Howard County Council Bill #58-84, which established a \$50.00 fine for violating provisions for handicapped parking and provided for posting notifications of that fine, this specification describes the sign authorized for posting and the associated mounting detail.



Sign to utilize an aluminum blank 6" x 12" x 0.080 inch thick with two (2) single post mounting holes. The text and border shall be standard green to match the R7-8 reserved parking sign and the background shall be reflective white. The text shall be 3" characters.

II. Mounting:

The above fine sign shall be mounted underneath the below R7-8 reserved parking sign. The bottom edge shall be no less than 7 feet above ground. If the sign is placed against a building, structure or other location where vehicle or pedestrian traffic is not obstructed, the bottom edge of the sign shall be at least 6 feet, but no more than 10 feet above ground. Because this is in addition to existing sign installations, some adjustment in height will be necessary.



REDUCE SPACING 4 PERCENT

COLORS
 LETTERS AND BORDER - GREEN
 WHITE STRIPS ON BLUE BACKGROUND
 BACKGROUND - WHITE

Reference: State of Maryland Standard Highway Signs Booklet
 Maryland Department of Transportation
 P.O. Box 717 - 707 North Calvert Street
 Baltimore, Maryland 21202

SITE ANALYSIS

1. Tax Map 25/Parcels 10 & 12
2. Total Area of Parcels: 30.04 Ac+
3. Area of Proposed Construction: 1.93 Ac+
4. Present Zoning: POR
(Planned Office Research)
5. Floor area, number of employees, parking space, open space requirement and building coverage not pertinent to the project proposed hereon.
6. Existing Parking Spaces = 157
Proposed Parking Spaces = 217
New Spaces = 60
7. Parking Lot Area
Total Area = 1.92 Ac.
Landscaped Area = 0.17 Ac. (9%)

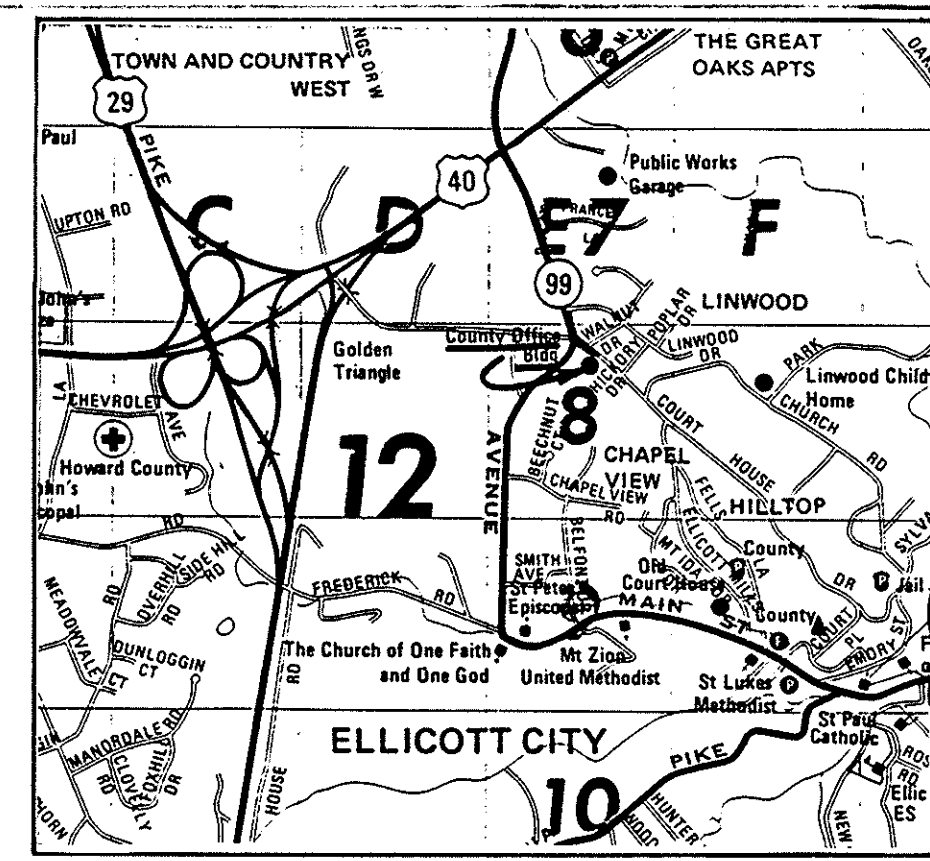

VICINITY MAP
 SCALE: 1" = 2000'

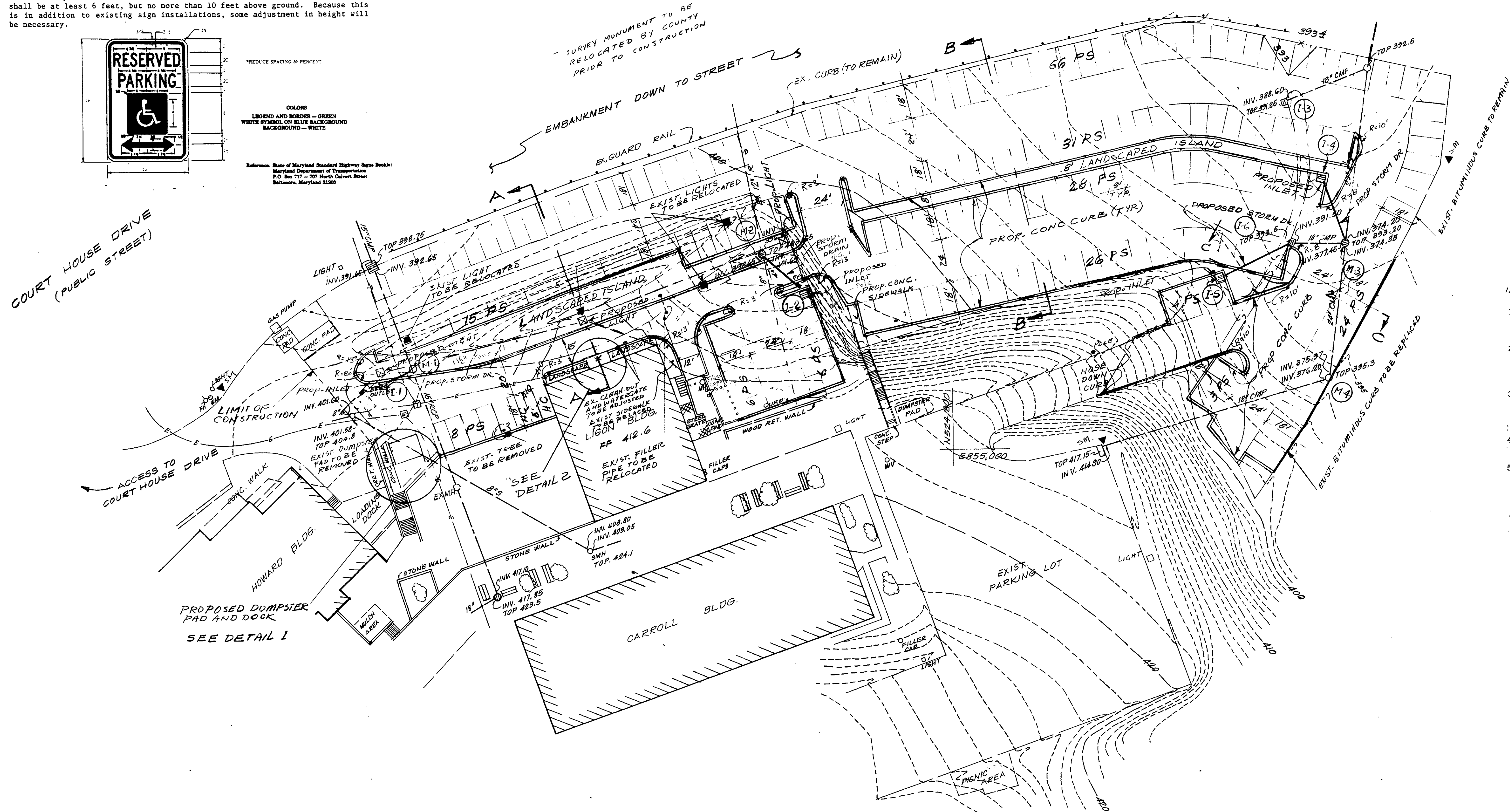

APPROVED: FOR PUBLIC WATER AND PUBLIC SEWERAGE SYSTEMS.
 HOWARD COUNTY HEALTH DEPARTMENT

COUNTY HEALTH OFFICER _____ DATE _____

APPROVED: HOWARD COUNTY OFFICE OF PLANNING & ZONING

DIRECTOR _____ DATE _____

CHIEF DIVISION OF COMMUNITY PLANNING AND LAND DEVELOPMENT _____ DATE _____

APPROVED: FOR PUBLIC WATER AND PUBLIC SEWERAGE, STORM DRAINAGE SYSTEMS AND PUBLIC ROADS.
 HOWARD COUNTY DEPARTMENT OF PUBLIC WORKS

DIRECTOR _____ DATE 9/12/88

CHIEF BUREAU OF ENGINEERING _____ DATE 9-12-88

GENERAL NOTES

1. All construction shall be in accordance with the latest standards and specifications of Howard County, Maryland and the Maryland State Highway Administration.
2. Information concerning underground utilities was obtained from available records, but the contractor must determine the exact location and elevations of all utilities prior to construction.
3. The contractor shall notify:
 "MISS UTILITY"
 1-800-257-7777
 at least 48 hours prior to start of construction.
4. Topographic Survey by Al Brown Surveys, Inc. dated February, 1988.
5. Contractor shall use contours and elevations shown as control; but must provide smooth transition to all existing pavement, curbs and sidewalks.
6. Traversal Along Embankment Adjacent to Roadway or Arterial is at _____
7. Engineer to provide worksheet for construction Stake-out

ADDRESS CHART	
LOT NUMBER	STREET ADDRESS
	3450 COURT HOUSE DRIVE
	ELICOTT CITY, MD 21043

SUBDIVISION NAME	SECT./AREA	LOT/PARCEL #
N.A.		10 212
PLAT # OR L.P. BLOCK #	ZONE	TAX/ZONE MAP
319/364	POR	25
WATER CODE	ELEC. DIST.	CENSUS TR.
	2	
	SEWER CODE	

SITE DEVELOPMENT PLAN

ari ENGINEERING
 8150 Leesburg Pike Suite 503
 Vienna, Virginia 22180
 (703) 442-0202

NO	REVISIONS	BY	DATE
7			
6			
5			
4			
3			
2			
1			
NO			

9 Sept 88

1" = 30'

**HOWARD COUNTY OFFICE COMPLEX
 PARKING LOT EXPANSION**
 TAX MAP 25 PARCEL 12

CAPITAL PROJECT #C-0105
 ELECTION DISTRICT NO 2
 HOWARD COUNTY, MARYLAND

JOB NUMBER
5105
 SHEET NO
1
 OF 5 SHEETS



N 525,100
E 855,300

N 524,800
E 855,300

N 524,500
E 855,300

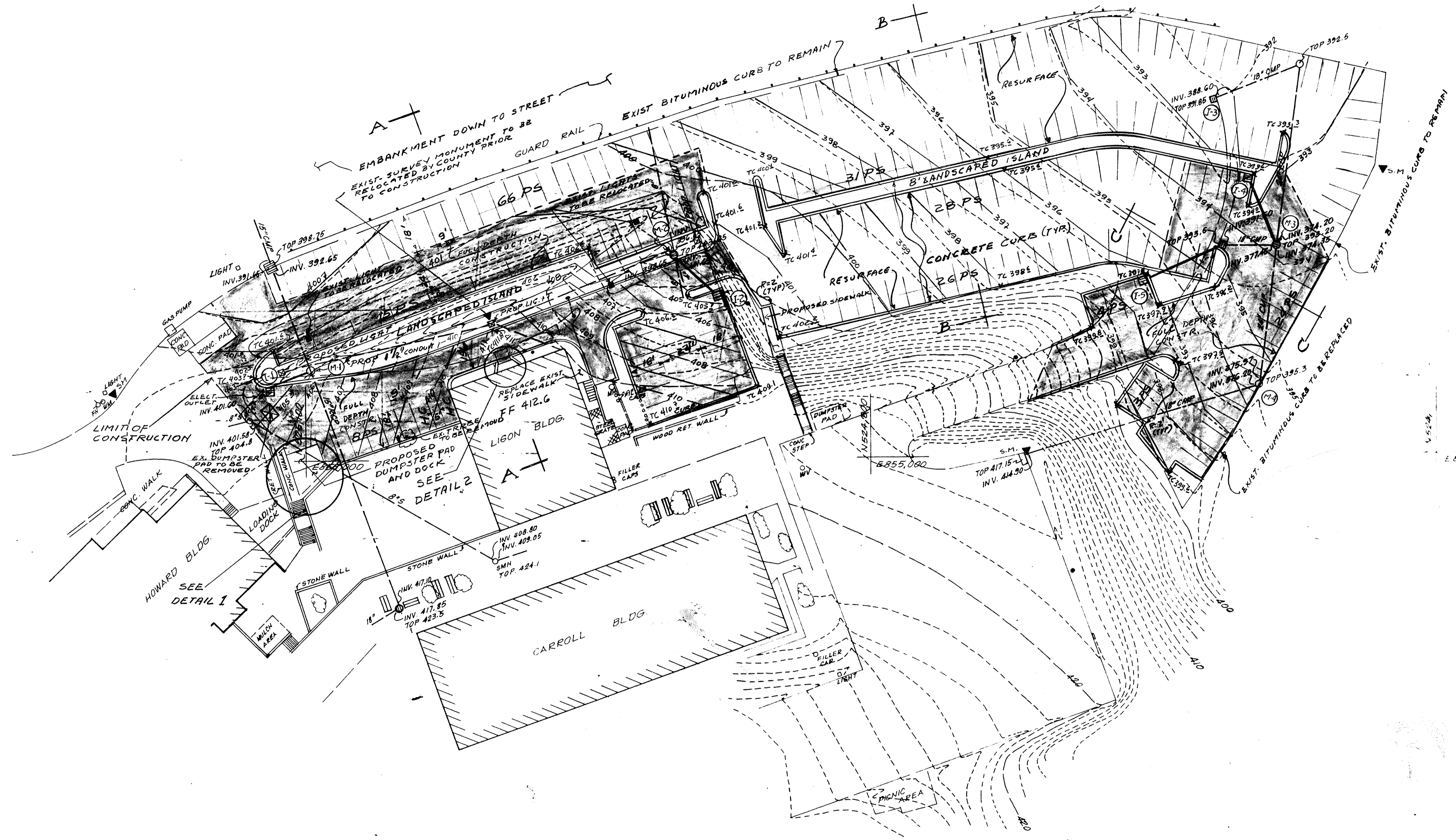

APPROVED: FOR PUBLIC WATER AND PUBLIC SEWERAGE SYSTEMS. HOWARD COUNTY HEALTH DEPARTMENT	
COUNTY HEALTH OFFICER	DATE
APPROVED: HOWARD COUNTY OFFICE OF PLANNING & ZONING	
DIRECTOR	DATE
CHIEF DIVISION OF COMMUNITY PLANNING AND LAND DEVELOPMENT	
DIRECTOR	DATE
APPROVED: FOR PUBLIC WATER AND PUBLIC SEWERAGE, STORM DRAINAGE SYSTEMS AND PUBLIC ROADS HOWARD COUNTY DEPARTMENT OF PUBLIC WORKS	
<i>James M. ...</i>	9/12/88
DIRECTOR	DATE
<i>William S. ...</i>	9-12-88
CHIEF BUREAU OF ENGINEERING	DATE

GRADING AND PAVING PLAN.

ari ENGINEERING
8150 Leesburg Pike Suite 503
Vienna, Virginia 22180
(703) 442-0202

NO	REVISIONS	BY	DATE
6			
5			
4			
3			
2			
1			
NO			

[Signature]
9 SEPT 88
1" = 30'



**HOWARD COUNTY OFFICE COMPLEX
PARKING LOT EXPANSION**
TAX MAP 25 PARCEL 12
CAPITAL PROJECT #C-0105
ELECTION DISTRICT NO. 2
HOWARD COUNTY, MARYLAND

JOB NUMBER	5105
SHEET NO	2
OF 5 SHEETS	